

NOTE:
THE TRAFFIC SIGNAL CONTROLLER EQUIPMENT FOR THIS PROJECT SHALL BE "ECONOLITE" TO MATCH THE EXISTING ADJACENT SYSTEM.

RESTORATION OF WORK AREA. RESTORATION OF THE TRAFFIC SIGNAL WORK AREA SHALL BE INCLUDED IN THE COST FOR THE RELATED PAY ITEM SUCH AS FOUNDATION, CONDUIT, HANDHOLE, TRENCH AND BACKFILL ETC., AND NO EXTRA COMPENSATION SHALL BE ALLOWED. ALL ROADWAY SURFACES SUCH AS SHOULDERS, MEDIANS, SIDEWALKS, PAVEMENT, ETC. SHALL BE REPLACED IN KIND. ALL DAMAGE TO MOWED LAWNS SHALL BE REPLACED WITH AN APPROVED SOD, AND ALL DAMAGE TO UNMOWED FIELDS SHALL BE SEEDING IN ACCORDANCE WITH STANDARD SPECIFICATIONS 252 AND 250 RESPECTIVELY.

EMERGENCY VEHICLE PREEMPTOR	3	4
MOVEMENT	←	↔

L.C.D.O.T. TRAFFIC SIGNAL INSTALLATION ELECTRICAL SERVICE REQUIREMENTS					TOTAL WATTAGE
TYPE	NO. OF LAMPS	WATTAGE INCAND.	LED	% OPERATION	
SIGNAL (RED)	16	10	0.50		80.0
(YELLOW)	16	19	0.10		30.4
(GREEN)	16	11	0.40		70.4
ARROW	16	9	0.10		14.4
PED. SIGNAL	10	9	1.00		90.0
CONTROLLER	1	100	1.00		100.0
LUMINAIRE	-	250	0.50		-
L.E.D. ST. NAME SIGN	-	64	0.50		-
VIDEO SYSTEM	1	150	1.00		150.0
BATTERY BACKUP	1	25	1.00		25.0
ENERGY COSTS TO:					TOTAL = 560.2

CITY OF HIGHLAND PARK
1707 ST. JOHNS AVENUE
HIGHLAND PARK, IL 60035-3593
ENERGY SUPPLY CONTACT: JEAN WILL
PHONE: (847) 816-5459
COMPANY: COMED

DESIGNED - WCE
DRAWN - FCP
CHECKED - GMZ
DATE - 4/11/13

REVISIONS:
REVISED -
REVISED -
REVISED -
REVISED -

STATE OF ILLINOIS
DEPARTMENT OF TRANSPORTATION

SCHEDULE OF QUANTITIES, CABLE PLAN, PHASE DESIGNATION DIAGRAM AND EMERGENCY VEHICLE PREEMPTION SEQUENCE
LAKE COOK ROAD AND GREEN BAY ROAD

SCALE: SHEET NO. -- OF -- SHEETS STA. TO STA.

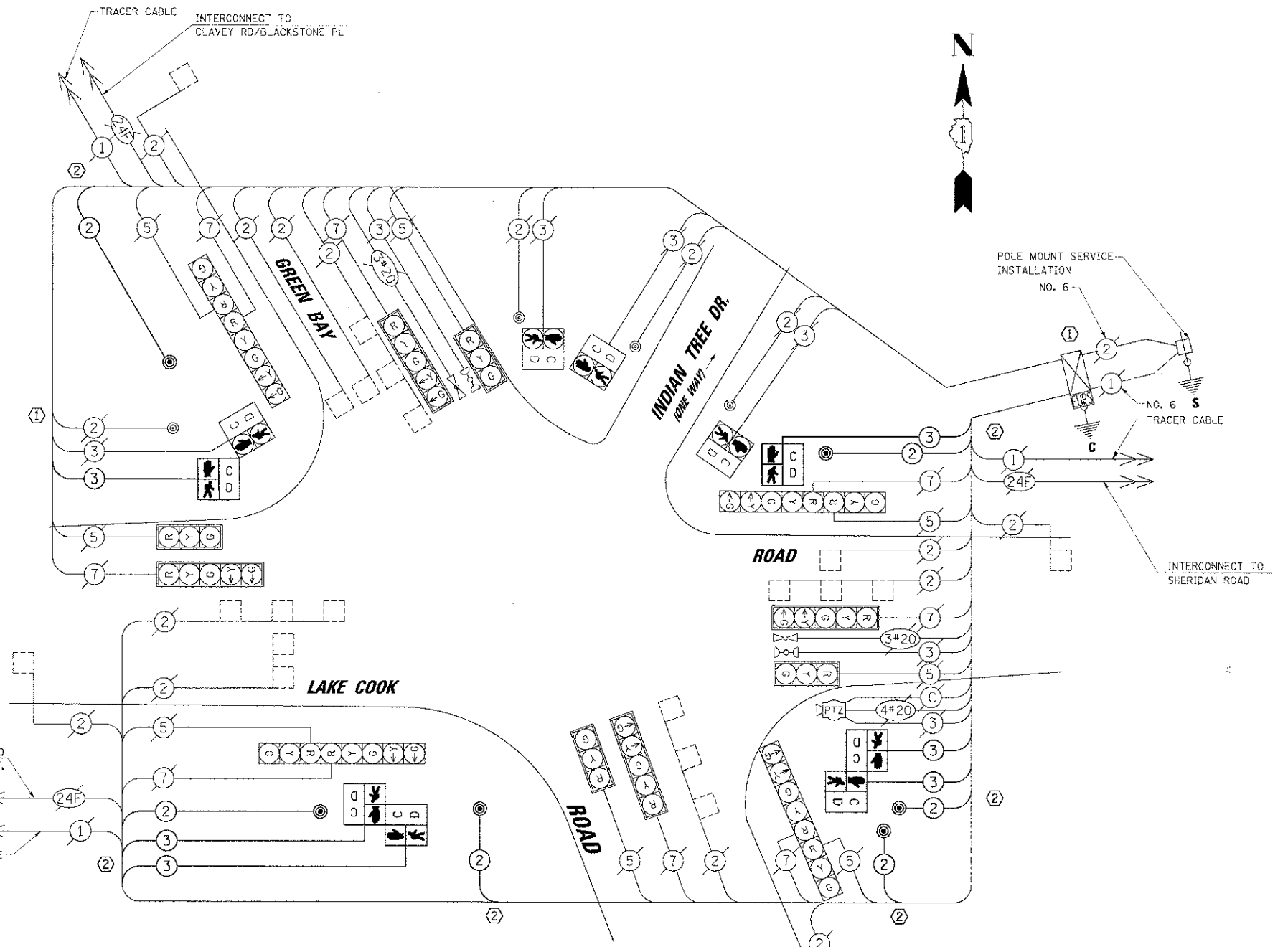

- CONSTRUCTION NOTES:**
- EXISTING PUSHBUTTON WILL OPERATE FOR PHASE 4. MODIFY EXISTING SIGNAL CONTROLLER AND CABINET.
 - ALL PROPOSED PEDESTRIAN SIGNALS, PUSHBUTTON AND SIGNING ASSEMBLIES WILL MATCH THE EXISTING SIGNAL EQUIPMENT. PEDESTRIAN SIGNAL HEADS AND PUSHBUTTONS WILL NOT BE ACTIVATED UNTIL THE MULTI-USE PATH IS OPEN FOR PEDESTRIAN USE.

SCHEDULE OF QUANTITIES

ITEM	UNIT	QTY
PORTLAND CEMENT CONCRETE SIDEWALK 5 INCH	SQ FT	1700
DETECTABLE WARNINGS	SQ FT	151
COMBINATION CURB AND GUTTER REMOVAL	FOOT	85
SIDEWALK REMOVAL	SQ FT	520
TRAFFIC CONTROL AND PROTECTION, STANDARD 701701	L SUM	1
TRAFFIC CONTROL AND PROTECTION, STANDARD 701801	L SUM	1
THERMOPLASTIC PAVEMENT MARKING - LINE 6"	FOOT	416
THERMOPLASTIC PAVEMENT MARKING - LINE 12"	FOOT	250
THERMOPLASTIC PAVEMENT MARKING - LINE 24"	FOOT	80
PAVEMENT MARKING REMOVAL	SQ FT	305
UNDERGROUND CONDUIT, GALVANIZED STEEL, 2 1/2" DIA.	FOOT	64
MAINTENANCE OF EXISTING TRAFFIC SIGNAL INSTALLATION	EACH	1
GROUNDING EXISTING HANDHOLE FRAME AND COVER	EACH	8
ELECTRIC CABLE IN CONDUIT, SIGNAL NO. 14 2C	FOOT	1110
ELECTRIC CABLE IN CONDUIT, SIGNAL NO. 14 3C	FOOT	1250
TRAFFIC SIGNAL POST, 10 FT.	EACH	1
CONCRETE FOUNDATION, TYPE A	FOOT	16
DRILL EXISTING HANDHOLE	EACH	4
PEDESTRIAN SIGNAL HEAD, LED, 1-FACE, BRACKET MOUNTED	EACH	1
PEDESTRIAN SIGNAL HEAD, LED, 2-FACE, BRACKET MOUNTED	EACH	2
PEDESTRIAN PUSH-BUTTON	EACH	6
MODIFY EXISTING CONTROLLER	EACH	1
COMBINATION CONCRETE CURB AND GUTTER, TYPE B (SPEC)	FOOT	85
PEDESTRIAN PUSH-BUTTON POST, TYPE A	EACH	3