

MATCHLINE STA. 112+00
SEE SHEET 12

MATCHLINE STA. 117+50
(SEE BELOW)

MATCHLINE STA. 117+50
(SEE ABOVE)

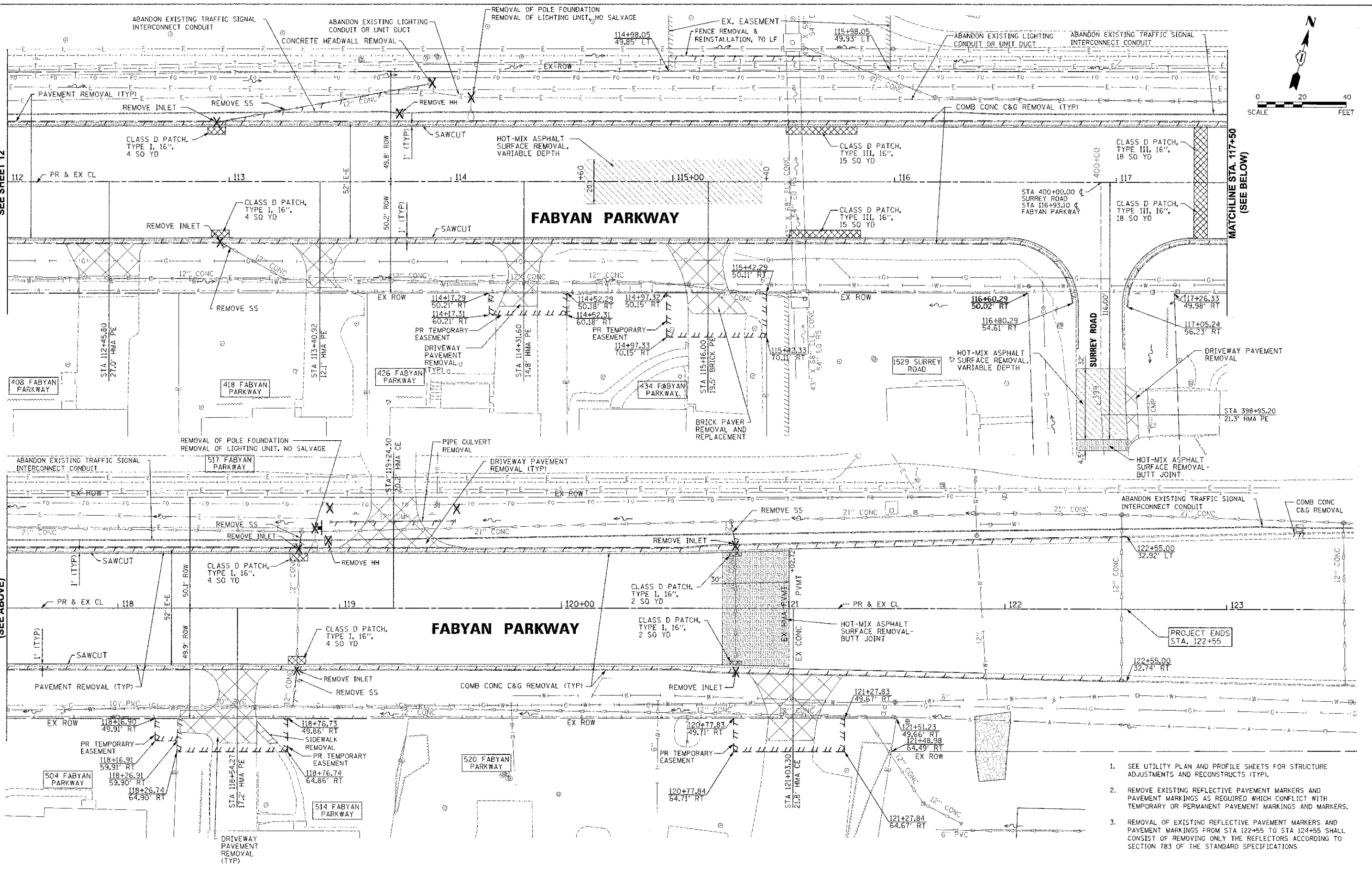

1. SEE UTILITY PLAN AND PROFILE SHEETS FOR STRUCTURE ADJUSTMENTS AND RECONSTRUCTS (TYP).
2. REMOVE EXISTING REFLECTIVE PAVEMENT MARKERS AND PAVEMENT MARKINGS AS REQUIRED WHICH CONFLICT WITH TEMPORARY OR PERMANENT PAVEMENT MARKINGS AND MARKERS.
3. REMOVAL OF EXISTING REFLECTIVE PAVEMENT MARKERS AND PAVEMENT MARKINGS FROM STA 122+55 TO STA 124+55 SHALL CONSIST OF REMOVING ONLY THE REFLECTORS ACCORDING TO SECTION 783 OF THE STANDARD SPECIFICATIONS

Project: 2112013 305569 Pw By: schmidt

Engineering Enterprises, Inc.
CONSULTING ENGINEERS
52 Wheeler Road
Sugar Grove, Illinois 60054
630.496.6700 / www.eeinc.com

**KANE COUNTY DIVISION
OF TRANSPORTATION**
41W011 BURLINGTON ROAD
ST. CHARLES, IL 60175

DESIGNED J.W. SWAN
DRAWN JPS
CHECKED JRL
DATE 12/7/12

REVISED PS 02/04/13
REVISED -
REVISED -
REVISED -

**STATE OF ILLINOIS
DEPARTMENT OF TRANSPORTATION**

**FABYAN PARKWAY
REMOVAL PLAN**

SCALE: 1"=20' SHEET NO. 2 OF 2 SHEETS STA. 112+00 TO STA. 123+50

F.A.P. RTE.	SECTION	COUNTY	TOTAL SHEETS	SHEET NO.
363	10-00404-00-CH	KANE	59	13
C-91-496-10		CONTRACT NO. 63818		
ILLINOIS FED. AID PROJECT CMM-90036271				