

**CONSTRUCTION STAGING LEGEND**

- TYPE II BARRICADE OR DRUM WITH STEADY BURN LIGHT AT 50' C/C (TYP.) ; 25' C/C ON TAPERS; 10' C/C AT INTERSECTION RETURNS AND DRIVEWAYS
- ▨ WORK ZONE
- ➔ DIRECTION OF TRAFFIC MOVEMENT
- ⊥ TYPE III BARRICADE WITH 2 2-WAY FLASHING LIGHTS
- ⊥ TEMPORARY INFORMATION SIGN/TRAFFIC CONTROL SIGN

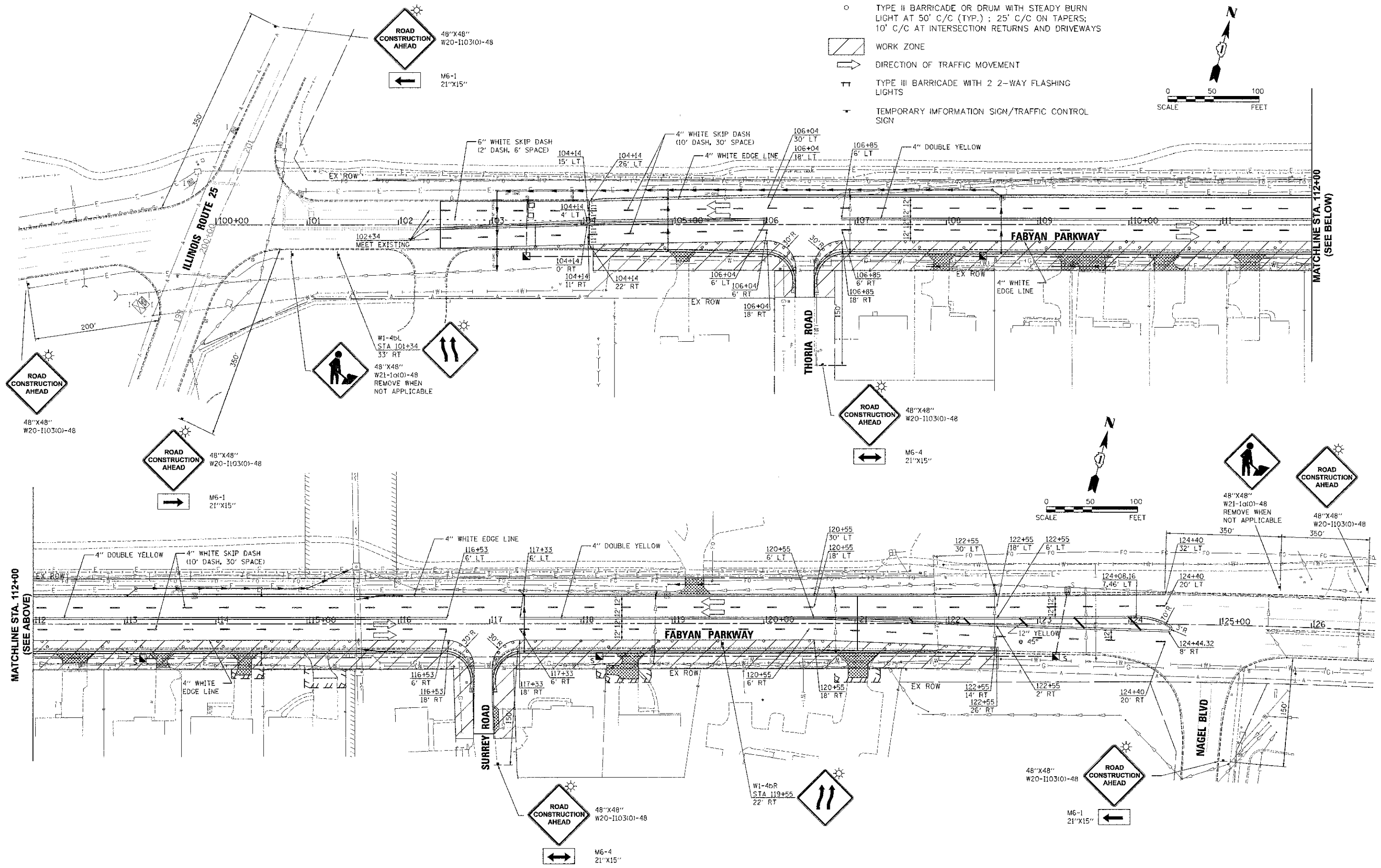
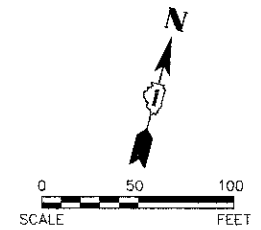

10/25/12 10:54:01 AM By: jschmidt

**Engineering Enterprises, Inc.**  
 CONSULTING ENGINEERS  
 52 Wheeler Road  
 Sugar Grove, Illinois 60054  
 630.466.6700 / www.eelweb.com

**KANE COUNTY DIVISION  
 OF TRANSPORTATION**  
 41W011 BURLINGTON ROAD  
 ST. CHARLES, IL 60175

|          |          |
|----------|----------|
| DESIGNED | TVM, SWM |
| DRAWN    | JPS      |
| CHECKED  | JRL      |
| DATE     | 12/7/12  |

|         |              |
|---------|--------------|
| REVISED | JPS 02/04/13 |
| REVISED | JPS 03/01/13 |
| REVISED | -            |
| REVISED | -            |

**STATE OF ILLINOIS  
 DEPARTMENT OF TRANSPORTATION**

**FABYAN PARKWAY  
 SUGGESTED CONSTRUCTION STAGING PLAN - STAGE 2**

SCALE: 1"=50'    SHEET NO. 4 OF 4 SHEETS    STA. 100+00 TO STA. 124+50

|  |                |                    |              |           |
|--|----------------|--------------------|--------------|-----------|
| F.A.P. RTE.                            | SECTION        | COUNTY             | TOTAL SHEETS | SHEET NO. |
| 363                                    | 10-00404-00-CH | KANE               | 59           | 22        |
| C-91-496-10                            |                | CONTRACT NO. 63818 |              |           |
| ILLINOIS FED. AID PROJECT CMM-90036271 |                |                    |              |           |