

MATCHLINE STA. 112+00  
SEE SHEET 23

MATCHLINE STA. 117+50  
(SEE BELOW)

MATCHLINE STA. 117+50  
(SEE ABOVE)

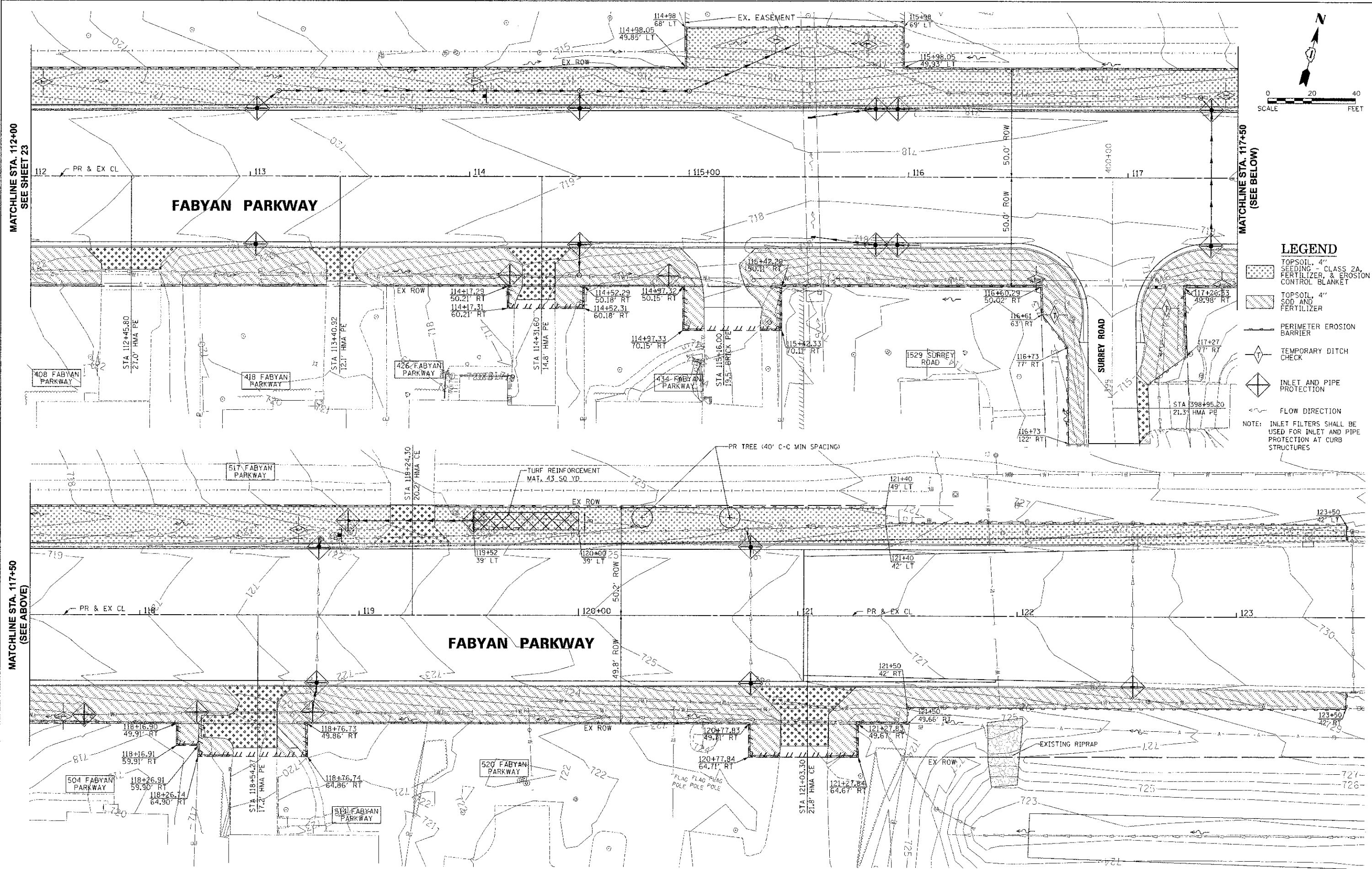

- LEGEND**
- TOPSOIL, 4" SEEDING - CLASS 2A, FERTILIZER, & EROSION CONTROL BLANKET
  - TOPSOIL, 4" SOD AND FERTILIZER
  - PERIMETER EROSION BARRIER
  - TEMPORARY DITCH CHECK
  - INLET AND PIPE PROTECTION
  - FLOW DIRECTION
- NOTE: INLET FILTERS SHALL BE USED FOR INLET AND PIPE PROTECTION AT CURB STRUCTURES

**Engineering Enterprises, Inc.**  
CONSULTING ENGINEERS  
32 Wheeler Road  
Sugar Grove, Illinois 60054  
630.466.6700 / www.eeieeb.com

**KANE COUNTY DIVISION  
OF TRANSPORTATION**  
41W011 BURLINGTON ROAD  
ST. CHARLES, IL 60175

DESIGNED J.V. SWM  
DRAWN J.P.S.  
CHECKED J.R.L.  
DATE 12/17/12

REVISED J.P.S. 02/04/13  
REVISED -  
REVISED -  
REVISED -

**STATE OF ILLINOIS  
DEPARTMENT OF TRANSPORTATION**

**FABYAN PARKWAY  
EROSION CONTROL AND LANDSCAPING PLAN**

SCALE: 1"=20'  
SHEET NO. 2 OF 3 SHEETS  
STA. 112+00 TO STA. 123+50

F.A.P. RTE.	SECTION	COUNTY	TOTAL SHEETS	SHEET NO.
363	10-00404-00-CH	KANE	59	24
C-91-496-10		CONTRACT NO. 63818		
ILLINOIS FED. AID PROJECT CMM-90036271				

P:\112001\112001.dwg 10/21/12 AM 8:45:58 PM J.S.M.

C:\Users\jpsmith\Documents\112001.dwg 10/21/12 AM 8:45:58 PM J.S.M.