

STATE OF ILLINOIS  
DEPARTMENT OF TRANSPORTATION  
DIVISION OF HIGHWAYS

F. A. C. S. E.	SECTION	COUNTY	TOTAL SHEETS	SHEET NO.
2796	12-00095-00-RS	COOK	14	01
STA. TO STA.				
FED. ROAD DIST. NO. 1	ILLINOIS	FED. AID PROJECT	M-4003(132)	

CONTRACT #63835

INDEX OF SHEETS

- COVER SHEET, INDEX OF SHEETS & STATE STANDARDS
- SUMMARY OF QUANTITIES & GENERAL NOTES
- TYPICAL CROSS SECTIONS
- 5. PAVEMENT PLAN
- 7. PAVEMENT MARKINGS
- 14. IDOT DISTRICT 1 STANDARD DETAILS

HIGHWAY STANDARDS

- 000001-06 STANDARD SYMBOLS, ABBREVIATIONS AND PATTERNS
- 442201-03 CLASS C AND D PATCHES
- 602301-03 INLET, TYPE A
- 606001-05 CONCRETE CURB TYPE B AND COMBINATION CONCRETE CURB AND GUTTER
- 701501-06 URBAN LANE CLOSURE, 2L, 2W, UNDIVIDED
- 701502-05 URBAN LANE CLOSURE, 2L, 2W WITH BIDIRECTIONAL LEFT TURN LANE
- 701901-02 TRAFFIC CONTROL DEVICES
- 781001-03 TYPICAL APPLICATIONS RAISED REFLECTIVE PAVEMENT MARKERS

PLANS FOR PROPOSED  
FEDERAL AID HIGHWAY

FAU 2796 (CENTRAL AVENUE)  
FAU 2796 (122ND STREET) TO  
FAU 1583(115TH STREET)  
ROADWAY RESURFACING  
SECTION NO.: 12-00095-00-RS  
PROJECT NO. : M-4003(132)  
VILLAGE of ALSIP  
COOK COUNTY  
JOB NO. C-91-143-13

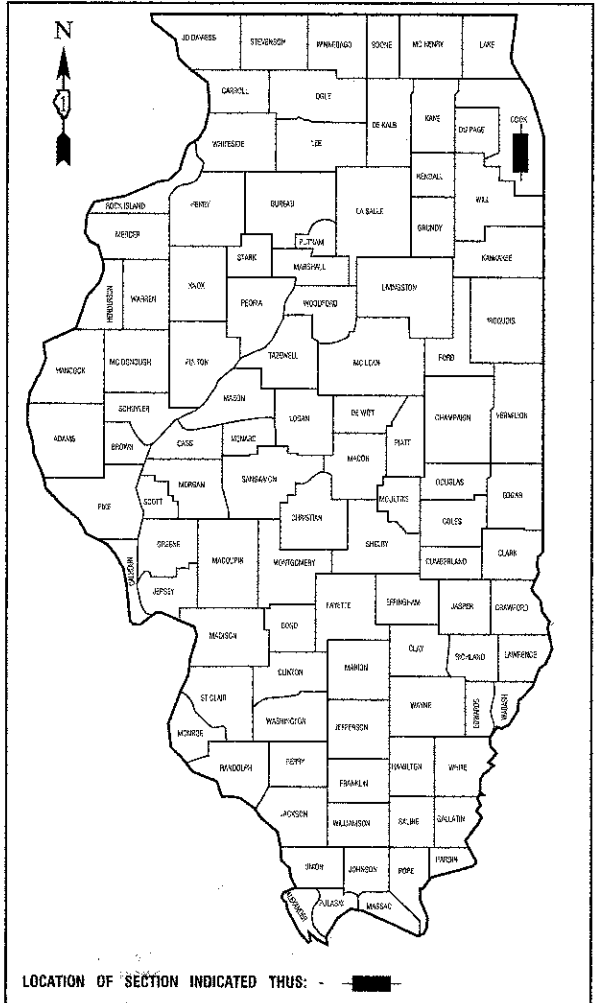

CENTRAL AVENUE

2010 ADT -	1500
2040 ADT -	1500
POSTED SPEED LIMIT -	30 mph
DESIGN PERIOD -	30 YEARS
DESIGN SPEED LIMIT -	30 mph
DESIGN DESIGNATION -	URBAN, COLLECTOR

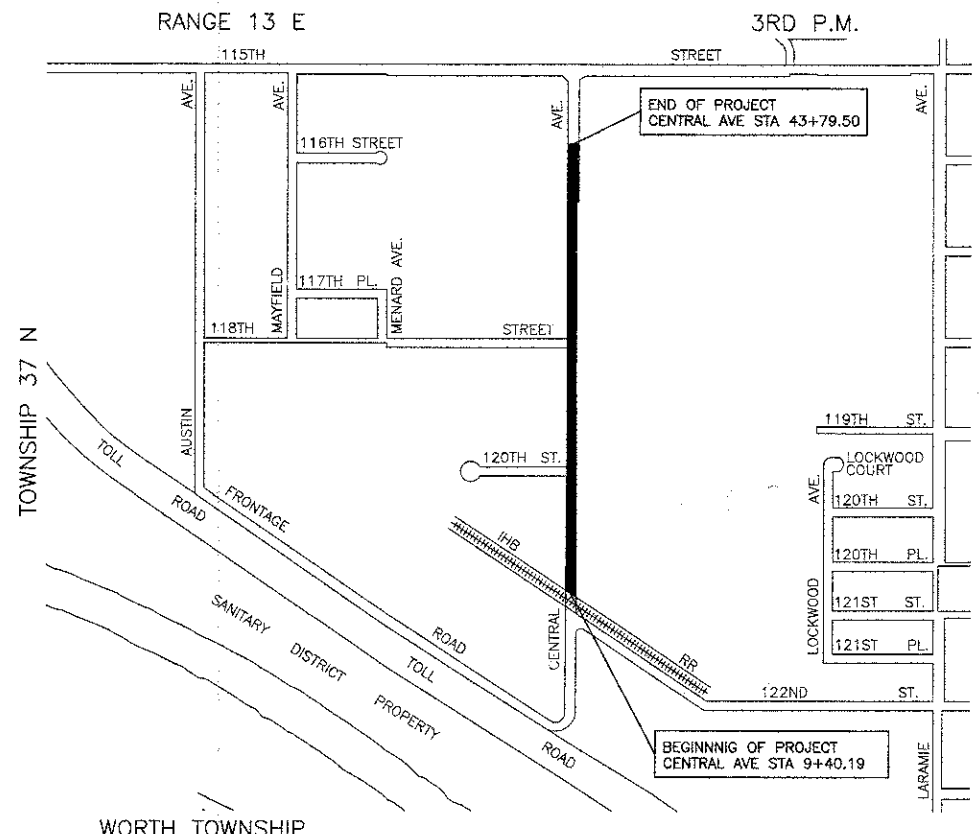
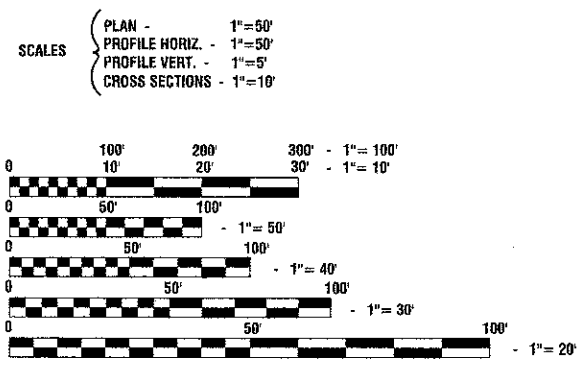

LOCATION MAP

GROSS LENGTH=3,439.31 FEET=0.65 MILES  
NET LENGTH=3,439.31 FEET=0.65 MILES

FULL SIZE PLANS HAVE BEEN PREPARED USING STANDARD ENGINEERING SCALES, REDUCED SIZED PLANS WILL NOT CONFORM TO STANDARD SCALES, IN MAKING MEASUREMENTS ON REDUCED PLANS, THE ABOVE SCALES MAY BE USED.

J. U. L. I. E.  
JOINT UTILITY LOCATION INFORMATION FOR EXCAVATION  
1-800-892-0123 or 811

CONTRACT NO. 63835

STATE OF ILLINOIS DEPARTMENT OF TRANSPORTATION  
DIVISION OF HIGHWAYS

Approved: *[Signature]*  
President, Village of Alsip

Passed: *[Signature]* APRIL 4, 2013  
District 1, Engineer of Local Roads & Streets

Released for Bid Based on Limited Review: *[Signature]* April 10, 2013  
Deputy Director of Highways, Region 1 Engineer

PRINTED BY THE AUTHORITY OF  
THE STATE OF ILLINOIS

PREPARED BY OR UNDER THE  
DIRECT SUPERVISION OF:

*[Signature]*  
THOMAS R. LANG  
67-3845  
REGISTERED  
PROFESSIONAL  
ENGINEER  
STATE OF ILLINOIS  
LICENSE EXPIRES: 11/20/13

PROGRAM AND OFFICE ENGINEER: CHARLES F. RIDDLE, PE (847)705-4406 SCHAMBOURG, IL  
CONSULTANTS: ROBINSON ENGINEERING, LTD. 708-331-6700