

STATE OF ILLINOIS
DEPARTMENT OF TRANSPORTATION
DIVISION OF HIGHWAYS

**PLANS FOR PROPOSED
FEDERAL AID HIGHWAY**

**112TH STREET - OAK PARK AVE TO NASHVILLE AVE
& 115TH STREET - OAK PARK AVE TO RIDGELAND AVE
SIDEWALK AND SIGNING**

**PROJECT NO.: SRTS-4009(179)
SECTION NO.: 12-00062-00-SW
VILLAGE of WORTH
COOK COUNTY
JOB NO.: C-91-484-12**

F. A. I. D. E. T.	SECTION	COUNTY	TOTAL SHEETS	SHEET NO.
	12-00062-00-SW	COOK	10	1
STA.	TO STA.			
FED. ROAD DIST. NO. 1	LEAVES	FED. AID PROJECT	SRTS-4009(179)	

CONTRACT #63836

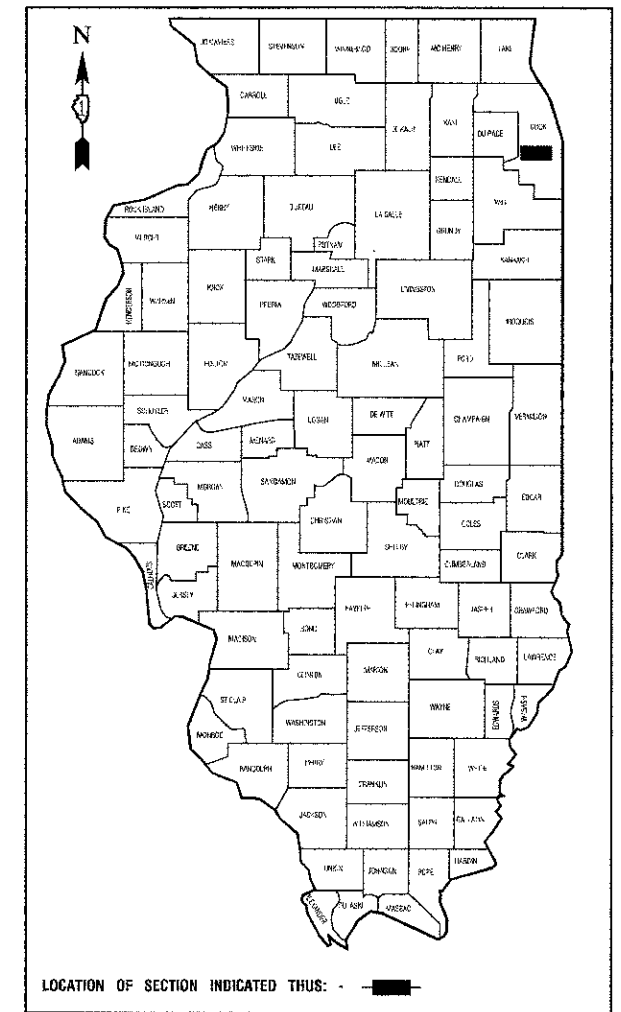

STATE OF ILLINOIS DEPARTMENT OF TRANSPORTATION
DIVISION OF HIGHWAYS

Approved: Randy Kellen
3/21/2013
President, Village of Worth

Passed: APRIL 10, 2013
C. J. Holt
District Engineer of Local Roads & Streets

Released for Bid Based on Limited Review: April 10, 2013
John Fortmann
Deputy Director of Highways, Region 1 Engineer

PRINTED BY THE AUTHORITY OF
THE STATE OF ILLINOIS

PREPARED BY OR UNDER THE DIRECT SUPERVISION OF:
Michael Spola
03/21/2013

62-48647 REGISTERED PROFESSIONAL ENGINEER
STATE OF ILLINOIS
LICENSE EXPIRES: 11/30/13

INDEX OF SHEETS

1. COVER SHEET, INDEX OF SHEETS & HIGHWAY STANDARDS
2. SUMMARY OF QUANTITIES & GENERAL NOTES
3. TYPICAL SECTIONS
- 4-8. SIDEWALK PLAN & PROFILE
- 9-10. DISTRICT 1 DETAILS

HIGHWAY STANDARDS

- 000001-06 STANDARD SYMBOLS, ABBREVIATIONS AND PATTERNS
- 424001-07 PERPENDICULAR CURB RAMPS
- 424011-01 CORNER PARALLEL CURB RAMPS FOR SIDEWALKS
- 606001-05 CONCRETE CURB TYPE B AND COMBINATION CONCRETE CURB AND GUTTER
- 701501-06 URBAN LANE CLOSURE, 2L, 2W, UNDIVIDED
- 701801-05 SIDEWALK, CORNER OR CROSSWALK CLOSURE
- 701901-02 TRAFFIC CONTROL DEVICES
- 280001-07 TEMPORARY EROSION CONTROL SYSTEMS
- 602011-02 CATCH BASIN TYPE C
- 604001-03 FRAME AND LIDS, TYPE 1
- 780001-03 TYPICAL PAVEMENT MARKINGS
- 814001-02 HANDHOLES

SCALES
PLAN - 1"=50'
PROFILE HORIZ. - 1"=50'
PROFILE VERT. - 1"=5'
CROSS SECTIONS - 1"=10'

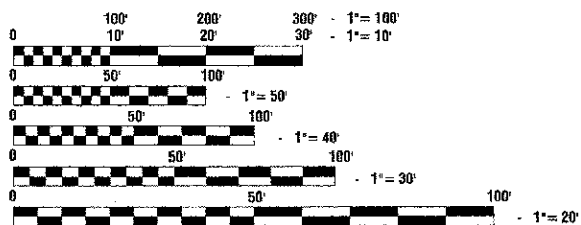

FULL SIZE PLANS HAVE BEEN PREPARED USING STANDARD ENGINEERING SCALES, REDUCED SIZED PLANS WILL NOT CONFORM TO STANDARD SCALES, IN MAKING MEASUREMENTS ON REDUCED PLANS, THE ABOVE SCALES MAY BE USED.

J. U. L. I. E.
JOINT UTILITY LOCATION INFORMATION FOR EXCAVATION
1-800-892-0123 or 811

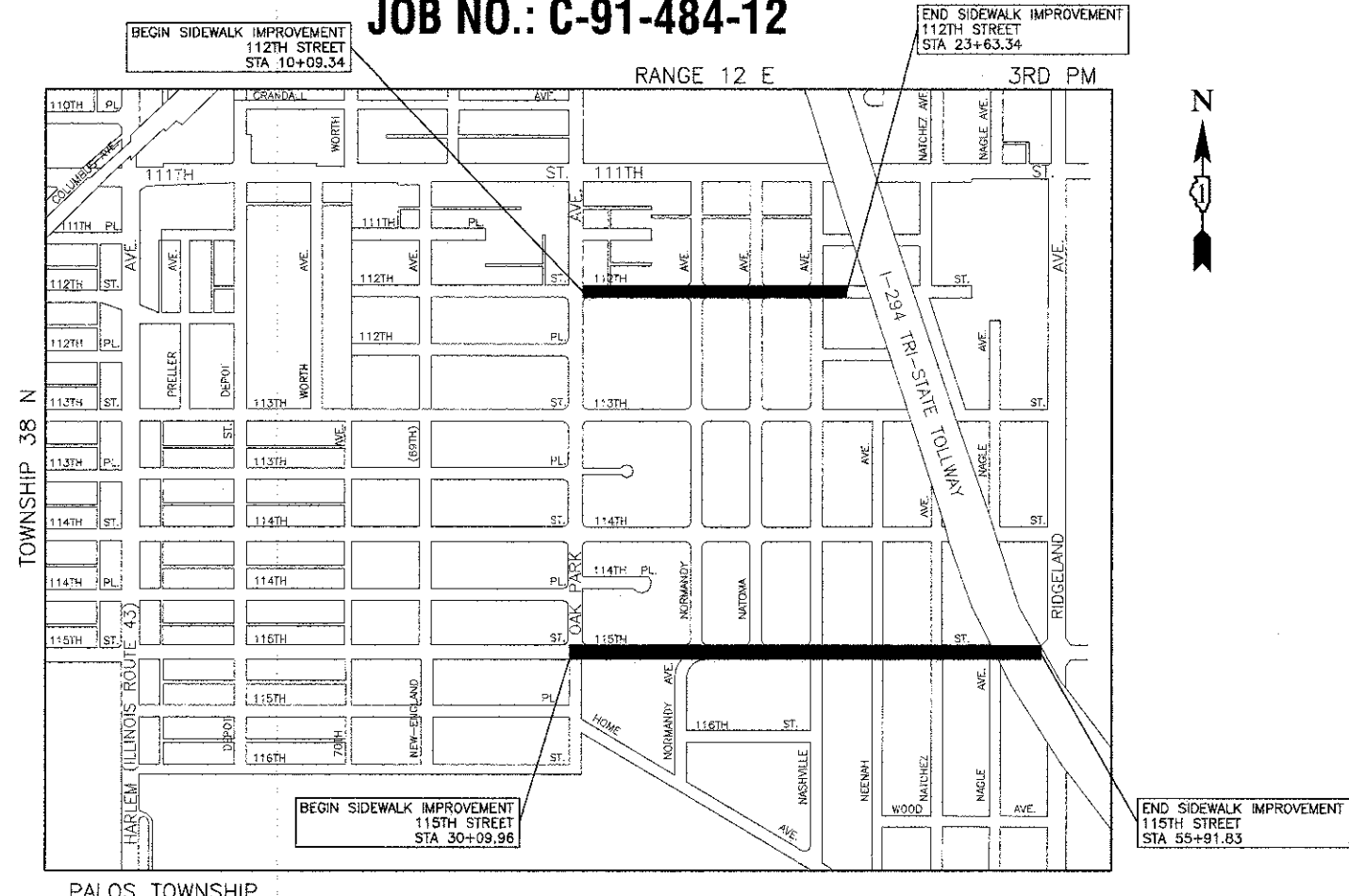

LOCATION MAP

GROSS LENGTH=3,935.87 FEET=0.75 MILES
NET LENGTH=3,935.87 FEET=0.75 MILES

CONTRACT NO. 63836

PROGRAM AND OFFICE ENGINEER: CHARLES F. RIDDLE, P.E. 847-705-4406, SCHAMBURG, IL.
CONSULTANTS: ROBINSON ENGINEERING, LTD. 708-331-6700

DATE	
BY	
DESIGNED	
CHECKED	
PLANNED	
NOTE BOOK	
NO.	

DATE	
BY	
DESIGNED	
CHECKED	
PLANNED	
NOTE BOOK	
NO.	

SUMMARY OF QUANTITIES					CONSTRUCTION TYPE CODE
S.I.	CODE NO.	PAY ITEM	UNIT	TOTAL QUANTITY	021
	20100110	TREE REMOVAL (6 TO 15 UNITS DIAMETER)	UNIT	12	12
	20100210	TREE REMOVAL (OVER 15 UNITS DIAMETER)	UNIT	182	182
	20800150	TRENCH BACKFILL	CUYD	55	55
~	* 21101615	TOPSOIL FURNISH AND PLACE, 4"	SQ YD	4937	4937
~	* 21101695	TOPSOIL FURNISH AND PLACE, 30"	SQYD	70	70
~	* 25000100	SEEDING, CLASS 1	ACRE	1.02	1.02
	28000510	INLET FILTERS	EACH	15	15
~	35101598	AGGREGATE BASE COURSE, TYPE B 3"	SQ YD	1981	1981
	42300200	PORTLAND CEMENT CONCRETE DRIVEWAY PAVEMENT, 6 INCH	SQ YD	34	34
~	42400200	PORTLAND CEMENT CONCRETE SIDEWALK 5 INCH	SQ FT	14590	14590
~	42400300	PORTLAND CEMENT CONCRETE SIDEWALK 6 INCH	SQ FT	3241	3241
~	42400800	DETECTABLE WARNINGS	SQ FT	160	160
	44000200	DRIVEWAY PAVEMENT REMOVAL	SQ YD	762	762
	44000800	SIDEWALK REMOVAL	SQ FT	572	572
~	48101498	AGGREGATE SHOULDERS, TYPE B 4"	SQ YD	2274	2274
~	542D2737	PIPE CULVERTS, CLASS D, TYPE 4 12"	FOOT	270	270
	550A0340	STORM SEWERS, CLASS A, TYPE 2 12"	FOOT	125	125
	56500800	DOMESTIC WATER SERVICE BOXES TO BE ADJUSTED	EACH	24	24
	60206905	CATCH BASINS, TYPE C, TYPE 1 FRAME, OPEN LID	EACH	5	5
	60255500	MANHOLES TO BE ADJUSTED	EACH	2	2
	60260100	INLETS TO BE ADJUSTED	EACH	5	5
	60266600	VALVE BOXES TO BE ADJUSTED	EACH	3	3
	67100100	MOBILIZATION	L SUM	1	1

* - INDICATES SPECIALTY ITEMS
~ - INDICATES SPECIAL PROVISIONS

SUMMARY OF QUANTITIES					CONSTRUCTION TYPE CODE
S.I.	CODE NO.	PAY ITEM	UNIT	TOTAL QUANTITY	021
	70102620	TRAFFIC CONTROL AND PROTECTION, STANDARD 701501	L SUM	1	1
	70102640	TRAFFIC CONTROL AND PROTECTION, STANDARD 701801	L SUM	1	1
	* 78000400	THERMOPLASTIC PAVEMENT MARKING - LINE 6"	FOOT	1082	1082
	* 78000600	THERMOPLASTIC PAVEMENT MARKING - LINE 12"	FOOT	280	280
	* 78000650	THERMOPLASTIC PAVEMENT MARKING - LINE 24"	FOOT	215	215
~	* 89502376	REBUILD EXISTING HANDHOLE	EACH	1	1
~	* B2001616	TREE, CRATAEGUS CRUSGALLI INERMIS (THORN LESS COCKSPUR HAWTHORN), 2" CALIPER, TREE FORM, BALLED AND BURLAPPED	EACH	7	7
~	X2020410	EARTH EXCAVATION (SPECIAL)	CU YD	856	856
~	XX008200	STABILIZED DRIVEWAY PAVEMENT	SQ YD	349	349
~	Z0004542	HOT-MIX ASPHALT REMOVAL (SPECIAL)	SQ YD	100	100
~	Z0004562	COMBINATION CURB AND GUTTER REMOVAL AND REPLACEMENT	FOOT	150	150

* - INDICATES SPECIALTY ITEMS
~ - INDICATES SPECIAL PROVISIONS

GENERAL NOTES:

- UTILITIES INDICATED ON THE PLANS ARE PROVIDED FOR THE CONTRACTORS USE AND ARE BASED UPON INFORMATION AVAILABLE AT THE TIME OF THE ADVERTISEMENT FOR BIDS. THE OWNER AND ENGINEER DO NOT GUARANTEE THE ACCURACY OF UTILITIES INFORMATION.
- BEFORE ANY EXCAVATION, THE CONTRACTOR SHALL CALL "JULIE" AT 1-800-892-0123 FOR FIELD LOCATIONS OF BURIED UTILITIES. (48 HOUR NOTIFICATION IS REQUIRED)
- THE CONTRACTOR SHALL COORDINATE CONSTRUCTION ACTIVITIES WITH UTILITY COMPANIES AND THE VILLAGE OF WORTH.
- BARRICADES: THE CONTRACTOR SHALL PROVIDE AND INSTALL TWO (2) WEIGHTED SANDBAGS ON EACH TYPE I OR TYPE II BARRICADE. USE ONE (1) WEIGHTED SAND BAG ACROSS EACH BOTTOM RAIL.
- ALL PAVEMENT, CURB, SIDEWALK AND DRIVEWAY REMOVALS SHALL BE MADE BY MEANS OF STRAIGHT SAW CUT JOINT. THE COST FOR SAW CUTTING SHALL BE INCLUDED IN THE COST OF THE INDIVIDUAL ITEMS BEING REMOVED
- THE CONTRACTOR MAY PROSECUTE WORK BETWEEN THE HOURS OF 7:00 A.M. AND DUSK EACH WORKDAY. NO WORK WILL BE PERMITTED ON SUNDAYS, OR ON HOLIDAYS, WITHOUT PRIOR WRITTEN PERMISSION FROM THE ENGINEER.

FILE NAME = 12402-QUAN-01 - IDOT P21

USER NAME -	DESIGNED -- MRS	REVISED --
	CHECKED -- PKB	REVISED --
PLOT SCALE - N/A	DRAWN -- RG	REVISED --
PLOT DATE - 3-21-13	CHECKED -- AG	REVISED --

STATE OF ILLINOIS
DEPARTMENT OF TRANSPORTATION

SIDEWALK IMPROVEMENTS SUMMARY OF QUANTITIES VILLAGE OF WORTH		F.A.U. RTE.	SECTION	COUNTY	TOTAL SHEETS	SHEET NO.
SCALE: NONE		SHEET NO. 2	OF 10 SHEETS	STA.	TO STA.	
		12-00062-00-SW		COOK	10	2
				CONTRACT NO. 63836		
		ILLINOIS		FED. AID PROJECT		SRTS-4009(179)

DATE	
BY	
SURVEYED	
PLOTTED	
CHECKED	
DATE	
PLAN	
NOTE BOOK	
NO.	

DATE	
BY	
SURVEYED	
PLOTTED	
CHECKED	
DATE	
PROFILE	
NOTE BOOK	
NO.	

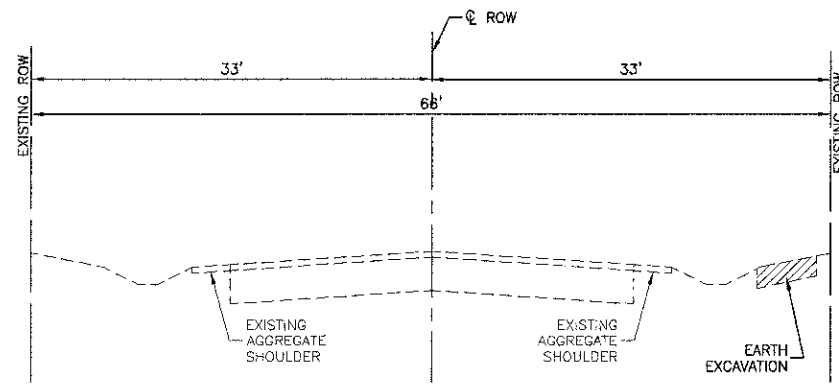

EXISTING TYPICAL SECTION
STA 10+09.34 TO STA 23+63.34, 112TH STREET

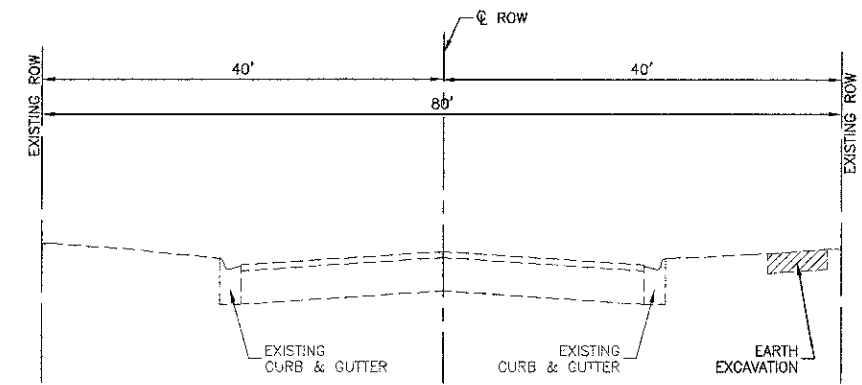

EXISTING TYPICAL SECTION
STA 30+09.96 TO STA 55+91.83, 115TH STREET

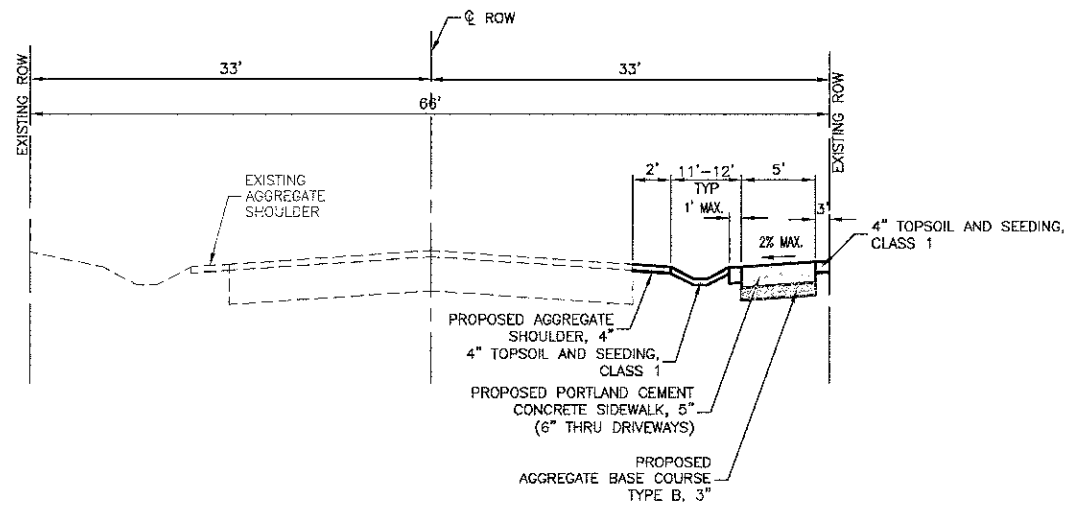

PROPOSED TYPICAL SECTION
STA 10+09.34 TO STA 23+63.34, 112TH STREET

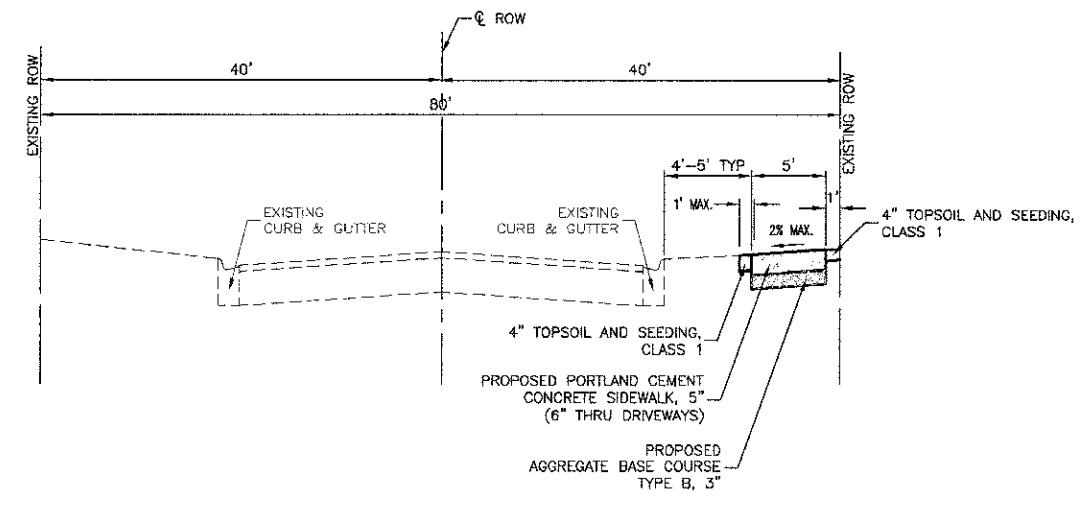

PROPOSED TYPICAL SECTION
STA 30+09.96 TO STA 55+91.83, 115TH STREET

HOT-MIX ASPHALT MIXTURE REQUIREMENTS

MIXTURE TYPE	AIR VOIDS
STABILIZED DRIVEWAY PAVEMENT	
HOT-MIX ASPHALT SURFACE COURSE, MIX "D", N50, (IL 9.5mm) 3"	4% @ 50 GYR

NOTES:
THE UNIT WEIGHT USED TO CALCULATE ALL HMA SURFACE MIXTURE QUANTITIES IS 112 LBS/SY/IN.
THE 'AC TYPE' FOR POLYMERIZED HMA MIXES SHALL BE 'SBS/SBR PG 76-22' AND FOR NON-POLYMERIZED HMA THE 'AC-TYPE' SHALL BE 'PG 64-22' UNLESS MODIFIED BY DISTRICT ONE SPECIAL PROVISIONS. FOR "PERCENT OF RAP" SEE DISTRICT ONE SPECIAL PROVISIONS.

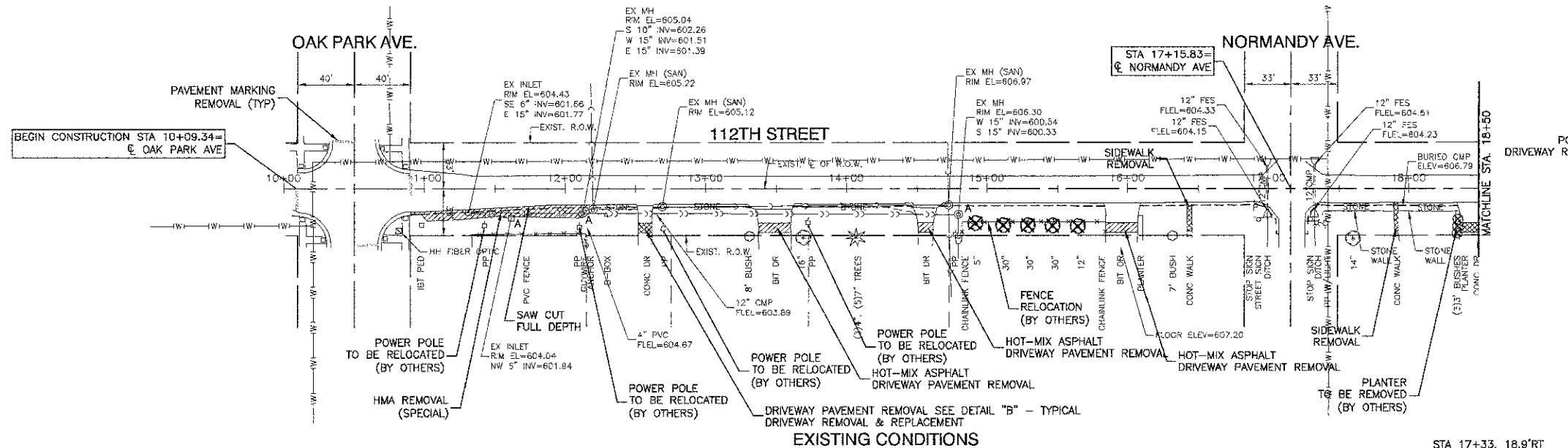

EXISTING CONDITIONS

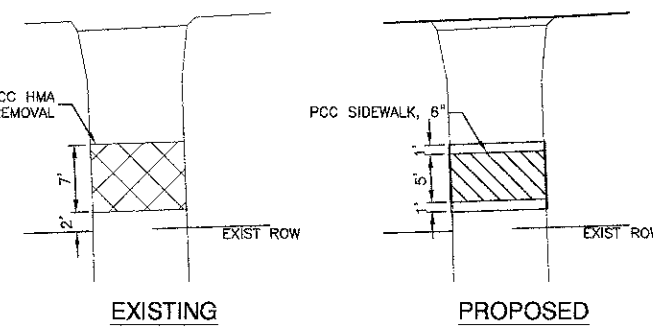

DETAIL "B"
TYPICAL DRIVEWAY REMOVAL AND REPLACEMENT

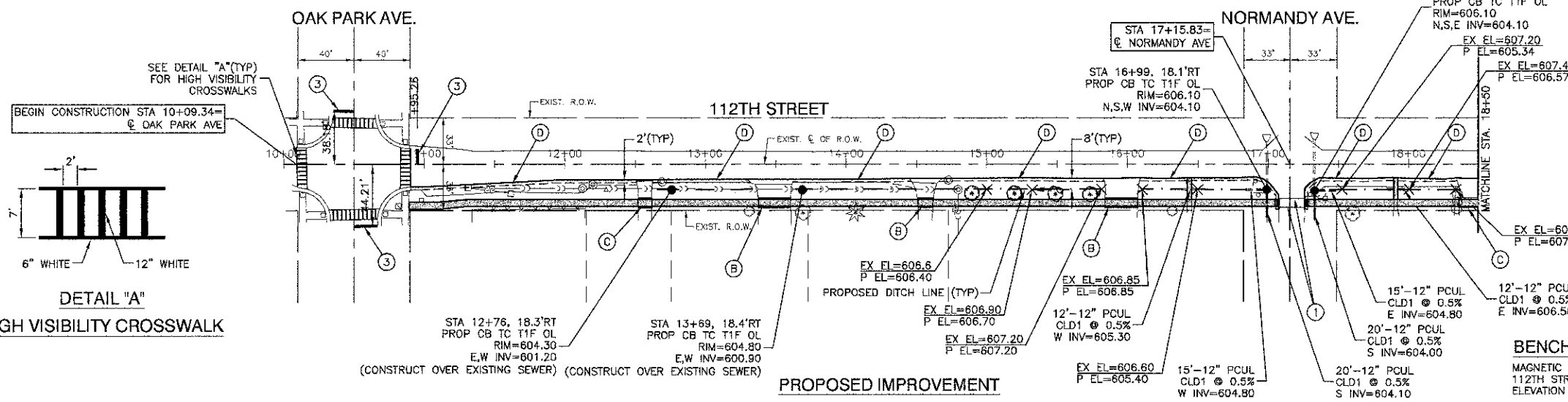

PROPOSED IMPROVEMENT

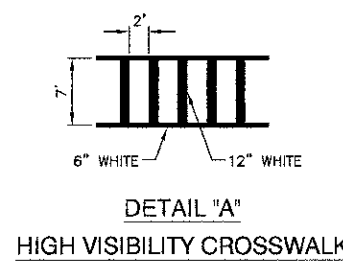

DETAIL "A"
HIGH VISIBILITY CROSSWALK

- LEGEND**
- CURB REMOVAL & REPLACEMENT
 - PCC SIDEWALK OR DRIVEWAY REMOVAL
 - PORTLAND CEMENT CONCRETE SIDEWALK, 5" (6" THROUGH DRIVEWAYS) AGGREGATE BASE COURSE, TYPE B, 3"
 - DETECTABLE WARNINGS
 - A ADJUST STRUCTURE
 - R REMOVE STRUCTURE
 - TREE / SHRUB REMOVAL
 - ① THERMOPLASTIC PAVEMENT MARKING - LINE 6"
 - ② THERMOPLASTIC PAVEMENT MARKING - LINE 12"
 - ③ THERMOPLASTIC PAVEMENT MARKING - LINE 24"
 - ④ STABILIZED DRIVEWAY PAVEMENT, 3"
 - ⑤ PCC DRIVEWAY PAVEMENT, 6"
 - ⑥ AGGREGATE SHOULDERS, TYPE B, 4"
 - ⑦ TREE - THORNLESS COCKSPUR HAWTHORN, 2" CALIPER

BENCH MARK:
MAGNETIC SURVEY NAIL SET AT THE NORTHWEST CORNER
112TH STREET AND NASHVILLE AVENUE.
ELEVATION = 609.91

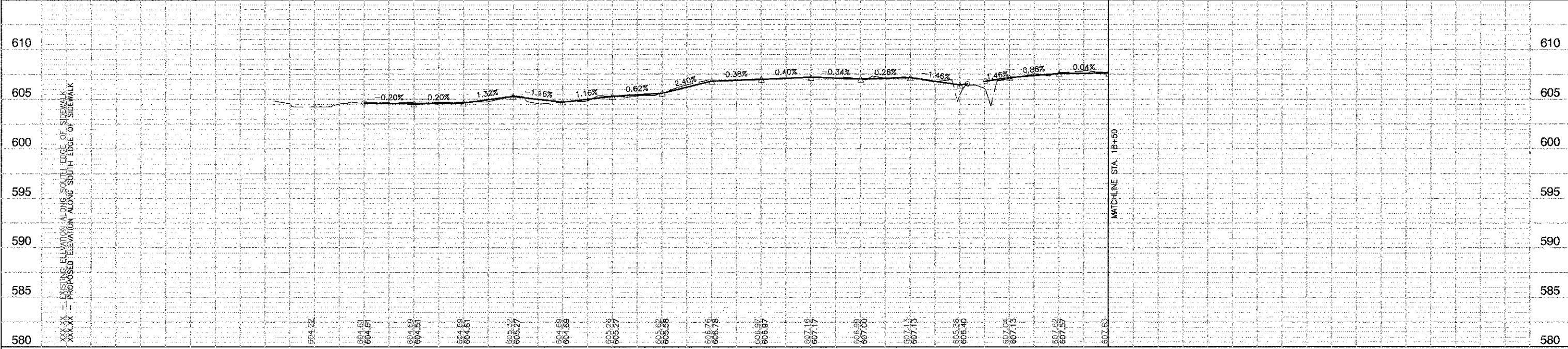

FILE NAME = ACAD:1242:PLR01 - IDOT.PDI	USER NAME =	DESIGNED = MRS	REVISED =	STATE OF ILLINOIS DEPARTMENT OF TRANSPORTATION	SIDEWALK IMPROVEMENTS PLAN & PROFILE VILLAGE OF WORTH	SCALE: H 1"=50' V 1"=5'	SHEET NO. 4	OF 10 SHEETS	STA. TO STA.	F.A.U. RTE.	SECTION	COUNTY	TOTAL SHEETS	SHEET NO.
	PLOT SCALE = N/A	CHECKED = PKB	REVISED =			12-0062-00-SW	COOK	10	4					
	PLOT DATE = 3-21-13	DRAWN = PS	REVISED =			CONTRACT NO. 63836								
		CHECKED = AG	REVISED =			FED. ROAD DIST. NO. 1		ILLINOIS		FED. AID PROJECT SRTS-4009(175)				

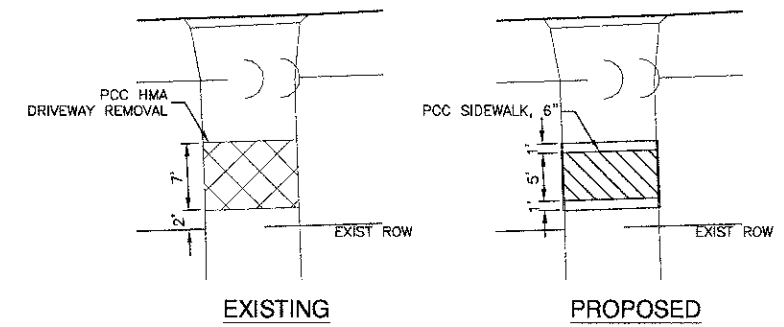
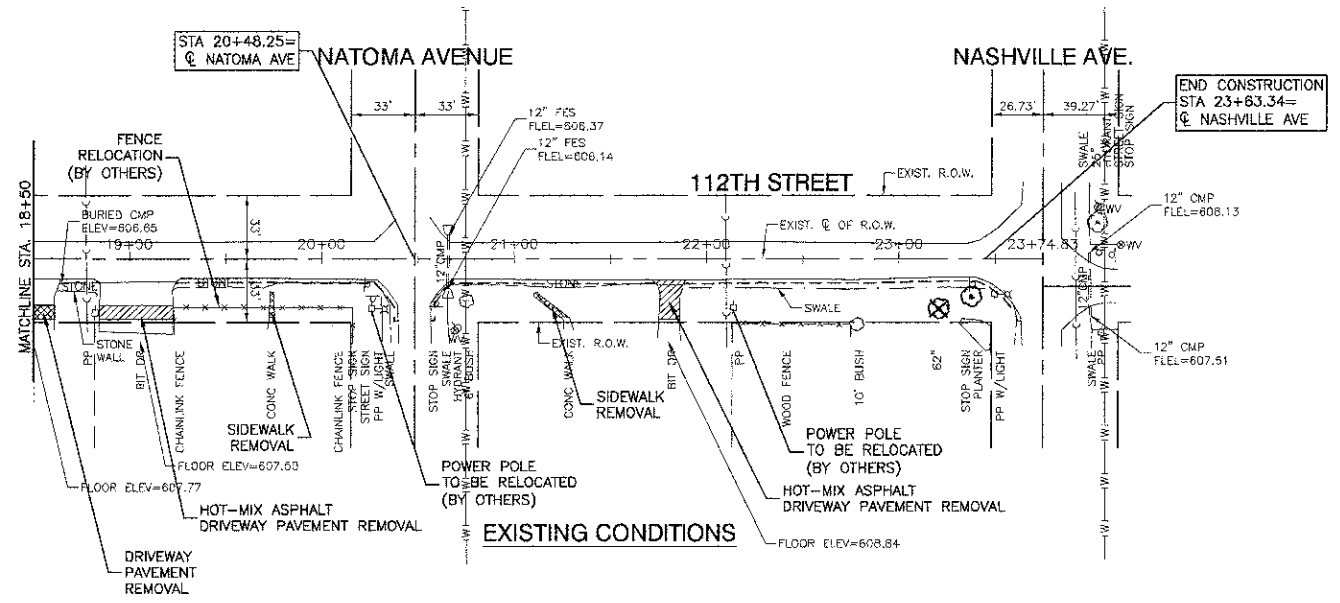

EXISTING PROPOSED
 DETAIL "B"
 TYPICAL DRIVEWAY REMOVAL AND REPLACEMENT

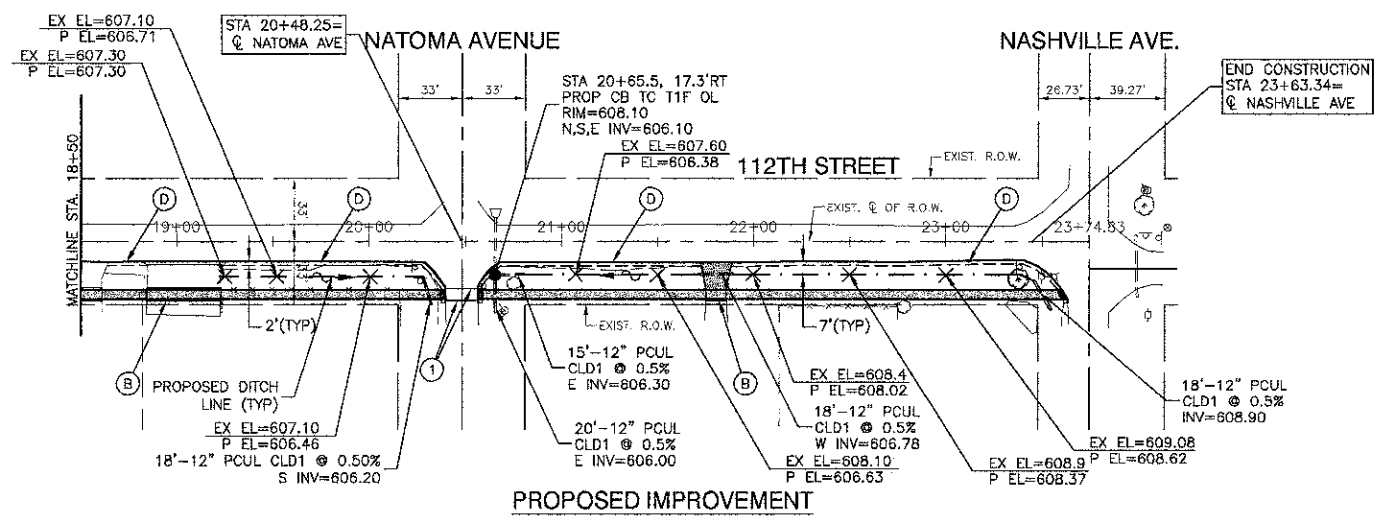

- LEGEND**
- CURB REMOVAL & REPLACEMENT
 - PCC SIDEWALK OR DRIVEWAY REMOVAL
 - PORTLAND CEMENT CONCRETE SIDEWALK, 5" (6" THROUGH DRIVEWAYS) AGGREGATE BASE COURSE, TYPE B, 3"
 - DETECTABLE WARNINGS
 - A ADJUST STRUCTURE
 - R REMOVE STRUCTURE
 - TREE / SHRUB REMOVAL
 - ① THERMOPLASTIC PAVEMENT MARKING - LINE 6"
 - ② THERMOPLASTIC PAVEMENT MARKING - LINE 12"
 - ③ THERMOPLASTIC PAVEMENT MARKING - LINE 24"
 - (B) STABILIZED DRIVEWAY PAVEMENT, 3"
 - (C) PCC DRIVEWAY PAVEMENT, 6"
 - (D) AGGREGATE SHOULDERS, TYPE B, 4"
 - (T) TREE - THORNLESS COCKSPUR HAWTHORN, 2" CALIPER

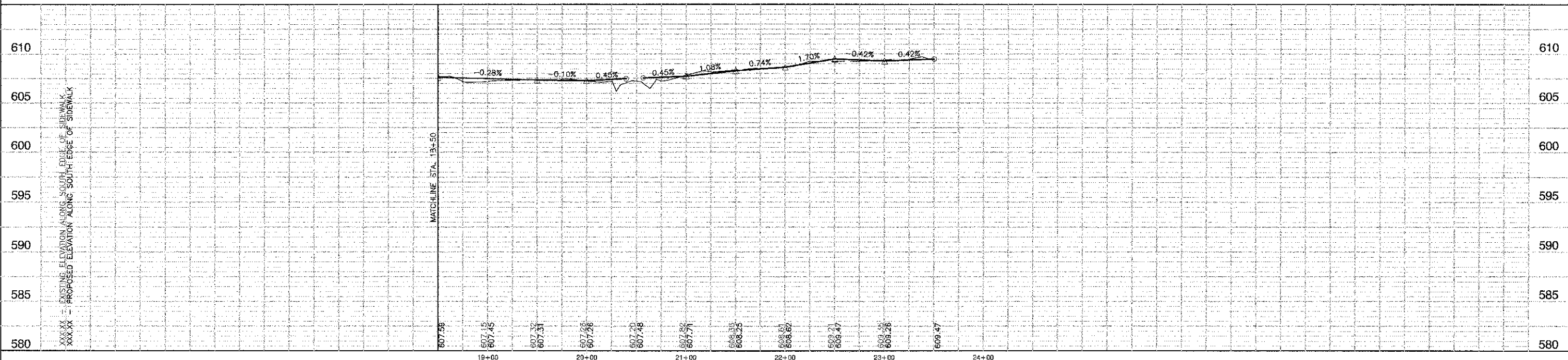

FILE NAME = ACAD-124C2-FLPR01 - IDOT P22	USER NAME =	DESIGNED - MRS	REVISD -	STATE OF ILLINOIS DEPARTMENT OF TRANSPORTATION	SIDEWALK IMPROVEMENTS PLAN & PROFILE VILLAGE OF WORTH	FAU. RTE.	SECTION	COUNTY	TOTAL SHEETS	SHEET NO.	
	CHECKED - PKB	REVISD -				12-0002-00-SW	COOK	10	5		
	PLOT SCALE = N/A	DRAWN - PS	REVISD -			CONTRACT NO. 43836					
	PLOT DATE = 3-21-13	CHECKED - AG	REVISD -			FED. ROAD DIST. NO. 1 ILLINOIS FED. AID PROJECT BRTS-4009(179)					

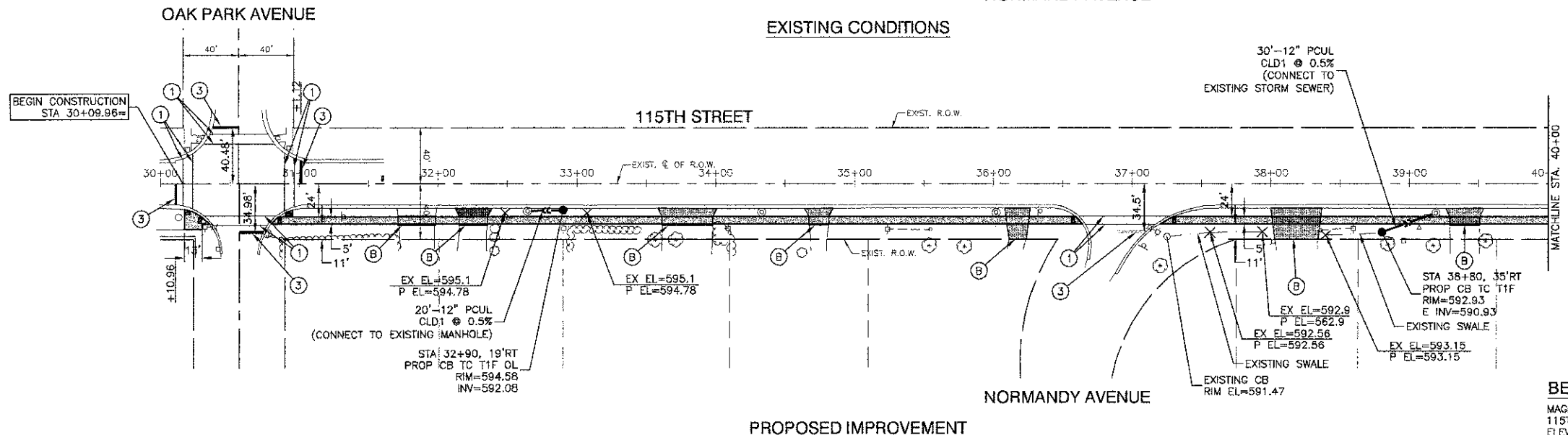
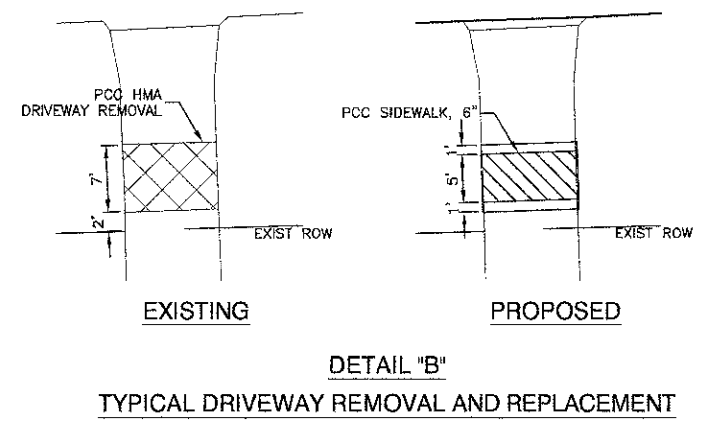
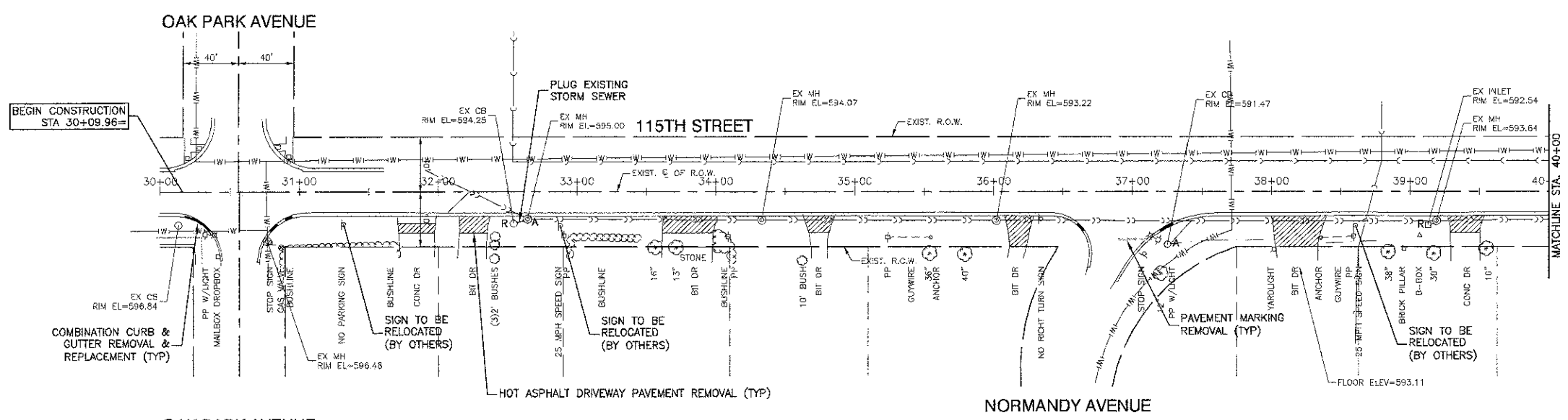
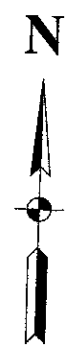

- LEGEND**
- CURB REMOVAL & REPLACEMENT
 - PCC SIDEWALK OR DRIVEWAY REMOVAL
 - PORTLAND CEMENT CONCRETE SIDEWALK, 5" (6" THROUGH DRIVEWAYS) AGGREGATE BASE COURSE, TYPE B, 3"
 - DETECTABLE WARNINGS
 - ADJUST STRUCTURE
 - REMOVE STRUCTURE
 - TREE / SHRUB REMOVAL
 - THERMOPLASTIC PAVEMENT MARKING - LINE 6"
 - THERMOPLASTIC PAVEMENT MARKING - LINE 12"
 - THERMOPLASTIC PAVEMENT MARKING - LINE 24"
 - STABILIZED DRIVEWAY PAVEMENT, 3"
 - PCC DRIVEWAY PAVEMENT, 6"
 - AGGREGATE SHOULDERS, TYPE B, 4"
 - TREE - THORNLESS COCKSPUR HAWTHORN, 2" CALIPER
- BENCH MARK:**
MAGNETIC SURVEY NAIL SET AT THE NORTHEAST CORNER 115TH STREET AND OAK PARK AVENUE. ELEVATION = 596.26

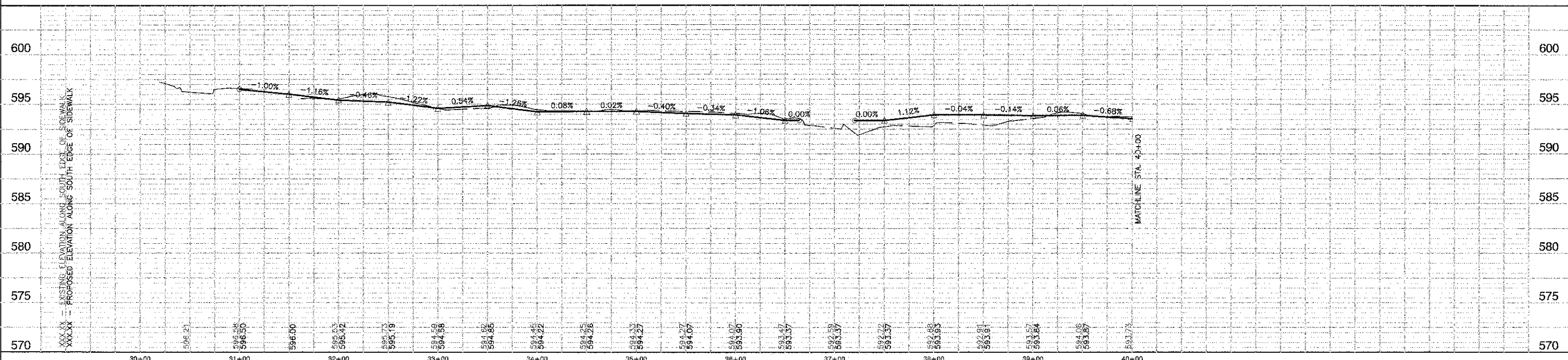

FILE NAME = ACAD-124C2-PLPR01 - IDOT Pcb	USER NAME =	DESIGNED -- MRS	REVISED --	STATE OF ILLINOIS DEPARTMENT OF TRANSPORTATION	SIDEWALK IMPROVEMENTS PLAN & PROFILE VILLAGE OF WORTH		F.A.U. RATE	SECTION	COUNTY	TOTAL SHEETS	SHEET NO.			
	PLOT SCALE = N/A	CHECKED -- PKB	REVISED --		SCALE: H 1"=50' V 1"=5'		SHEET NO. 6	OF 10 SHEETS	STA.	TO STA.	12-00062-00-SW	COOK	10	6
	PLOT DATE = 3-21-13	CHECKED -- AG	REVISED --		FED. ROAD DIST. NO. 1		ILLINOIS	FED. AID PROJECT	3RTS-4009(179)					
CONTRACT NO. 43236														

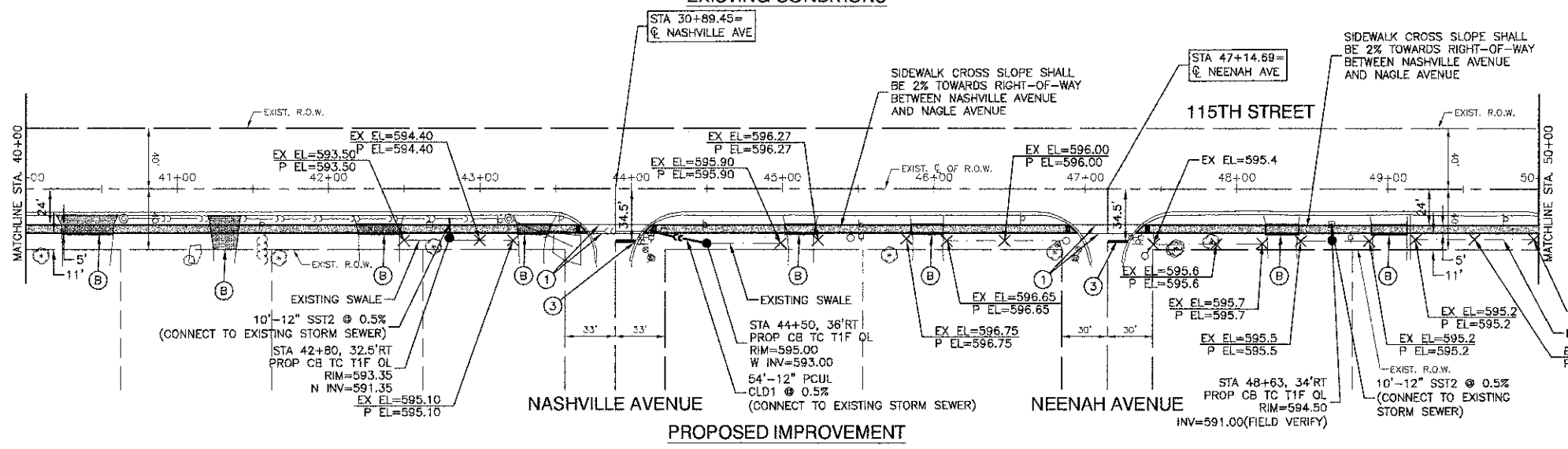
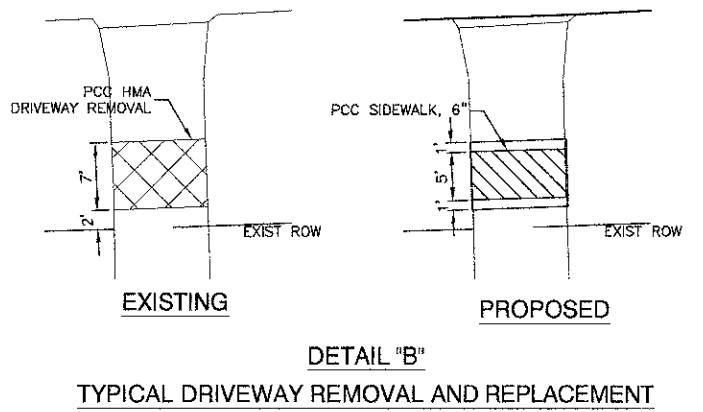
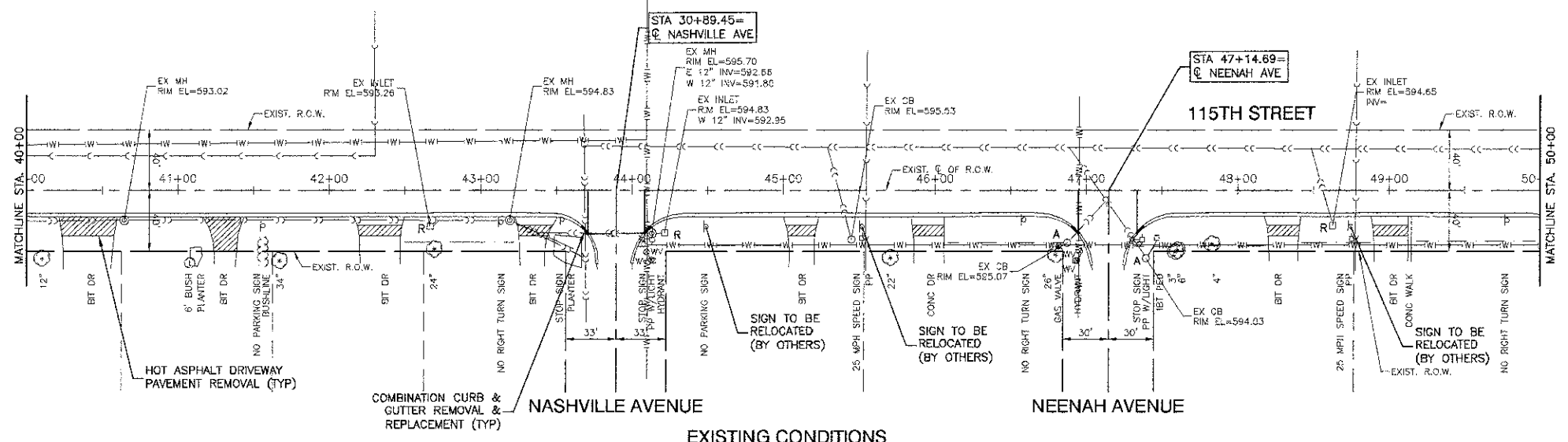
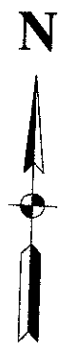

LEGEND

- CURB REMOVAL & REPLACEMENT
- PCC SIDEWALK OR DRIVEWAY REMOVAL
-
- DETECTABLE WARNINGS
- ADJUST STRUCTURE
- REMOVE STRUCTURE
- TREE / SHRUB REMOVAL
-
-
-
-
-
-
-

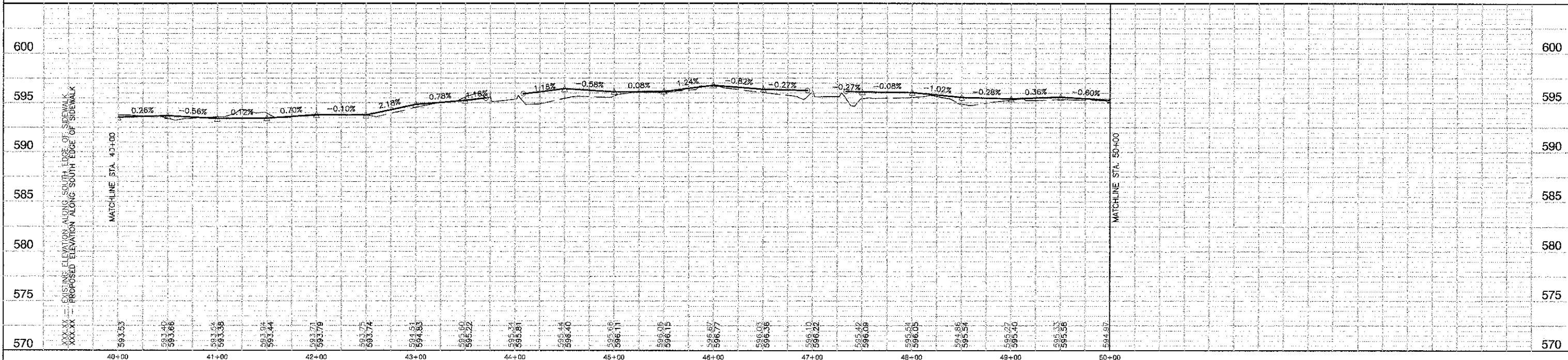

FILE NAME = AGAD-12402-PLPR01 - 1DOT P04	USER NAME =	DESIGNED -- MRS	REVISD --	STATE OF ILLINOIS DEPARTMENT OF TRANSPORTATION	SIDEWALK IMPROVEMENTS PLAN & PROFILE VILLAGE OF WORTH		F.A.U. RTE.	SECTION	COUNTY	TOTAL SHEETS	SHEET NO.
	PLOT SCALE = N/A	CHECKED -- PKB	REVISD --		12-00062-00-SW	COOK	10	7			
	PLOT DATE = 9-21-13	DRAWN -- PS	REVISD --		SCALE: H 1"=60' V 1"=5'		SHEET NO. 7 OF 10 SHEETS		STA.	TO STA.	
		CHECKED -- AG	REVISD --		FED. ROAD DIST. NO. 1		ILLINOIS		FED. AID PROJECT: SRTS-4009(179)		

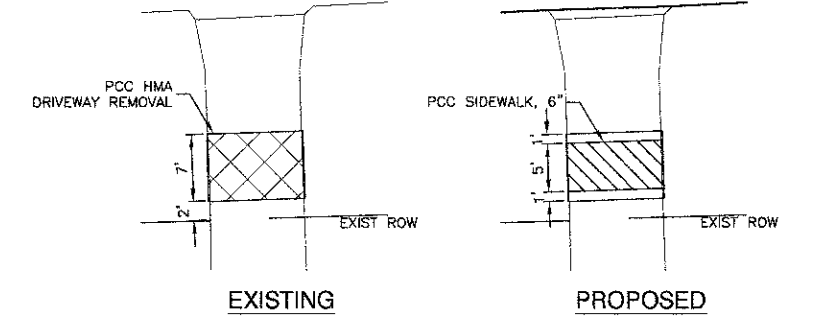
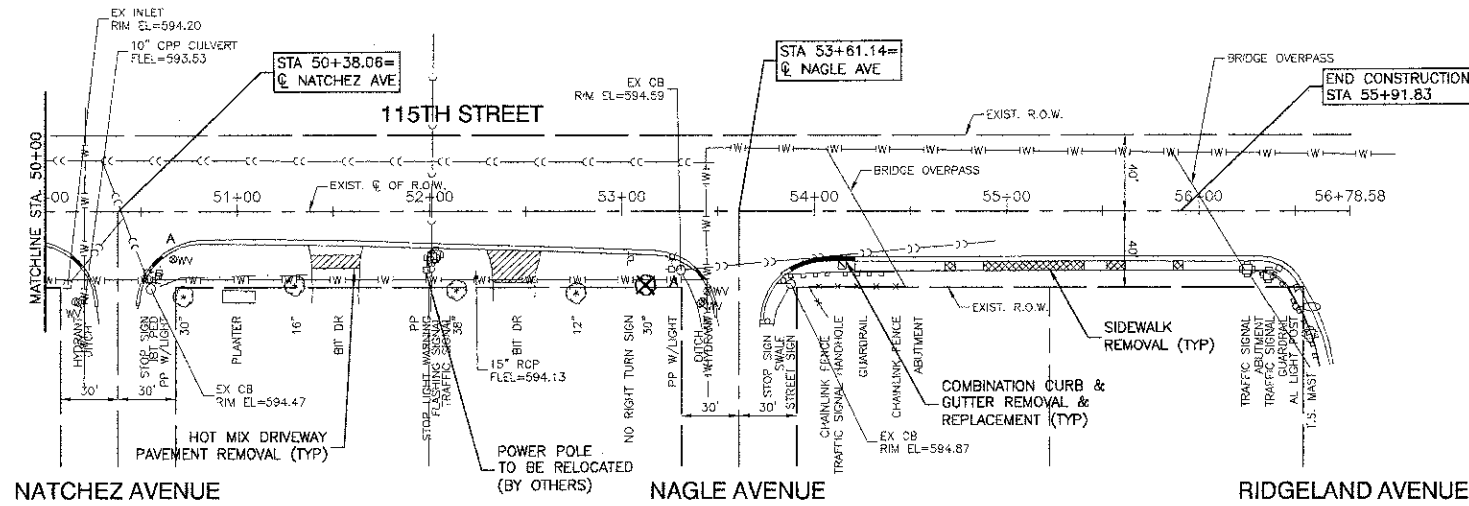
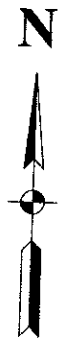

DETAIL "B"
TYPICAL DRIVEWAY REMOVAL AND REPLACEMENT

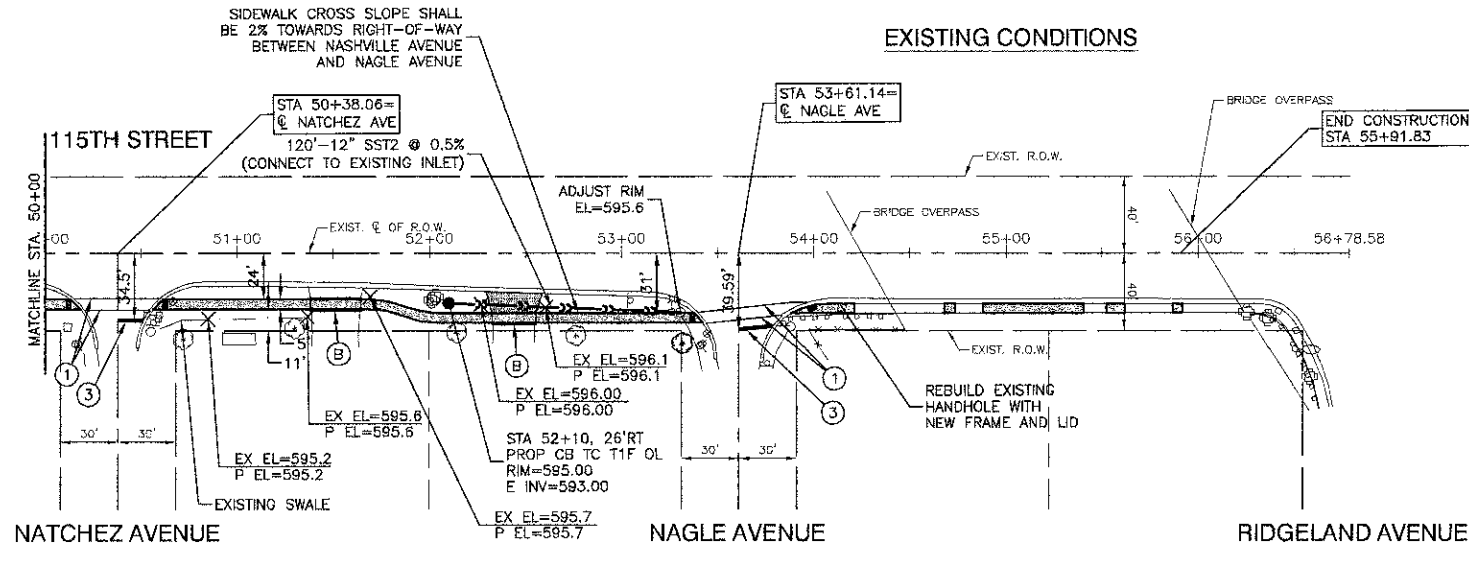

PROPOSED IMPROVEMENT

LEGEND

- CURB REMOVAL & REPLACEMENT
- ▨ PCC SIDEWALK OR DRIVEWAY REMOVAL
- ▩ PORTLAND CEMENT CONCRETE SIDEWALK, 5" (6" THROUGH DRIVEWAYS) AGGREGATE BASE COURSE, TYPE B, 3"
- DETECTABLE WARNINGS
- A ADJUST STRUCTURE
- R REMOVE STRUCTURE
- ⊗ TREE / SHRUB REMOVAL
- ① THERMOPLASTIC PAVEMENT MARKING - LINE 6"
- ② THERMOPLASTIC PAVEMENT MARKING - LINE 12"
- ③ THERMOPLASTIC PAVEMENT MARKING - LINE 24"
- Ⓟ STABILIZED DRIVEWAY PAVEMENT, 3"
- Ⓢ PCC DRIVEWAY PAVEMENT, 6"
- Ⓣ AGGREGATE SHOULDERS, TYPE B, 4"
- Ⓤ TREE - THORNLESS COCKSPUR HAWTHORN, 2" CALIPER

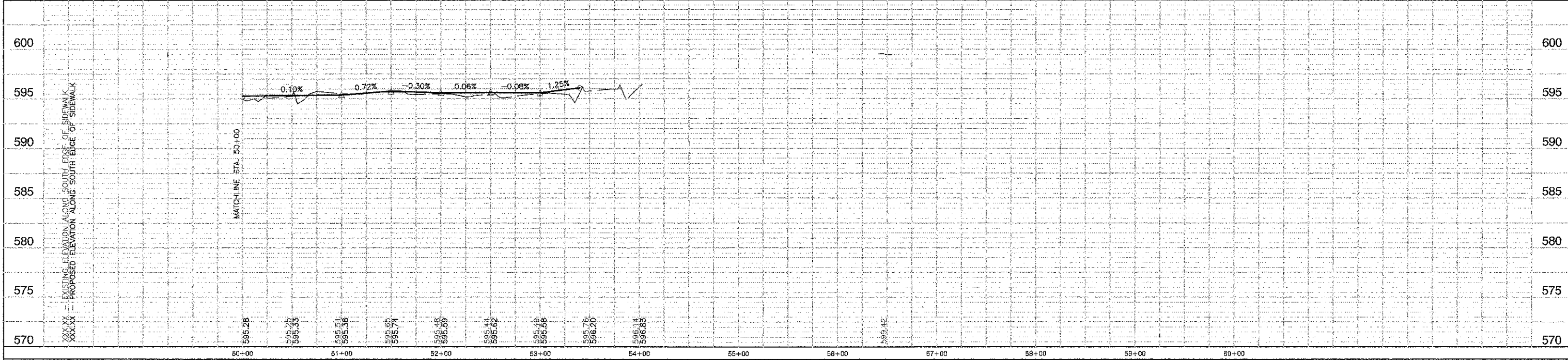

FILE NAME = ACAD:12402\FUPR01 - 1DOT P05	USER NAME =	DESIGNED - MRS	REVISED -	STATE OF ILLINOIS DEPARTMENT OF TRANSPORTATION	SIDEWALK IMPROVEMENTS PLAN & PROFILE VILLAGE OF WORTH			F.A.U. RTE.	SECTION	COUNTY	TOTAL SHEETS	SHEET NO.
	PLOT SCALE = N/A	CHECKED - PKB	REVISED -					12-0062-00-SW	COOK	10	8	
	PLOT DATE = 3-21-13	DRAWN - PS	REVISED -					SHEET NO. 8	OF 10 SHEETS	STA.	TO STA.	CONTRACT NO. 63836
		CHECKED - AG	REVISED -					FED. ROAD DIST. NO. 1	ILLINOIS	FED. AID PROJECT	SRTS-4008(179)	

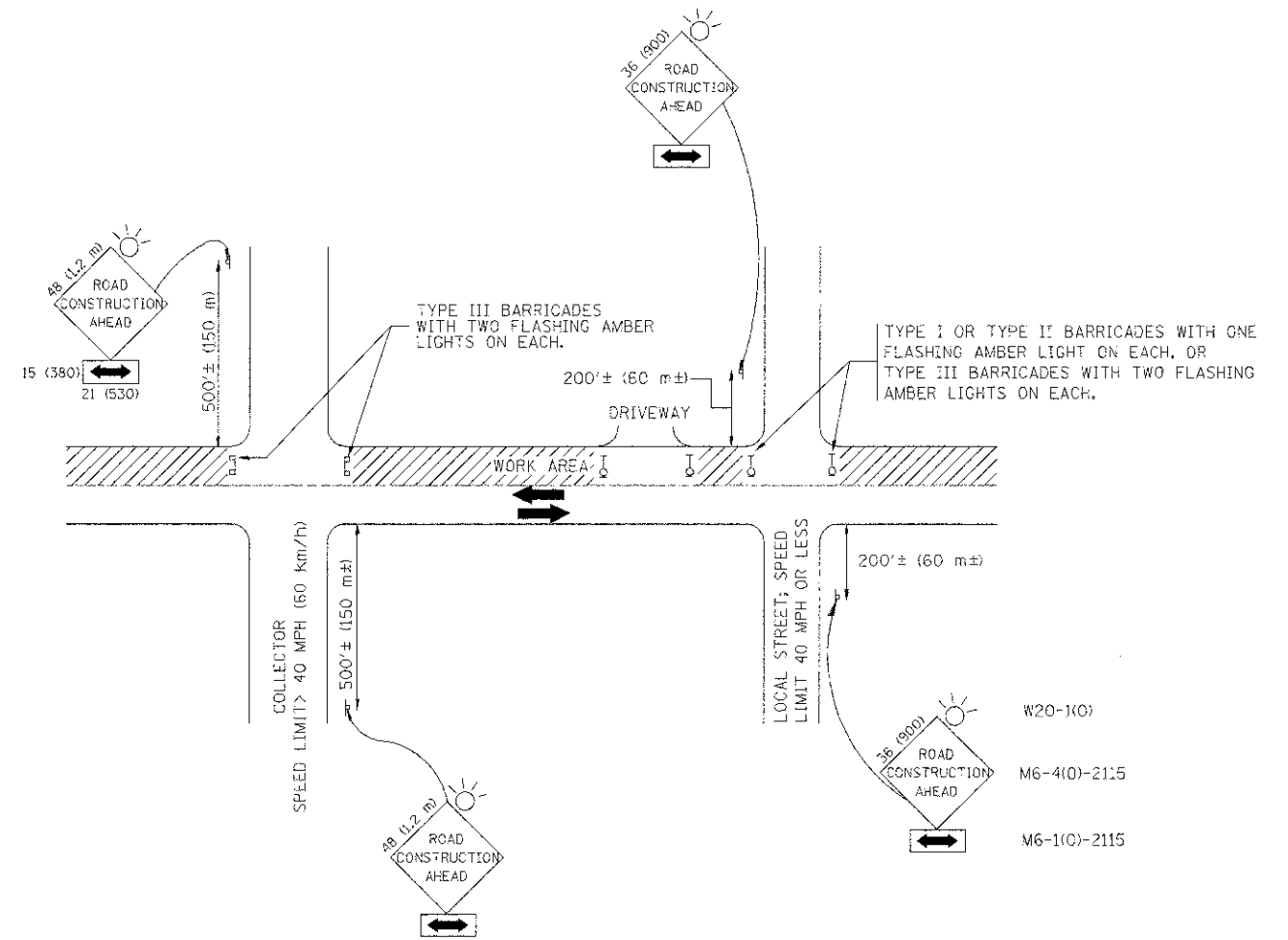

TRAFFIC CONTROL AND PROTECTION FOR SIDE ROADS, INTERSECTIONS, AND DRIVEWAYS

NOTES:

A. FOR NO LANE RESTRICTION ON THE SIDE ROAD OR DRIVEWAYS

1. SIDE ROAD WITH A SPEED LIMIT OF 40 MPH (60 km/h) OR LESS AS SHOWN ON THE DRAWING AND AS DIRECTED BY THE ENGINEER:

a) ONE **ROAD CONSTRUCTION AHEAD** SIGN 36 x 36 (900x900) WITH A FLASHER AND FLAG MOUNTED ON IT APPROXIMATELY 200' (60 m) IN ADVANCE OF THE MAIN ROUTE.

b) THE CLOSED PORTION OF THE MAIN ROUTE SHALL BE PROTECTED BY BLOCKING WITH TYPE I, TYPE II OR TYPE III BARRICADES, 1/3 OF THE CROSS SECTION OF THE CLOSED PORTION.

2. SIDE ROAD WITH A SPEED LIMIT GREATER THAN 40 MPH (60 km/h) AS SHOWN ON THE DRAWING AND AS DIRECTED BY THE ENGINEER:

a) ONE **ROAD CONSTRUCTION AHEAD** SIGN 48 x 48 (1.2 m x 1.2 m) WITH A FLASHER MOUNTED ON IT APPROXIMATELY 500' (150 m) IN ADVANCE OF THE MAIN ROUTE.

b) THE CLOSED PORTION OF THE MAIN ROUTE SHALL BE PROTECTED BY BLOCKING WITH TYPE III BARRICADES, 1/2 OF THE CROSS SECTION OF THE CLOSED PORTION.

3. WHEN THE SIDE ROAD LIES BETWEEN THE BEGINNING OF THE MAINLINE SIGNING AND THE WORK ZONE, A SINGLE HEADED ARROW (M6-5) SHALL BE USED IN LIEU OF THE DOUBLE HEADED ARROW (M6-4).

B. FOR A LANE CLOSURE ON A SIDE ROAD OR DRIVEWAY:

USE APPLICABLE PORTIONS OF THE TYPICAL APPLICATION OF TRAFFIC CONTROL DEVICES (STD. 701501, STD. 701606 OR THE APPROPRIATE STANDARD). THE SPACING OF SIGNS AND BARRICADES SHALL BE ADJUSTED FOR FIELD CONDITIONS AS DIRECTED BY THE ENGINEER. THE DIRECTIONAL ARROW SHALL BE COVERED OR REMOVED WHEN NO LONGER CONSISTENT WITH THE SIDE ROAD LANE CLOSURE.

C. ADVANCE WARNING SIGNS ARE TO BE OMITTED ON DRIVEWAY UNLESS OTHERWISE NOTED.

D. THE TRAFFIC CONTROL AND PROTECTION FOR SIDE ROADS, INTERSECTIONS, AND DRIVEWAYS SHALL BE INCIDENTAL TO THE COST OF SPECIFIED TRAFFIC CONTROL STANDARDS OR ITEMS.

All dimensions are in millimeters (inches) unless otherwise shown.

FILE NAME = 12402-DT1501 - IDOT P01	USER NAME = wgl1emout	DESIGNED -- LHA	REVISED -- J. OBERLE 10-18-95
		CHECKED --	REVISED -- A. HOUSEH 03-06-96
	PLOT SCALE = 60.000 / 1 IN.	DRAWN --	REVISED -- A. HOUSEH 10-15-96
	PLOT DATE = 4/4/2009	CHECKED -- 06-89	REVISED -- T. RAMMACHER 01-06-00

STATE OF ILLINOIS
DEPARTMENT OF TRANSPORTATION

TRAFFIC CONTROL AND PROTECTION FOR
SIDE ROADS, INTERSECTIONS, AND DRIVEWAYS

SCALE: SHEET NO. 9 OF 10 SHEETS STA. TO STA.

F.A. RTE.	SECTION	COUNTY	TOTAL SHEETS	SHEET NO.
	12-0002-00-SW	COOK	9	9
TC-10			CONTRACT NO. 63836	
FED. ROAD DIST. NO. 1 ILLINOIS FED. AID PROJECT SRTS-4009(179)				

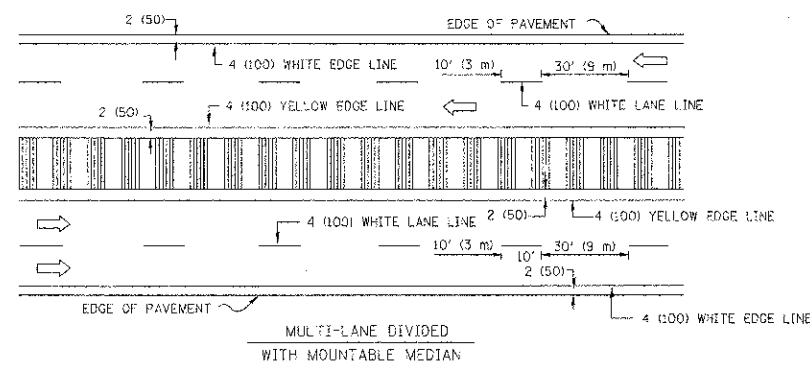
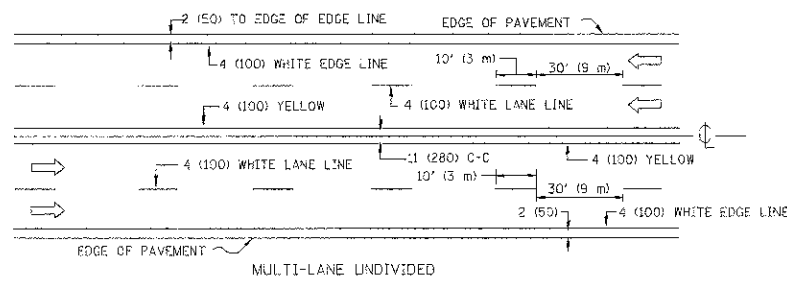
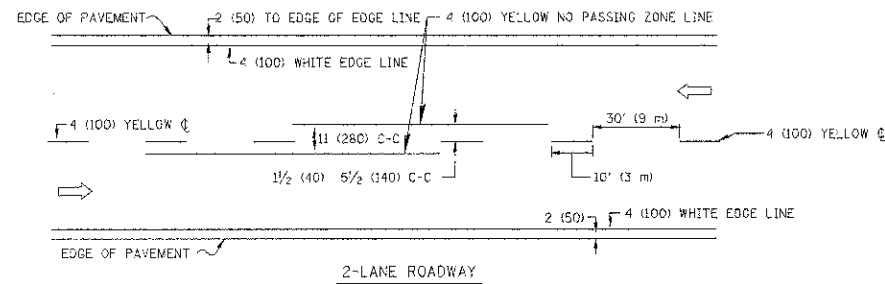

NOTE: MEDIANS WITH BARRIER CURB DO NOT REQUIRE AN EDGE LINE

TYPICAL LANE AND EDGE LINE MARKING

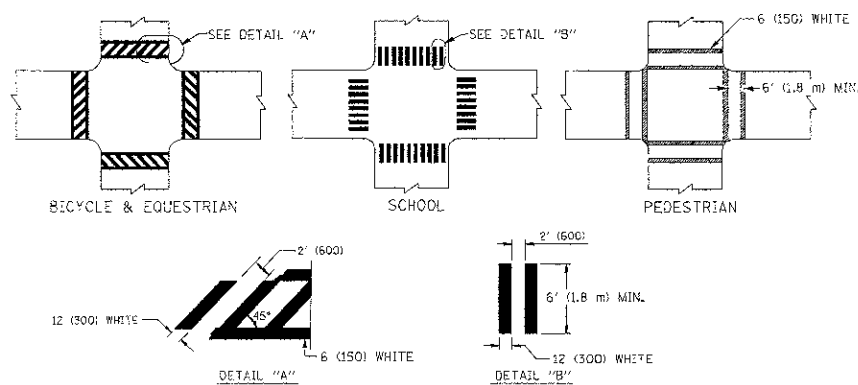

TYPICAL CROSSWALK MARKING

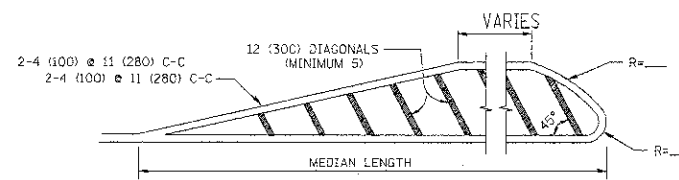
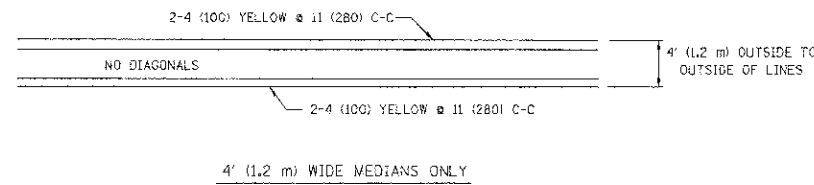

DIAGONAL LINE SPACING: 50' (15 m) C-C (LESS THAN 30MPH (50 km/h))
75' (25 m) C-C 30MPH (50 km/h) TO 45MPH (70 km/h)
150' (45 m) C-C (MORE THAN 45MPH (70 km/h))

MEDIANS OVER 4' (1.2 m) WIDE

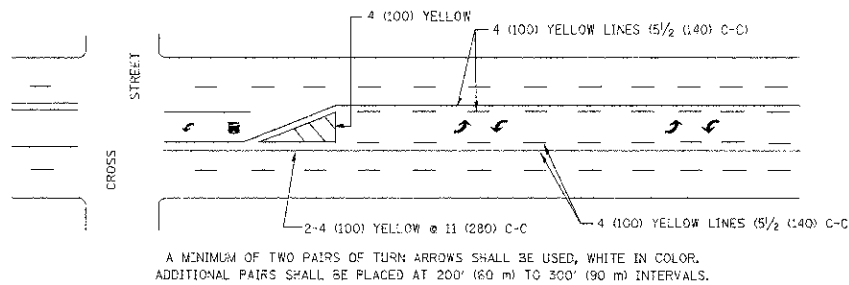

A MINIMUM OF TWO PAIRS OF TURN ARROWS SHALL BE USED, WHITE IN COLOR. ADDITIONAL PAIRS SHALL BE PLACED AT 200' (60 m) TO 300' (90 m) INTERVALS.

MEDIAN WITH TWO-WAY LEFT TURN LANE

TYPICAL PAINTED MEDIAN MARKING

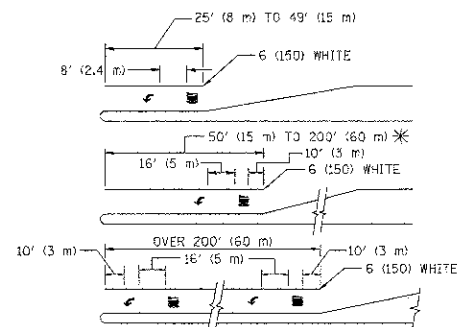

FULL SIZE LETTERS 8' (2.4 m) AND ARROWS SHALL BE USED.
AREA = 15.6 SQ. FT. (1.5 m²) AREA = 20.8 SQ. FT. (1.9 m²)

* TURN LANES IN EXCESS OF 400' (120 m) IN LENGTH MAY HAVE AN ADDITIONAL SET OF ARROW - "ONLY" INSTALLED MIDWAY BETWEEN THE OTHER TWO SETS OF ARROW - "ONLY".

TYPICAL LEFT (OR RIGHT) TURN LANE

TYPICAL TURN LANE MARKING

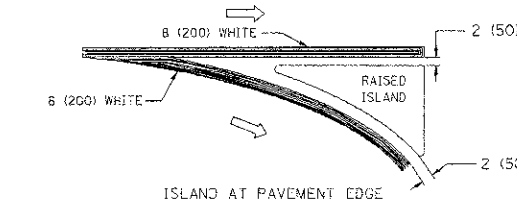
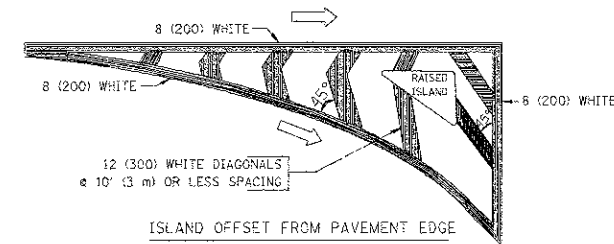

TYPICAL ISLAND MARKING

TYPE OF MARKING	WIDTH OF LINE	PATTERN	COLOR	SPACING / REMARKS
CENTERLINE ON 2 LANE PAVEMENT	4 (100)	SKIP-DASH	YELLOW	10' (3 m) LINE WITH 30' (9 m) SPACE
CENTERLINE ON MULTI-LANE UNDIVIDED PAVEMENT	2 @ 4 (100)	SOLID	YELLOW	11 (280) C-C
NO PASSING ZONE LINES FOR ONE DIRECTION FOR BOTH DIRECTIONS	4 (100) 2 @ 4 (100)	SOLID SOLID	YELLOW YELLOW	5/2 (140) C-C FROM SKIP-DASH CENTERLINE 11 (280) C-C OMIT SKIP-DASH CENTERLINE BETWEEN
LANE LINES	4 (100) 8 (125) ON FREEWAYS	SKIP-DASH SKIP-DASH	WHITE WHITE	10' (3 m) LINE WITH 30' (9 m) SPACE
DOTTED LINES (EXTENSIONS OF CENTER, LANE OR TURN LANE MARKINGS)	SAME AS LINE BEING EXTENDED	SKIP-DASH	SAME AS LINE BEING EXTENDED	2' (600) LINE WITH 6' (1.8 m) SPACE
EDGE LINES	4 (100)	SOLID	YELLOW-LEFT WHITE-RIGHT	OUTLINE MOUNTABLE MEDIANS IN YELLOW; EDGE LINES ARE NOT USED NEXT TO BARRIER CURB
TURN LANE MARKINGS	6 (150) LINE; FULL SIZE LETTERS & SYMBOLS (8' (2.4m))	SOLID	WHITE	SEE TYPICAL TURN LANE MARKING DETAIL
TWO WAY LEFT TURN MARKING	2 @ 4 (100) EACH DIRECTION 8' (2.4m) LEFT ARROW	SKIP-DASH AND SOLID IN PAIRS	YELLOW WHITE	10' (3 m) LINE WITH 30' (9 m) SPACE FOR SKIP-DASH; 5/2 (140) C-C BETWEEN SOLID LINE AND SKIP-DASH LINE SEE TYPICAL TWO-WAY LEFT TURN MARKING DETAIL
CROSSWALK LINES (PEDESTRIAN A. DIAGONALS (BIKE & EQUESTRIAN) B. LONGITUDINAL BARS (SCHOOL))	2 @ 6 (150) 12 (300) @ 45° 12 (300) @ 90°	SOLID SOLID SOLID	WHITE WHITE WHITE	NOT LESS THAN 6' (1.8 m) APART 2' (600) APART SEE TYPICAL CROSSWALK MARKING DETAILS.
STOP LINES	24 (600)	SOLID	WHITE	PLACE 4' (1.2 m) IN ADVANCE OF AND PARALLEL TO CROSSWALK, IF PRESENT. OTHERWISE, PLACE AT DESIRED STOPPING POINT, PARALLEL TO CROSSROAD CENTERLINE, WHERE POSSIBLE
PAINTED MEDIANS	2 @ 4 (100) WITH 12 (300) DIAGONALS @ 45° NO DIAGONALS USED FOR 4' (1.2 m) WIDE MEDIANS	SOLID	YELLOW: TWO WAY TRAFFIC WHITE: ONE WAY TRAFFIC	11 (280) C-C FOR THE DOUBLE LINE SEE TYPICAL PAINTED MEDIAN MARKING.
CORE MARKING AND CHANNELIZING LINES	8 (200) WITH 12 (300) DIAGONALS @ 45°	SOLID	WHITE	DIAGONALS: 15' (4.5 m) C-C (LESS THAN 30MPH (50 km/h)) 20' (6 m) C-C 30MPH (50 km/h) TO 45MPH (70 km/h) 30' (9 m) C-C (OVER 45MPH (70 km/h))
RAILROAD CROSSING	24 (600) TRANSVERSE LINES "RR" 15' (4.5 m) LINE FOR "X"	SOLID	WHITE	SEE STATE STANDARD T80001 AREA OF: "R"=3.6 SQ. FT. (0.33 m ²) EACH "X"=54.0 SQ. FT. (5.0 m ²)
SHOULDER DIAGONALS	12 (300) @ 45°	SOLID	WHITE - RIGHT YELLOW - LEFT	50' (15 m) C-C (LESS THAN 30MPH (50 km/h)) 75' (25 m) C-C 30 MPH (50 km/h) TO 45MPH (70 km/h) 150' (45 m) C-C (OVER 45MPH (70 km/h))

FOR FURTHER DETAILS ON PAVEMENT MARKING REFER TO STANDARD SPECIFICATIONS FOR ROAD AND BRIDGE CONSTRUCTION AND STATE STANDARD T80001.

All dimensions are in inches (millimeters) unless otherwise shown.