

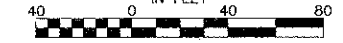

1"=40'

GRAPHIC SCALE
IN FEET



REMOVAL LEGEND

- DENOTES HOT-MIX ASPHALT SURFACE REMOVAL—BUTT JOINT
- DENOTES HOT-MIX ASPHALT SURFACE REMOVAL, 3 INCH. SURFACE REMOVAL SHALL COMMENCE ONLY AFTER PLACEMENT OF HOT-MIX ASPHALT BASE COURSE, 9 INCH IN PAVEMENT REMOVAL AREA IS COMPLETED.
- DENOTES PAVEMENT REMOVAL
- DENOTES DRIVEWAY PAVEMENT REMOVAL
- DENOTES SIDEWALK REMOVAL
- DENOTES COMBINATION CURB AND GUTTER REMOVAL
- "A"** DENOTES EXISTING VALVE VAULTS, VALVE BOXES, INLETS, CATCH BASINS AND MANHOLES TO BE ADJUSTED
- "BO"** DENOTES EXISTING TO BE ADJUSTED (BY OTHERS)
- "S"** DENOTES EXISTING FRAMES AND LIDS TO BE ADJUSTED (SPECIAL)
- "OL"** DENOTES NEW FRAMES AND LIDS, TYPE I, OPEN LID
- "CL"** DENOTES NEW FRAMES AND LIDS, TYPE I, CLOSED LID
- "R"** DENOTES EXISTING VALVE VAULTS TO BE RECONSTRUCTED
- DENOTES ALLEY RETURN OR DRIVEWAY TO BE REMOVED WITH PAVEMENT REMOVAL

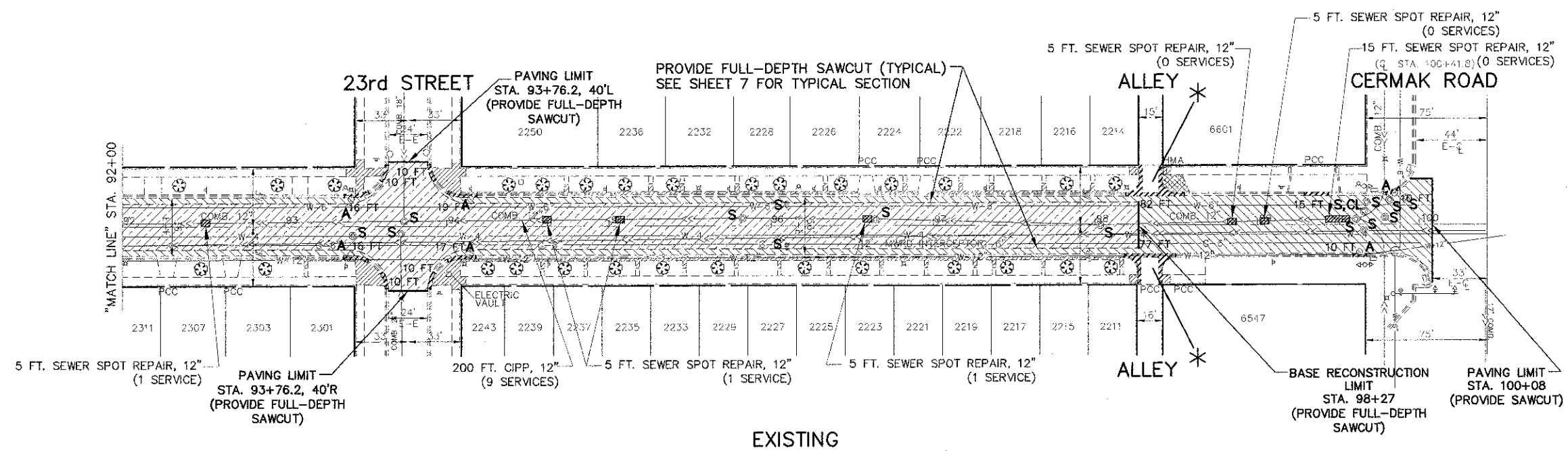

EXISTING

FOR CONTINUATION
SEE SHEET 13

EAST AVENUE
PROJECT ENDS
STA. 100+08

PROPOSED PAVEMENT LEGEND

- DENOTES LEVELING BINDER (MACHINE METHOD), N50, 1 INCH AND AREA REFLECTIVE CRACK CONTROL TREATMENT (6 OZ.) BETWEEN LEVELING BINDER AND SURFACE COURSE AND HOT-MIX ASPHALT SURFACE COURSE, MIX "D", N50, 2 INCH. CLASS D PATCHES, 9 INCH. SEE TYPICAL SECTIONS
- DENOTES HOT-MIX ASPHALT BASE COURSE, 9 INCH. SEE TYPICAL SECTIONS
- DENOTES PORTLAND CEMENT CONCRETE DRIVEWAY PAVEMENT, 7 INCH (PE)
- DENOTES PORTLAND CEMENT CONCRETE SIDEWALK, 5 INCH (PORTLAND CEMENT CONCRETE SIDEWALK, 7 INCH AT PE DRIVEWAYS)
- DENOTES COMBINATION CONCRETE CURB AND GUTTER, TYPE B-6.12
- DENOTES PORTLAND CEMENT CONCRETE SIDEWALK, 5 INCH WITH DETECTABLE WARNINGS PER I.D.O.T. STANDARDS FOR HANDICAP RAMPS (WHERE APPLICABLE) SEE CONSTRUCTION HIGHWAY STANDARDS
- PE** DENOTES PRIVATE ENTRANCE
- CE** DENOTES COMMERCIAL ENTRANCE
- DENOTES PORTLAND CEMENT CONCRETE PAVEMENT, 8 INCH

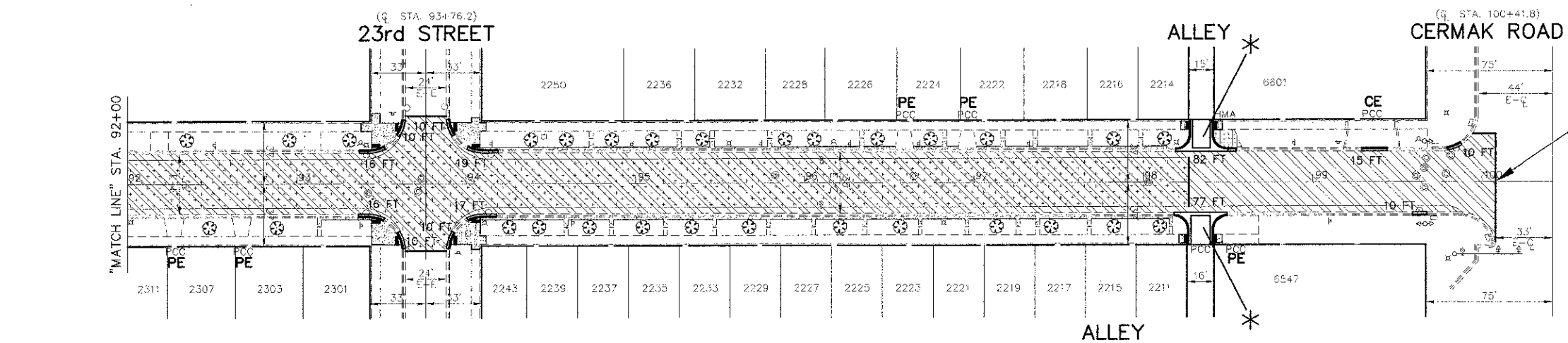

PROPOSED
EAST AVENUE

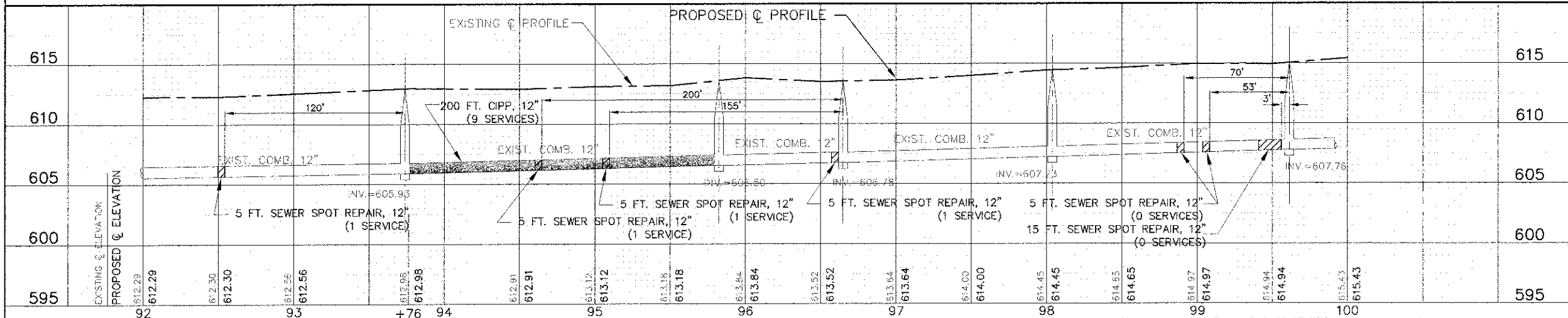

ALL SAW CUTS SHALL BE CONSIDERED INCLUDED IN THE COST OF THE ITEM BEING REMOVED.

FOR TYPICAL SECTIONS OF NEW PAVEMENT WORK SEE SHEET Z

IMPORTANT!
FULL SIZE PLANS HAVE BEEN PREPARED USING STANDARD ENGINEERING SCALES. REDUCED SIZED PLANS WILL NOT CONFORM TO STANDARD SCALES INDICATED IN TITLE BLOCK.



FILE NAME CITY OF BERWYN
EAST AVENUE
31st STREET TO CERMAK ROAD
RESURFACING

USER NAME =
DESIGNED -- THK
DRAWN -- JFP
CHECKED -- JEF
DATE -- 1-24-13

REVISD -- JEF 3-13-13
REVISD -- JEF 4-5-13
REVISD --
REVISD --

STATE OF ILLINOIS
DEPARTMENT OF TRANSPORTATION

PLAN & PROFILE: EAST AVENUE - STA. 92+00 TO STA. 100+08
(RESURFACING AND RECONSTRUCTION)

SCALE: 1"=40' SHEET NO. OF SHEETS STA. TO STA.

SECTION	COUNTY	TOTAL SHEETS
09-00167-00-RS	COOK	31
CONTRACT NO. 63837		14
FED. ROAD DIST. NO. ILLINOIS FED. AID PROJECT M-4003(087)		