

DATE	
BY	
DESIGNED	
DRAWN	
CHECKED	
DATE	

DATE	
BY	
DESIGNED	
DRAWN	
CHECKED	
DATE	

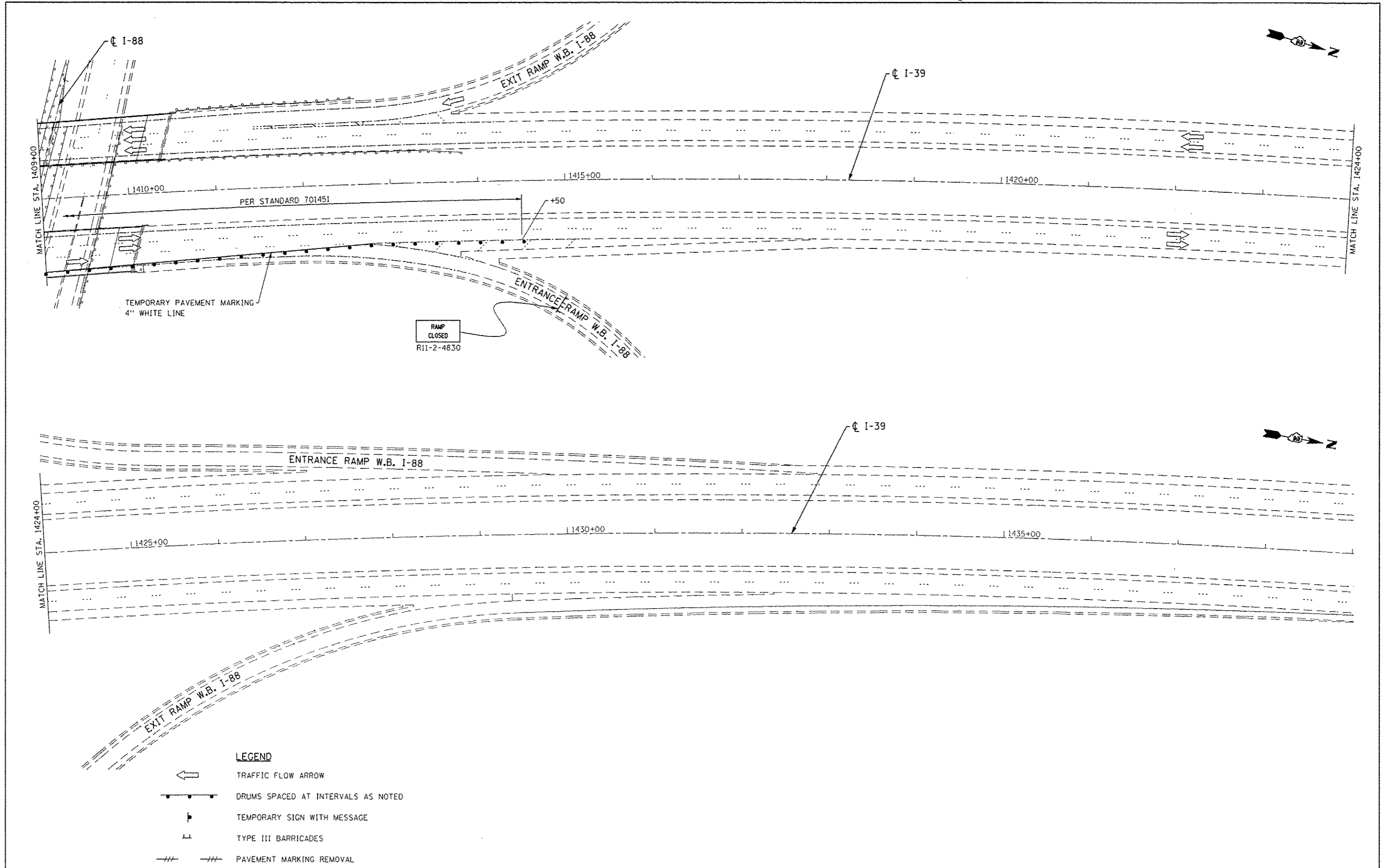

**LEGEND**

- TRAFFIC FLOW ARROW
- DRUMS SPACED AT INTERVALS AS NOTED
- TEMPORARY SIGN WITH MESSAGE
- TYPE III BARRICADES
- PAVEMENT MARKING REMOVAL

FILE NAME: tsh-tstogel.02 1-39.dgn  
 PLOT DATE: 9/6/2012  
 PLOT SCALE: 100,0000 1/ IN.

**CR & A**  
 CHRISTIAN-ROGE & ASSOCIATES, INC.  
 ENGINEERS-PLANNERS-SURVEYORS  
 211 WEST WACKER DRIVE  
 CHICAGO, ILLINOIS 60606  
 PHONE: (312)372-2023 FAX: (312)372-5274

DESIGNED	-	E.M.	REVISED	-
DRAWN	-	B.K.	REVISED	-
CHECKED	-	G.F.L.	REVISED	-
DATE	-	JULY 2012	REVISED	-

**STATE OF ILLINOIS  
 DEPARTMENT OF TRANSPORTATION**

<b>TRAFFIC CONTROL AND PROTECTION</b>				
<b>STAGE I</b>				
<b>I-39 OVER I-88</b>				
SCALE:	SHEET NO.	OF SHEETS	STA.	TO STA.

F.A.I. RTE.	SECTION	COUNTY	TOTAL SHEETS	SHEET NO.
39	D2 BRIDGE PAINTING 2013-2	OGLE	26	10
FED. ROAD DIST. NO. 1 [ILLINOIS]			FED. AID PROJECT	
			CONTRACT NO. 64J27	