

DATE	
BY	
FINAL SURVEY	
NOTED	
REVISIONS	
NO.	

DATE	
BY	
FINAL SURVEY	
NOTED	
REVISIONS	
NO.	

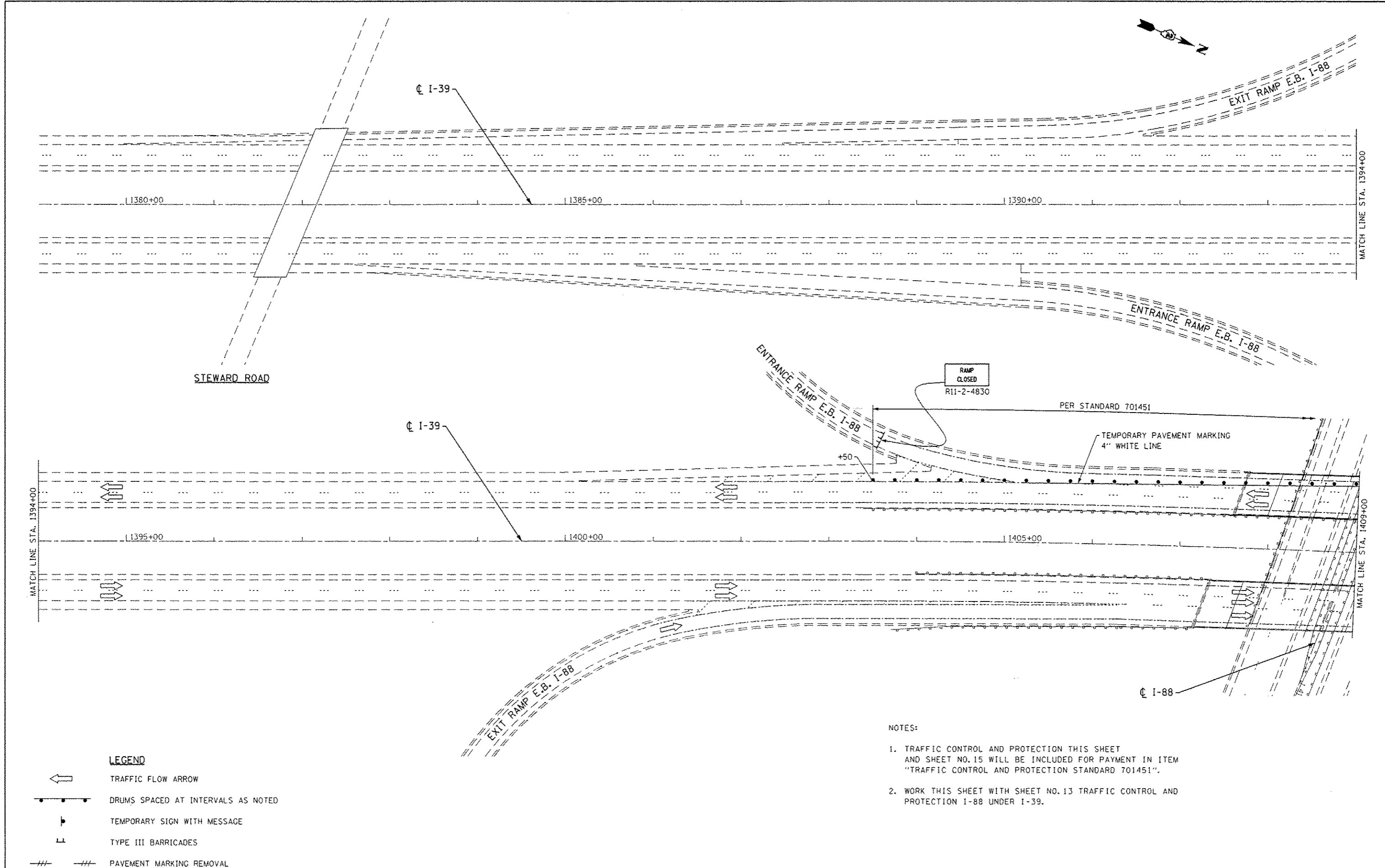

**LEGEND**

- TRAFFIC FLOW ARROW
- DRUMS SPACED AT INTERVALS AS NOTED
- TEMPORARY SIGN WITH MESSAGE
- TYPE III BARRICADES
- PAVEMENT MARKING REMOVAL

**NOTES:**

1. TRAFFIC CONTROL AND PROTECTION THIS SHEET AND SHEET NO. 15 WILL BE INCLUDED FOR PAYMENT IN ITEM "TRAFFIC CONTROL AND PROTECTION STANDARD 701451".
2. WORK THIS SHEET WITH SHEET NO. 13 TRAFFIC CONTROL AND PROTECTION I-88 UNDER I-39.

FILE NAME: i-39-stage4.01-1-39.dgn  
 PLOT DATE: 9/6/2012  
 PLOT SCALE: 100.0000' / 1" = 100'

**CR & A**  
 CHRISTIAN-ROGE & ASSOCIATES, INC.  
 ENGINEERS-PLANNERS-SURVEYORS  
 211 WEST WACKER DRIVE  
 CHICAGO, ILLINOIS 60606  
 PHONE: (312)372-2023 FAX: (312)372-5274

DESIGNED	- E.M.	REVISED	-
DRAWN	- B.K.	REVISED	-
CHECKED	- G.F.L.	REVISED	-
DATE	- JULY 2012	REVISED	-

**STATE OF ILLINOIS  
 DEPARTMENT OF TRANSPORTATION**

<b>TRAFFIC CONTROL AND PROTECTION</b>			
<b>STAGE IV</b>			
<b>I-39 OVER I-88</b>			
SCALE:	SHEET NO.	OF SHEETS	STA. TO STA.

F.A.I. RTE.	SECTION	COUNTY	TOTAL SHEETS	SHEET NO.
39	02 BRIDGE PAINTING 2013-2	OCLE	26	14
CONTRACT NO. 64J27				
FED. ROAD DIST. NO. 1 ILLINOIS FED. AID PROJECT				