

HORIZONTAL CONTROL POINTS					
POINT	NORTHING	EASTING	STATION EXISTING ALIGNMENT	STATION PROPOSED ALIGNMENT	DESCRIPTION
SHADYOAK01	1743597.8669	989392.3113		58+93.24	POT - STA. 10+00 ON SHADY OAKS
MINOOKA3	1743651.5350	989476.1880	124+63.54	59+78.50	CONTROL POINT
PC MINE P11-3	1743607.9776	898879.3124		63+80.35	PC
PT MINE P11-3	1743625.0093	990200.6882		67+02.23	PT
PC MINE P11-4	1743643.2682	990414.6415		69+16.96	PC
54	1743657.1856	990609.7670	135+96.77		POT
PT MINE P11-4	1743659.8119	990714.7019		72+17.52	PT
55	1743664.8410	990915.6449	139+02.74	74+18.53	POT
MINOOKA4	1743637.1680	991209.9130	141+96.22	77+12.00	CONTROL POINT
56	1743674.4376	991299.0844	142+86.30	78+02.09	POT
57	1743712.5610	992822.3340	158+10.03	93+25.51	POT

BENCHMARKS								
NO.	NORTHING	EASTING	STATION EXISTING ALIGNMENT	OFFSET EXISTING ALIGNMENT	STATION PROPOSED ALIGNMENT	OFFSET PROPOSED ALIGNMENT	ELEVATION	DESCRIPTION
20			108+51.31	58.13' RT	43+67.36	50.13' RT	552.49	CHIS "X" ON NE BOLT FIRE HYDRANT
MINOOKA 2	1743599.3740	987993.1290	109+79.55	20.04' LT	44+94.45	30.22' LT	557.14	REBAR W/CAP IN FIELD ENTRANCE
1580			1580+61.71	0'	1580+61.71	0'	554.04	PC PLUG CL I-80
21			121+21.49	64.51' RT	56+37.07	44.55' RT	551.73	CHIS "X" ON NE BOLT FIRE HYDRANT
MINOOKA 3	1743651.5350	989476.1880	124+63.54	28.7' LT	59+78.50	51.92' LT	547.55	REBAR W/CAP OFF MINOOKA RD
MINOOKA 4	1743637.1680	991209.9130	141+96.22	35.03' RT	77+12.00	35.03' RT	547.73	REBAR W/CAP, SE QUAD TABLER RD

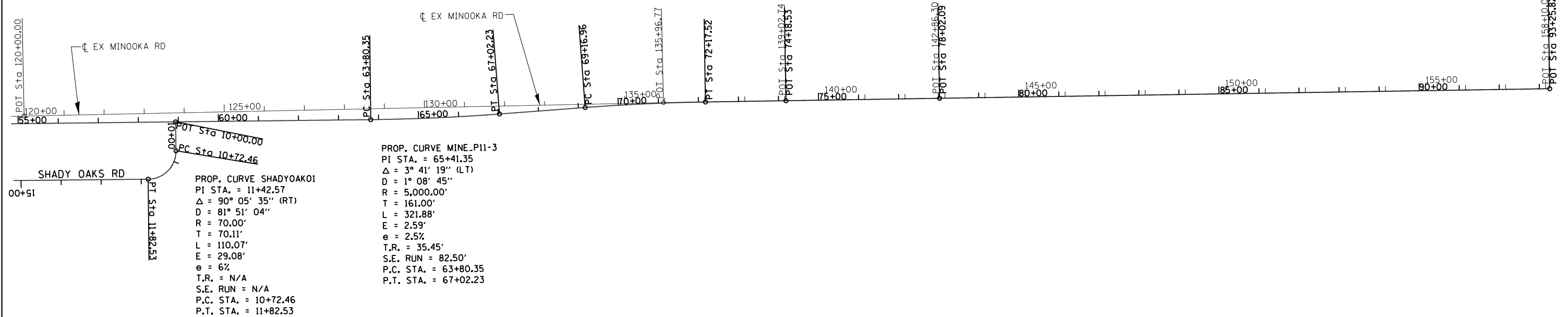

PROP. CURVE MINE.P11-4
 PI STA. = 70+67.29
 $\Delta = 3^\circ 26' 39''$ (RT)
 $D = 1^\circ 08' 45''$
 $R = 5,000.00'$
 $T = 150.33'$
 $L = 300.56'$
 $E = 2.26'$
 $e = 2.5\%$
 $T.R. = 33.00'$
 $S.E. RUN = 55.00'$
 $P.C. STA. = 69+16.96$
 $P.T. STA. = 72+17.52$



HORIZONTAL CONTROL POINTS					
POINT	NORTHING	EASTING	STATION EXISTING ALIGNMENT	STATION PROPOSED ALIGNMENT	DESCRIPTION
SHADYOAK01	1743597.8669	989392.3113		10+00.00	POT
PC SHADYOAK01	1743525.4229	989393.8153		10+72.46	PC
PT SHADYOAK01	1743453.9828	989325.1698		11+82.53	PT
PC SHADY02	1743443.9847	988802.7727		17+05.02	PC
PT SHADY02	1743233.3642	988315.5346		22+49.45	PT

FILE NAME =	USER NAME = duncanbd	DESIGNED -	REVISED -
Default		DRAWN -	REVISED -
		CHECKED -	REVISED -
		DATE -	REVISED -

STATE OF ILLINOIS
 DEPARTMENT OF TRANSPORTATION

ALIGNMENT, TIES &
 BENCHMARKS

SCALE: 1"=125' SHEET 2 OF 3 SHEETS STA. TO STA.

F.A.I. RTE.	SECTION	COUNTY	TOTAL SHEETS	SHEET NO.
80	(32,47-4)HBR-2	GRUNDY	143	24
CONTRACT NO. 66873				
ILLINOIS FED. AID PROJECT				