

F.A.P. RTE.	SECTION	COUNTY	TOTAL SHEETS	SHEET NO.
623	(1HBR)I-2	LASALLE	11	1
		ILLINOIS	CONTRACT NO. 66C80	

DEPARTMENT OF TRANSPORTATION

DIVISION OF HIGHWAYS

**PROPOSED
HIGHWAY PLANS**

F.A.P. ROUTE 623 (US 6)

SECTION (1HBR)I-2

APPROACH SLAB REPAIR

LASALLE COUNTY

C-93-050-13

1. COVER SHEET
2. GENERAL NOTES
3. SUMMARY OF QUANTITIES
4. TYPICAL SECTIONS
5. STAGE I CONSTRUCTION DETAILS
6. STAGE II TRAFFIC CONTROL DETAILS
7. STAGE III TRAFFIC CONTROL DETAILS
8. STAGE IV CONSTRUCTION DETAILS
9. TYPICAL PAVEMENT MARKINGS
- 10 - 11. STRUCTURE PLANS.

STANDARDS

- | | |
|-----------|---|
| 000001-06 | STANDARD SYMBOLS, ABBREVIATIONS AND PATTERNS |
| 001001-02 | AREAS OF REINFORCEMENT BARS |
| 001006 | DECIMAL OF AN INCH AND OF A FOOT |
| 701101-03 | OFF-ROAD OPERATIONS MULTILANE, 15' (4.5 m) TO 24" (600 mm) FROM PAVEMENT EDGE |
| 701106-02 | OFF-ROAD OPERATIONS, MULTILANE, MORE THAN 15' (4.5 m) AWAY |
| 701201-04 | LANE CLOSURE, 2L, 2W, DAY ONLY, FOR SPEEDS ≥ 45 MPH |
| 701301-04 | LANE CLOSURE, 2L, 2W, SHORT TIME OPERATIONS |
| 701311-03 | LANE CLOSURE, 2L, 2W, MOVING OPERATIONS - DAY ONLY |
| 701456-02 | PARTIAL EXIT RAMP CLOSURE FREEWAY/EXPRESSWAY |
| 701601-08 | URBAN LANE CLOSURE, MULTILANE, 2W WITH MOUNTABLE MEDIAN |
| 701801-05 | LANE CLOSURE, MULTILANE 1W OR 2W CROSSWALK OR SIDEWALK CLOSURE |
| 701901-02 | TRAFFIC CONTROL DEVICES |
| 704001-07 | TEMPORARY CONCRETE BARRIER |
| 782001 | PRISMATIC CURB REFLECTORS |

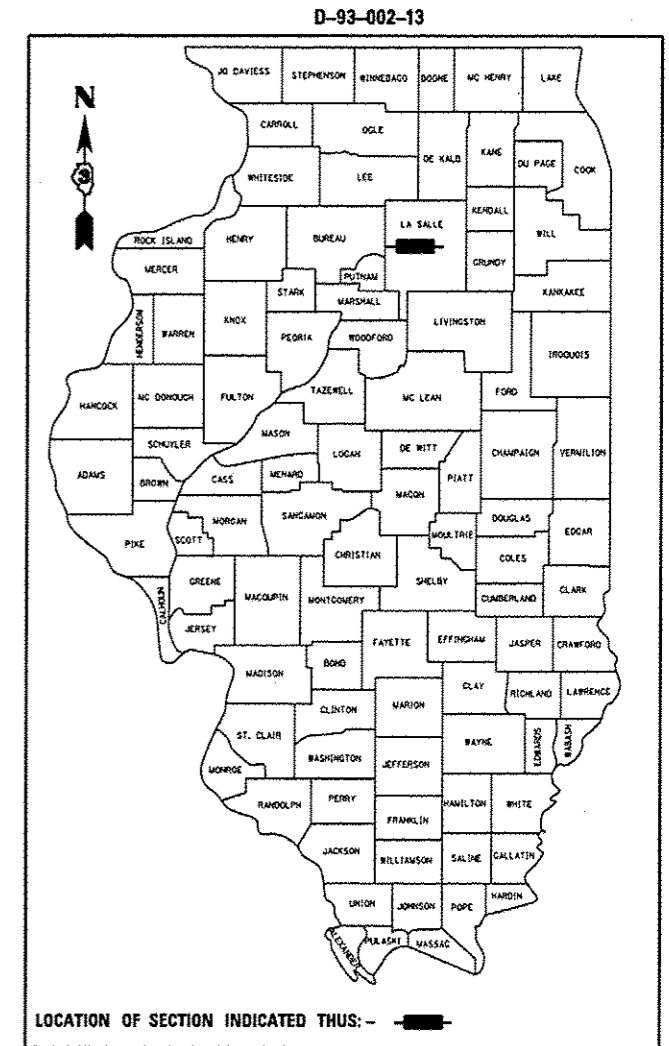

PROJECT LOCATION

STRUCTURE NO. 050-0027
CARRYING FAP ROUTE 623 (US 6)
OVER IL ROUTE 251 IN PERU

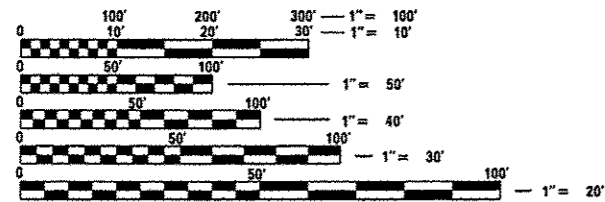
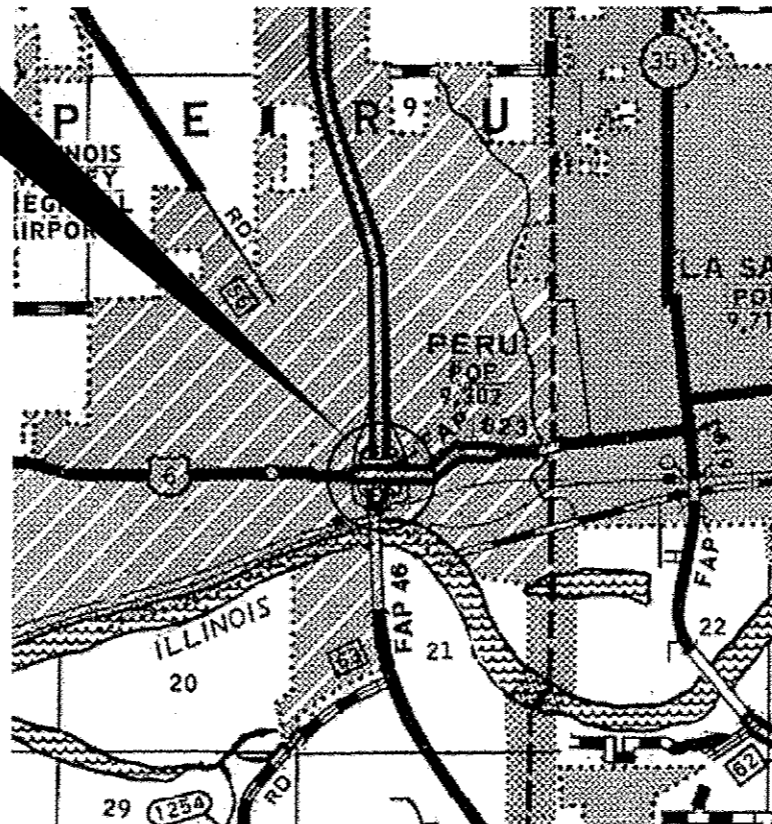

FULL SIZE PLANS HAVE BEEN PREPARED USING STANDARD ENGINEERING SCALES. REDUCED SIZED PLANS WILL NOT CONFORM TO STANDARD SCALES. IN MAKING MEASUREMENTS ON REDUCED PLANS, THE ABOVE SCALES MAY BE USED.

J.U.L.I.E.
JOINT UTILITY LOCATION INFORMATION FOR EXCAVATION
1-800-892-0123
OR 811

PROJECT ENGINEER: JOE KANNEL, P.E.
UNIT CHIEF: RON WOODSHANK
TOWNSHIP: PERU
CONTRACT NO. 66C80

GROSS LENGTH = 148 FT. = 0.03 MILE
NET LENGTH = 38 FT. = 0.01 MILE

STATE OF ILLINOIS
DEPARTMENT OF TRANSPORTATION
DIVISION OF HIGHWAYS

SUBMITTED 4-3-2013
Paul A. Cantamano
DEPUTY DIRECTOR OF HIGHWAYS, REGION ENGINEER

May 10 2013
John D. Baranowski, P.E.
ENGINEER OF DESIGN AND ENVIRONMENT

May 10 2013
Chris Osman, P.E.
DIRECTOR OF HIGHWAYS, CHIEF ENGINEER

**PRINTED BY THE AUTHORITY
OF THE STATE OF ILLINOIS**

GENERAL NOTES

THE THICKNESS OF CONCRETE OVERLAY SHOWN ON THE PLANS IS THE NOMINAL THICKNESS. DEVIATIONS FROM THE NOMINAL THICKNESS WILL BE PERMITTED WHEN SUCH DEVIATIONS OCCUR TO IRREGULARITIES IN THE EXISTING SURFACE, OR BASE ON WHICH THE CONCRETE LATEX OVERLAY IS PLACED.

FOR STABILIZATION, ALL TYPE III BARRICADES SHALL REQUIRE A MINIMUM OF FOUR SAND BAGS PER BARRICADE.

SODDING SHALL NOT BE PERMITTED AT ANY TIME WHEN THE GROUND IS FROZEN, WET, OR IN AN UNTILLABLE CONDITION. LOCATIONS TO BE SODDED WILL BE DETERMINED BY THE ENGINEER.

ANY REFERENCE TO A STANDARD IN THESE PLANS SHALL BE INTERPRETED TO MEAN THE EDITION AS INDICATED BY THE SUBNUMBER SHOWN IN THE LIST OF STANDARDS OR THE COPY INCLUDED IN THESE PLANS.

THE FOLLOWING RATES OF APPLICATION HAVE BEEN USED IN CALCULATING PLAN QUANTITIES:

GRANULAR MATERIALS	2.05	TONS / CU YD
AGGREGATE (PRIME COAT)	0.002	TONS / SQ YD
HMA RESURFACING	112	LBS / SQ YD / IN
SUPPLEMENTAL WATERING	3	GAL / SQ YD / APPLICATION

THE CONTRACTOR'S ATTENTION IS DIRECTED TO THE PRESENCE OF DEPARTMENT-OWNED UNDERGROUND ELECTRICAL CABLE WITHIN THE LIMITS OF THE PROPOSED IMPROVEMENT. THE CONTRACTOR SHALL REQUEST THE ILLINOIS DEPARTMENT OF TRANSPORTATION IN OTTAWA (815-434-8417) TO LOCATE THE UNDERGROUND FACILITIES, PROVIDING A MINIMUM OF 72 HOURS NOTICE. THE DEPARTMENT IS NOT A MEMBER OF THE JOINT UTILITY LOCATING INFORMATION FOR EXCAVATORS (JULIE) SYSTEM.

ALL DAMAGE TO DEPARTMENT OWNED UNDERGROUND FACILITIES, CAUSED BY THE CONTRACTOR SHALL BE REPAIRED TO THE SATISFACTION OF THE DEPARTMENT AT THE CONTRACTOR'S EXPENSE. THIS SHALL INCLUDE ALL TEMPORARY REPAIRS REQUIRED TO KEEP THE FACILITY OPERATIONAL WHILE MATERIAL IS BEING OBTAINED TO MAKE PERMANENT REPAIRS. SPLICING OF ELECTRIC CABLE SHALL NOT BE ALLOWED. ELECTRIC CABLE SHALL BE REPLACED FROM POLE TO POLE OR CONTROLLER.

THE CONTRACTOR SHALL CONTACT JULIE AT LEAST 48 HOURS PRIOR TO EXCAVATION TO DETERMINE WHICH UTILITIES ARE IN THE AREA.

COMMITMENTS

DISPOSAL OF EXCAVATED MATERIALS. ALL UNSUITABLE OR UNSTABLE MATERIALS, DEFINED AS SOILS, EMBANKMENTS, SUB-BASE GRANULAR MATERIALS, AND/OR AGGREGATE MATERIALS THAT ARE EXCAVATED DUE TO CONSTRUCTION OPERATIONS SHALL BE DISPOSED OF WITHIN THE LIMITS OF THE EXISTING RIGHT OF WAY. DISPOSAL OF EXCAVATED MATERIALS, AS DEFINED ABOVE, OFF THE EXISTING RIGHT OF WAY SHALL NOT BE PERMITTED.

EXCAVATED MATERIALS SHALL BE DISPOSED OF AT LOCATIONS DIRECTED BY THE ENGINEER. ANY SUCH DISPOSAL SHALL NOT CREATE AND UNSIGHTLY OR OBJECTIONABLE APPEARANCE OR DETRACT FROM THE NATURAL TOPOGRAPHIC FEATURES WITHOUT WRITTEN PERMISSION FROM THE ENGINEER.

DATE: 4-3-13

PREPARED BY: Dan. Bravakian
DISTRICT STUDIES & PLANS ENGINEER

EXAMINED BY: Herbert J. [Signature]
DISTRICT CONSTRUCTION ENGINEER

Wayne L. Phillips, Jr.
DISTRICT MATERIALS ENGINEER

Bruce A. Ancker, PE
DISTRICT OPERATIONS ENGINEER

FILE NAME *	USER NAME * petaluj	DESIGNED - RW	REVISED -	STATE OF ILLINOIS DEPARTMENT OF TRANSPORTATION	GENERAL NOTES	P.A.P. RTE.	SECTION	COUNTY	TOTAL SHEETS	SHEET NO.
c:\pvc\work\pwidot\petaluj\40332461\0366088-ah-t-details.dgn	DRAWN - RW	REVISED -	623			(1)HBRII-2	LASALLE	11	2	
PLOT SCALE * 100.0000 / / in.	CHECKED -	REVISED -	CONTRACT NO. 66C80							
PLOT DATE * 4/3/2013	DATE -	REVISED -	ILLINOIS FED. AID PROJECT							
				SCALE:	SHEET NO. 1 OF 1 SHEETS	STA.	TO STA.			

CODE NO.	ITEM	UNIT	CONSTR. CODE
			STATE FUNDS 100% STRUCTURE 0014 URBAN
20200100	EARTH EXCAVATION	CU YD	146
25000110	SEEDING, CLASS 1A	ACRE	0.05
25000400	NITROGEN FERTILIZER NUTRIENT	POUND	5
25000500	PHOSPHORUS FERTILIZER NUTRIENT	POUND	5
25000600	POTASSIUM FERTILIZER NUTRIENT	POUND	5
25100630	EROSION CONTROL BLANKET	SQ YD	245
42400100	PORTLAND CEMENT CONCRETE SIDEWALK 4 INCH	SQ FT	421
42400800	DETECTABLE WARNINGS	SQ FT	20
44000500	COMBINATION CURB AND GUTTER REMOVAL	FOOT	440
44000600	SIDEWALK REMOVAL	SQ FT	421
60607500	COMBINATION CONCRETE CURB AND GUTTER, TYPE B-9.24 (ABUTTING EXISTING PAVEMENT)	FOOT	440
67100100	MOBILIZATION	L SUM	1
70100825	TRAFFIC CONTROL AND PROTECTION, STANDARD 701456	L SUM	1
70102640	TRAFFIC CONTROL AND PROTECTION, STANDARD 701801	L SUM	1
70400100	TEMPORARY CONCRETE BARRIER	FOOT	225
70400200	RELOCATE TEMPORARY CONCRETE BARRIER	FOOT	125
70600250	IMPACT ATTENUATORS, TEMPORARY (NON- REDIRECTIVE), TEST LEVEL 3	EACH	2
70600350	IMPACT ATTENUATORS, RELOCATE (NON- REDIRECTIVE), TEST LEVEL 3	EACH	2
78009006	MODIFIED URETHANE PAVEMENT MARKING - LINE 6"	FOOT	160
78009008	MODIFIED URETHANE PAVEMENT MARKING - LINE 8"	FOOT	386
78009012	MODIFIED URETHANE PAVEMENT MARKING - LINE 12"	FOOT	46
78200300	PRISMATIC CURB REFLECTOR	EACH	30
78300100	PAVEMENT MARKING REMOVAL	SQ FT	385
X5030275	CONCRETE WEARING SURFACE REMOVAL	SQ YD	166
X7010228	TRAFFIC CONTROL AND PROTECTION, STANDARD 701601, SPECIAL	L SUM	1
Z0062456	TEMPORARY PAVEMENT	SQ YD	377
Z0006014	BRIDGE DECK LATEX CONCRETE OVERLAY, 2 1/2 INCHES	SQ YD	166
Z0012144	BRIDGE DECK SCARIFICATION 2 1/2 INCHES	SA YD	166

* SPECIALITY ITEMS

FILE NAME :	USER NAME : patelejj	DESIGNED - RW	REVISED -	STATE OF ILLINOIS DEPARTMENT OF TRANSPORTATION	SUMMARY OF QUANTITIES	F.A.P. RTE.	SECTION	COUNTY	TOTAL SHEETS	SHEET NO.
ca:\pwork\pwork\patelejj\08332461\03600000-ah1-details.dgn	DRAWN - RW	REVISED -	623			(1HBR)1-2	LASALLE	11	3	
PLOT SCALE = 100.0000' / 1"	CHECKED -	REVISED -	CONTRACT NO. 66C80							
PLOT DATE = 4/3/2013	DATE -	REVISED -	SCALE:			SHEET NO. 1 OF 1 SHEETS	STA.	TO STA.	ILLINOIS FED. AID PROJECT	

Rev.

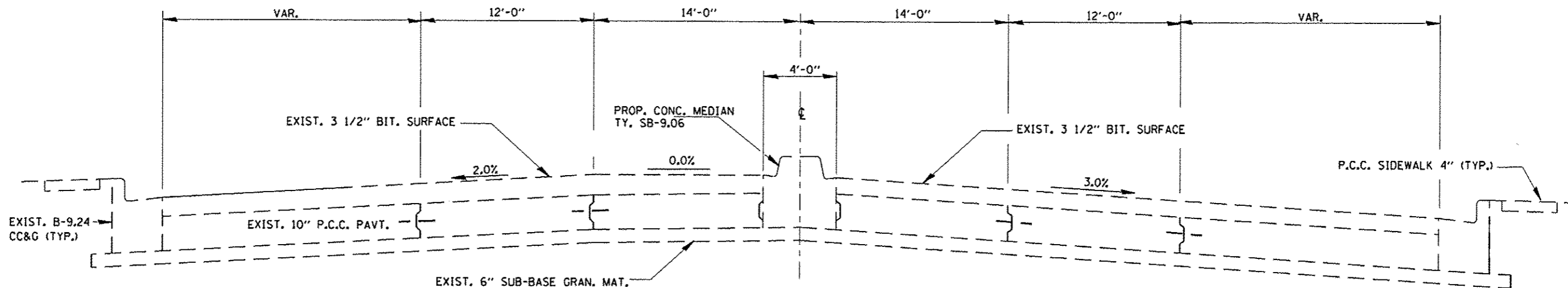

**TYPICAL SECTION
STA. 6+45 TO STA. 9+22**

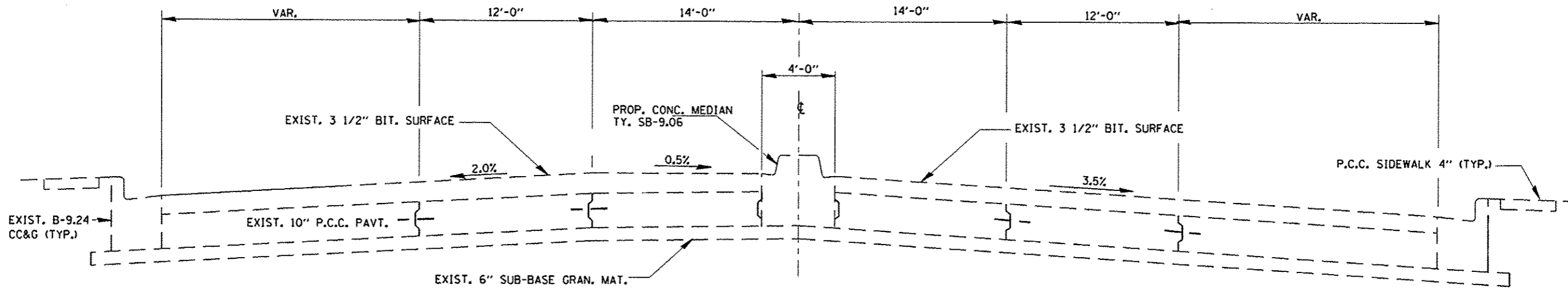

**TYPICAL SECTION
STA. 10+67 TO STA. 13+22**

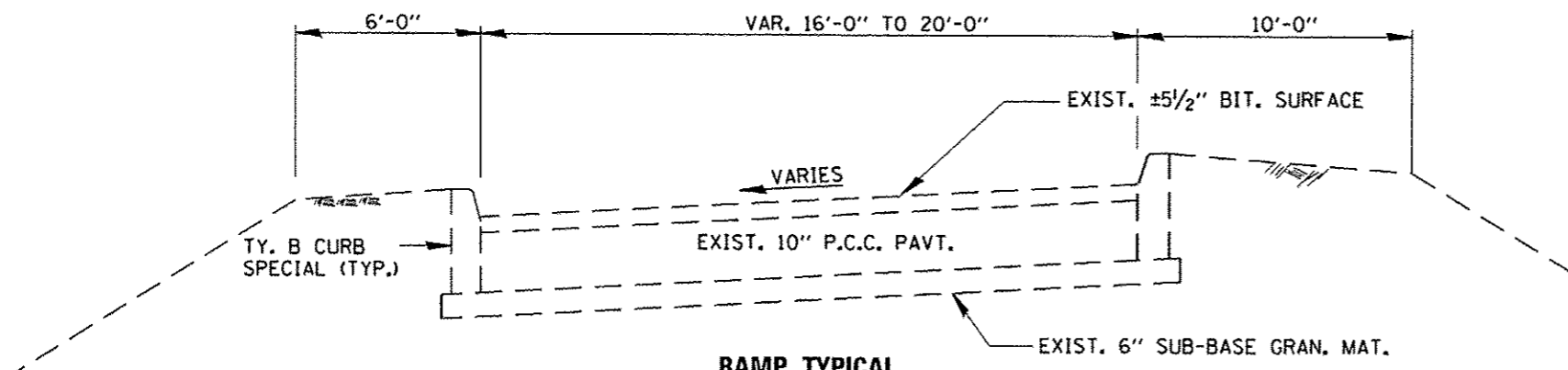

RAMP TYPICAL

FILE NAME :	USER NAME : petelyj	DESIGNED - RW	REVISED -
oh:\pwork\p\midot\petelyj\0302461\0366000\ah\detail\dgn		DRAWN - RW	REVISED -
	PLOT SCALE = 1/8"=1'-0"	CHECKED -	REVISED -
	PLOT DATE = 4/3/2013	DATE -	REVISED -

STATE OF ILLINOIS
DEPARTMENT OF TRANSPORTATION

TYPICAL SECTIONS

SCALE:	SHEET NO. 1 OF 1 SHEETS	STA.	TO STA.	F.A.P. RTE. 623	SECTION (IHR)1-2	COUNTY LASALLE	TOTAL SHEETS 11	SHEET NO. 4	
								CONTRACT NO. 66C80	
ILLINOIS FED. AID PROJECT									

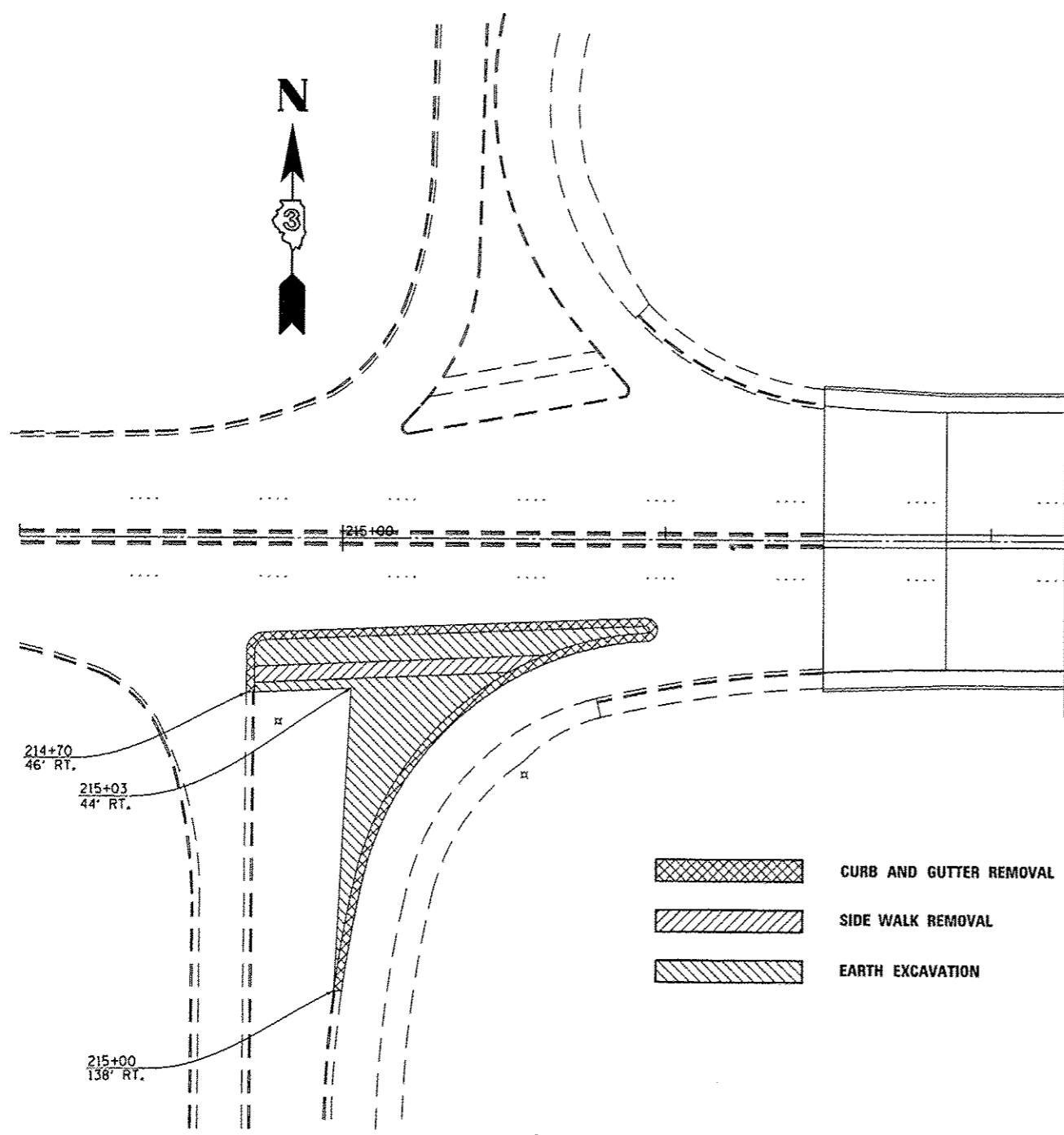

**PLAN
EXISTING**

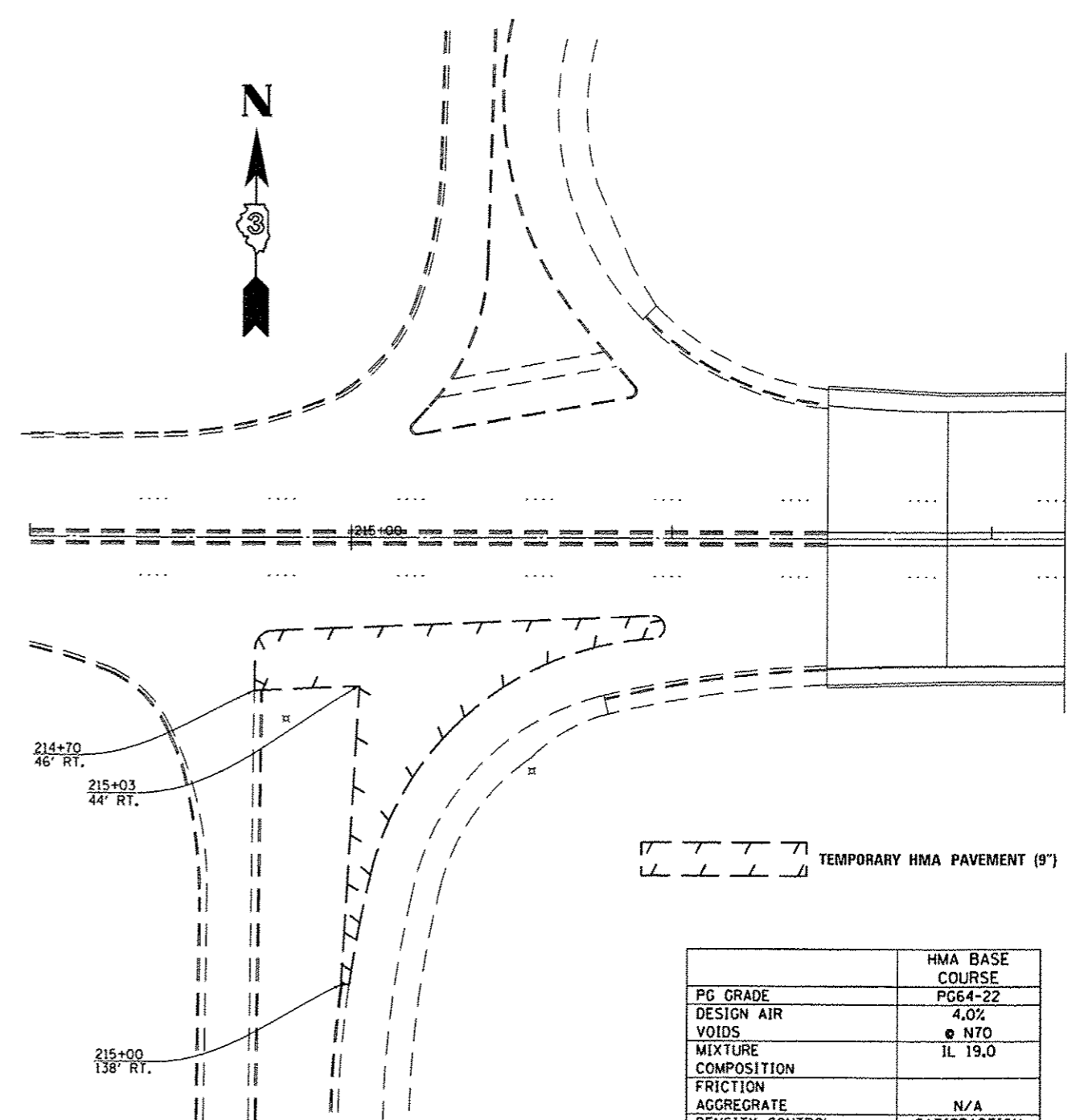

**PLAN
PROPOSED**

SEQUENCE OF OPERATIONS

STAGE I CONSTRUCTION

1. REMOVE EXISTING COMBINATION CONCRETE CURB AND GUTTER TYPE B9.24
2. REMOVE EXISTING PCC SIDEWALK, 5' WIDTH, 4" DEPTH
3. REMOVE EXISTING SOILS TO AN ELEVATION 9" BELOW EXISTING PAVEMENT ELEVATION
4. PLACE TEMPORARY HOT-MIX ASPHALT PAVEMENT 9"

TEMPORARY HMA PAVEMENT (9")

	HMA BASE COURSE
PG GRADE	PG64-22
DESIGN AIR VOIDS	4.0%
MIXTURE COMPOSITION	@ N70 IL 19.0
FRICTION AGGREGATE	N/A
DENSITY CONTROL METHOD	SATISFACTION OF ENGINEER

GENERAL NOTES

WHENEVER ANY VEHICLE, EQUIPMENT, WORKERS OR THEIR ACTIVITIES ENCROACH ON THE MAINLINE PAVEMENT REQUIRING THE CLOSURE OF ONE OR MORE TRAFFIC LANES IN AN URBAN AREA TRAFFIC CONTROL AND PROTECTION SHALL BE ACCORDING TO TRAFFIC CONTROL AND PROTECTION STANDARD 701601.

WHENEVER ANY VEHICLE, EQUIPMENT, WORKERS OR THEIR ACTIVITIES ENCROACH ON THE RAMP PAVEMENT REQUIRING THE RESTRICTION OF THE RAMP LANE IN AN URBAN AREA TRAFFIC CONTROL AND PROTECTION SHALL BE ACCORDING TO TRAFFIC CONTROL AND PROTECTION STANDARD 701456.

FILE NAME *	USER NAME = potelyj	DESIGNED - RW	REVISED -
o:\pwork\pedit\potelyj\0332461\0366008-shd-details.dgn		DRAWN - RW	REVISED -
PLOT SCALE * 1/8"=1'-0"		CHECKED -	REVISED -
PLOT DATE * 4/3/2013		DATE -	REVISED -

**STATE OF ILLINOIS
DEPARTMENT OF TRANSPORTATION**

STAGE I CONSTRUCTION DETAILS

SCALE: SHEET NO. 1 OF 1 SHEETS STA. TO STA.

F.A.P. RTE.	SECTION	COUNTY	TOTAL SHEETS	SHEET NO.
623	(IHR)I-2	LASALLE	11	5
CONTRACT NO. 66C80				
ILLINOIS FED. AID PROJECT				

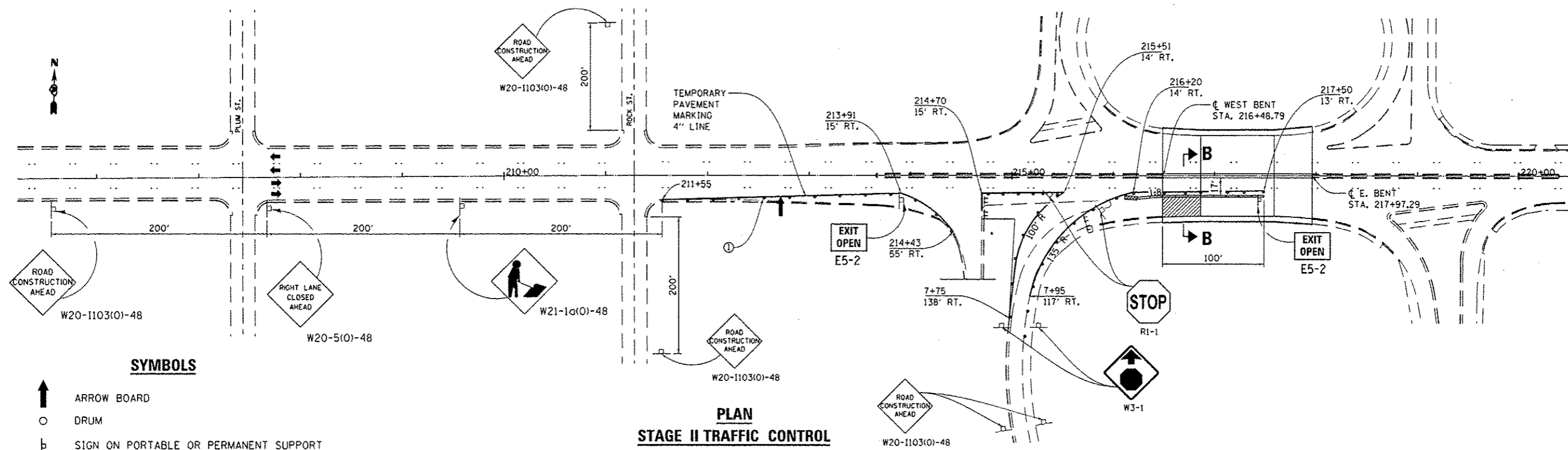

SYMBOLS

- ↑ ARROW BOARD
- DRUM
- ⊢ SIGN ON PORTABLE OR PERMANENT SUPPORT
- ▨ WORK AREA
- ⚡ TYPE III BARRICADE WITH FLASHING LIGHTS
- FLAGGER WITH TRAFFIC CONTROL SIGN
- ▩ TEMPORARY IMPACT ATTENUATORS

**PLAN
STAGE II TRAFFIC CONTROL**

① DRUMS AT 25' CTS. TYPICAL

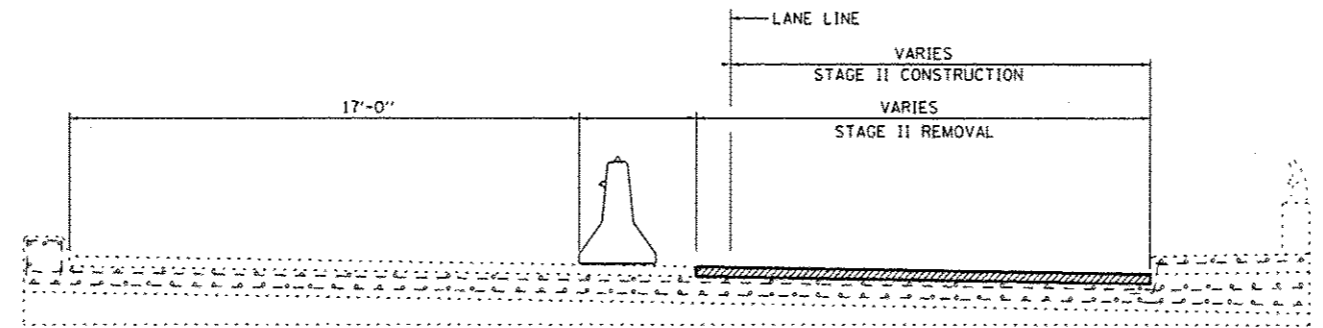

SECTION B-B

GENERAL NOTES

THIS STANDARD IS USED WHERE AT ANY TIME, DAY OR NIGHT, ANY VEHICLE, EQUIPMENT, WORKERS OR THEIR ACTIVITIES ENCROACH ON THE PAVEMENT REQUIRING THE CLOSURE OF ONE OR MORE TRAFFIC LANES IN AN URBAN AREA.

TRAFFIC CONTROL AND PROTECTION FOR STAGE I AND STAGE IV CONSTRUCTION OPERATIONS SHALL BE ACCORDING TO TRAFFIC CONTROL AND PROTECTION, STANDARD 701601 AND AS DIRECTED BY THE ENGINEER.

FILE NAME : c:\p\work\hwydot\woodshenk\11d0332461\1	USER NAME : woodshenk-1	DESIGNED - RW	REVISED -	STATE OF ILLINOIS DEPARTMENT OF TRANSPORTATION	TRAFFIC CONTROL AND PROTECTION STANDARD 701601 (SPECIAL)	F.A.P. RTE.	SECTION	COUNTY	TOTAL SHEETS	SHEET NO.
	366C08-shr-details.dgn	DRAWN - RW	REVISED -			623	(1HBR)-2	LASALLE	11	6
	PLOT SCALE = 1/8"=1'-0"	CHECKED -	REVISED -		SCALE:	SHEET NO. 1 OF 1 SHEETS	STA.	TO STA.	ILLINOIS FED. AID PROJECT CONTRACT NO. 66C80	
	PLOT DATE = 4/8/2013	DATE -	REVISED -							

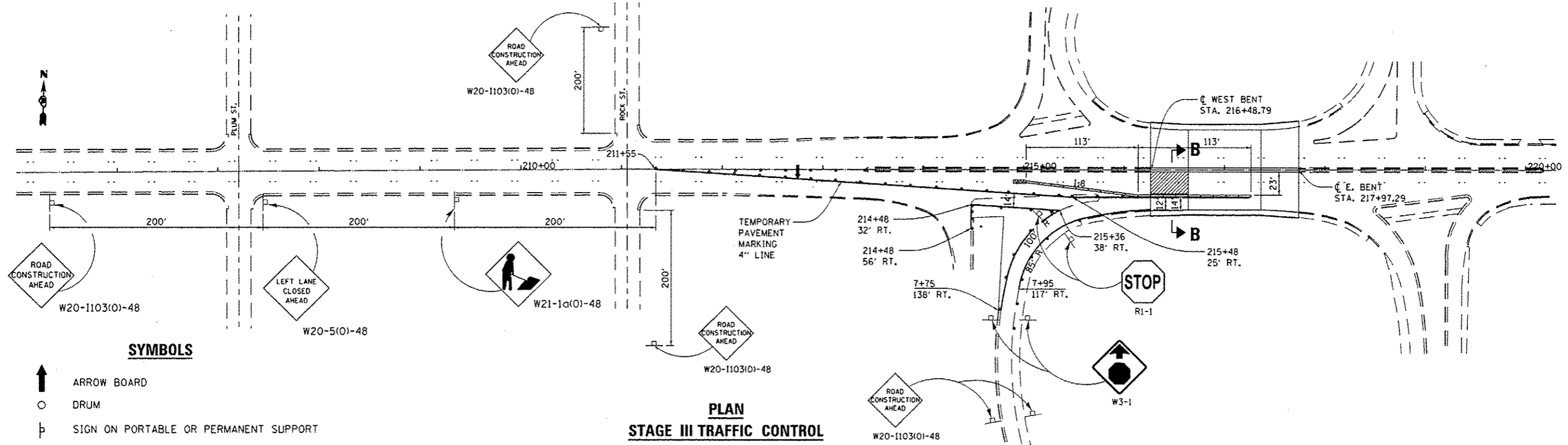

PLAN
STAGE III TRAFFIC CONTROL

① DRUMS AT 25' CTS. TYPICAL

SYMBOLS

- ↑ ARROW BOARD
- DRUM
- ⊥ SIGN ON PORTABLE OR PERMANENT SUPPORT
- ▨ WORK AREA
- ⚡ TYPE III BARRICADE WITH FLASHING LIGHTS
- FLAGGER WITH TRAFFIC CONTROL SIGN
- ▩ TEMPORARY IMPACT ATTENUATORS

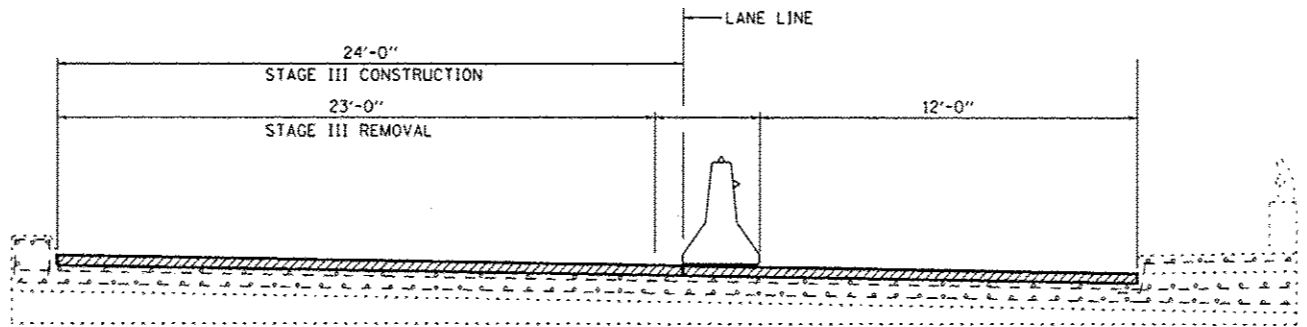

SECTION B-B

GENERAL NOTES

THIS STANDARD IS USED WHERE AT ANY TIME, DAY OR NIGHT, ANY VEHICLE, EQUIPMENT, WORKERS OR THEIR ACTIVITIES ENCR OACH ON THE PAVEMENT REQUIRING THE CLOSURE OF ONE OR MORE TRAFFIC LANES IN AN URBAN AREA.

TRAFFIC CONTROL AND PROTECTION FOR STAGE I AND STAGE IV CONSTRUCTION OPERATIONS SHALL BE ACCORDING TO TRAFFIC CONTROL AND PROTECTION, STANDARD 701601 AND AS DIRECTED BY THE ENGINEER.

FILE NAME: c:\pwwork\pwwork\woodshank\1\d8322461\366C80-shd-details.dgn	USER NAME: woodshank1	DESIGNED - RW	REVISED -	STATE OF ILLINOIS DEPARTMENT OF TRANSPORTATION	TRAFFIC CONTROL AND PROTECTION STANDARD 701601 (SPECIAL)	F.A.P. R.I.E. 623	SECTION (HBR)I-2	COUNTY LASALLE	TOTAL SHEETS 11	SHEET NO. 7
PLOT SCALE: 1/8" = 1'-0"	CHECKED -	REVISED -	SCALE: SHEET NO. 1 OF 1 SHEETS			STA. TO STA.	ILLINOIS FED. AID PROJECT			
PLOT DATE: 4/8/2013	DATE -	REVISED -	CONTRACT NO. 66C80							

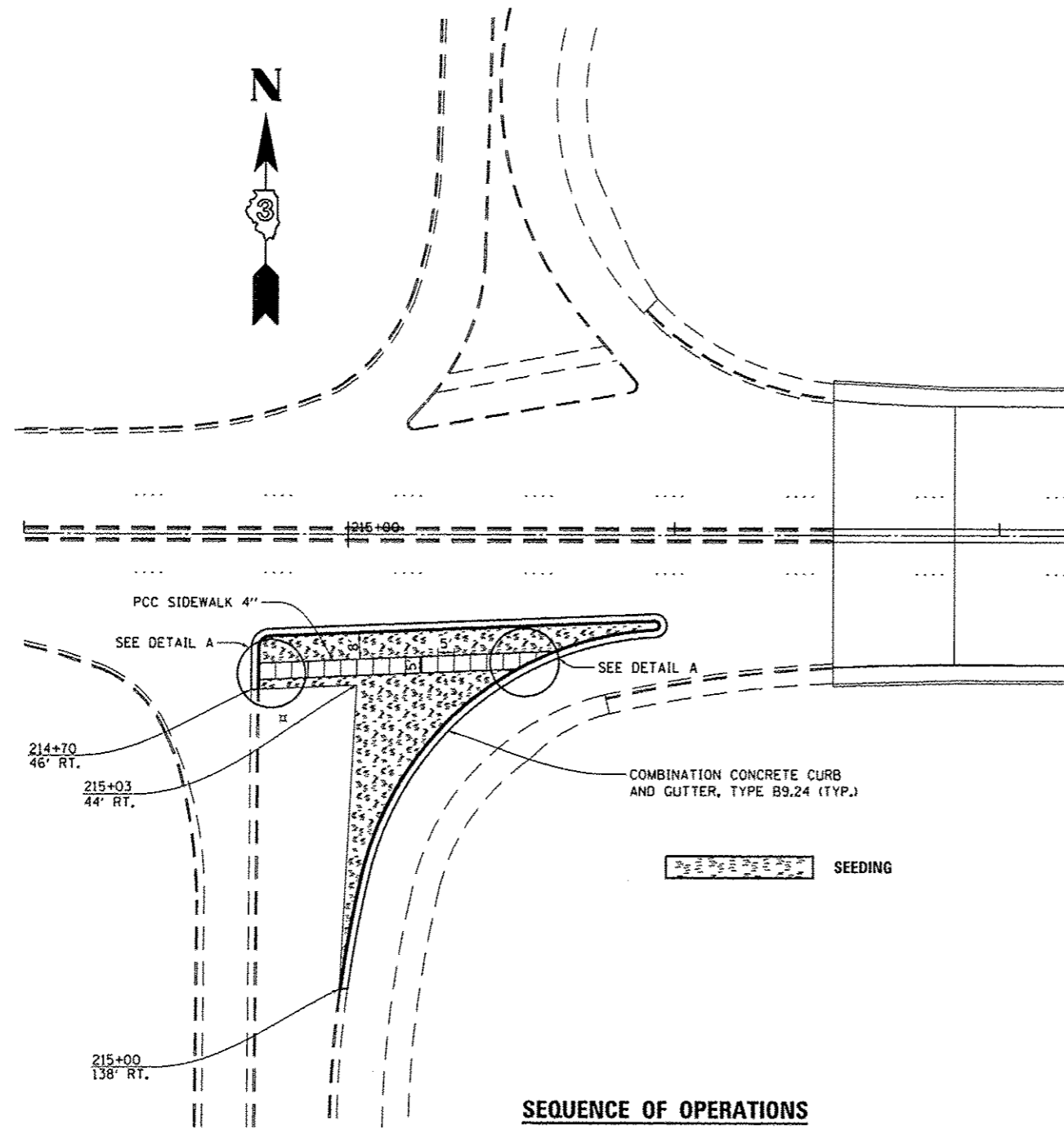

**PLAN
PROPOSED**

SEQUENCE OF OPERATIONS

STAGE IV CONSTRUCTION

1. REMOVE TEMPORARY HOT-MIX ASPHALT PAVEMENT
2. CONSTRUCT COMBINATION CONCRETE CURB AND GUTTER TYPE B9.24
3. CONSTRUCT PORTLAND CEMENT CONCRETE SIDEWALK, 4"
4. PLACE SUITABLE EXCAVATED MATERIALS
5. PLACE FERTILIZER AND SOD.

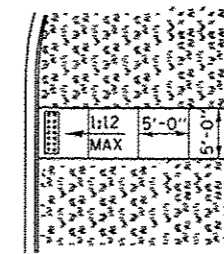

DETAIL A

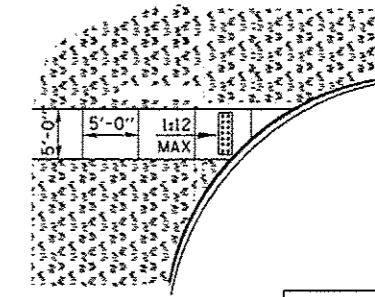

LEGEND	
	PLANTING OR OTHER NON-WALKING SURFACE
	DETECTABLE WARNING

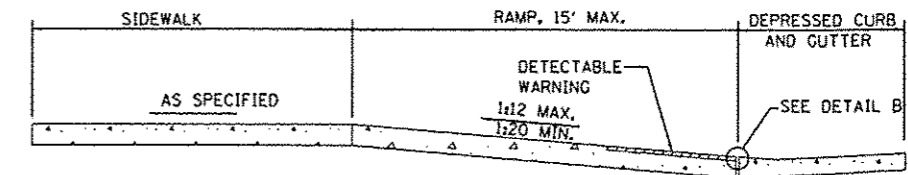

SECTION B-B

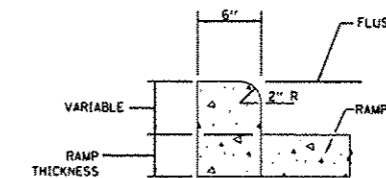

SIDE CURB DETAIL

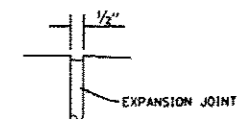

DETAIL B

GENERAL NOTES

THIS STANDARD IS USED WHERE AT ANY TIME, DAY OR NIGHT, ANY VEHICLE, EQUIPMENT, WORKERS OR THEIR ACTIVITIES ENCR OACH ON THE PAVEMENT REQUIRING THE CLOSURE OF ONE OR MORE TRAFFIC LANES IN AN URBAN AREA.

TRAFFIC CONTROL AND PROTECTION FOR STAGE I CONSTRUCTION OPERATIONS SHALL BE ACCORDING TO TRAFFIC CONTROL AND PROTECTION, STANDARD 701201 AND AS DIRECTED BY THE ENGINEER.

FILE NAME =	USER NAME = petelyj	DESIGNED - RW	REVISED -	STATE OF ILLINOIS DEPARTMENT OF TRANSPORTATION	STAGE IV CONSTRUCTION DETAILS	F.A.P. RTE.	SECTION	COUNTY	TOTAL SHEETS	SHEET NO.
c:\pwwork\pedit\petelyj\0332461\036608-shd-detail.dgn	DRAWN - RW	REVISED -	623			(1HBR)1-2	LASALLE	11	8	
PLOT SCALE = 1/8" = 1'-0"	CHECKED -	REVISED -	CONTRACT NO. 66C80							
PLOT DATE = 4/3/2013	DATE -	REVISED -	ILLINOIS FED. AID PROJECT							
				SCALE:	SHEET NO. 1 OF 1 SHEETS	STA.	TO STA.			

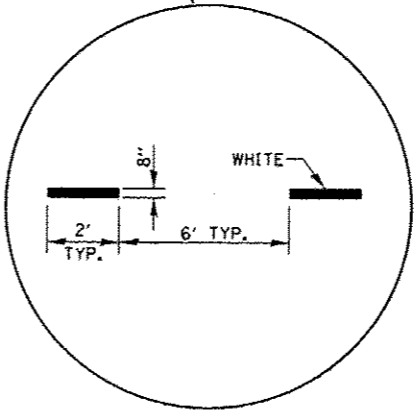
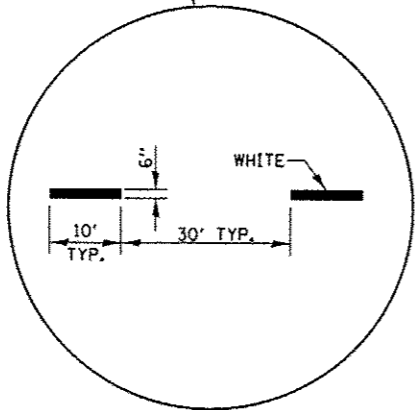
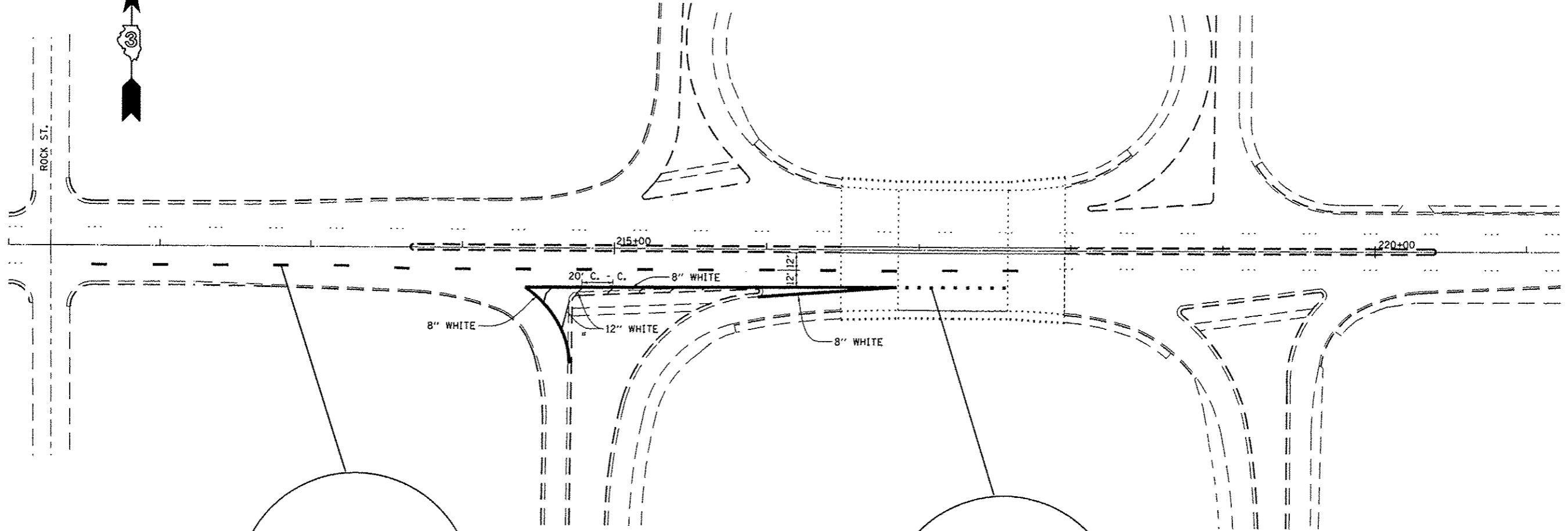

FILE NAME =	USER NAME = patelijj	DESIGNED - RW	REVISED -
ci:\pw_work\pavdoc\patelijj\0332461\0368038-sh\detail.dgn		DRAWN - RW	REVISED -
		CHECKED - RW	REVISED -
		DATE -	REVISED -

**STATE OF ILLINOIS
DEPARTMENT OF TRANSPORTATION**

TYPICAL PAVEMENT MARKINGS

SCALE: SHEET NO. 1 OF 1 SHEETS STA. TO STA.

F.A.P. RTE.	SECTION	COUNTY	TOTAL SHEETS	SHEET NO.
623	(IHDR)1-2	LASALLE	11	9
CONTRACT NO. 66C80				
ILLINOIS FED. AID PROJECT				

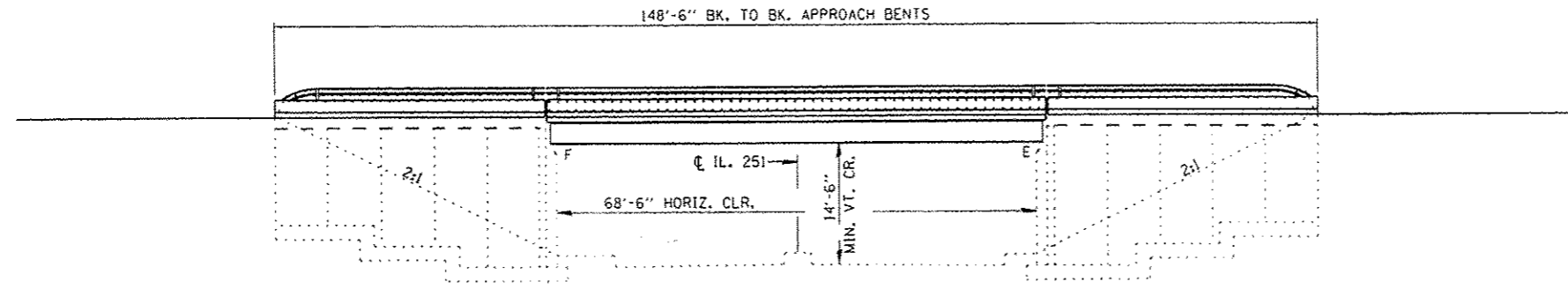

ELEVATION

GENERAL NOTES
 PLAN DIMENSIONS AND DETAILS RELATIVE TO EXISTING PLANS ARE SUBJECT TO NOMINAL CONSTRUCTION VARIATIONS. THE CONTRACTOR SHALL FIELD VERIFY EXISTING DIMENSIONS AND DETAILS AFFECTING NEW CONSTRUCTION AND MAKE NECESSARY APPROVED ADJUSTMENTS PRIOR TO CONSTRUCTION OR ORDERING OF MATERIALS. SUCH VARIATIONS SHALL NOT BE CAUSE FOR ADDITIONAL COMPENSATION FOR A CHANGE IN SCOPE OF WORK; HOWEVER, THE CONTRACTOR WILL BE PAID FOR THE QUANTITY ACTUALLY FURNISHED AT THE UNIT PRICE BID FOR THE WORK.

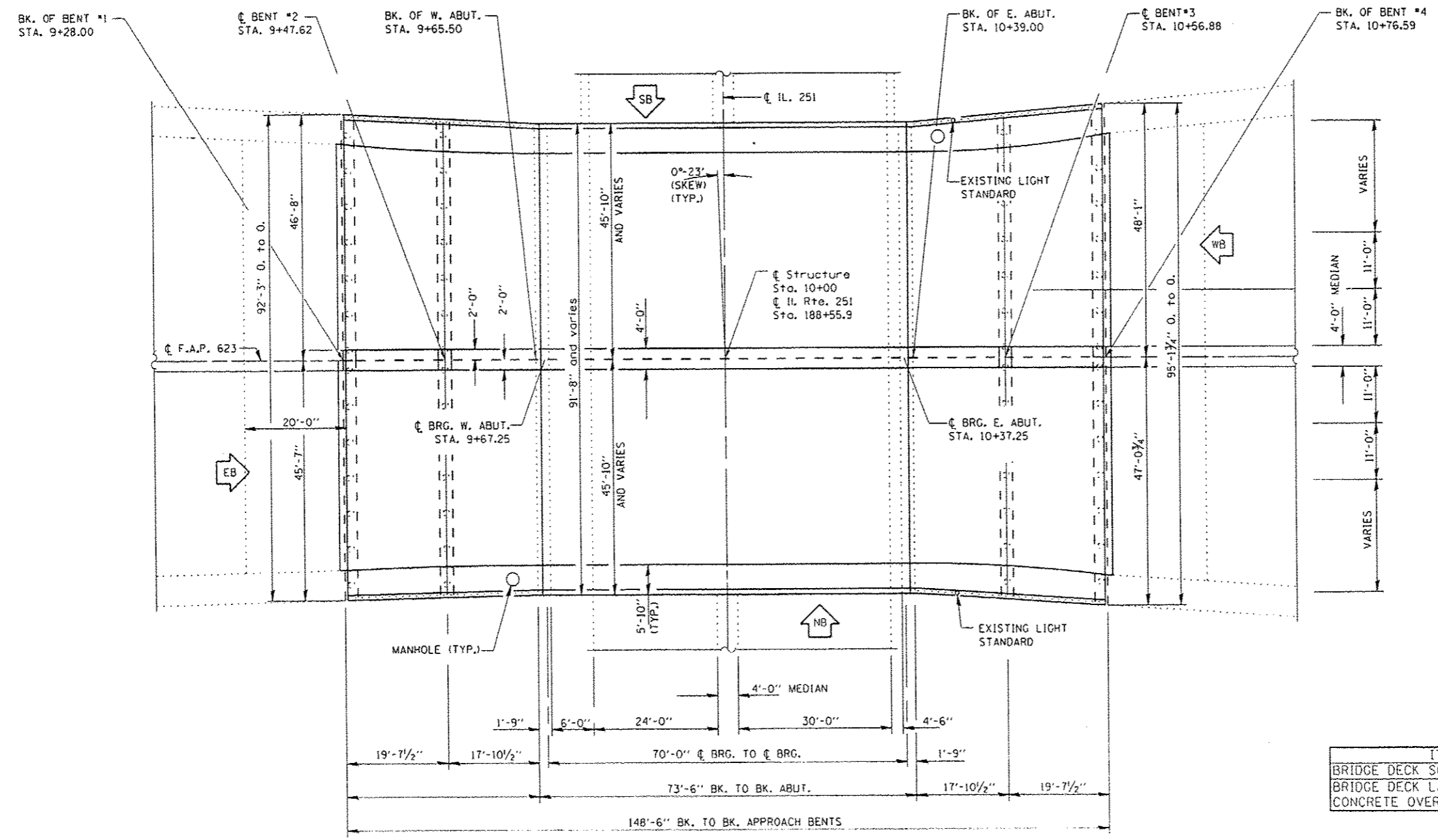

TOTAL BILL OF MATERIAL

ITEM	UNIT	SUPER	SUB	TOTAL
BRIDGE DECK SCARIFICATION 2 1/2"	SQ YD	166		166
BRIDGE DECK LATEX	SO YD	166		166
CONCRETE OVERLAY 2 1/2 INCHES	SO YD			

