

**WEST EDGE OF SHOULDER**

Location	Station	Offset	Theoretical Grade Elevations
S. End S. Appr. Pavmt.	316+53.32	-18.00	488.96
A	316+63.32	-18.00	489.01
B	316+73.32	-18.00	489.06
N. End S. Appr. Pavmt.	316+83.32	-18.00	489.11

**WEST EDGE OF PAVEMENT**

Location	Station	Offset	Theoretical Grade Elevations
S. End S. Appr. Pavmt.	316+56.78	-12.00	489.10
A	316+66.78	-12.00	489.16
B	316+76.78	-12.00	489.21
N. End S. Appr. Pavmt.	316+86.78	-12.00	489.26

**PROFILE GRADE & BASELINE**

Location	Station	Offset	Theoretical Grade Elevations
S. End S. Appr. Pavmt.	316+63.71	0.00	489.33
A	316+73.71	0.00	489.38
B	316+83.71	0.00	489.43
N. End S. Appr. Pavmt.	316+93.71	0.00	489.48

**EAST EDGE OF PAVEMENT**

Location	Station	Offset	Theoretical Grade Elevations
S. End S. Appr. Pavmt.	316+70.64	12.00	489.17
A	316+80.64	12.00	489.23
B	316+90.64	12.00	489.28
N. End S. Appr. Pavmt.	317+00.64	12.00	489.33

**EAST EDGE OF SHOULDER**

Location	Station	Offset	Theoretical Grade Elevations
S. End S. Appr. Pavmt.	316+76.41	22.00	489.00
A	316+86.41	22.00	489.05
B	316+96.41	22.00	489.10
N. End S. Appr. Pavmt.	317+06.41	22.00	489.15

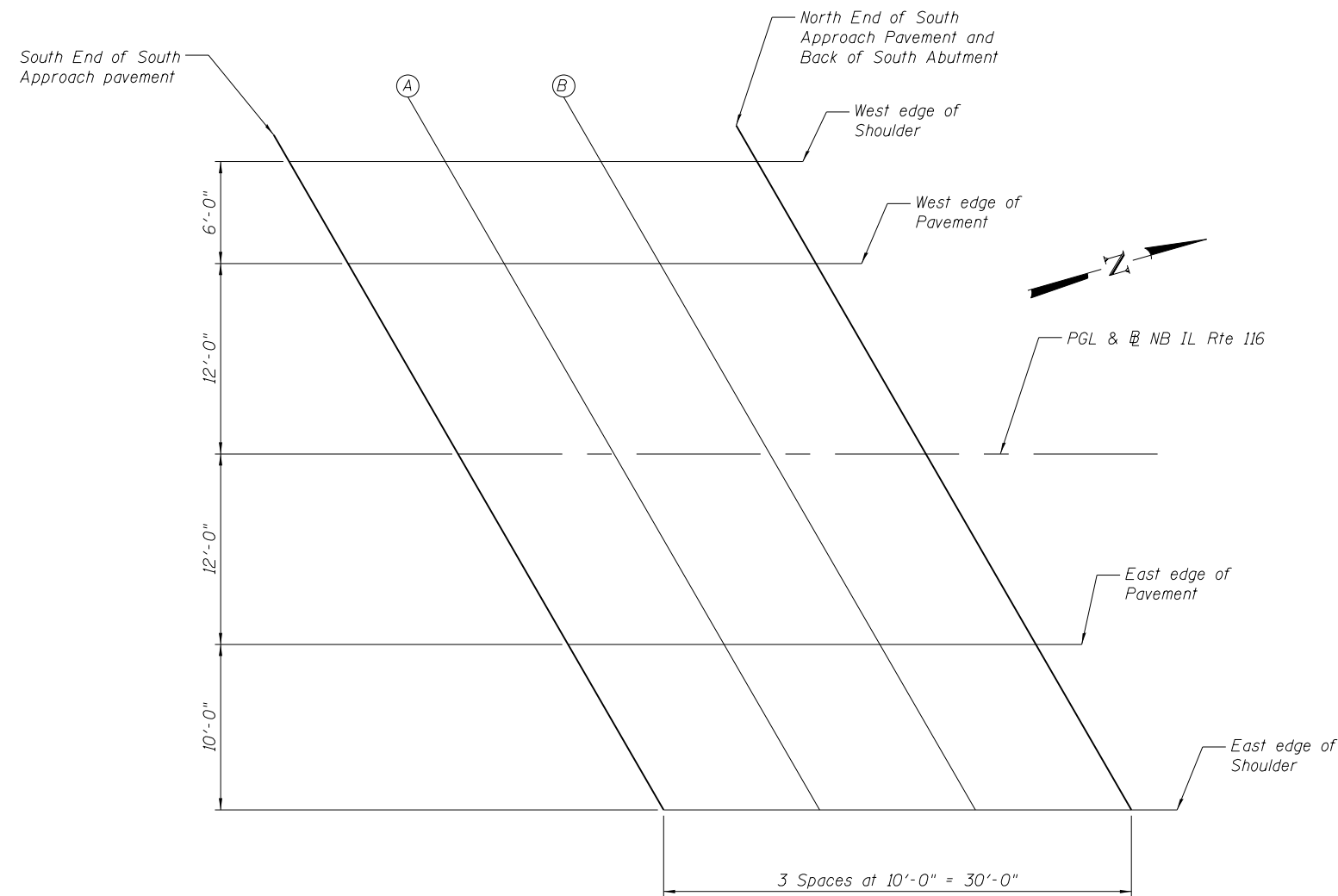

**PLAN**  
South Approach

T:\Projects\10-221\1001-102B-Edges\_Ten Mile Creek-Phase II\Drawings\Structural\Final Plans\SHEETS\006-TOS-S.Appr-Elevs.dgn



USER NAME = WAH  
FILE NAME = D468671-006-TOS-S.Appr-Elevs.dgn  
PLOT DATE = 10/5/2012

DESIGNED - OY  
CHECKED - DB  
DRAWN - CM  
CHECKED - JB

REVISED -  
REVISED -  
REVISED -  
REVISED -

**STATE OF ILLINOIS  
DEPARTMENT OF TRANSPORTATION**

**TOP OF SOUTH APPROACH SLAB ELEVATIONS  
STRUCTURE NO. 090-0179**

SHEET NO. S06 OF S22 SHEETS

F.A.P. RTE.	SECTION	COUNTY	TOTAL SHEETS	SHEET NO.
673	(102B-1) BR	TAZEWELL	89	49
CONTRACT NO. 68671				

ILLINOIS FED. AID PROJECT