

WEST EDGE OF SHOULDER

Location	Station	Offset	Theoretical Grade Elevations
S. End N. Appr. Pavmt.	318+66.20	-18.00	490.05
C	318+76.20	-18.00	490.10
D	318+86.20	-18.00	490.15
N. End N. Appr. Pavmt.	318+96.20	-18.00	490.20

WEST EDGE OF PAVEMENT

Location	Station	Offset	Theoretical Grade Elevations
S. End N. Appr. Pavmt.	318+69.66	-12.00	490.19
C	318+79.66	-12.00	490.24
D	318+89.66	-12.00	490.30
N. End N. Appr. Pavmt.	318+99.66	-12.00	490.35

PROFILE GRADE & BASELINE

Location	Station	Offset	Theoretical Grade Elevations
S. End N. Appr. Pavmt.	318+76.59	0.00	490.42
C	318+86.59	0.00	490.47
D	318+96.59	0.00	490.52
N. End N. Appr. Pavmt.	319+06.59	0.00	490.57

EAST EDGE OF PAVEMENT

Location	Station	Offset	Theoretical Grade Elevations
S. End N. Appr. Pavmt.	318+83.52	12.00	490.26
C	318+93.52	12.00	490.32
D	319+03.52	12.00	490.37
N. End N. Appr. Pavmt.	319+13.52	12.00	490.42

EAST EDGE OF SHOULDER

Location	Station	Offset	Theoretical Grade Elevations
S. End N. Appr. Pavmt.	318+89.29	22.00	490.09
C	318+99.29	22.00	490.14
D	319+09.29	22.00	490.19
N. End N. Appr. Pavmt.	319+19.29	22.00	490.24

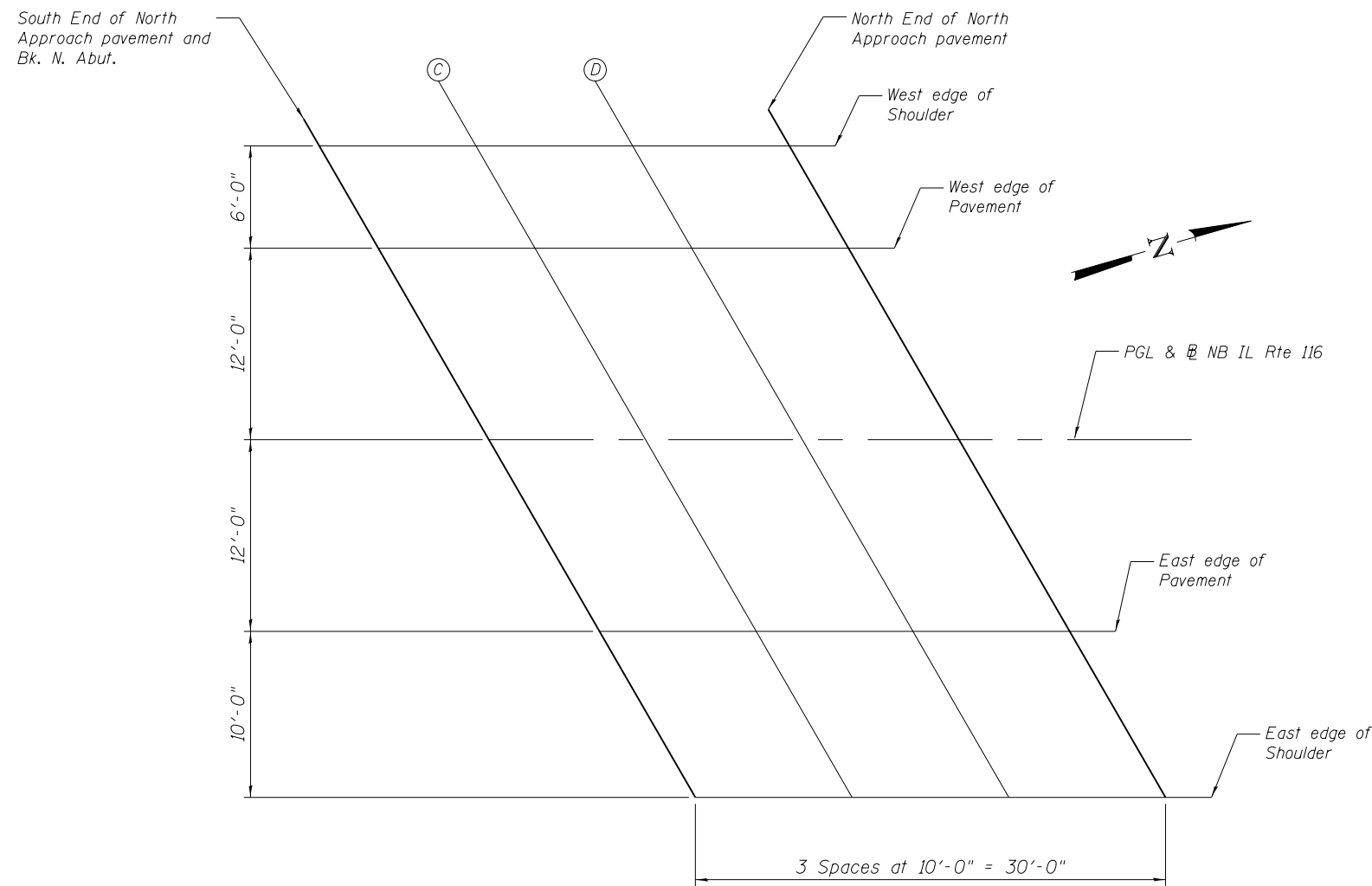

PLAN

North Approach

T:\Projects\10-221\1001-102B\edges_Ten Mile Creek-Phase II\Drawings\Structural\Final Plans\SHEETS\0468671-007-TOS-N.Appr-Elevs.dgn



USER NAME = WAH	DESIGNED - OY	REVISED -
FILE NAME = D468671-007-TOS-N.Appr-Elevs.dgn	CHECKED - DB	REVISED -
PLOT DATE = 10/5/2012	DRAWN - CM	REVISED -
	CHECKED - JB	REVISED -

**STATE OF ILLINOIS
DEPARTMENT OF TRANSPORTATION**

**TOP OF NORTH APPROACH SLAB ELEVATIONS
STRUCTURE NO. 090-0179**

SHEET NO. S07 OF S22 SHEETS

F.A.P. RTE.	SECTION	COUNTY	TOTAL SHEETS	SHEET NO.
673	(102B-1) BR	TAZEWELL	89	50
CONTRACT NO. 68671			ILLINOIS FED. AID PROJECT	