

STRUCTURE TABLE (STORM SEWERS AND INLETS)										
STR. #	O/S	STA.	STR. TYPE	FRAME & GRATE	FRAME & LID	ROAD C/L ELEV.	RIM ELEV. (F/L GUTTER)	TOP OF MASONRY ELEV.	F/L IN	F/L OUT
11	LT. 28.00'	30+85	INLET TYPE B	TYPE 20	-	746.48	745.68	744.93	-	741.20
12	LT. 34.63'	32+41	INLET TYPE B	-	TYPE 1	740.54	739.00	738.25	735.09	735.00

NOTE: O/S ARE FROM CH 50 ALIGNMENT TO CENTER OF STRUCTURE.

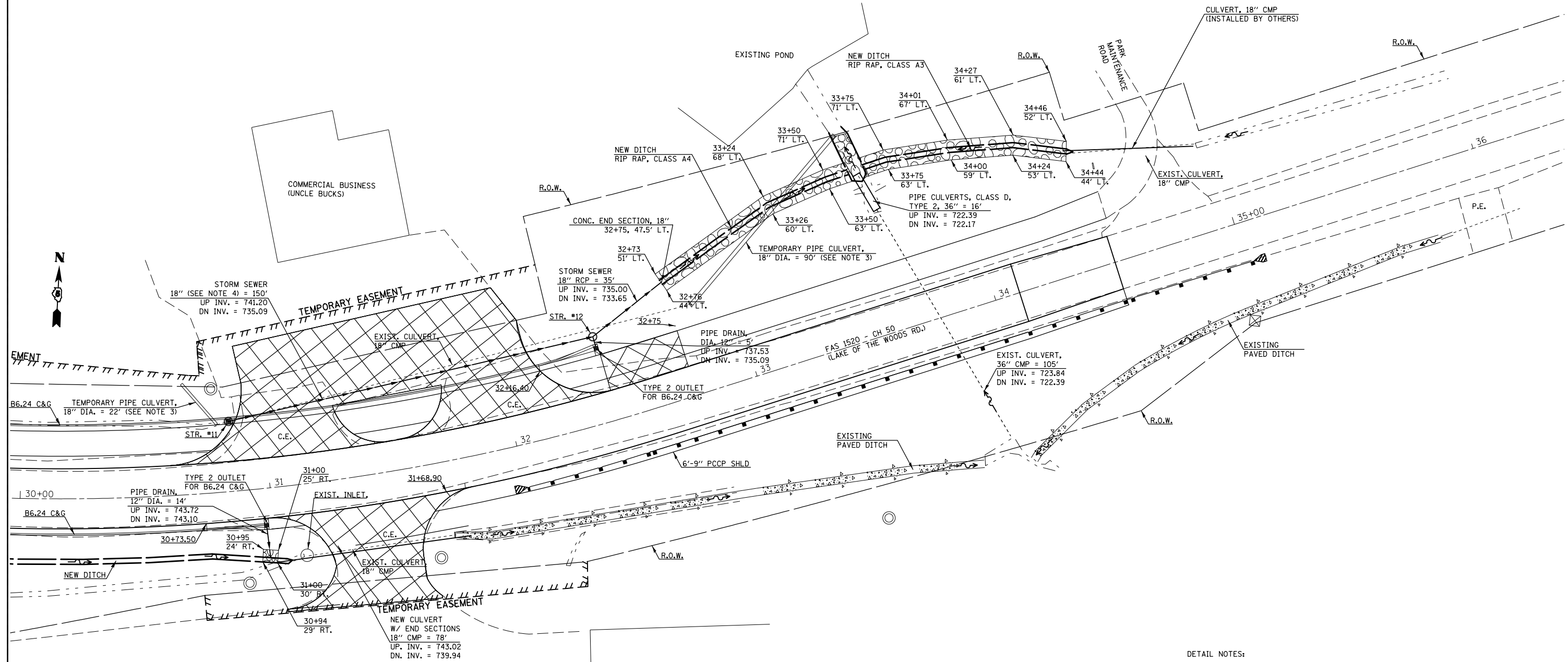

- DETAIL NOTES:
- SEE STANDARD 606006-02 FOR B6.24 CURB AND GUTTER OUTLETS.
  - LOCATIONS AND DIMENSIONS FOR STONE RIP RAP, CLASS A3 MAY VARY AND BE ADJUSTED IN THE FIELD BY THE ENGINEER.
  - TEMPORARY PIPE CULVERTS SHALL BE INSTALLED DURING CONSTRUCTION OF TEMPORARY ACCESS ROADWAY PHASE II AND SHALL BE REMOVED WHEN TEMPORARY ACCESS ROADWAY PHASE II IS REMOVED. SEE TEMPORARY ACCESS ROADWAY PHASE I, II, & III DETAILS FOR ADDITIONAL INFORMATION.
  - DUE TO PROXIMITY TO EXISTING WATER MAIN STORM SEWER FROM STRUCTURE #11 TO STRUCTURE #12 SHALL BE RUBBER GASKET, CLASS A, TYPE 1 18\".

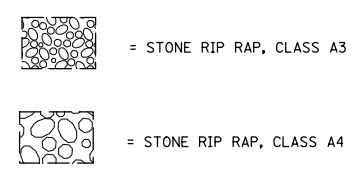

FILE NAME =	USER NAME = ceerlockbm	DESIGNED BMC	REVISED -
ce:\pw\work\p\midot\ceerlockbm\d0208368\0570700-sht-drain.dgn		DRAWN BMC	REVISED -
PLOT SCALE = 40.0000' / in.		CHECKED -	REVISED -
PLOT DATE = 11/9/2012		DATE 5-2-12	REVISED -

**STATE OF ILLINOIS  
DEPARTMENT OF TRANSPORTATION**

<b>DRAINAGE PLAN DETAILS CH 50 - LAKE OF THE WOODS RD.</b>		
SCALE: N/A	SHEET NO. 4 OF 4 SHEETS	STA. ----- TO STA. -----

F.A.I. RTE.	SECTION	COUNTY	TOTAL SHEETS	SHEET NO.
74	10-4BR	CHAMPAIGN	290	68
CONTRACT NO. 70700			ILLINOIS FED. AID PROJECT	