

INDEX OF SHEETS

- 1 COVER SHEET
- 2 GENERAL NOTES
- 3-7 SUMMARY OF QUANTITIES
- 8-22 SCHEDULE OF QUANTITIES
- 23-30 TYPICAL CROSS SECTIONS
- 31-48 PLAN SHEETS
- 49-55 PAVEMENT MARKING SHEETS
- 56, 57 BUTT-JOINT DETAILS
- 58-60 ENTRANCE /SIDEROAD DETAILS
- 61, 62 GUARDRAIL DETAILS

STANDARDS

000001-06 630301-06 701501-06
001006 631011-09 701801-05
406201-01 635006-03 701901-02
424001-07 635011-02 720001-01
442001-04 642006 720006-03
442101-07 701006-04 720011-01
442201-03 701201-04 728001-01
482006-03 701301-04 729001-01
606301-04 701306-03 731001-01
630001-10 701311-03 780001-03
630106-01 701326-04 781001-03

HIGHWAY CLASSIFICATION: US 136 - OTHER PRINCIPAL ARTERIAL

ADT = 2,400 (2011) 2,928 (2031)
SU = 21.4%
MU = 11.2%

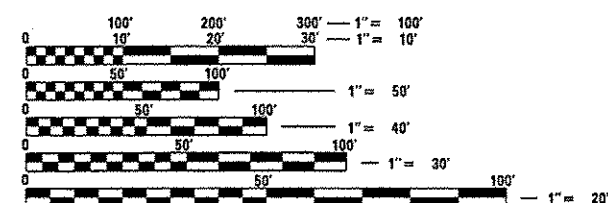

FULL SIZE PLANS HAVE BEEN PREPARED USING STANDARD
ENGINEERING SCALES. REDUCED SIZED PLANS WILL NOT
CONFORM TO STANDARD SCALES. IN MAKING MEASUREMENTS
ON REDUCED PLANS, THE ABOVE SCALES MAY BE USED.

J.U.L.I.E.
JOINT UTILITY LOCATION INFORMATION FOR EXCAVATION
1-800-892-0123
OR 811

SENIOR TEAM ENGINEER: VINCE MADONIA - (217)785-9046
TEAM MANAGER: TIM SLAGLE - (217)785-5538

CONTRACT NO. 72E03

STATE OF ILLINOIS DEPARTMENT OF TRANSPORTATION DIVISION OF HIGHWAYS

PROPOSED HIGHWAY PLANS FAP ROUTE 315 (US 136) SECTION (H)RS-2, (124)RS-3, (116)RS RESURFACING (3P), SHOULDER RECONSTRUCTION MASON COUNTY C-96-023-11 PROJECT NO. ACNH-F-0315(063)

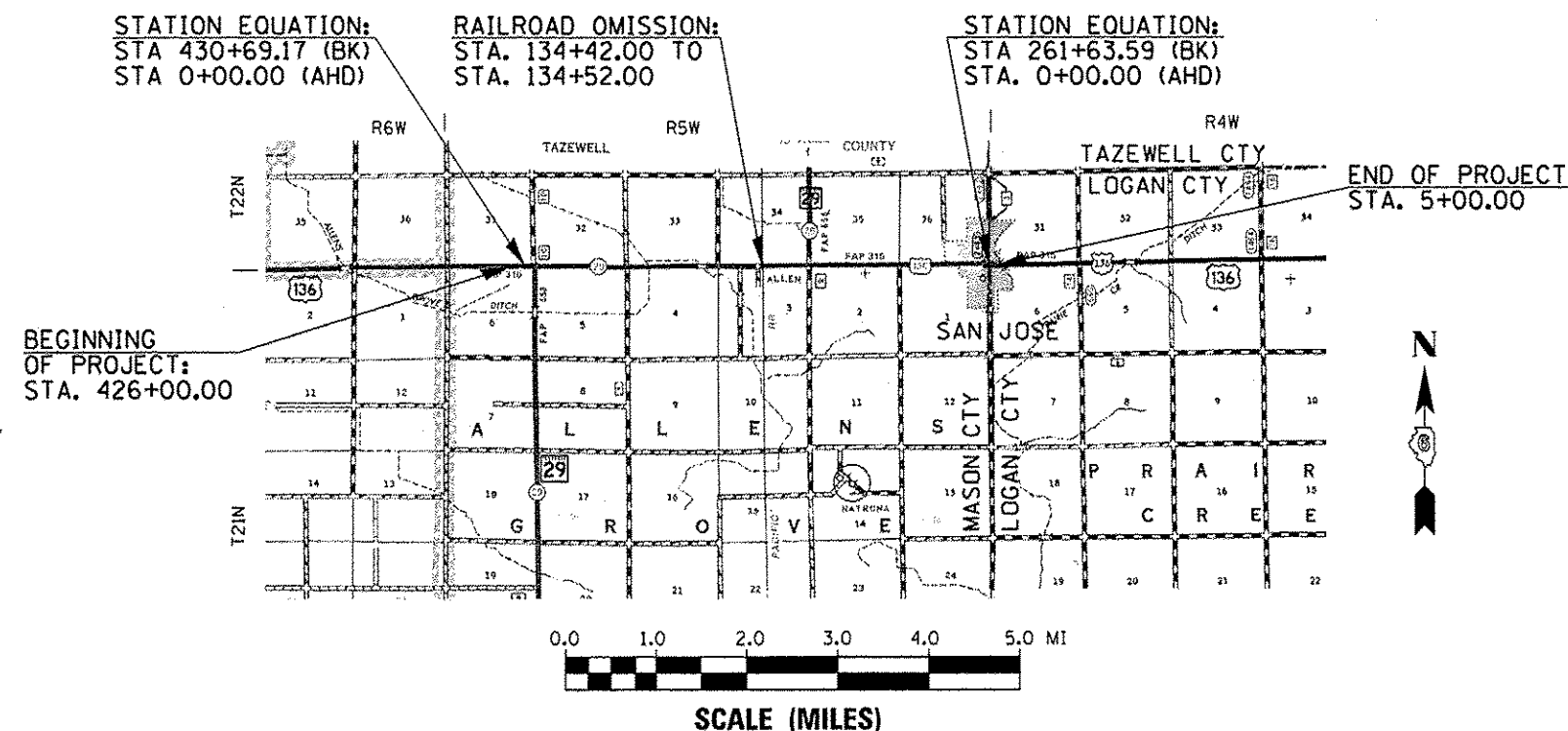

LOCATION MAP

GROSS LENGTH = 27,244.80 FT. = 5.16 MILE
NET LENGTH = 27,091.35 FT. = 5.13 MILE

F.A.P. RTE.	SECTION	COUNTY	TOTAL SHEETS	SHEET NO.
315	(H)RS-2, (124)RS-3, (116)RS	MASON	62	1
ILLINOIS CONTRACT NO. 72E03				

D-96-023-11

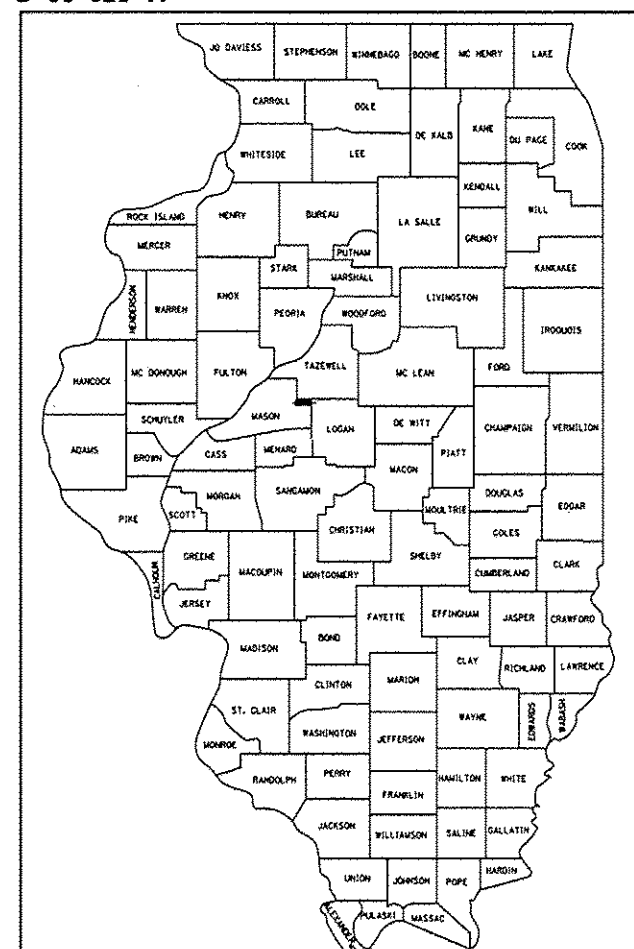

LOCATION OF SECTION INDICATED THUS: -

STATE OF ILLINOIS DEPARTMENT OF TRANSPORTATION DIVISION OF HIGHWAYS

SUBMITTED December 14, 2012
R. J. Smith
DEPUTY DIRECTOR OF HIGHWAYS, REGION ENGINEER
March 22, 2013
John D. Baranzelle, P.E.
ENGINEER OF DESIGN AND ENVIRONMENT
March 22, 2013
Omer Osman, P.E.
DIRECTOR OF HIGHWAYS, CHIEF ENGINEER

PRINTED BY THE AUTHORITY
OF THE STATE OF ILLINOIS