

DEAD LOAD DEFLECTION DIAGRAM

(Includes weight of concrete only.)

Note:

The above deflections are not to be used in the field if the engineer is working from the grade elevations adjusted for dead load deflections as shown on sheets 6-8 of 53.

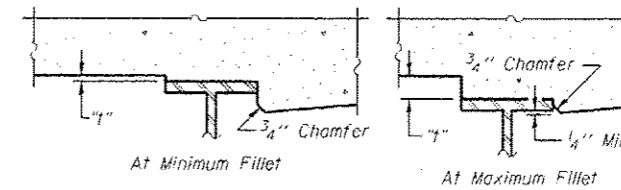

To determine "I": After all structural steel has been erected, elevations of the top flanges of the girders shall be taken at intervals shown below. These elevations subtracted from the "Theoretical Grade Elevations Adjusted for Dead Load Deflection" shown on sheets 6-8 of 53, minus slab thickness, equals the fillet heights "I" above top flange of girders.

FILLET HEIGHTS

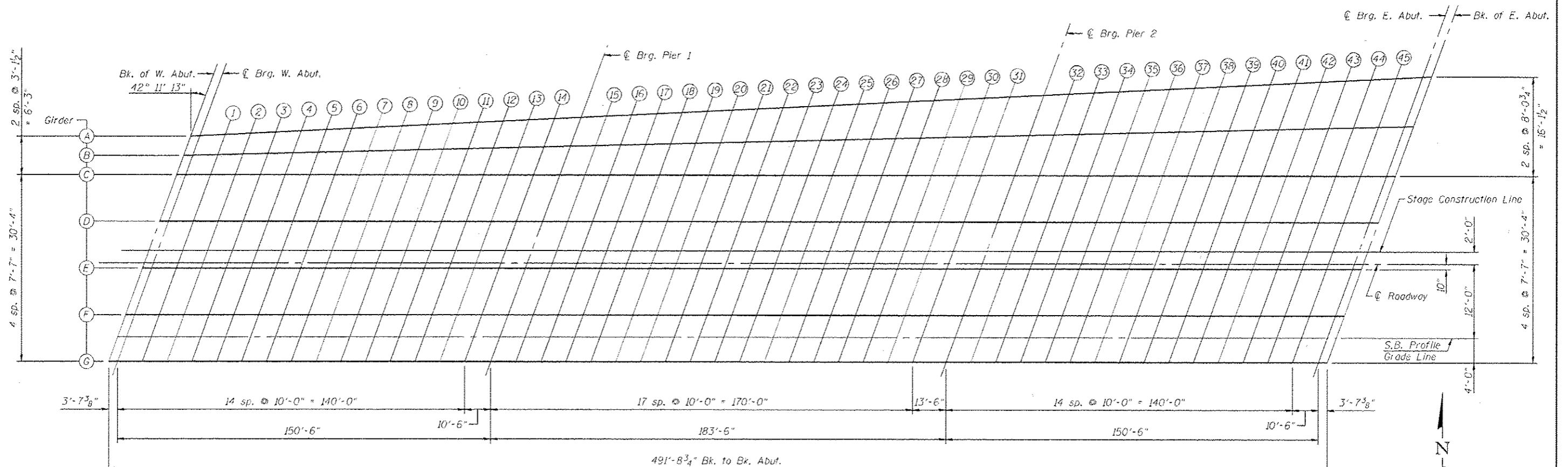

PLAN

REV. SHEET C-3-13



JOB • 2265.2
 FILE • 0540060.0061-72E11-05-00-ToS-SB.dgn
 DATE • 5/14/2013

DESIGNED - ANN
 CHECKED - MDC
 DRAWN - SJS
 CHECKED - MDC

REVISED -
 REVISED -
 REVISED -
 REVISED -

STATE OF ILLINOIS
 DEPARTMENT OF TRANSPORTATION

TOP OF SLAB ELEVATIONS
 STRUCTURE NO. 054-0060 (SB)

SHEET NO. 5 OF 53 SHEETS

F.A.I. RTE.	SECTION	COUNTY	TOTAL SHEETS	SHEET NO.
55	D6 LOGAN CO BR 2011-1	LOGAN	429	235
CONTRACT NO. 72E11				
ILLINOIS FED. AID PROJECT				