

**NOTE**

Plan elevations relative to the existing structure have been taken from existing plans and reduced by 0.38 feet to match benchmark datum.

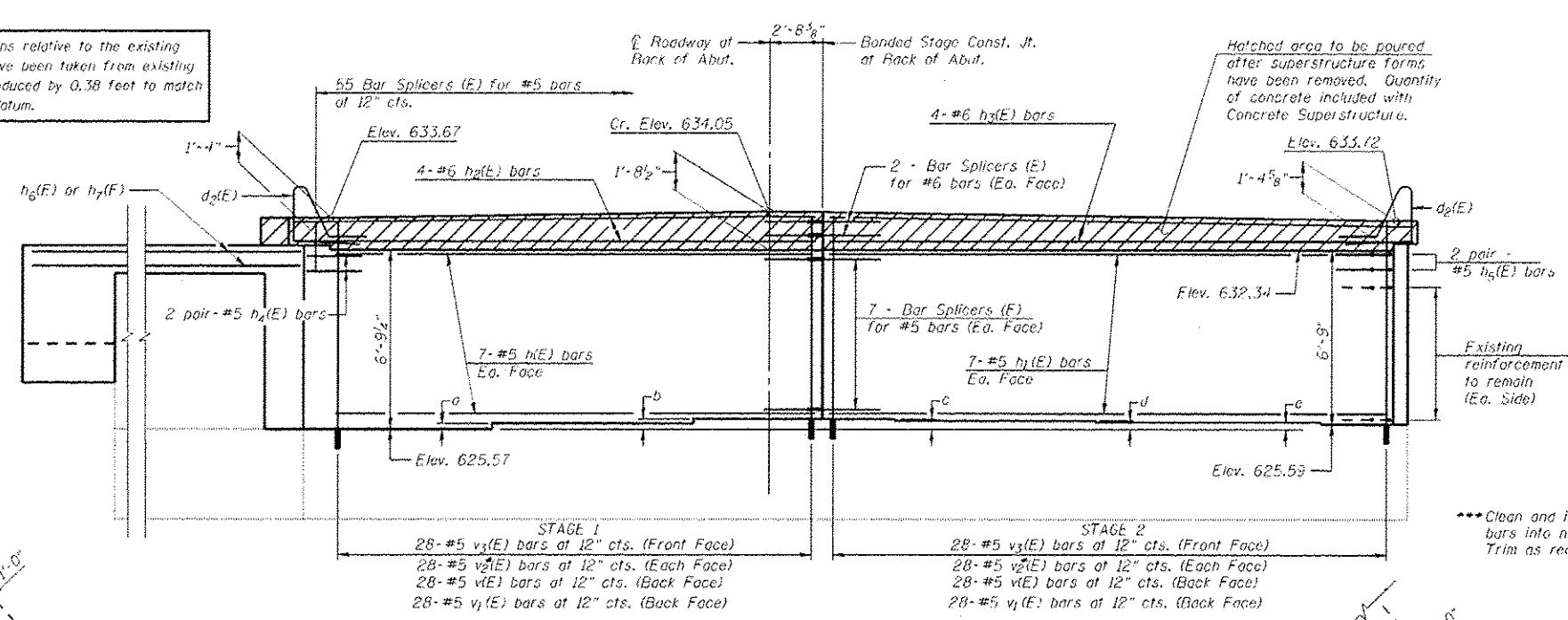

**ELEVATION**

(Looking West - W. Abut. - S.B.)

**TABLE OF EXISTING STEP HEIGHTS**

West Abutment (S.B.)	a	b	c	d	e
	2"	3 5/8"	2 3/4"	7 1/8"	8"

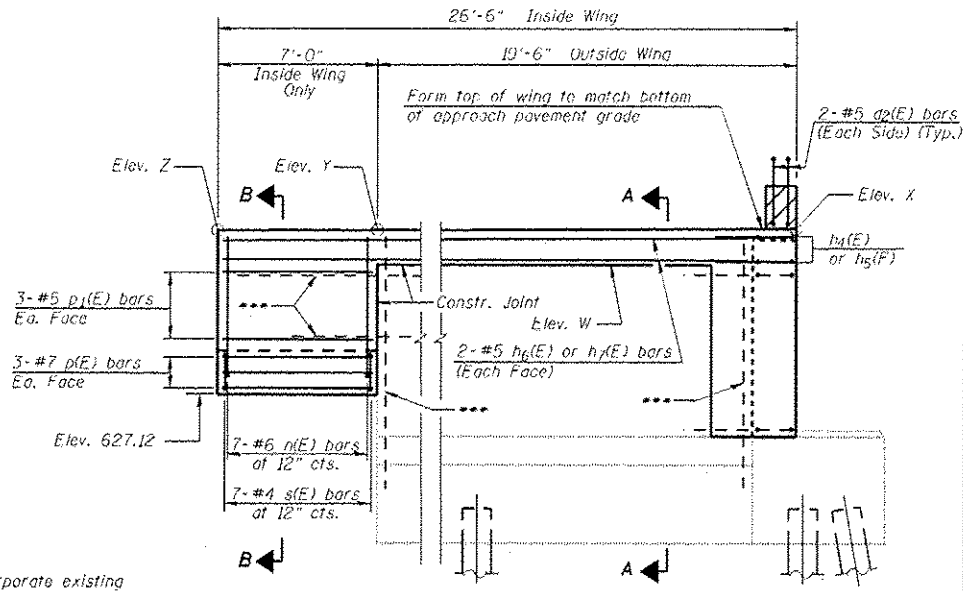

**WINGWALL ELEVATION**

Elev.	West Abut. - S.B.	
	Inside Wing	Outside Wing
W	631.64	631.67
X	632.42	632.47
Y	632.32	632.38
Z	632.29	-

**ABUTMENT**

**BILL OF MATERIAL**

Bar No.	Size	Length	Shape
d2(E)	4 #5	7'-11"	⊏
n(E)	14 #5	26'-9"	⊏
h1(E)	14 #5	27'-6"	⊏
h2(E)	4 #6	27'-10"	⊏
h3(E)	4 #6	28'-0"	⊏
h4(E)	4 #5	5'-0"	⊏
h5(E)	4 #5	5'-0"	⊏
h6(E)	4 #5	19'-2"	⊏
h7(E)	4 #5	25'-3"	⊏
n(E)	7 #6	9'-1"	⊏
p(E)	6 #7	6'-8"	⊏
d1(E)	6 #5	6'-8"	⊏
s(E)	7 #4	7'-5"	⊏
v(E)	56 #5	3'-9"	⊏
v1(E)	56 #5	4'-6"	⊏
v2(E)	112 #5	6'-3"	⊏
v3(E)	56 #5	3'-2"	⊏
Structure Excavation	Cu. Yd.	151	
Concrete Structures	Cu. Yd.	24.5	
Reinforcement Bars, Epoxy Coated	Pound	3040	
Bar Splicers	Each	73	
Concrete Sealer	Sq. Ft.	381	

**Notes:**  
 All bars designated with an asterisk (ex: v3(E)) shall be epoxy grouted in accordance with Section 584 of the Standard Specifications. Minimum embedment = 9". Locate bars to miss existing reinforcement.  
 Existing wingwall reinforcement shall be cleaned and incorporated into the new construction. Cost included with Concrete Removal.  
 Existing vertical bars in backwall shall be cut off and covered with a layer of epoxy. Cost included with Concrete Removal.  
 Concrete Sealer shall be applied to the front face of the backwall.  
 See Sheet 22 for point block details of hatch block.  
 See Section Thru West Abutment on Sheet 46 of 53.

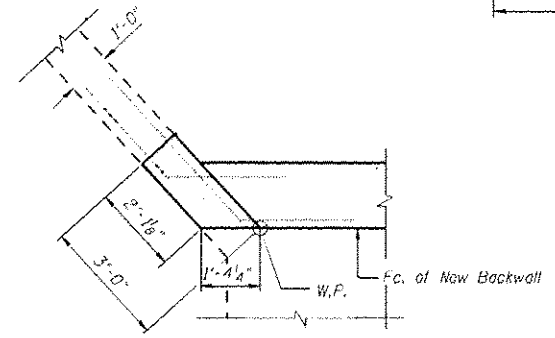

**CORNER DETAIL E**  
(hatch block above not shown)

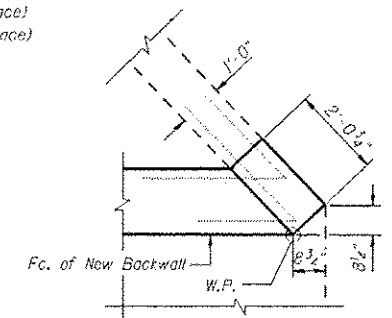

**CORNER DETAIL F**  
(hatch block above not shown)

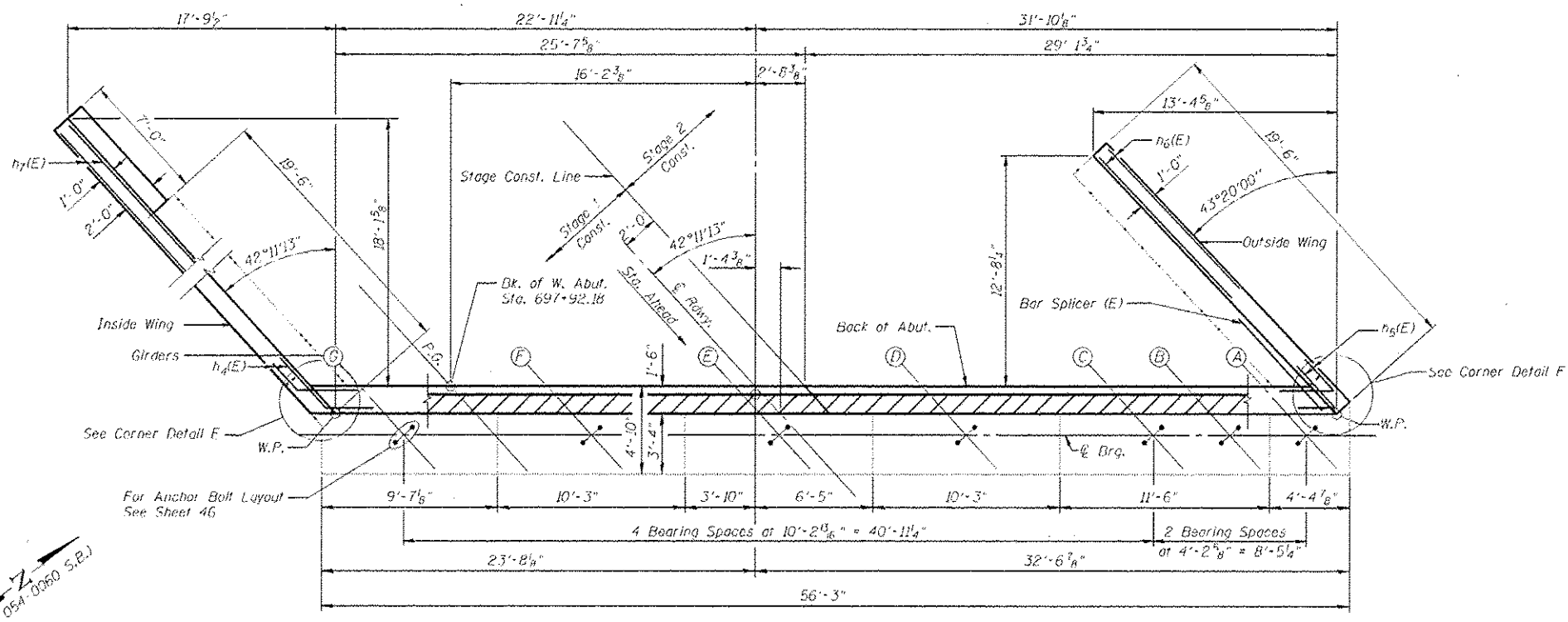

**PLAN**

**REV. SHEET 0-3-13** (West Abutment - S.B.)



JOB	• 2265.2	DESIGNED	- AAN	REVISED	-
FILE	• 054-0060.0061-72E11-42-43-Abut-58.dwg	CHECKED	- MDC	REVISED	-
DATE	• 5/14/2013	DRAWN	- SJS	REVISED	-
		CHECKED	- TSH	REVISED	-

**STATE OF ILLINOIS**  
**DEPARTMENT OF TRANSPORTATION**

**WEST ABUTMENT DETAILS**  
**STRUCTURE NO. 054-0060 (SB)**  
 SHEET NO. 42 OF 53 SHEETS

F.A.I. RTE.	SECTION	COUNTY	TOTAL SHEETS	SHEET NO.
55	D6 LOGAN CO BR 2011-1	LOGAN	429	272
				CONTRACT NO. 72E11
ILLINOIS FED. AID PROJECT				