

**GENERAL NOTES**

Fasteners shall be ASTM A325 Type 1, mechanically galvanized bolts 3/4" diameter, holes 1/16" diameter, unless otherwise noted.

No field welding is permitted except as specified in contract documents.

The Contractor shall test the existing welds by non-destructive methods within 2 ft. of the end of the existing cover plates for cracks after removal of the existing concrete deck. Dye penetrant (PT), magnetic particle (MT), or other approved testing method shall be performed by qualified personnel approved by the Engineer. If cracks are found, report them to the Bureau of Bridges and Structures for disposition. The cost of testing is included in Removal of Existing Concrete Deck. The cost of crack repair, if necessary, will be paid for according to Article 109.04 of the Standard Specifications.

Reinforcement bars designated (E) shall be epoxy coated.

Prior to pouring the new concrete deck, all heavy or loose rust, loose mill scale, and other loose or potentially detrimental foreign material shall be removed from the surfaces in contact with concrete. Tightly adhered paint may remain unless otherwise noted. Removal shall be accomplished by methods that will not damage the steel and the cost will be included in the pay item covering removal of the existing concrete.

As directed by the Engineer, existing construction accessories welded to the top flange of beams and girders shall be removed. The weld areas shall be ground flush and inspected for cracks using magnetic particle testing (MT) or dye penetrant testing (PT) by qualified personnel approved by the Engineer. Any cracks that cannot be removed by grinding 1/4" deep shall be identified and reported to the Bureau of Bridges and Structures for further disposition. The cost of removing welded accessories, grinding and inspecting weld areas grinding cracks will be paid for according to Article 109.04 of the Standard Specifications.

If the contractor elects to use cantilever forming brackets on the exterior beams or girders, the brackets shall be placed at the same locations as required for the hardwood blocks in Article 503.06(b) of the Standard Specifications. If additional cantilever forming brackets are required, hardwood blocking shall be wedged between the exterior and first interior beam at each of these additional bracket locations.

Plan dimensions and details relative to existing plans are subject to nominal construction variations. The Contractor shall field verify existing dimensions and details affecting new construction and make necessary approved adjustments prior to construction or ordering of materials. Such variations shall not be cause for additional compensation for a change in scope of the work, however, the Contractor will be paid for the quantity actually furnished at the unit price bid for the work.

The existing structural steel coating contains lead. The contractor shall take appropriate precautions to deal with the presence of lead on this project.

All new structural steel shall be shop painted with an inorganic zinc rich primer per AASHTO M300, Type 1.

Field painting of structural steel shall be done under a separate painting contract.

Removal of existing bridge rail is included with the cost of Removal of Existing Concrete Deck No. 4.

STATION 457+00.00  
RE-BUILT 20\_\_ BY  
STATE OF ILLINOIS  
F.A.I. ROUTE 55  
SEC D6 LOGAN CO BR 2011-1  
LOADING HS20-44 & ALT  
STR. NO. 054-0065 (NB)

STATION 457+00.00  
RE-BUILT 20\_\_ BY  
STATE OF ILLINOIS  
F.A.I. ROUTE 55  
SEC D6 LOGAN CO BR 2011-1  
LOADING HS20-44 & ALT  
STR. NO. 054-0066 (SB)

**NAME PLATES**

See Std. 515001  
Existing Name Plates shall be cleaned and relocated next to new Name Plates. Cost included with Name Plates.

**INDEX OF SHEETS**

- 1 General Plan and Elevation
- 2 General Data
- 3-5 Top of Slab Elevations (SB)
- 6-7 Top of Approach Slab Elevations (SB)
- 8-10 Top of Slab Elevations (NB)
- 11-12 Top of Approach Slab Elevations (NB)
- 13 Superstructure (SB)
- 14 Superstructure (NB)
- 15-16 Superstructure Details
- 17 Diaphragm Details
- 18-20 Bridge Approach Slab Details (SB)
- 21-23 Bridge Approach Slab Details (NB)
- 24 Framing Plan
- 25 Bearing Details
- 26 South Abutment Concrete Removal (SB)
- 27 North Abutment Concrete Removal (SB)
- 28 South Abutment Concrete Removal (NB)
- 29 North Abutment Concrete Removal (NB)
- 30-31 Abutment Details (SB)
- 32-33 Abutment Details (NB)
- 34 Abutment Repairs
- 35 Pier Repairs
- 36 South Slopewall Repairs
- 37 North Slopewall Repairs
- 38 Bar Splicer Assembly and Mechanical Splicer Details
- 39 Concrete Parapet Slipforming Option
- 39A Cantilever Forming Bracket

**TOTAL BILL OF MATERIAL**

ITEM	UNIT	SUPER	SUB	TOTAL
Granular Backfill for Structures	Cu. Yd.		363	363
Concrete Removal	Cu. Yd.		62.2	62.2
Removal of Existing Concrete Deck No. 4	Each	2		2
Structure Excavation	Cu. Yd.		276	276
Concrete Structures	Cu. Yd.		78.8	78.8
Concrete Superstructure	Cu. Yd.	646.9		646.9
Bridge Deck Grooving	Sq. Yd.	1729		1729
Protective Coat	Sq. Yd.	2063		2063
Furnishing and Erecting Structural Steel	Pound	3370		3370
Stud Shear Connectors	Each	5508		5508
Reinforcement Bars, Epoxy Coated	Lb.	145,980	15,200	161,180
Bar Splicers	Each	176		176
Name Plates	Each	2		2
Elastomeric Bearing Assembly, Type I	Each	24		24
Anchor Bolts, 1"	Each	96		96
Geocomposite Wall Drain	Sq. Yd.		179	179
Pipe Underdrains for Structures 4"	Ft.		328	328
Diamond Grinding (Bridge Section)	Sq. Yd.	1716		1716
Structural Repair of Concrete (Depth Equal to or Less Than 5")	Sq. Ft.		9	9
Jack and Remove Existing Bearings	Each	24		24
Slopewall Repair	Sq. Yd.		32	32
Controlled Low-Strength Material	Cu. Yd.		9	9
Protective Shield	Sq. Yd.		516	516

\*Includes PCC Connector Pavement beyond the end of approaches.

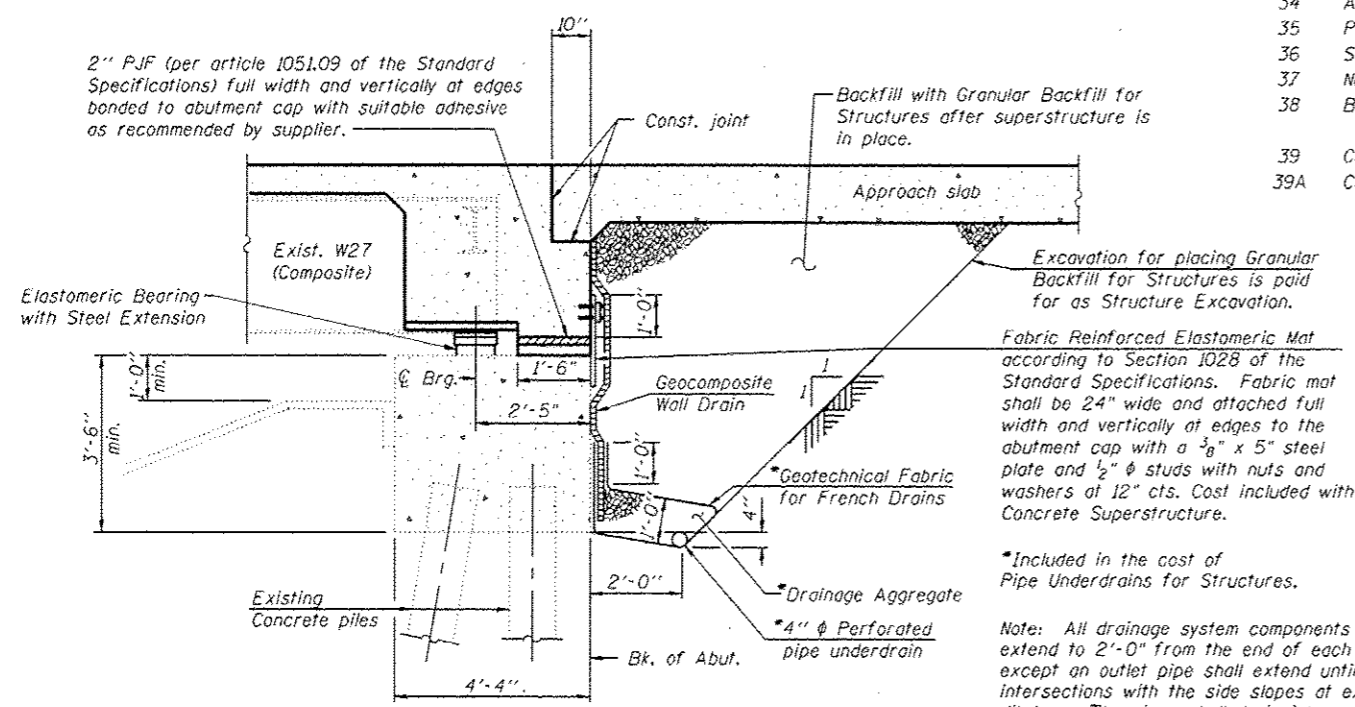

**SECTION THRU SEMI-INTEGRAL ABUTMENT**

(Horiz. dim. @ Rt. L's)

REV. SHEET 6-3-13

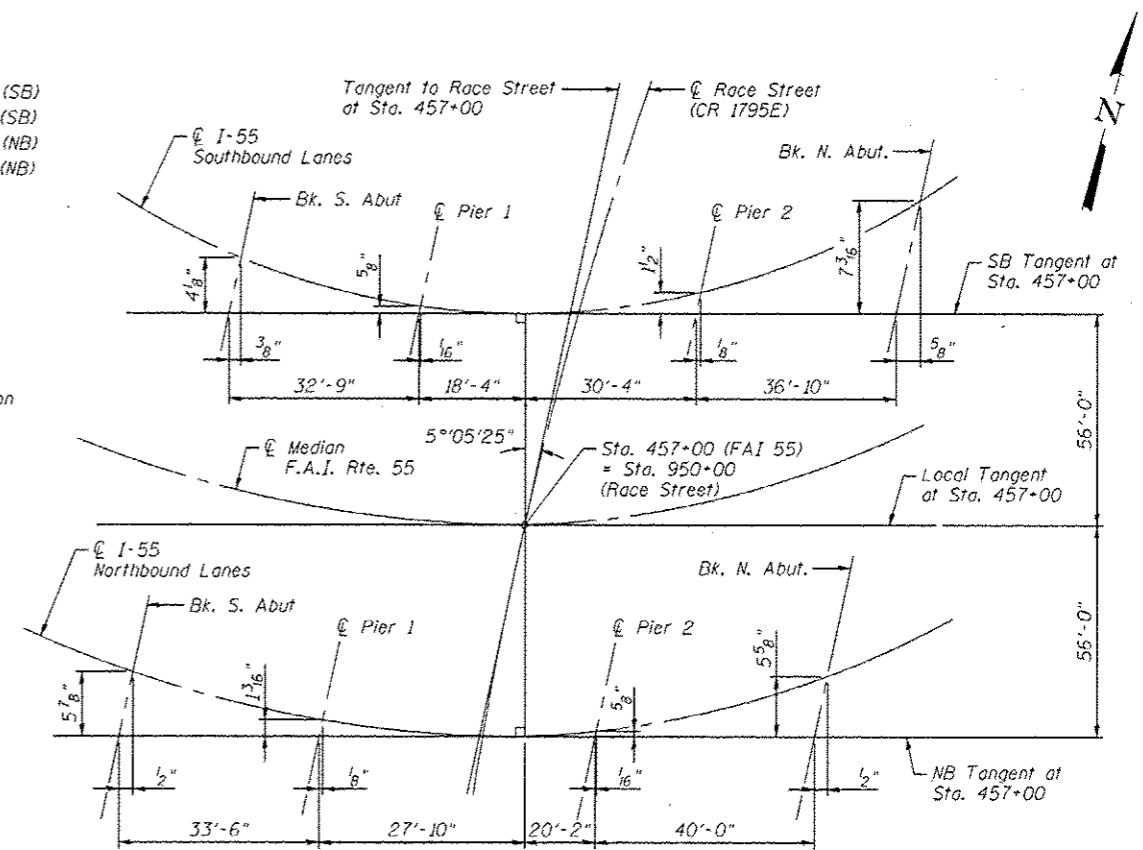

**OFFSET SKETCH**

**CB** Coombe-Bloxdorf P.C.  
- CIVIL ENGINEERS -  
- STRUCTURAL ENGINEERS -  
- LAND SURVEYORS -  
Design Firm License No. 184-002703

FILE NAME ...0540065-0066-72all-002-gen-data.dgn	USER NAME _MMML	DESIGNED GJB	REVISED -
PLOT SCALE 0.0000 / IN.	DRAWN MMML	CHECKED MCB/RKM	REVISED -
PLOT DATE 5/18/2013	CHECKED MCB/GJB	REVISED -	REVISED -

STATE OF ILLINOIS  
DEPARTMENT OF TRANSPORTATION

GENERAL DATA  
STRUCTURE NO. 054-0065 (N.B.) & STRUCTURE NO. 054-0066 (S.B.)

F.A.I. RTE. 55	SECTION D6 LOGAN CO BR 2011-1	COUNTY LOGAN	TOTAL SHEETS 429	SHEET NO. 325
CONTRACT NO. 72E11				ILLINOIS FED. AID PROJECT