

DEAD LOAD DEFLECTION DIAGRAM

(Includes weight of concrete only.)

Note:

The above deflections are not to be used in the field if the engineer is working from the grade elevations adjusted for dead load deflections and grinding as shown on sheets 4 and 5 of 39.

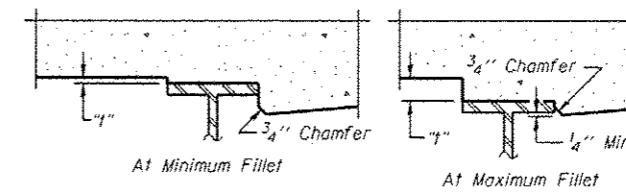

To determine "f": After all structural steel has been erected, elevations of the top flanges of the beams shall be taken at intervals shown below. These elevations subtracted from the "Theoretical Grade Elevations Adjusted for Dead Load Deflection and Grinding" shown on sheets 4 and 5 of 39, minus slab thickness, equals the fillet heights "f" above top flange of beams.

The slab is to be ground after curing to achieve smoothness, but the slab is not to be ground to elevations below the "Theoretical Grade Elevations" shown on sheets 4 and 5 of 39. For grinding the deck, see Special Provisions.

FILLET HEIGHTS

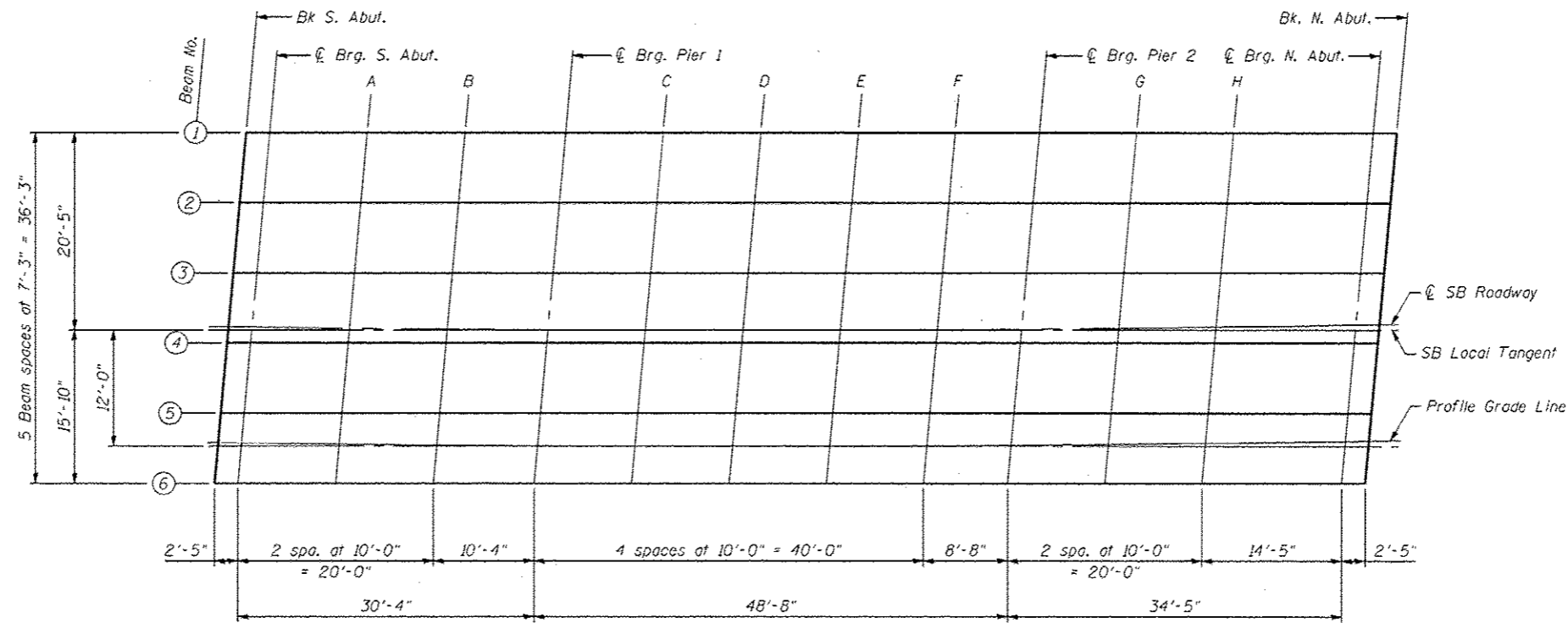

PLAN

Note:
Offsets measured from \varnothing Roadway.

E-S1

7-1-10

REV. SHEET 6-3-13

FILE NAME *	USER NAME * _MML_	DESIGNED - GJB	REVISED -
...054065-0066-72e11-003-slab-elevation	deck-ab.dgn	CHECKED - MCB/RKM	REVISED -
	PLOT SCALE * 1/8" = 1' / IN.	DRAWN - CFC	REVISED -
CR PROJECT NO 18965-1	PLOT DATE * 5/19/2013	CHECKED - MCB/GJB	REVISED -

STATE OF ILLINOIS
DEPARTMENT OF TRANSPORTATION

TOP OF SLAB ELEVATIONS (SOUTH BOUND STRUCTURE)
STRUCTURE NO. 054-0065 (N.B.) & 054-0066 (S.B.)

SHEET NO. 3 OF 39 SHEETS

CB Coombe-Bloxdorf P.C.
- CIVIL ENGINEERS -
- STRUCTURAL ENGINEERS -
- LAND SURVEYORS -
Design Firm License No. 184-002703

F.A.I. RTE.	SECTION	COUNTY	TOTAL SHEETS	SHEET NO.
55	D6 LOGAN CO BR 2011-1	LOGAN	429	326
				CONTRACT NO. 72E11
ILLINOIS FED. AID PROJECT				