

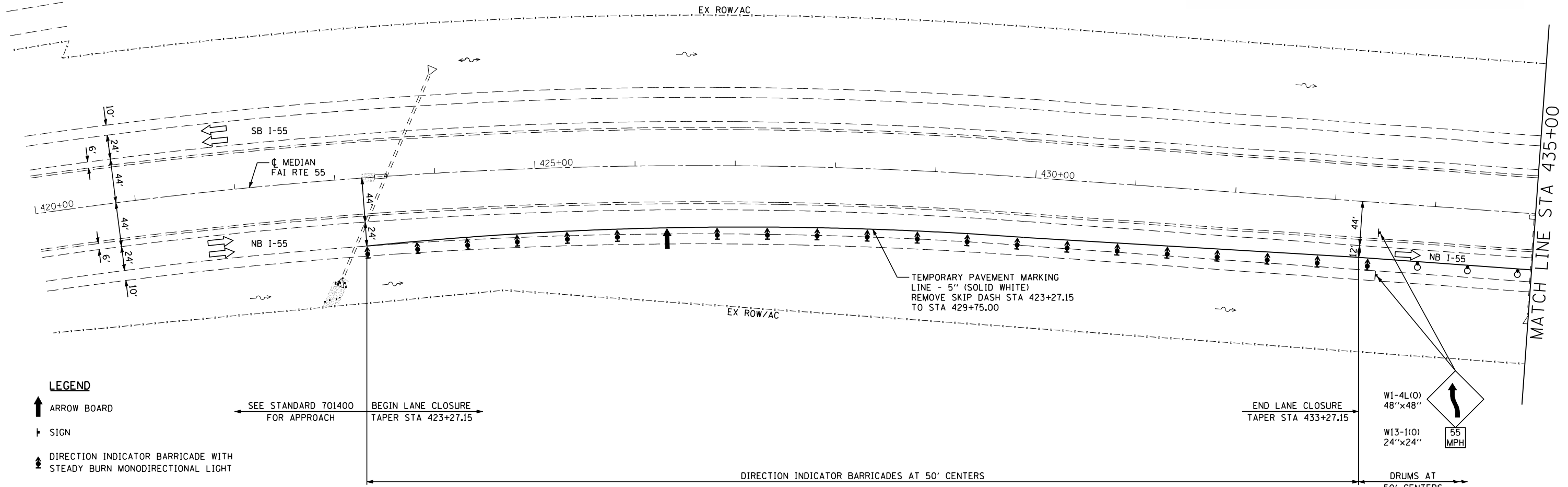

NOTES:
SEE STANDARDS 701400 AND 701416 FOR DETAILS NOT SHOWN.

SEQUENCE OF OPERATIONS SN 054-0065 THRU 0068
STAGE 2

1. RELOCATE TEMPORARY CONCRETE BARRIER AND TRAFFIC CONTROL DEVICES AND PLACE ALL TRAFFIC ON THE SOUTHBOUND LANES.
2. REMOVE BRIDGE DECK ON SN 054-0065 AND EXISTING APPROACH SLABS.
3. REMOVE SUPERSTRUCTURE, PIER CAPS AND COLUMNS, ABUTMENT WINGWALLS AND BACK WALL, AND APPROACH SLABS AT SN 054-0067.
4. REHABILITATE SN 054-0065 SUBSTRUCTURE AND CONSTRUCT NEW BRIDGE DECK, BRIDGE APPROACH PAVEMENTS, AND BRIDGE APPROACH PAVEMENT CONNECTOR, (PCC).
5. AT SN 054-0067, CONSTRUCT EMBANKMENT, CRC PAVEMENT, AND HMA SHOULDERS.
6. CONSTRUCT HMA SURFACE COURSE ON APPROACHES TO SN 054-0065 AND SN 054-0067 AND ON CRC PAVEMENT.
7. REMOVE AND REERECT GUARDRAIL AND TERMINALS



LEGEND

- ARROW BOARD
- SIGN
- DIRECTION INDICATOR BARRICADE WITH STEADY BURN MONODIRECTIONAL LIGHT
- TYPE II BARRICADE WITH STEADY BURN MONODIRECTIONAL LIGHT
- DRUM WITH STEADY BURN MONODIRECTIONAL LIGHT
- VERTICAL PANEL (BACK TO BACK)
- TYPE III BARRICADE WITH FLASHING LIGHTS
- TEMPORARY CONCRETE BARRIER
- MONODIRECTIONAL BARRIER MARKER
- INDICATES LIMITS OF PAVED SHOULDER REMOVAL
- INDICATES LIMITS OF APPROACH SLAB REMOVAL
- INDICATES LIMITS OF PAVEMENT REMOVAL

SEE STANDARD 701400 FOR APPROACH
BEGIN LANE CLOSURE TAPER STA 423+27.15

DIRECTION INDICATOR BARRICADES AT 50' CENTERS

END LANE CLOSURE TAPER STA 433+27.15
W1-4L(0) 48"x48"
W13-1(0) 24"x24"
55 MPH
DRUMS AT 50' CENTERS

MATCH LINE STA 435+00



JOB = 2236.10	DESIGNED - NAK	REVISED -
FILE NAME = D672E11-sh1-S2-6568.dgn	DRAWN - TJD	REVISED -
PLOT SCALE = 100.0000 "/>		

**STATE OF ILLINOIS
DEPARTMENT OF TRANSPORTATION**

MAINTENANCE OF TRAFFIC STAGE 2		
SN 054-0065, 0066, 0067, 0068		
SCALE:	SHEET NO. 1 OF 6 SHEETS	STA. 420+00 TO STA. 435+00

F.A.I. RTE.	SECTION	COUNTY	TOTAL SHEETS	SHEET NO.
55	D6 LOGAN CO BR 2011-1	LOGAN	429	154
FED. ROAD DIST. NO.			ILLINOIS FED. AID PROJECT	
			CONTRACT NO. 72E11	