

\* Order a(E) and a<sub>1</sub>(E) bars full length.  
Cut to fit skew and use remainder of bars  
in opposite end.

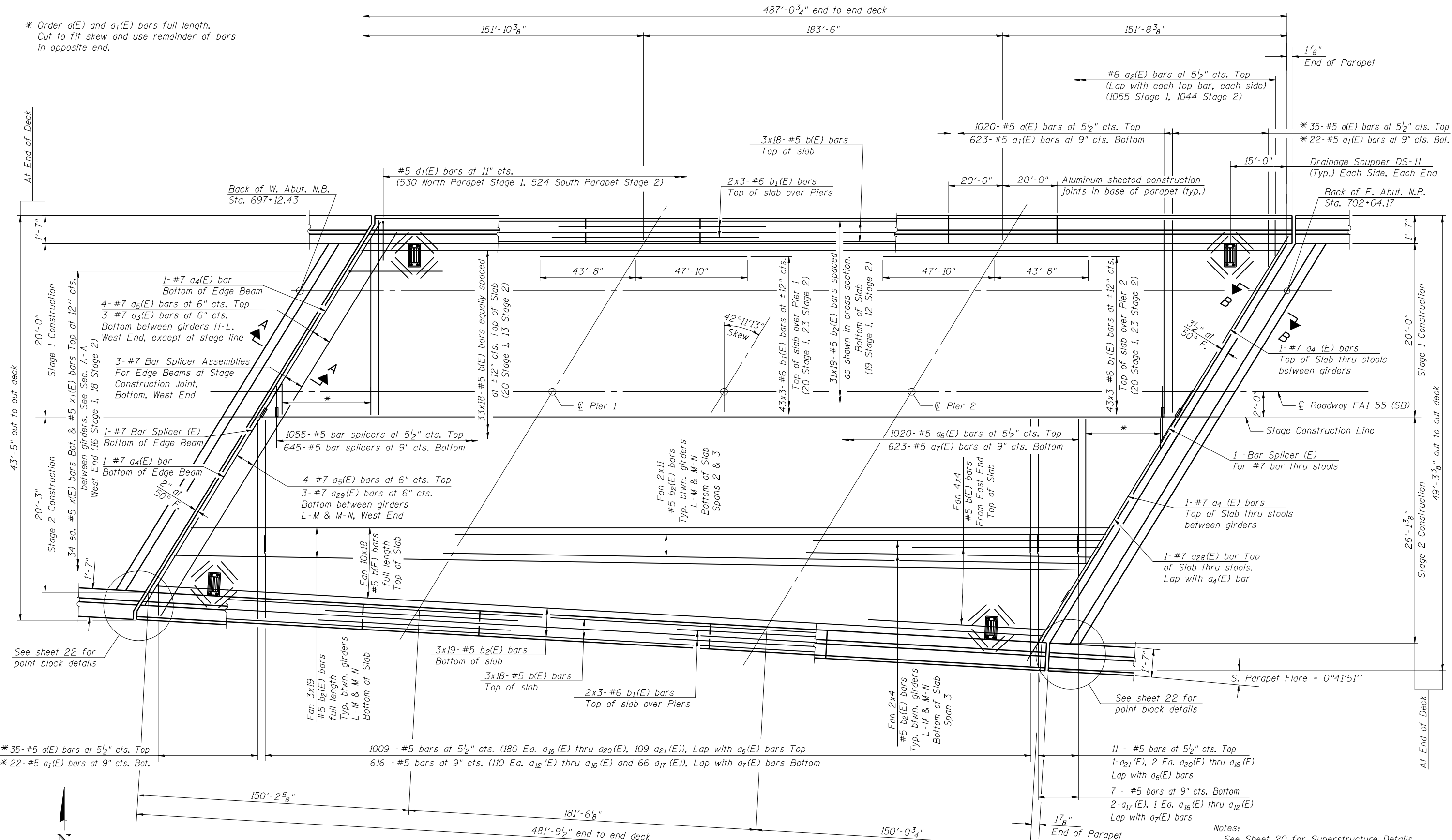

See sheet 22 for point block details

\* 35-#5 a(E) bars at 5 1/2" cts. Top  
\* 22-#5 a<sub>1</sub>(E) bars at 9" cts. Bot.



PLAN - NB

**MINIMUM BAR LAP**  
#5 bar = 2'-7"  
#6 bar = 3'-1"  
#7 bar = 5'-2"

Notes:  
See Sheet 20 for Superstructure Details, Section A-A, and Bill of Material.  
Bars indicated thus 20 x 3-#5 etc. indicates 20 lines of bars with 3 lengths per line.  
See Sheet 20 and 21 for parapet reinforcement.  
See Sheet 32 for Section B-B and finger plate expansion joint details.



JOB = 2265.2  
FILE = 0540060.0061-72E11-17-19-Super.dgn  
DATE = 3/7/2013

DESIGNED - AAN  
CHECKED - MDC  
DRAWN - TSH  
CHECKED - AAN

REVISED -  
REVISED -  
REVISED -  
REVISED -

STATE OF ILLINOIS  
DEPARTMENT OF TRANSPORTATION

SUPERSTRUCTURE  
STRUCTURE NO. 054-0061 (NB)

SHEET NO. 18 OF 53 SHEETS

F.A.I. RTE.	SECTION	COUNTY	TOTAL SHEETS	SHEET NO.
55	D6 LOGAN CO BR 2011-1	LOGAN	429	248
CONTRACT NO. 72E11				

ILLINOIS FED. AID PROJECT