

P. C. STA. 146+72.44
MAG NAIL W/WASHER

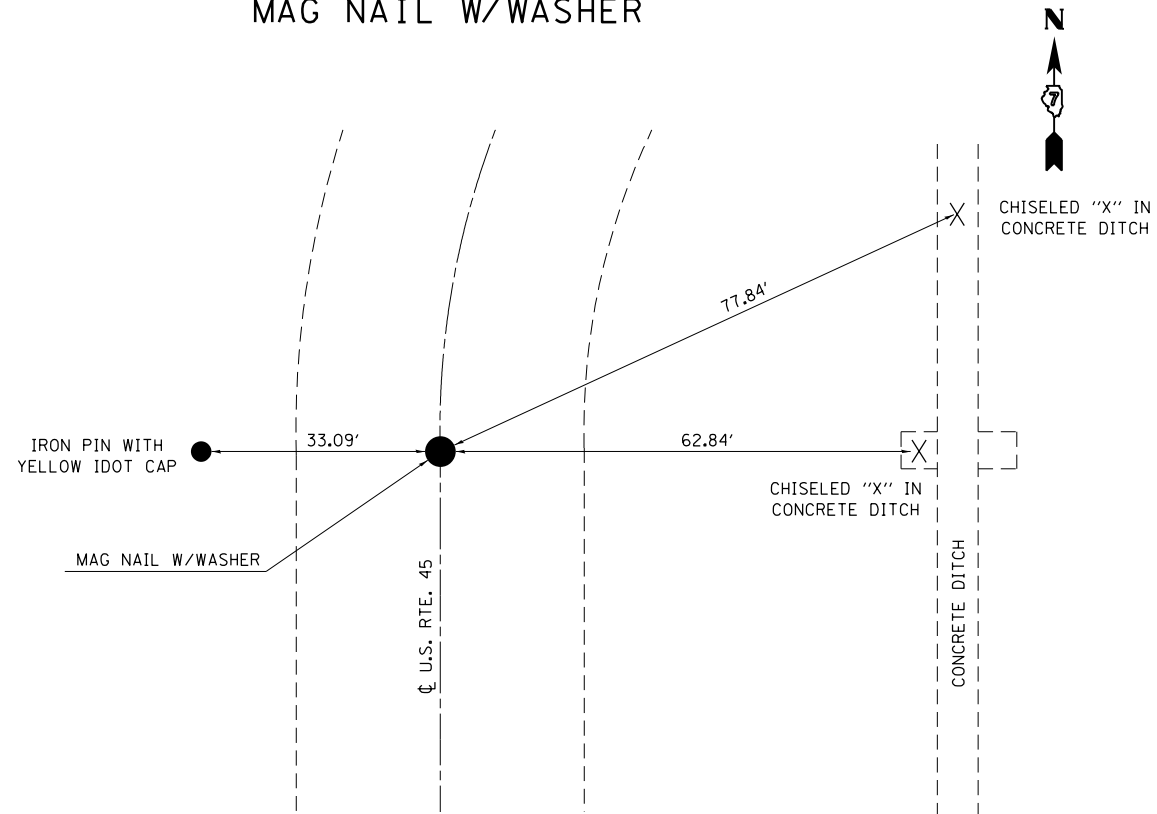

NOTE: NOT DRAWN TO SCALE

P. T. STA. 191+07.24
MAG NAIL W/WASHER

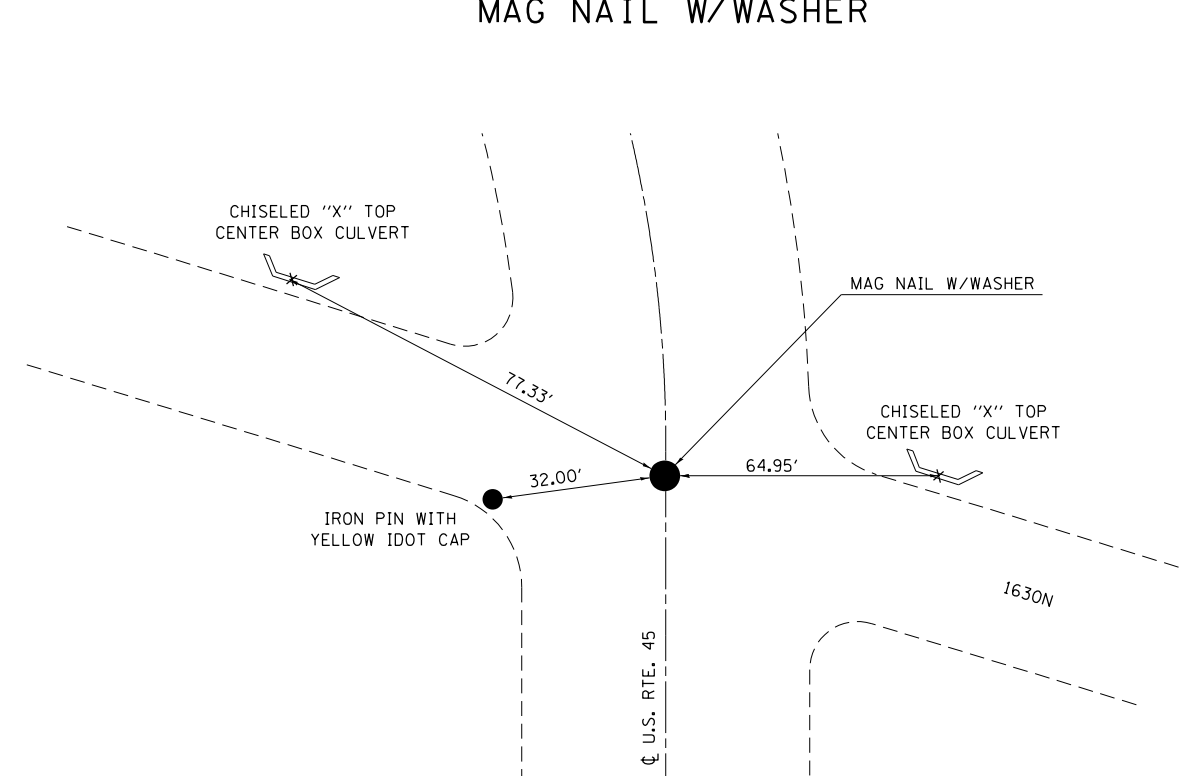

NOTE: NOT DRAWN TO SCALE

P. O. T. STA. 193+62.20
MAG NAIL W/WASHER

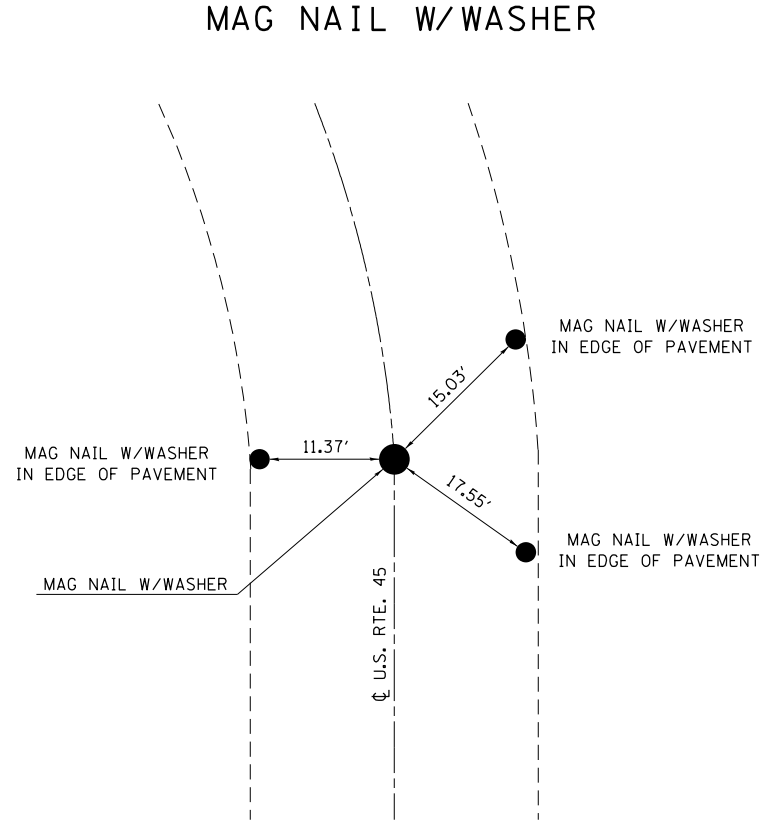

NOTE: NOT DRAWN TO SCALE

SURVEY MARKER SCHEDULE	PERMANENT SURVEY MARKERS, TYPE I
LOCATION	EACH
STA 370+06.15	1.0
STA 380+80.00 (BK) = STA 100+00.00 (AH)	1.0
STA 100+14.59	1.0
STA 142+71.60	1.0
STA 146+72.44	1.0
STA 191+07.24	1.0
STA 193+62.20	1.0
TOTAL	7.0

FILE NAME =	USER NAME = steffenmk	DESIGNED -	REVISED -
ci:\pw\work\p\idot\steffenmk\d0249325\d74511-sh-ttiepts.dgn		DRAWN -	REVISED -
	PLOT SCALE = 40.0000' / in.	CHECKED -	REVISED -
	PLOT DATE = 10/2/2012	DATE -	REVISED -

STATE OF ILLINOIS
DEPARTMENT OF TRANSPORTATION

TIE POINTS

SCALE: NA SHEET NO. 2 OF 2 SHEETS STA. TO STA.

F.A.P. RTE.	SECTION	COUNTY	TOTAL SHEETS	SHEET NO.
824	(19,20)RS-4	COLES	56	25
FED. ROAD DIST. NO. ILLINOIS FED. AID PROJECT			CONTRACT NO. 74511	