

 PARTIAL DEPTH PATCHING

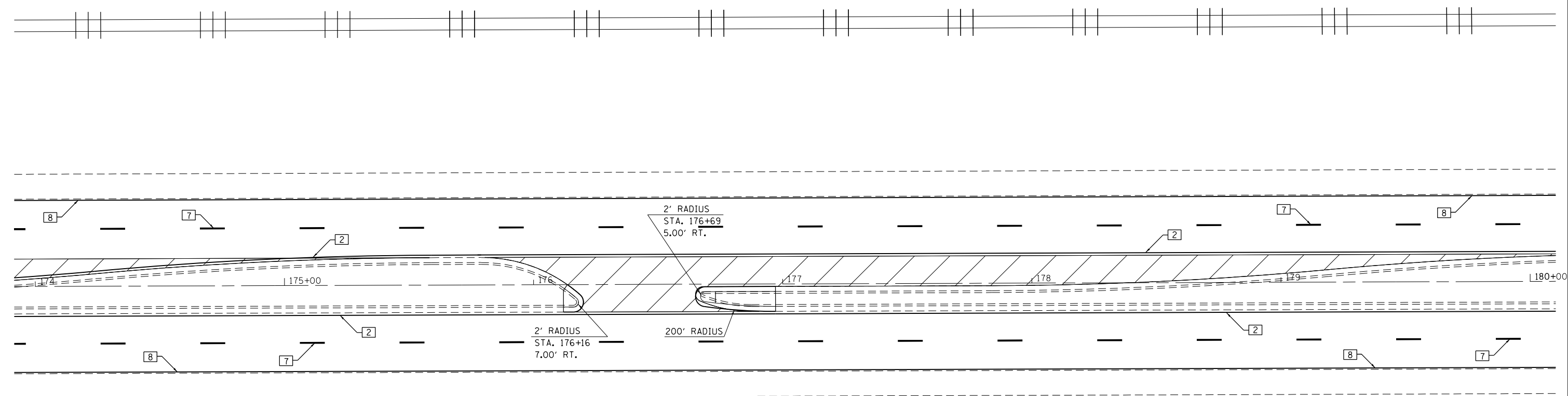

MEDIAN #13:
 - STA. 172+07 TO STA. 176+20
 - SOUTH AND NORTH NOSE REMOVAL AND REPLACEMENT
 - SEE MEDIAN SCHEDULE FOR QUANTITIES

MEDIAN #14:
 - STA. 176+65 TO STA. 181+23
 - SOUTH AND NORTH NOSE REMOVAL AND REPLACEMENT
 - SEE MEDIAN SCHEDULE FOR QUANTITIES

PAVEMENT MARKING LEGEND

- | | |
|--|---|
| <p>1 4" (100) SKIP-DASH (YELLOW)</p> <p>2 4" (100) SOLID (YELLOW)</p> <p>3 12" (300) DIAGONAL (YELLOW)</p> <p>4 4" (100) DOUBLE YELLOW (NARROW)</p> <p>5 12" (300) SOLID WHITE</p> <p>6 RESERVED</p> <p>7 6" (150) SKIP-DASH (WHITE)</p> | <p>8 4" (100) SOLID (WHITE)</p> <p>9 12" (300) DIAGONAL (WHITE)</p> <p>10 6" (150) SOLID (WHITE)</p> <p>11 24" (600) STOP BAR (WHITE)</p> <p>12 8" (200) SOLID (WHITE)</p> <p>13 4" (100) PARKING WHITE</p> |
|--|---|

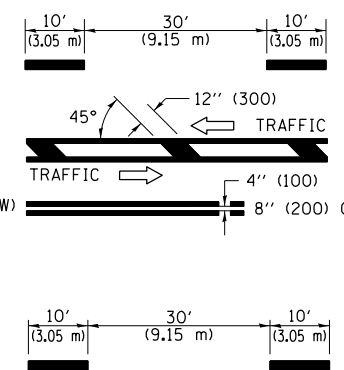

FILE NAME =	USER NAME = steffenmk	DESIGNED -	REVISED -
Default	74537-sh1-plan.dgn	DRAWN -	REVISED -
	PLOT SCALE = 40.0000' / in.	CHECKED -	REVISED -
	PLOT DATE = 3/22/2013	DATE -	REVISED -

**STATE OF ILLINOIS
 DEPARTMENT OF TRANSPORTATION**

PLAN
 SCALE: 20 SHEET 16 OF 31 SHEETS STA. 174+00 TO STA. 180+00

• F.A.P. RTE. 712, F.A.U. RTE. 7464				
F.A. RTE.	SECTION	COUNTY	TOTAL SHEETS	SHEET NO.
58-64-IRS, 126RS-2		Macon	69	42
CONTRACT NO. 74537			ILLINOIS FED. AID PROJECT	