

Bar c(E)

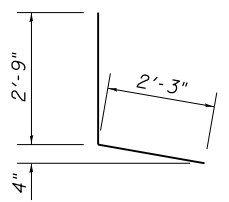

Bar d(E)

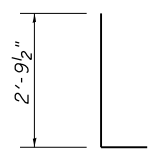

Bar d1(E)

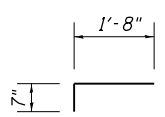

Bar x(E)

BILL OF MATERIAL
PER ABUTMENT

BAR	NUMBER OF BARS		TOTAL	SIZE	LENGTH	SHAPE
	STAGE I	STAGE II				
a (E)	8		8	#6	42'-10"	—
a1(E)		8	8	#6	40'-1"	—
c (E)	3	3	6	#5	2'-9"	J
c1(E)	3	3	6	#5	8'-7"	—
d (E)	3	3	6	#5	5'-0"	L
d1(E)	3	3	6	#5	3'-9"	L
h (E)	4		4	#6	34'-2"	—
h1(E)		4	4	#6	31'-5"	—
h2(E)	6	6	12	#5	7'-7"	—
x (E)	44	41	83	#5	2'-3"	J
REINFORCEMENT BARS (EPOXY COATED)					POUND	1800
CONCRETE REMOVAL					CU YD	13.2
CONCRETE SUPERSTRUCTURE					CU YD	13.2

Hatching indicates removal.

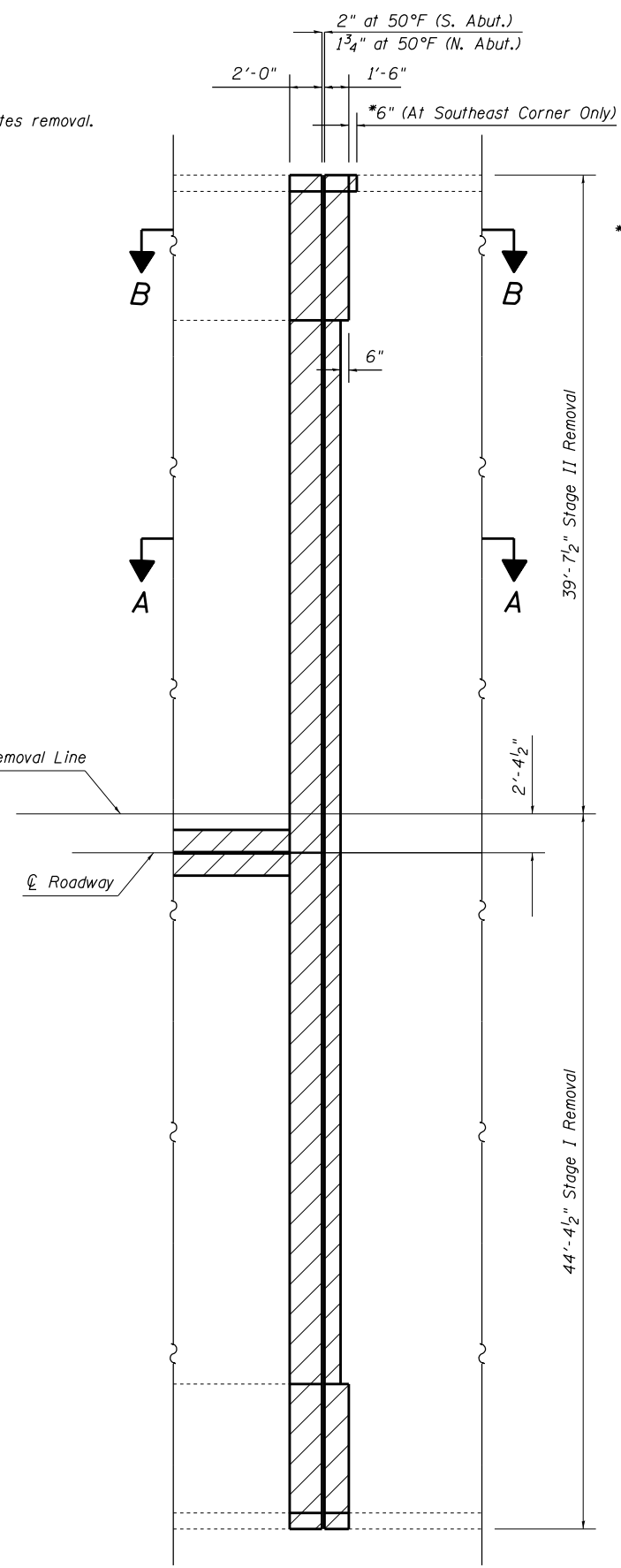

EXISTING PARTIAL PLAN
(North Abutment shown; South Abutment similar unless noted otherwise)



* The 6" removal at the southeast corner is due to current location of name plate.

For Sections A-A to D-D See sheet 4 of 14.

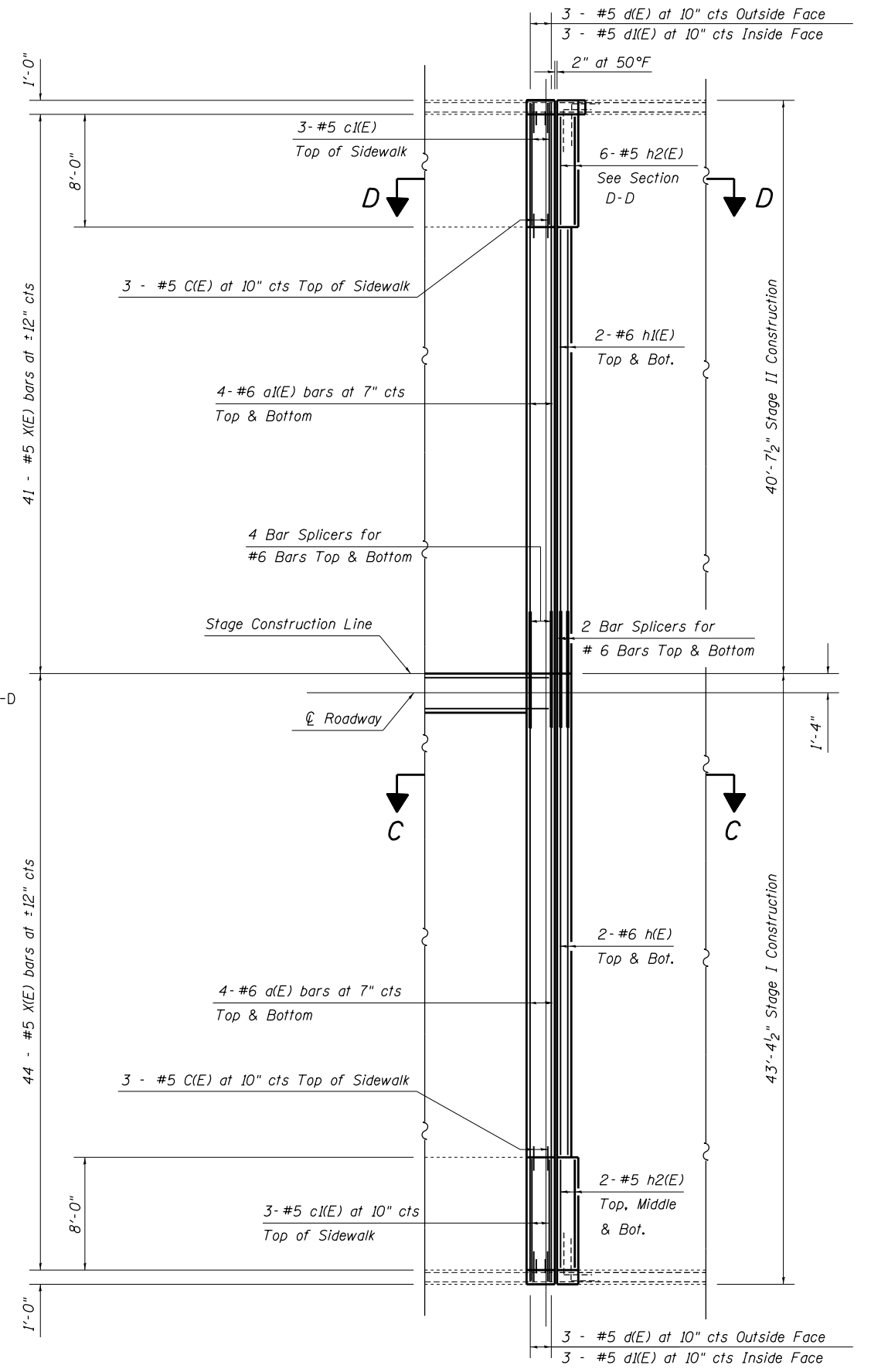

PROPOSED PARTIAL PLAN
(North Abutment shown; South Abutment similar unless noted otherwise)