

Hatching indicates removal.

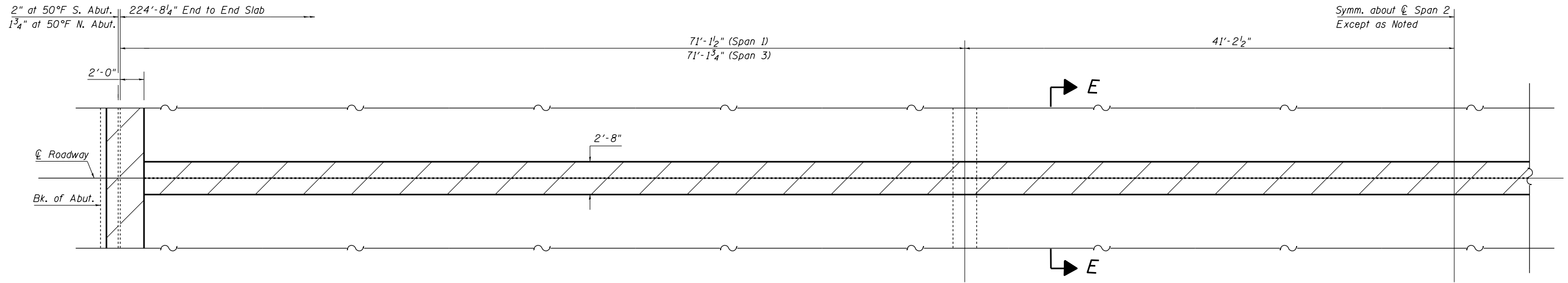

EXISTING PARTIAL PLAN

For Sections E-E and F-F  
 See sheet 6 of 14

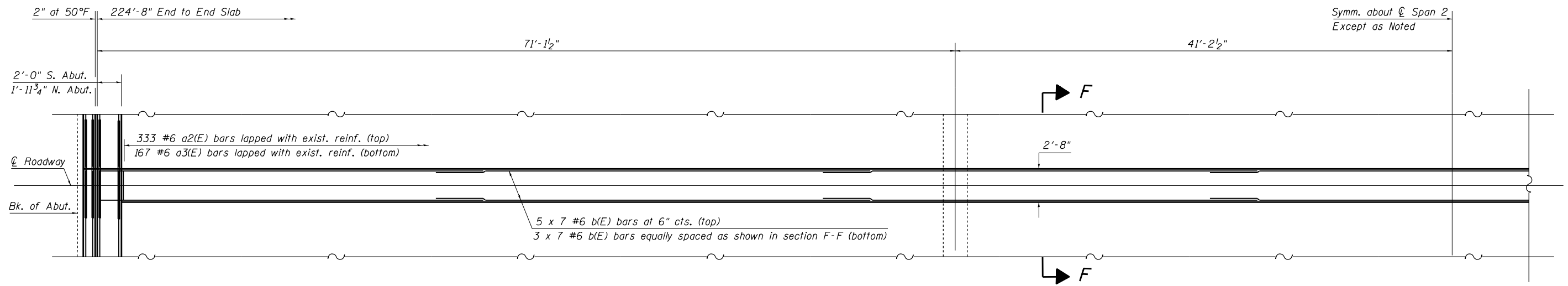

PROPOSED PARTIAL PLAN

Required Lap Length	
#6 Bar	3'-1"

FILE NAME =	USER NAME = teasleyck	DESIGNED - DFZ	REVISED -
ci:\pwork\pwork\pwork\teasleyck\d0312934\074601-sht-brdetails.dgn		DRAWN - DFZ	REVISED -
Default	PLOT SCALE = 40.0000' / in.	CHECKED - MJM	REVISED -
	PLOT DATE = 4/8/2013	DATE - 2/20/2013	REVISED -

STATE OF ILLINOIS  
 DEPARTMENT OF TRANSPORTATION

LONGITUDINAL JOINT REPLACEMENT DETAILS  
 SN. 058-0055

SCALE: SHEET 5 OF 14 SHEETS STA. TO STA.

F.A.P. RTE.	SECTION	COUNTY	TOTAL SHEETS	SHEET NO.
320	D7 Bridge Repairs 2014-2	MACON	29	20
ILLINOIS FED. AID PROJECT			CONTRACT NO. 74601	