

NOTE: PERMANENT ROUNDABOUT SIGNING SHALL BE PLACED AS SOON AS FEASIBLE.  
WHERE NECESSARY, SIGNAGE MAY BE PLACED ON TEMPORARY SUPPORTS.

**APPLICABLE  
TRAFFIC CONTROL  
HIGHWAY STANDARDS**

- 701001
- 701006
- 701011
- 701201
- 701206
- 701301
- 701306
- 701311
- 701326
- 701336
- 701501
- 701502
- 701602
- 701701
- 701801
- 701901

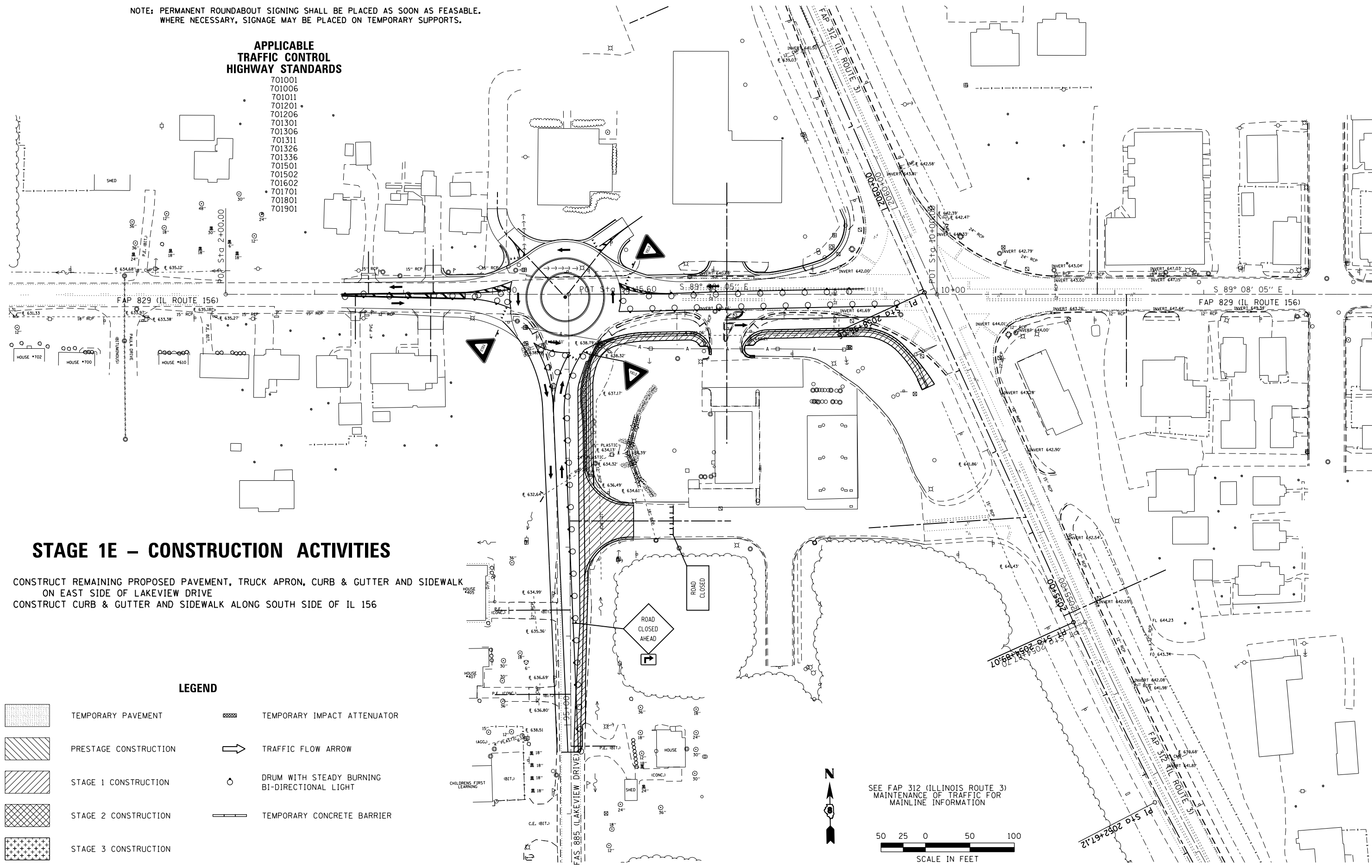

**STAGE 1E – CONSTRUCTION ACTIVITIES**

CONSTRUCT REMAINING PROPOSED PAVEMENT, TRUCK APRON, CURB & GUTTER AND SIDEWALK  
ON EAST SIDE OF LAKEVIEW DRIVE  
CONSTRUCT CURB & GUTTER AND SIDEWALK ALONG SOUTH SIDE OF IL 156

**LEGEND**

- TEMPORARY PAVEMENT
- PRESTAGE CONSTRUCTION
- STAGE 1 CONSTRUCTION
- STAGE 2 CONSTRUCTION
- STAGE 3 CONSTRUCTION
- TEMPORARY IMPACT ATTENUATOR
- TRAFFIC FLOW ARROW
- DRUM WITH STEADY BURNING BI-DIRECTIONAL LIGHT
- TEMPORARY CONCRETE BARRIER

SEE FAP 312 (ILLINOIS ROUTE 3)  
MAINTENANCE OF TRAFFIC FOR  
MAINLINE INFORMATION

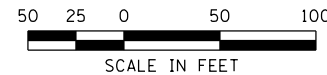

LAST SAVED = 1/22/2013  
 PEN TABLE = W62444.dwg  
 PLOT DRIVER = pdfplotlayers.pltcf9

FILE NAME =	USER NAME = beriechmann	DESIGNED -	REVISED -
I:\1001100\Phase II - 76817\Cad\T\Plans\066_0876817-sht-Staging-1E-IL156.dgn		DRAWN -	REVISED -
		CHECKED -	REVISED -
PLOT SCALE = 100.0000' / 1"		DATE -	REVISED -
PLOT DATE = 1/25/2013 3:31:09 PM			

**STATE OF ILLINOIS  
DEPARTMENT OF TRANSPORTATION**

**HORNER &  
SHIRIN, INC.  
ENGINEERS**

**SUGGESTED STAGES OF CONSTRUCTION  
AND TRAFFIC CONTROL**  
STAGE 1E - FAP 829 (IL ROUTE 156)

SCALE: 1" = 50' SHEET NO. 26 OF 46 SHEETS STA. 2108+00.00 TO STA. 2122+00.00

F.A.P. RTE.	SECTION	COUNTY	TOTAL SHEETS	SHEET NO.
312	68-WRS-1	MONROE	760	185
				<b>CONTRACT NO. 76817</b>
ILLINOIS FED. AID PROJECT				