

OUTER ROUNDABOUT - "I"		
POINT	NORTHING	EASTING
I1	606,551.06	2,298,792.84
I2	606,544.89	2,298,815.03
I3	606,528.44	2,298,831.16
I4	606,506.14	2,298,836.92
I5	606,483.95	2,298,830.74
I6	606,467.81	2,298,814.30
I7	606,462.06	2,298,792.00
I8	606,468.23	2,298,769.81
I9	606,476.62	2,298,759.50
I10	606,484.67	2,298,753.67
I11	606,506.98	2,298,747.92
I12	606,529.17	2,298,754.09
I13	606,545.30	2,298,770.53

INNER ROUNDABOUT - "H"		
POINT	NORTHING	EASTING
H1	606,534.56	2,298,792.68
H2	606,530.67	2,298,806.64
H3	606,520.33	2,298,816.80
H4	606,506.29	2,298,820.42
H5	606,492.33	2,298,816.53
H6	606,482.18	2,298,806.19
H7	606,478.56	2,298,792.15
H8	606,482.44	2,298,778.19
H9	606,487.72	2,298,771.70
H10	606,492.79	2,298,768.04
H11	606,506.82	2,298,764.42
H12	606,520.79	2,298,768.30
H13	606,530.94	2,298,778.65

NORTHWEST QUADRANT - "E"		
POINT	NORTHING	EASTING
E1	606,526.20	2,298,663.85
E2	606,526.49	2,298,673.85
E3	606,527.45	2,298,683.80
E4	606,529.07	2,298,693.66
E5	606,531.35	2,298,703.40
E6	606,534.26	2,298,712.96
E7	606,537.81	2,298,722.31
E8	606,541.97	2,298,731.40
E9	606,546.73	2,298,740.19
E10	606,552.07	2,298,748.65
E11	606,556.45	2,298,754.78
E12	606,569.06	2,298,793.00

NORTHEAST QUADRANT - "F"		
POINT	NORTHING	EASTING
F1	606,555.16	2,298,831.71
F2	606,549.14	2,298,839.69
F3	606,543.66	2,298,848.05
F4	606,538.75	2,298,856.76
F5	606,534.43	2,298,865.78
F6	606,530.73	2,298,875.07
F7	606,527.58	2,298,884.81

EAST 156 MEDIAN - "G"		
POINT	NORTHING	EASTING
G1	606,508.89	2,298,893.29
G2	606,509.51	2,298,883.31
G3	606,511.12	2,298,873.44
G4	606,513.70	2,298,863.79
G5	606,517.45	2,298,853.96
G6	606,508.80	2,298,854.88
G7	606,486.93	2,298,851.75
G8	606,489.27	2,298,861.48
G9	606,491.42	2,298,871.24
G10	606,493.38	2,298,881.05
G11	606,495.13	2,298,890.89
G12	606,496.70	2,298,900.77
G13	606,498.06	2,298,910.68
G14	606,499.22	2,298,920.61
G15	606,500.19	2,298,930.56
G16	606,500.95	2,298,940.53
G17	606,501.52	2,298,950.52
G18	606,501.89	2,298,960.51
G19	606,502.06	2,298,971.08

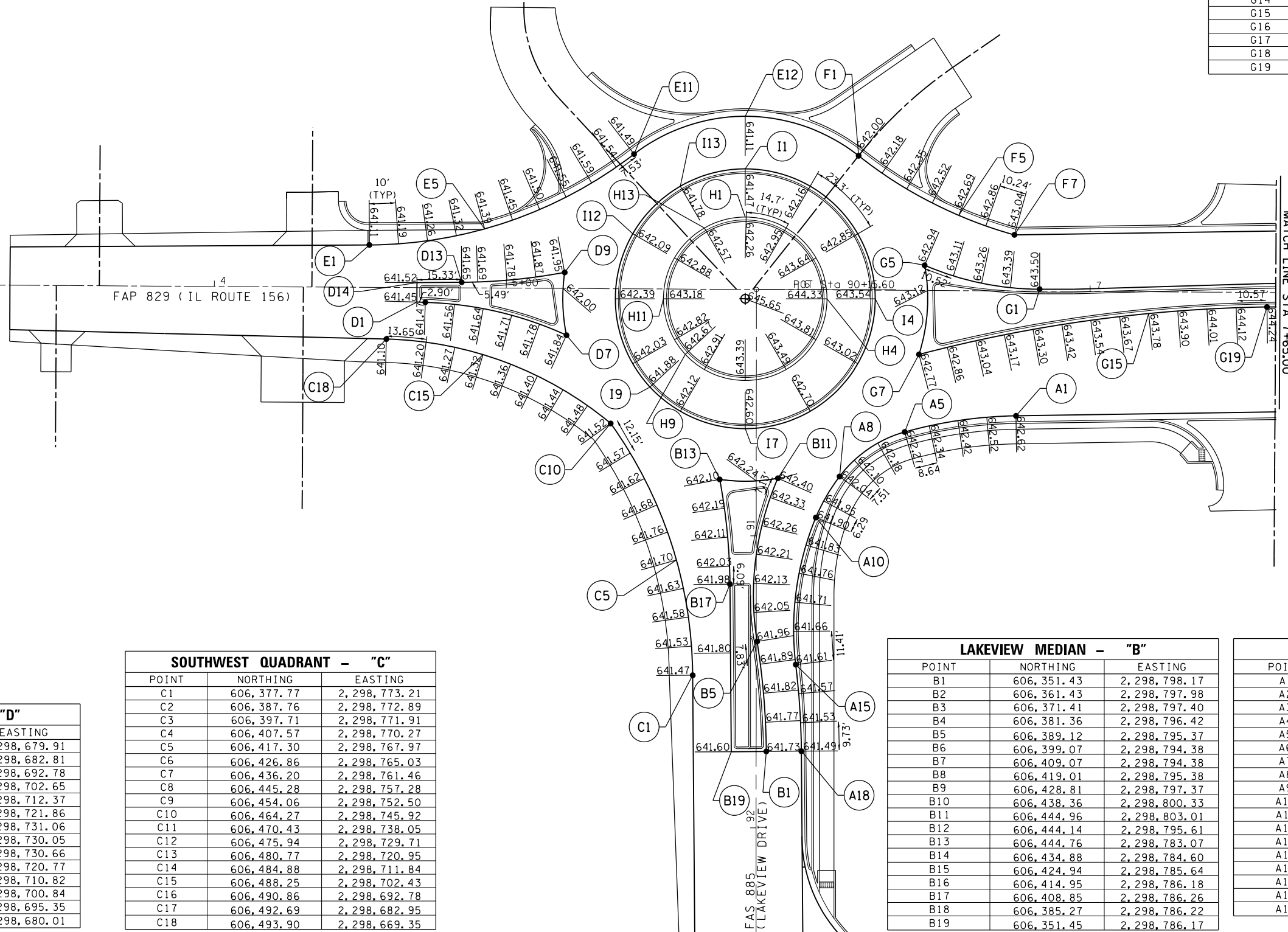

WEST 156 MEDIAN - "D"		
POINT	NORTHING	EASTING
D1	606,506.48	2,298,679.91
D2	606,506.37	2,298,682.81
D3	606,505.59	2,298,692.78
D4	606,504.01	2,298,702.65
D5	606,501.65	2,298,712.37
D6	606,498.53	2,298,721.86
D7	606,494.66	2,298,731.06
D8	606,510.69	2,298,730.05
D9	606,516.16	2,298,730.66
D10	606,514.67	2,298,720.77
D11	606,513.68	2,298,710.82
D12	606,513.18	2,298,700.84
D13	606,513.12	2,298,695.35
D14	606,513.16	2,298,680.01

SOUTHWEST QUADRANT - "C"		
POINT	NORTHING	EASTING
C1	606,377.77	2,298,773.21
C2	606,387.76	2,298,772.89
C3	606,397.71	2,298,771.91
C4	606,407.57	2,298,770.27
C5	606,417.30	2,298,767.97
C6	606,426.86	2,298,765.03
C7	606,436.20	2,298,761.46
C8	606,445.28	2,298,757.28
C9	606,454.06	2,298,752.50
C10	606,464.27	2,298,745.92
C11	606,470.43	2,298,738.05
C12	606,475.94	2,298,729.71
C13	606,480.77	2,298,720.95
C14	606,484.88	2,298,711.84
C15	606,488.25	2,298,702.43
C16	606,490.86	2,298,692.78
C17	606,492.69	2,298,682.95
C18	606,493.90	2,298,669.35

LAKEVIEW MEDIAN - "B"		
POINT	NORTHING	EASTING
B1	606,351.43	2,298,798.17
B2	606,361.43	2,298,797.98
B3	606,371.41	2,298,797.40
B4	606,381.36	2,298,796.42
B5	606,389.12	2,298,795.37
B6	606,399.07	2,298,794.38
B7	606,409.07	2,298,794.38
B8	606,419.01	2,298,795.38
B9	606,428.81	2,298,797.37
B10	606,438.36	2,298,800.33
B11	606,444.96	2,298,803.01
B12	606,444.14	2,298,795.61
B13	606,444.76	2,298,783.07
B14	606,434.88	2,298,784.60
B15	606,424.94	2,298,785.64
B16	606,414.95	2,298,786.18
B17	606,408.85	2,298,786.26
B18	606,385.27	2,298,786.22
B19	606,351.45	2,298,786.17

SOUTHEAST QUADRANT - "A"		
POINT	NORTHING	EASTING
A1	606,465.58	2,298,884.77
A2	606,465.19	2,298,874.78
A3	606,464.14	2,298,864.84
A4	606,462.42	2,298,854.99
A5	606,460.42	2,298,846.59
A6	606,456.70	2,298,837.34
A7	606,450.90	2,298,829.22
A8	606,445.37	2,298,824.15
A9	606,437.04	2,298,818.64
A10	606,431.39	2,298,815.89
A11	606,422.01	2,298,812.44
A12	606,412.33	2,298,809.94
A13	606,402.45	2,298,808.43
A14	606,392.46	2,298,807.91
A15	606,381.08	2,298,808.53
A16	606,371.12	2,298,809.46
A17	606,361.14	2,298,810.00
A18	606,351.41	2,298,810.17

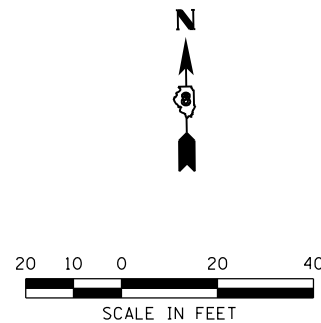

LAST SAVED = 1/23/2013  
 PEN TABLE = W24x40x41  
 PLOT DRIVER = pdfplotlayers.plt

FILE NAME =	USER NAME = beriechmann	DESIGNED -	REVISED -
I:\1001100\Phase II - 76817\Cad\T\Plans\077_0876817-sht-intersec-03A.dgn		DRAWN -	REVISED -
PLOT SCALE = 40.0000' / in.		CHECKED -	REVISED -
PLOT DATE = 1/25/2013 3:33:10 PM		DATE -	REVISED -

**STATE OF ILLINOIS**  
**DEPARTMENT OF TRANSPORTATION**



<b>INTERSECTION DETAILS</b>	
IL ROUTE 156 & LAKEVIEW DRIVE	
SCALE: 1" = 20'	SHEET NO. 2 OF 3 SHEETS
STA.	TO STA.

F.A.P. RTE. 312	SECTION 68-WRS-1	COUNTY MONROE	TOTAL SHEETS 760	SHEET NO. 352
CONTRACT NO. 76817				
ILLINOIS FED. AID PROJECT				