

END ELEVATION

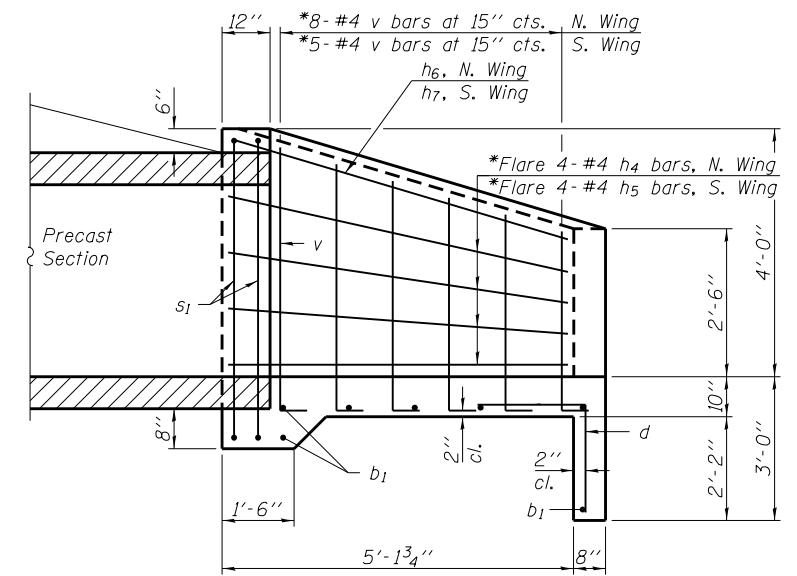

HALF SIDE ELEVATION

\* Cut or Bend to fit

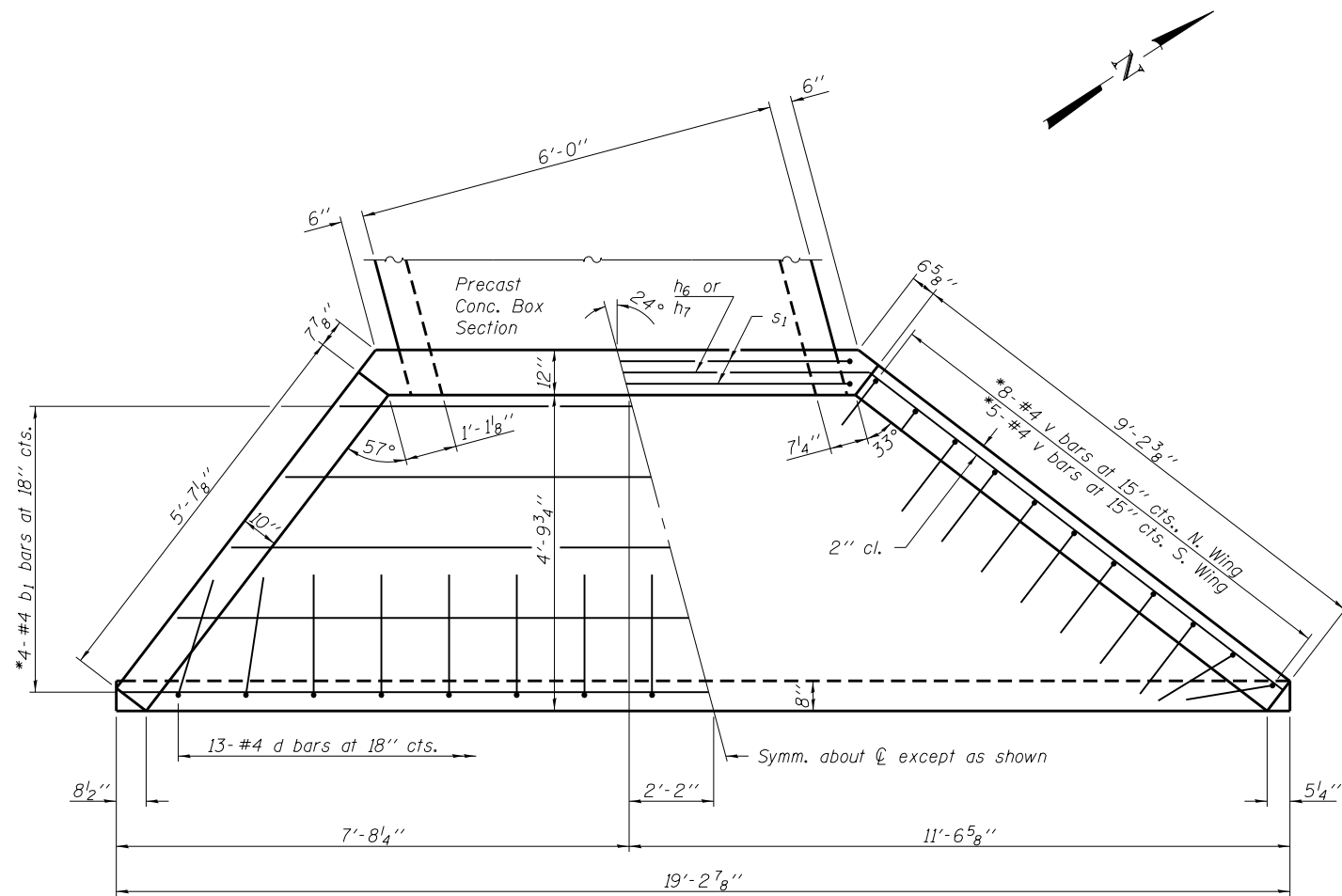

PLAN

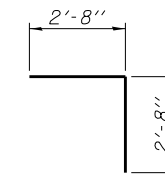
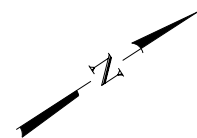

BAR d

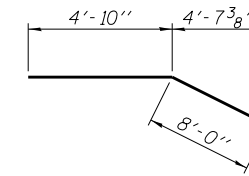

BAR h

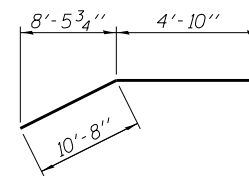

BAR h3

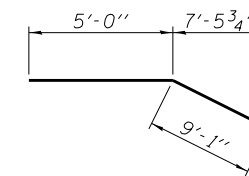

BAR h6

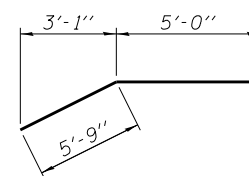

BAR h7

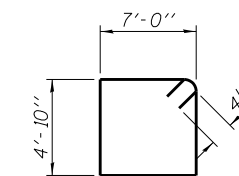

BAR s

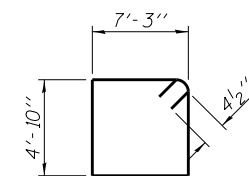

BAR s1

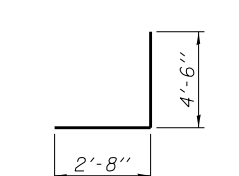

BAR v

BILL OF MATERIAL

Bar	No.	Size	Length	Shape
b	7	#4	21'-1"	—
b1	6	#4	18'-10"	—
d	28	#4	5'-4"	J
h	1	#4	12'-10"	┌
h1	4	#4	7'-8"	—
h2	4	#4	10'-6"	—
h3	1	#4	15'-6"	┌
h4	4	#4	9'-0"	—
h5	4	#4	5'-5"	—
h6	1	#4	14'-1"	┌
h7	1	#4	10'-9"	┌
s	2	#4	24'-5"	□
s1	2	#4	24'-11"	□
v	29	#4	7'-2"	J
Reinforcement Bars			Pound	600
Concrete Box Culverts			Cu. Yd.	12.2

Note: For Downstream cast-in-place apron end, see sheet 1 of 2.

LAST SAVED = 1/23/2013  
 PEN TABLE = V2:44:41  
 PLOT DRIVER = pdfNCLAYERS=plctcf

FILE NAME =	USER NAME = elagemann	DESIGNED K.A. Klues	REVISED -
I:\1001100\Phase II - 76817\Cad\S\Plans\Headwalls-76817.dgn		DRAWN K.A. Klues	REVISED -
	PLOT SCALE = 0:2.0000 1' = 1/4"	CHECKED E.M. Lagemann	REVISED -
	PLOT DATE = 1/23/2013 11:46:29 AM	DATE 01/09/2013	REVISED -

STATE OF ILLINOIS  
 DEPARTMENT OF TRANSPORTATION

HORNER &  
 SHIRIN, INC.  
 ENGINEERS

UPSTREAM APRON DETAILS  
 CULVERT AT STA. 2115+79.04

SCALE: SHEET NO. 2 OF 2 SHEETS STA. 2115+42.18 TO STA. 2116+19.32

F.A.P. R.T.E.	SECTION	COUNTY	TOTAL SHEETS	SHEET NO.
312	68-WRS-1	MONROE	760	448
CONTRACT NO. 76817			ILLINOIS FED. AID PROJECT	