

DATE	
BY	
FINAL SURVEY	SURVEYED
NOTE BOOK	PLOTTED
NO.	TEMPLATE
	AREAS
	CHECKED

DATE	
BY	
ORIGINAL SURVEY	SURVEYED
NOTE BOOK	PLOTTED
NO.	TEMPLATE
	AREAS
	CHECKED

LAST SAVED = 1/25/2013
 PEN TABLE = VBI-HA17-R1
 PLOT DRIVER = BDFNCLATER50wptc6f9

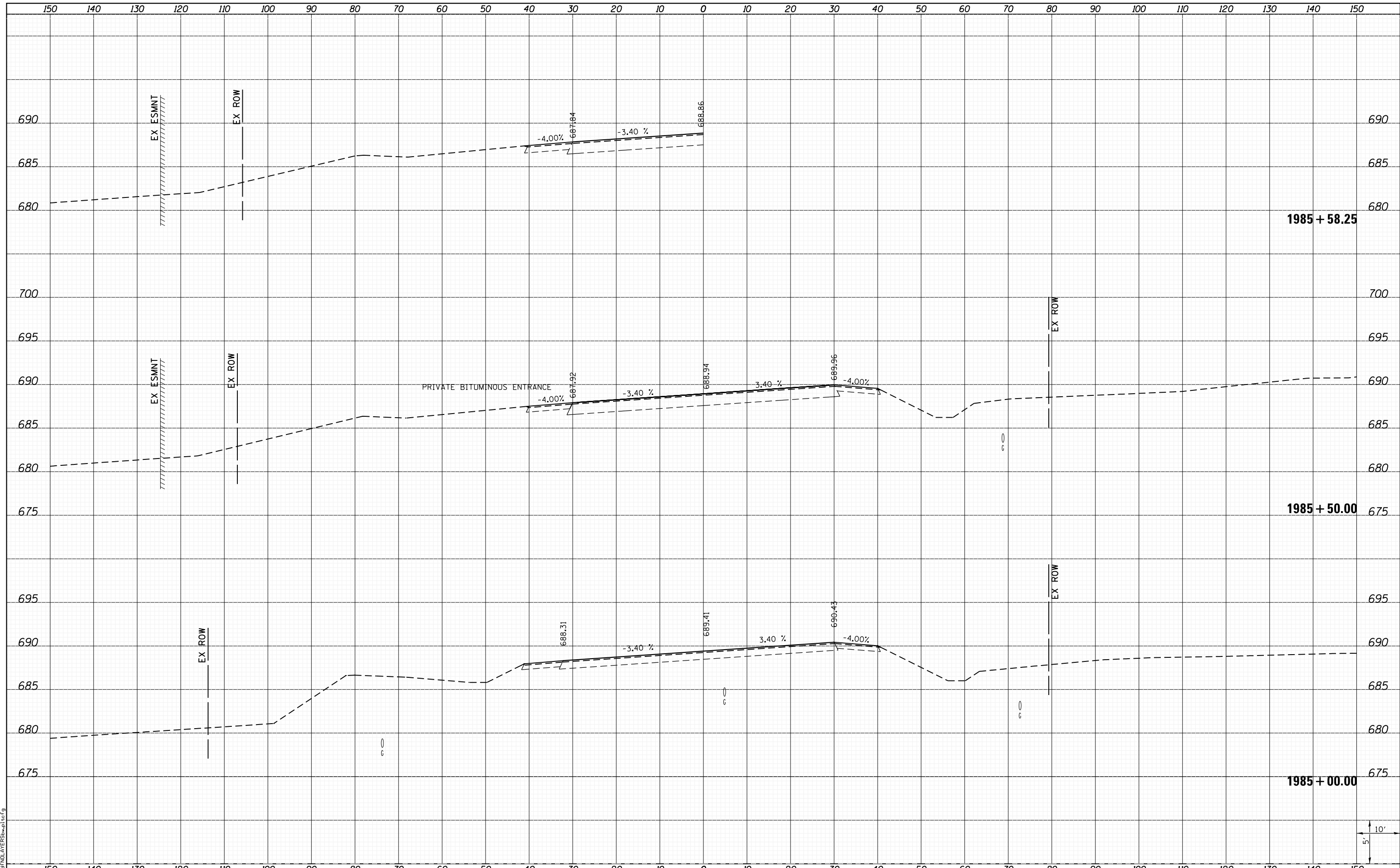

FILE NAME =	USER NAME = kakluos	DESIGNED -	REVISED -
I:\1001100\Phase II - 76817\Cad\T\Plans\300.00	76817-sh1-IL3-xssht.dgn	DRAWN -	REVISED -
		CHECKED -	REVISED -
		DATE -	REVISED -

PLOT SCALE = 20.0000' / in.	
PLOT DATE = 1/25/2013 4:49:23 PM	

**STATE OF ILLINOIS
DEPARTMENT OF TRANSPORTATION**



CROSS SECTIONS
IL ROUTE 3
SCALE: SHEET 3 OF 197 SHEETS STA. 1985+00.00 TO STA. 1985+58.25

F.A.P. RTE.	SECTION	COUNTY	TOTAL SHEETS	SHEET NO.
312	68-WRS-1	MONROE	760	489
CONTRACT NO. 76817			ILLINOIS FED. AID PROJECT	

