

DATE	
BY	
SURVEYED	
PLOTTED	
TEMPLATE	
NOTE BOOK	
AREAS CHECKED	
NO.	

DATE	
BY	
SURVEYED	
PLOTTED	
TEMPLATE	
NOTE BOOK	
AREAS CHECKED	
NO.	

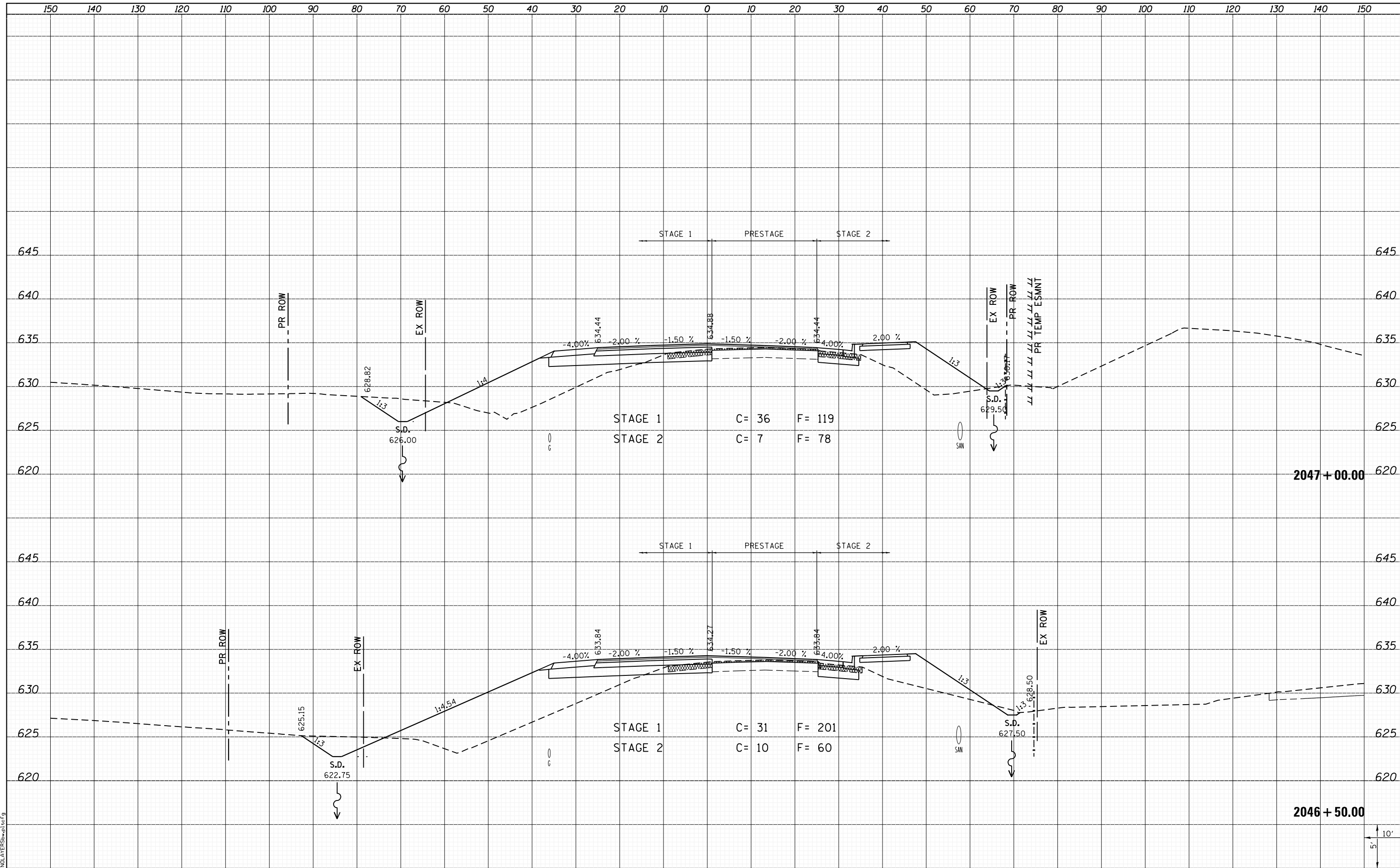

LAST SAVED = 1/25/2013
 PEN TABLE = 161-hat.rdi
 PLOT DRIVER = PdfPlotterServer.batcf9

FILE NAME = I:\10011001_Phase II - 76817\Cad\T\Plans\300.08	USER NAME = kakluos	DESIGNED -	REVISED -
	76817-sh1-IL3-xssht.dgn	DRAWN -	REVISED -
		CHECKED -	REVISED -
		DATE -	REVISED -
PLOT SCALE = 20.0000' / in.			
PLOT DATE = 1/25/2013 4:54:45 PM			

STATE OF ILLINOIS
 DEPARTMENT OF TRANSPORTATION



CROSS SECTIONS
 IL ROUTE 3

SCALE: SHEET 65 OF 197 SHEETS STA. 2046+50.00 TO STA. 2047+00.00

F.A.P. RTE.	SECTION	COUNTY	TOTAL SHEETS	SHEET NO.
312	68-WRS-1	MONROE	760	551
CONTRACT NO. 76817			ILLINOIS FED. AID PROJECT	