

DATE	
BY	
SURVEYED	
PLOTTED	
TEMPLATE	
AREAS	
CHECKED	
FINAL SURVEY	
NOTE BOOK	
NO.	

DATE	
BY	
SURVEYED	
PLOTTED	
TEMPLATE	
AREAS	
CHECKED	
ORIGINAL SURVEY	
NOTE BOOK	
NO.	

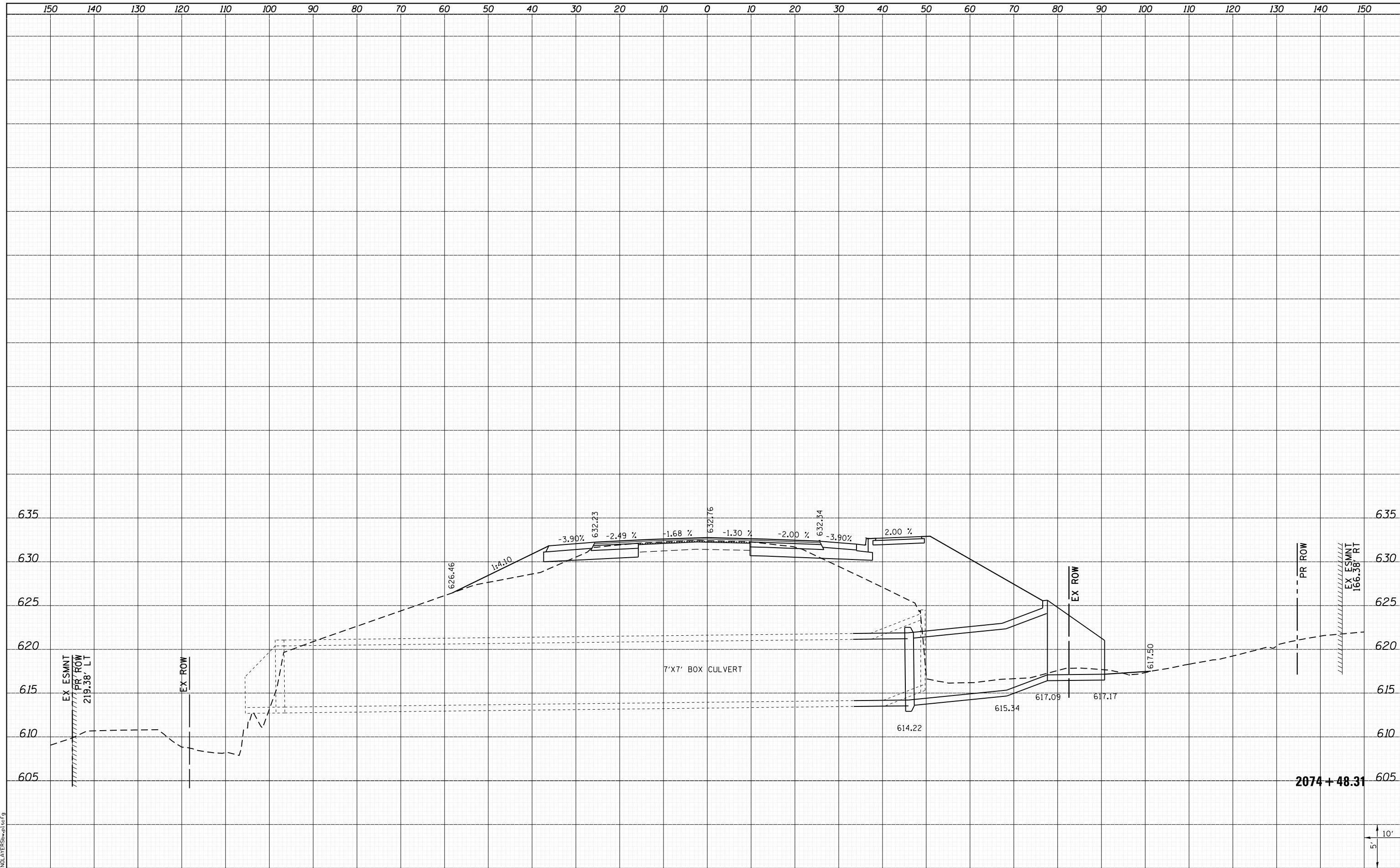

2074 + 48.31



LAST SAVED = 1/25/2013
 PEN TABLE = VBI-HAT.rdi
 PLOT DRIVER = PLOTCLTERSPW.pltcf9

FILE NAME = I:\10011001_Phase II - 76817\Cad\T\Plans\300.08	USER NAME = kaklues	DESIGNED -	REVISIED -
	76817-sh1-IL3-xssht.dgn	DRAWN -	REVISIED -
	PLOT SCALE = 20.0000' / in.	CHECKED -	REVISIED -
	PLOT DATE = 1/25/2013 4:56:58 PM	DATE -	REVISIED -

STATE OF ILLINOIS
 DEPARTMENT OF TRANSPORTATION



CROSS SECTIONS
 IL ROUTE 3

SCALE: SHEET 92 OF 197 SHEETS STA. 2074+48.31 TO STA. 2074+48.31

F.A.P. RTE.	SECTION	COUNTY	TOTAL SHEETS	SHEET NO.
312	68-WRS-1	MONROE	760	578
CONTRACT NO. 76817			ILLINOIS FED. AID PROJECT	