

BY	DATE
SURVEYED	
PLOTTED	
TEMPLATE	
AREAS	
CHECKED	
NO.	

BY	DATE
SURVEYED	
PLOTTED	
TEMPLATE	
AREAS	
CHECKED	
NO.	

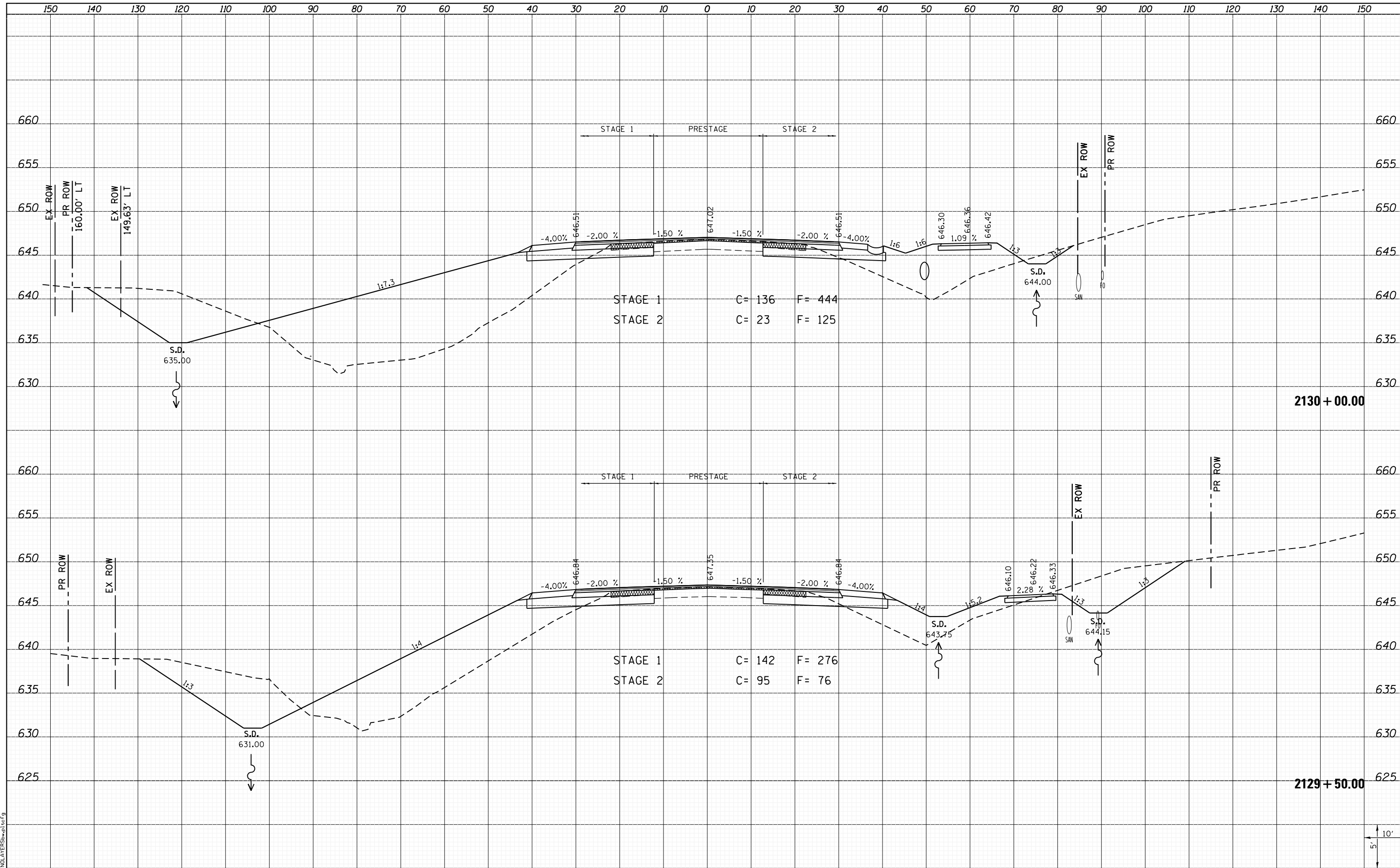

LAST SAVED = 1/25/2013 5:02:15 PM
 PEN TABLE = I:\10011000\Phase II - 76817\Cad\T\Plns\300.08
 PLOT DRIVER = PdfPlotterSpw.bat

FILE NAME = I:\10011000\Phase II - 76817\Cad\T\Plns\300.08	USER NAME = kakluos	DESIGNED -	REVISIED -
	76817-sh1-IL3-xssht.dgn	DRAWN -	REVISIED -
	PLOT SCALE = 20.0000' / in.	CHECKED -	REVISIED -
	PLOT DATE = 1/25/2013 5:02:15 PM	DATE -	REVISIED -

STATE OF ILLINOIS
 DEPARTMENT OF TRANSPORTATION



CROSS SECTIONS
 IL ROUTE 3

SCALE: SHEET 153 OF 197 SHEETS STA. 2129+50.00 TO STA. 2130+00.00

F.A.P. RTE. 312	SECTION 68-WRS-1	COUNTY MONROE	TOTAL SHEETS 760	SHEET NO. 639
CONTRACT NO. 76817				ILLINOIS FED. AID PROJECT