

DATE	
BY	
FINAL SURVEY	
PLOTTED	
TEMPLATE	
NOTE BOOK	
AREAS CHECKED	
NO.	

DATE	
BY	
ORIGINAL SURVEY	
PLOTTED	
TEMPLATE	
NOTE BOOK	
AREAS CHECKED	
NO.	

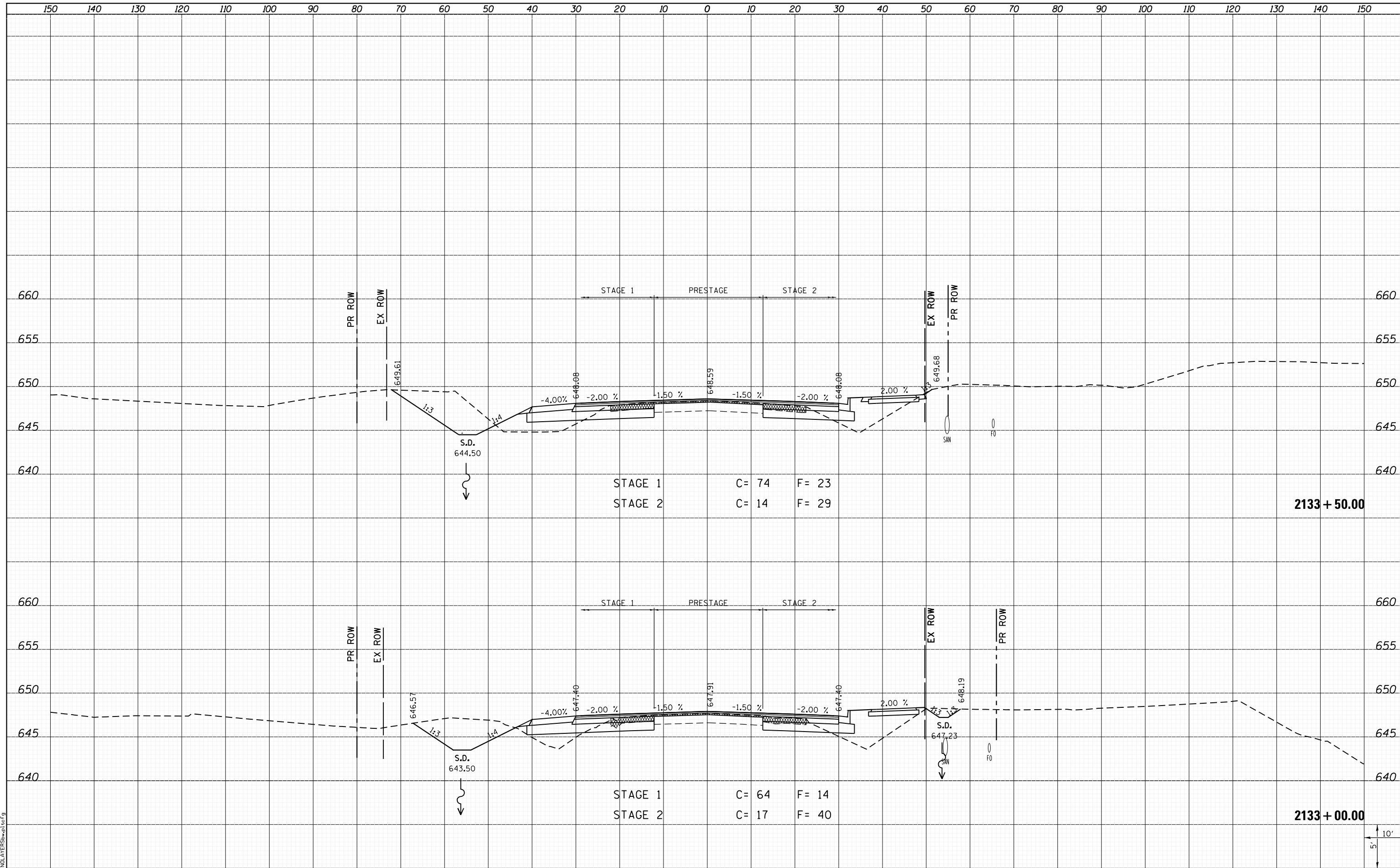

LAST SAVED = 1/25/2013
 PEN TABLE = 161-hat.tbl
 PLOT DRIVER = PdfPlotterServer.bat

FILE NAME =	USER NAME = kakluos	DESIGNED -	REVISED -
I:\1001100\Phase II - 76817\Cad\T\Plans\300.08	76817-sh1-IL3-xssht.dgn	DRAWN -	REVISED -
	PLOT SCALE = 20.0000' / in.	CHECKED -	REVISED -
	PLOT DATE = 1/25/2013 5:02:35 PM	DATE -	REVISED -

**STATE OF ILLINOIS
 DEPARTMENT OF TRANSPORTATION**



**CROSS SECTIONS
 IL ROUTE 3**

SCALE: SHEET 157 OF 197 SHEETS STA. 2133+00.00 TO STA. 2133+50.00

F.A.P. RTE.	SECTION	COUNTY	TOTAL SHEETS	SHEET NO.
312	68-WRS-1	MONROE	760	643
			CONTRACT NO. 76817	
ILLINOIS FED. AID PROJECT				