

DATE	
BY	
FINAL SURVEY	SURVEYED
NOTE BOOK	PLOTTED
NO.	TEMPLATE
	AREAS
	CHECKED

DATE	
BY	
ORIGINAL SURVEY	SURVEYED
NOTE BOOK	PLOTTED
NO.	TEMPLATE
	AREAS
	CHECKED

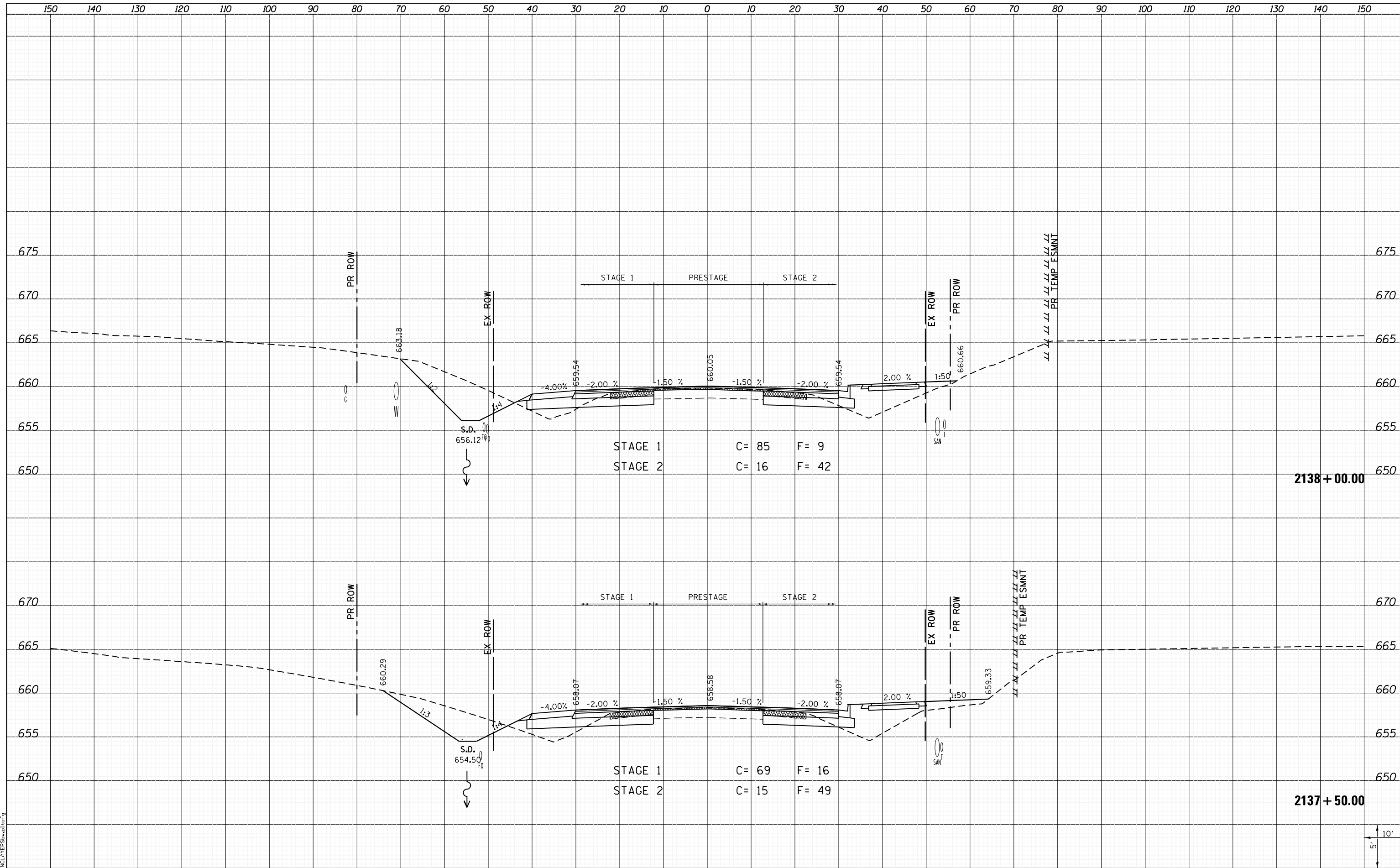

STAGE 1 C = 85 F = 9
 STAGE 2 C = 16 F = 42

STAGE 1 C = 69 F = 16
 STAGE 2 C = 15 F = 49

2138 + 00.00

2137 + 50.00

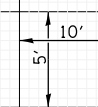

LAST SAVED = 1/25/2013
 PEN TABLE = \\h1-hat\rd1
 PLOT DRIVER = \\h1-hat\rd1

FILE NAME =	USER NAME = kakluos	DESIGNED -	REVISIED -	STATE OF ILLINOIS DEPARTMENT OF TRANSPORTATION		CROSS SECTIONS		F.A.P. RTE.	SECTION	COUNTY	TOTAL SHEETS	SHEET NO.
I:\1001100\Phase II - 76817\Cad\T\Plans\300.08	6817-sh1-IL3-xssht.dgn	DRAWN -	REVISIED -			312	68-WRS-1	MONROE	760	648		
PLOT SCALE = 20.0000' / in.		CHECKED -	REVISIED -			CONTRACT NO. 76817						
PLOT DATE = 1/25/2013 5:02:59 PM		DATE -	REVISIED -			ILLINOIS FED. AID PROJECT						