

DATE	
BY	
FINAL SURVEY	
SURVEY PLOTTED	
NOTE BOOK	
AREAS CHECKED	
NO.	

DATE	
BY	
ORIGINAL SURVEY	
SURVEY PLOTTED	
NOTE BOOK	
AREAS CHECKED	
NO.	

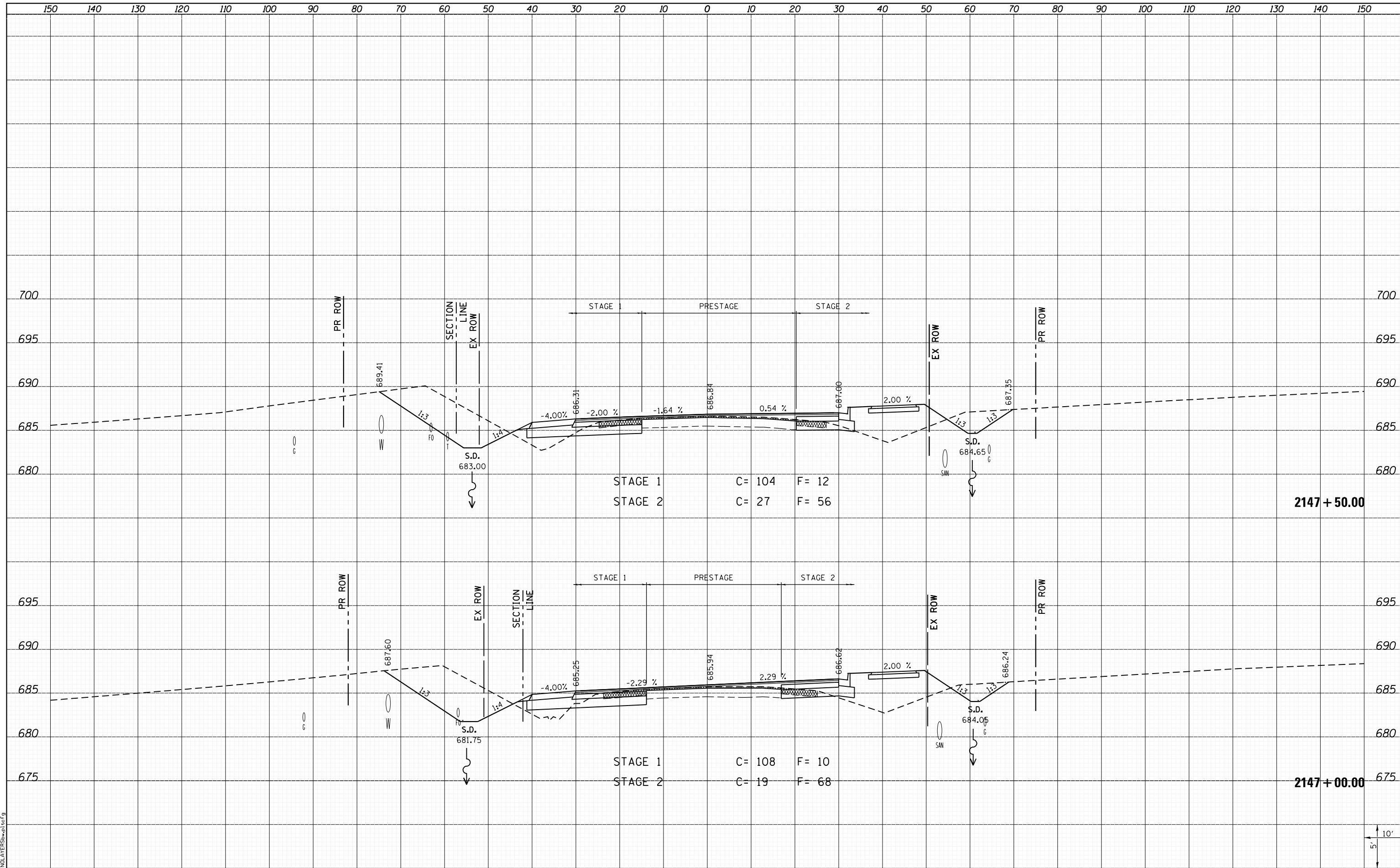

STAGE 1 C= 104 F= 12  
 STAGE 2 C= 27 F= 56

STAGE 1 C= 108 F= 10  
 STAGE 2 C= 19 F= 68

2147+50.00

2147+00.00

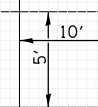

LAST SAVED = 1/25/2013  
 PEN TABLE = 161-hat.tbl  
 PLOT DRIVER = pdfplotter.exe

FILE NAME = I:\10011000\Phase II - 76817\Cad\T\Plans\300.08	USER NAME = kakluos	DESIGNED -	REVISD -	<b>STATE OF ILLINOIS</b> <b>DEPARTMENT OF TRANSPORTATION</b>		<b>CROSS SECTIONS</b> IL ROUTE 3		F.A.P. RTE.	SECTION	COUNTY	TOTAL SHEETS	SHEET NO.
		DRAWN -	REVISD -					312	68-WRS-1	MONROE	760	658
		CHECKED -	REVISD -					CONTRACT NO. 76817				
		DATE -	REVISD -					ILLINOIS FED. AID PROJECT				
PLOT SCALE = 20.0000' / in. PLOT DATE = 1/25/2013 5:03:48 PM				SCALE:		SHEET 172 OF 197 SHEETS		STA. 2147+00.00 TO STA. 2147+50.00				