

DATE	
BY	
FINAL SURVEY	
SURVEYED	
PLOTTED	
TEMPLATE	
NOTE BOOK	
AREAS CHECKED	
NO.	

DATE	
BY	
ORIGINAL SURVEY	
SURVEYED	
PLOTTED	
TEMPLATE	
NOTE BOOK	
AREAS CHECKED	
NO.	

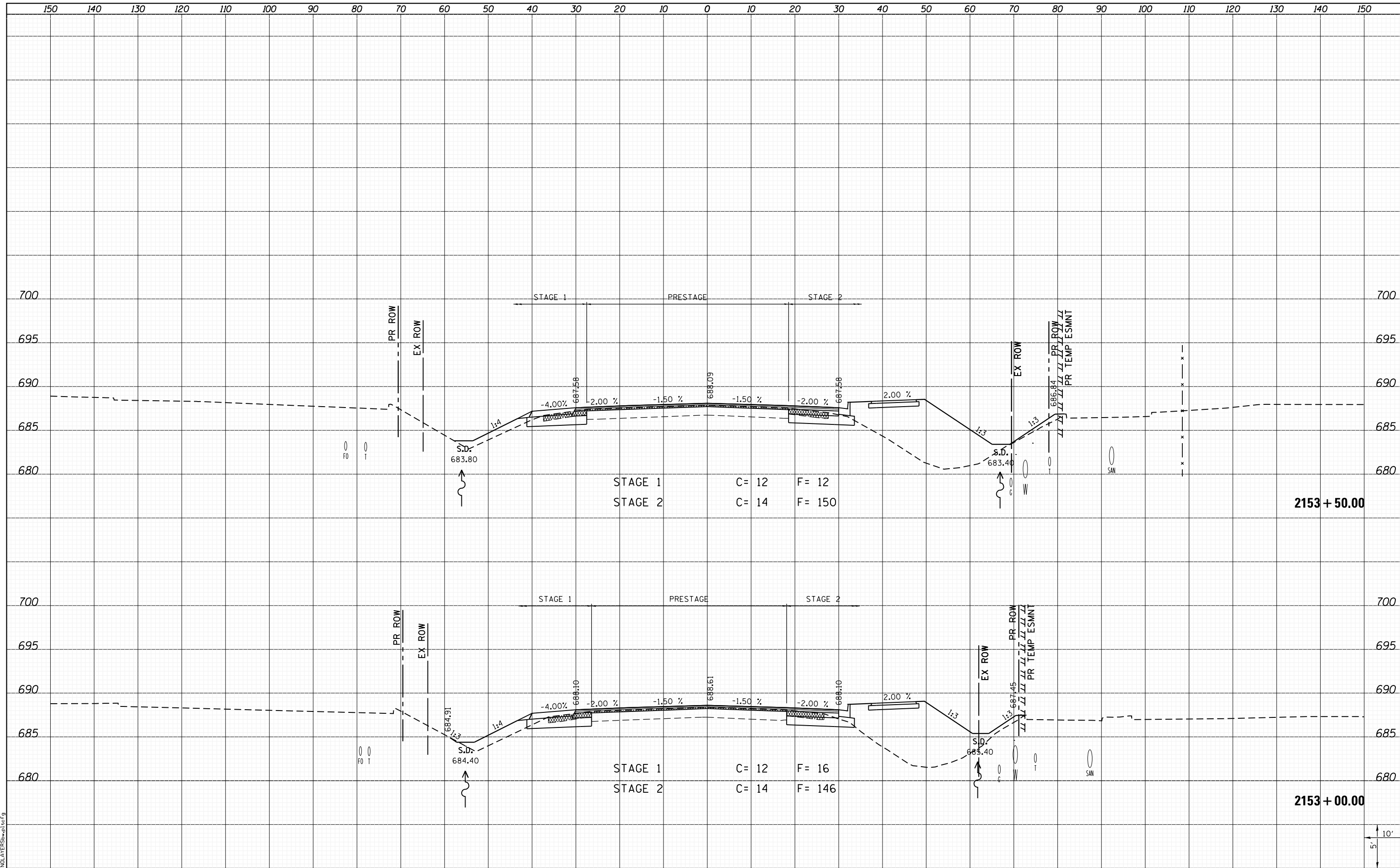

**STATE OF ILLINOIS  
DEPARTMENT OF TRANSPORTATION**



**CROSS SECTIONS  
IL ROUTE 3**

FILE NAME = I:\10011001\Phase II - 76817\Cad\T\Plans\300.08  
 LAST SAVED = 1/25/2013 5:04:18 PM  
 PEN TABLE = 161-hat.tbl  
 PLOT DRIVER = batplotter\$wpltcfg

USER NAME = kakluos	DESIGNED -	REVISIED -
I:\10011001\Phase II - 76817-sh1-IL3-xssht.dgn	DRAWN -	REVISIED -
PLOT SCALE = 20.0000' / in.	CHECKED -	REVISIED -
PLOT DATE = 1/25/2013 5:04:18 PM	DATE -	REVISIED -

REVISIED -
REVISIED -
REVISIED -
REVISIED -

SCALE: SHEET 178 OF 197 SHEETS STA. 2153+00.00 TO STA. 2153+50.00

F.A.P. RTE.	SECTION	COUNTY	TOTAL SHEETS	SHEET NO.
312	68-WRS-1	MONROE	760	664
				CONTRACT NO. 76817
ILLINOIS FED. AID PROJECT				

