

DATE	
BY	
SURVEYED	
PLOTTED	
TEMPLATE	
AREAS	
CHECKED	
NO.	

DATE	
BY	
SURVEYED	
PLOTTED	
TEMPLATE	
AREAS	
CHECKED	
NO.	

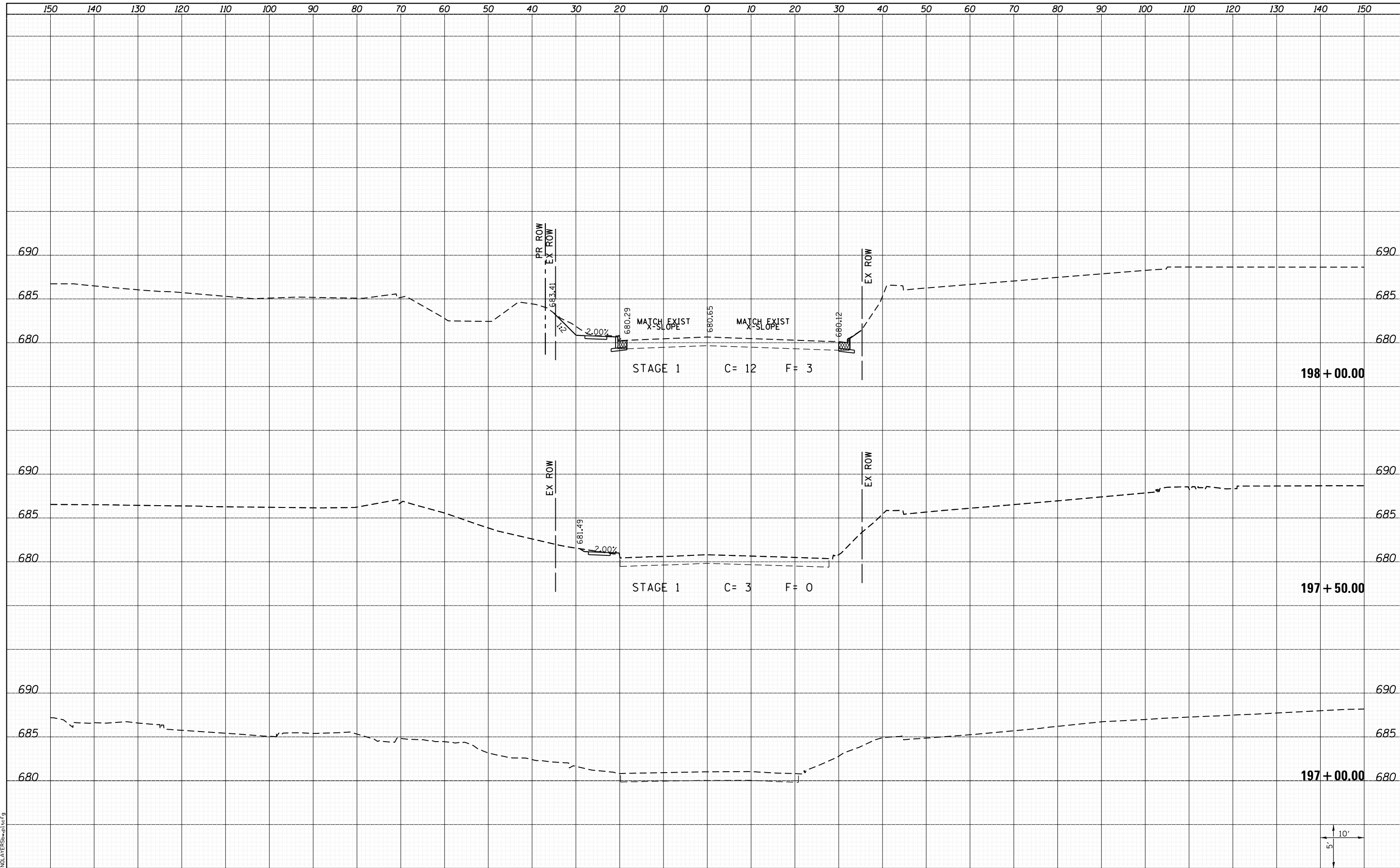

LAST SAVED = 1/24/2013
 PEN TABLE = \\h1-hat\rd1
 PLOT DRIVER = \\h1-hat\rd1

FILE NAME =	USER NAME = kaklues	DESIGNED -	REVISED -
I:\1001100\Phase II - 76817\Cad\T\Plans\312.L087	6817-sh1-N_Market-xssh.dgn	DRAWN -	REVISED -
	PLOT SCALE = 20.0000' / in.	CHECKED -	REVISED -
	PLOT DATE = 1/25/2013 5:06:51 PM	DATE -	REVISED -

**STATE OF ILLINOIS
 DEPARTMENT OF TRANSPORTATION**



**CROSS SECTIONS
 NORTH MARKET DRIVE**

SCALE: SHEET 1 OF 9 SHEETS STA. 197+00.00 TO STA. 198+00.00

F.A.P. RTE.	SECTION	COUNTY	TOTAL SHEETS	SHEET NO.
312	68-WRS-1	MONROE	760	748
CONTRACT NO. 76817			ILLINOIS FED. AID PROJECT	

