

DATE	
BY	
FINAL SURVEY	SURVEYED
NOTE BOOK	PLOTTED
NO.	TEMPLATE
	AREAS CHECKED

DATE	
BY	
ORIGINAL SURVEY	SURVEYED
NOTE BOOK	PLOTTED
NO.	TEMPLATE
	AREAS CHECKED

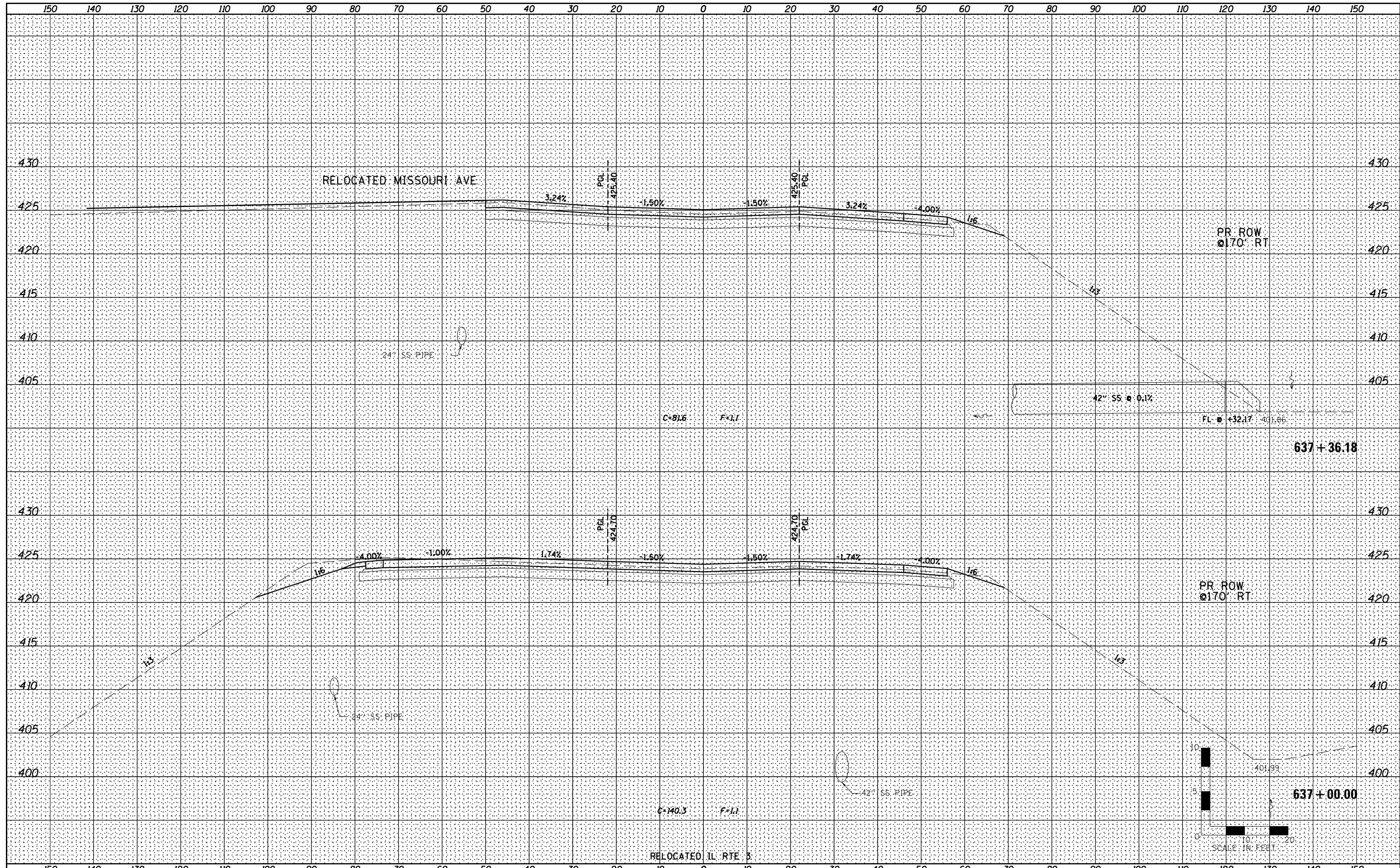

Farnsworth
GROUP, INC.
2709 McGraw Drive
Bloomington, Illinois 61704
309/663-8435, 309/663-1571 fax

USER NAME = *USERS*	DESIGNED - JJ0	REVISED -
	DRAWN - JJ0	REVISED -
PLOT SCALE =	CHECKED - PJM	REVISED -
PLOT DATE	DATE - 03/20/13	REVISED -

STATE OF ILLINOIS
DEPARTMENT OF TRANSPORTATION

RELOCATED IL RTE 3
CROSS SECTIONS
SCALE: SHEET NO. OF SHEETS STA. 637+00.00 TO STA. 637+36.18

F.A.P. RTE.	SECTION	COUNTY	TOTAL SHEETS	SHEET NO.
788	520-1-2	ST. CLAIR	142	106
CONTRACT NO. 76850				
ILLINOIS FED. AID PROJECT				