

BY	DATE

ORIGINAL SURVEY NO.	SURVEYED PLOTTED AREAS CHECKED

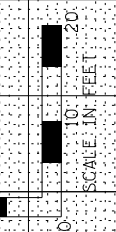
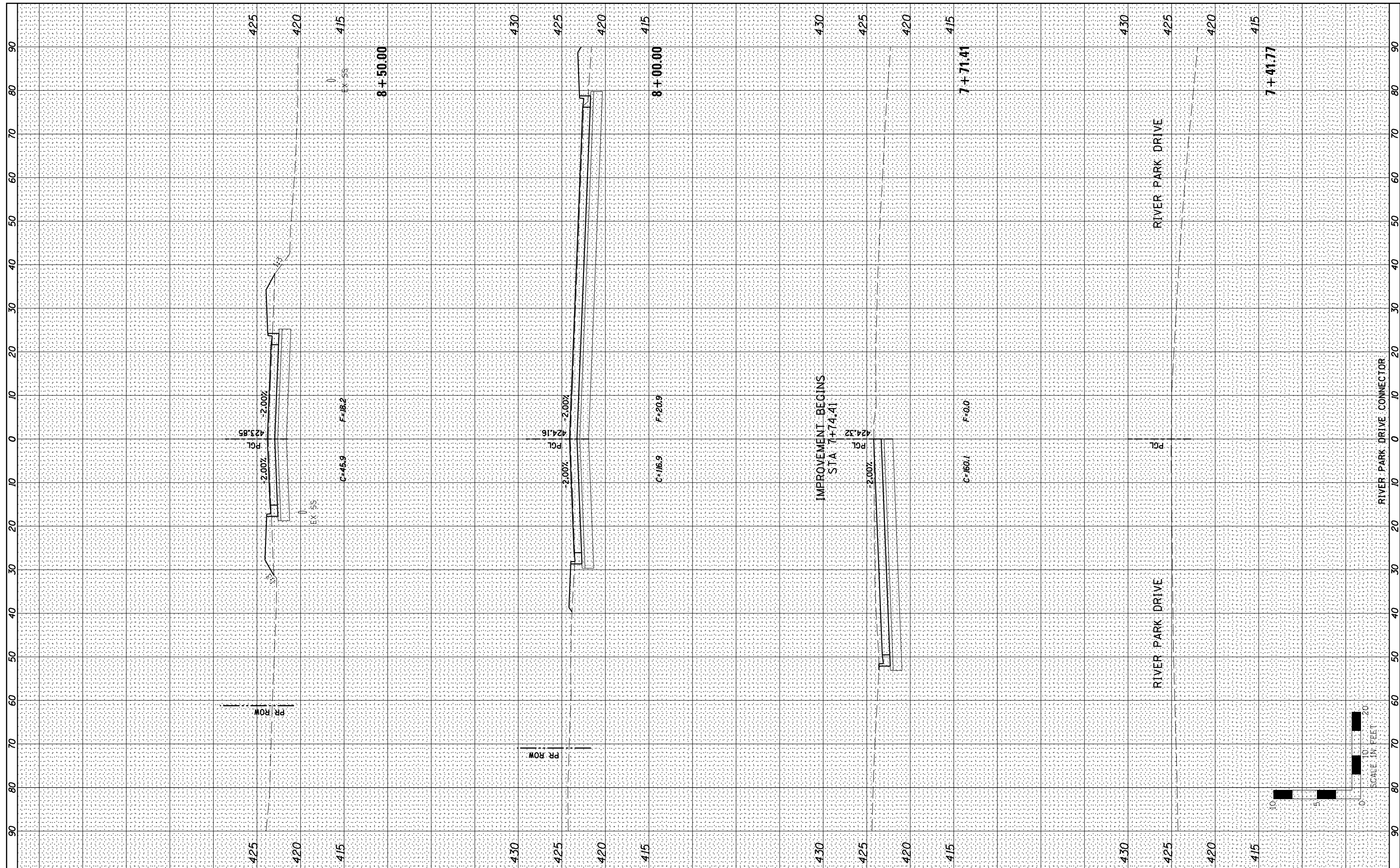

Farnsworth GROUP, INC.
2709 McGraw Drive
Bloomington, Illinois 61704
309/663-8435, 309/663-1571 fax

USER NAME = *USER*	DESIGNED - JJO	REVISED -
	DRAWN - JJO	REVISED -
PLOT SCALE = *SCALE*	CHECKED - PJM	REVISED -
PLOT DATE = *DATE*	DATE - 03/20/13	REVISED -

**STATE OF ILLINOIS
DEPARTMENT OF TRANSPORTATION**

**RIVER PARK DRIVE CONNECTOR
CROSS SECTIONS**

SCALE: SHEET NO. OF SHEETS STA. 7+41.77 TO STA. 8+50.00

F.A.P. RTE. 788	SECTION 520-1-2	COUNTY ST. CLAIR	TOTAL SHEETS 142	SHEET NO. 115
CONTRACT NO. 76850				

ILLINOIS FED. AID PROJECT