

DATE	
BY	
REVISION	
NO.	
DATE	
BY	
REVISION	
NO.	
DATE	
BY	
REVISION	
NO.	

DATE	
BY	
REVISION	
NO.	
DATE	
BY	
REVISION	
NO.	
DATE	
BY	
REVISION	
NO.	

PROP. CURVE RUNAROUND-1
 PI STA. = 202+74.80
 $\Delta = 67^\circ 10' 05''$ (LT)
 $D = 76^\circ 23' 40''$
 $R = 75.00'$
 $T = 49.80'$
 $L = 87.92'$
 $E = 15.03'$
 $\theta = \dots$
 $T.R. = \dots$
 $S.E. RUN = \dots$
 P.C. STA. = 202+25.00
 P.T. STA. = 203+12.92

PROP. CURVE RUNAROUND-2
 PI STA. = 203+95.92
 $\Delta = 64^\circ 54' 54''$ (RT)
 $D = 76^\circ 23' 40''$
 $R = 75.00'$
 $T = 47.70'$
 $L = 84.97'$
 $E = 13.88'$
 $\theta = \dots$
 $T.R. = \dots$
 $S.E. RUN = \dots$
 P.C. STA. = 203+48.22
 P.T. STA. = 204+33.19

PROP. CURVE RUNAROUND-3
 PI STA. = 207+44.85
 $\Delta = 95^\circ 19' 20''$ (LT)
 $D = 76^\circ 23' 40''$
 $R = 75.00'$
 $T = 82.31'$
 $L = 124.78'$
 $E = 36.36'$
 $\theta = \dots$
 $T.R. = \dots$
 $S.E. RUN = \dots$
 P.C. STA. = 206+62.54
 P.T. STA. = 207+87.32

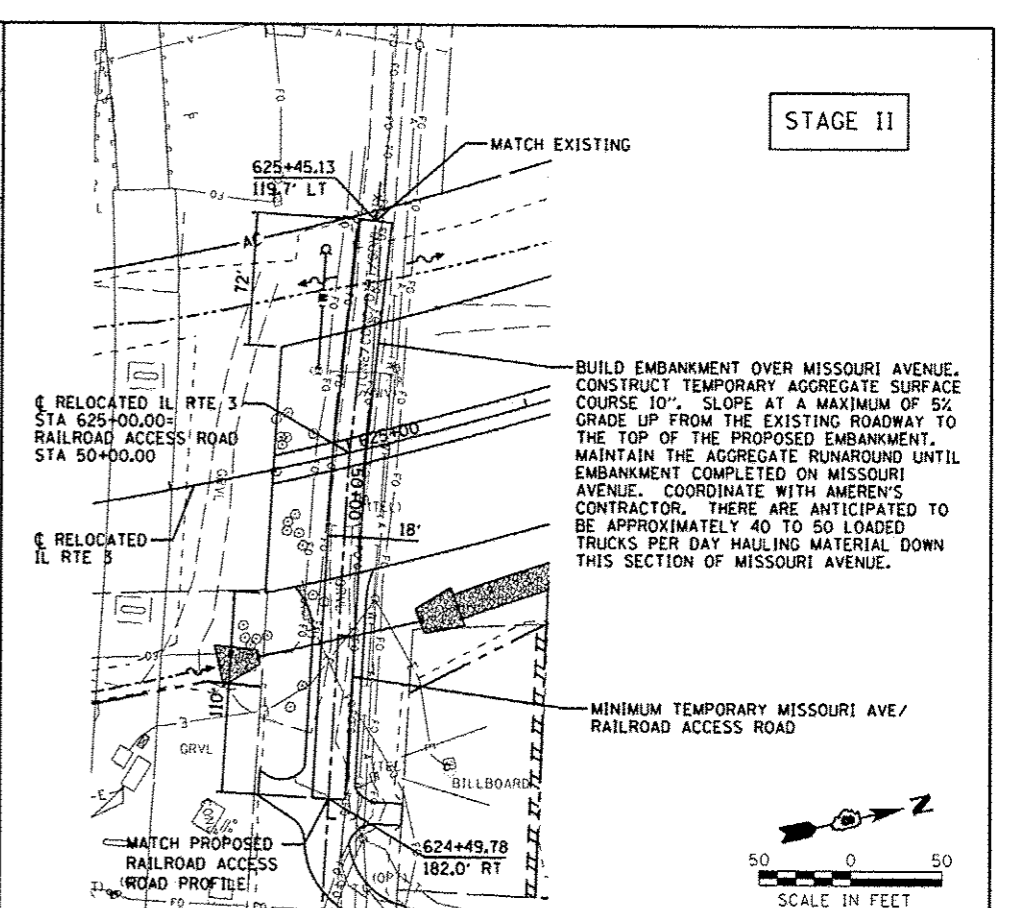
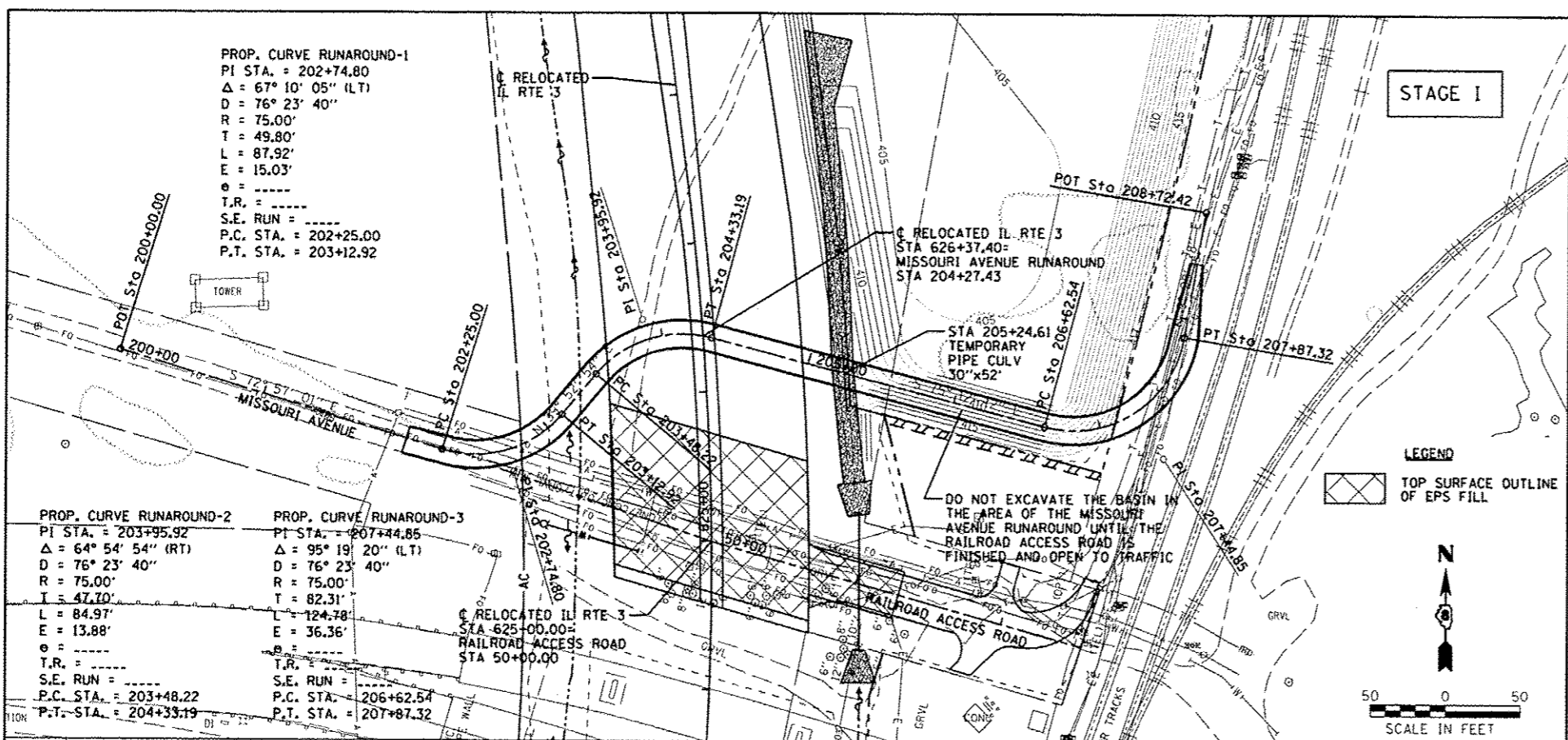

STAGE I NOTES:

1. INSTALL AGGREGATE FOR TEMPORARY ACCESS, 10" FOR RUNAROUND ON THE NORTH SIDE. GRADING FOR TEMPORARY ACCESS SHALL BE INCLUDED IN THE UNIT PRICE BID PER TON FOR AGGREGATE FOR TEMPORARY ACCESS.
2. SWITCH TRAFFIC TO MISSOURI AVENUE RUNAROUND.
3. EXPOSE UTILITIES AND UNDERGROUND OBSTRUCTIONS. REMOVE OBSTRUCTIONS IN CONFLICT WITH EPS FILL.
4. INSTALL SAND BEDDING (FA-1) 6", EPS FILL, FOUNDATION CAP AND MINIMUM 10" SUBBASE GRANULAR MATERIAL, TYPE C.
5. THERE ARE ANTICIPATED TO BE APPROXIMATELY 40 TO 50 LOADED TRUCKS PER DAY HAULING MATERIAL DOWN THIS SECTION OF MISSOURI AVENUE.

NOTE: EXPANDED POLYSTYRENE FILL = EPS FILL

ALIGNMENT COORDINATES - MISSOURI AVENUE RUNAROUND			
STATION	NORTHING	EASTING	
POT 200+00.00	14040602.4899	2449867.6353	
PC 202+25.00	14040536.5191	2450082.7465	
PI 202+74.80	14040521.9176	2450130.3576	
PT 203+12.92	14040560.1325	2450162.2895	
PC 203+48.22	14040587.2183	2450184.9221	
PI 203+95.92	14040623.8234	2450215.5089	
PT 204+33.19	14040611.6408	2450261.6291	
PC 206+62.54	14040553.0675	2450483.3722	
PI 207+44.85	14040532.0460	2450562.9544	
PT 207+87.32	14040613.2350	2450576.5034	
POT 208+72.42	14040697.1722	2450590.5110	

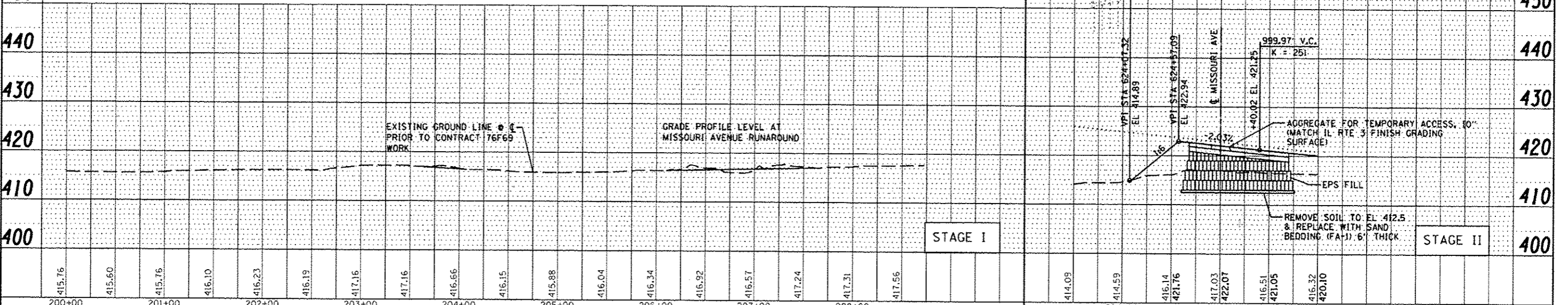
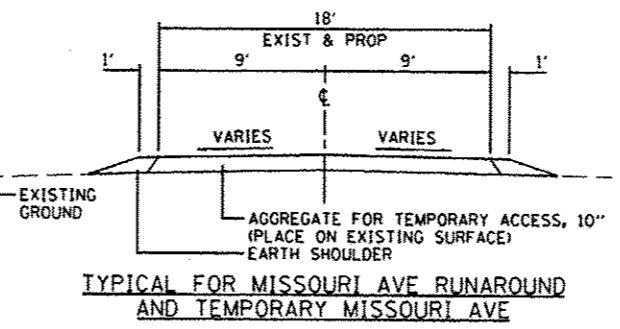

Farnsworth GROUP, INC.
 2709 McGraw Drive
 Bloomington, Illinois 61704
 309/663-8430, 309/663-1571 fax

USER NAME = #USER#	DESIGNED - JJO	REVISED - 6-5-13
PLBT SCALE = #SCALE#	DRAWN - JJO	REVISED -
PLDT DATE = #DATE#	CHECKED - PJM	REVISED -
	DATE - 05/24/13	REVISED -

STATE OF ILLINOIS DEPARTMENT OF TRANSPORTATION

SCALE:	SHEET NO. OF SHEETS	STA. TO STA.

F.A.P. R.I.L.	SECTION	COUNTY	TOTAL SHEETS	SHEET NO.
788	520-1-2-1	ST. CLAIR	121	31C
CONTRACT NO. 76F70				
ILLINOIS FED. AID PROJECT				