

FILE: S:\PROJECTS\2008\1139001\Phase1\DESIGN\79-113\phase2\crosssections\sheet.dgn

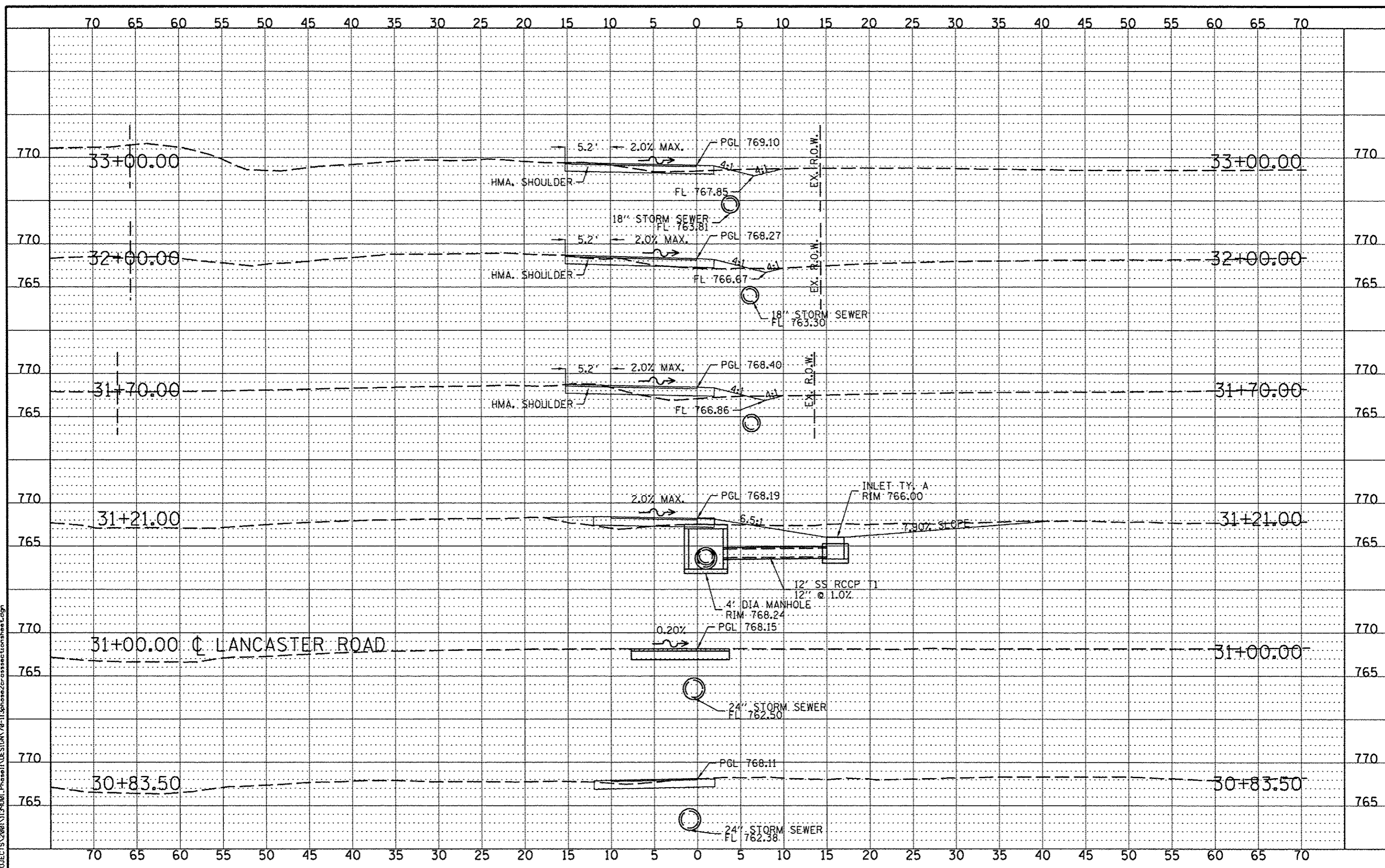

REVISION	DATE	BY	REMARKS
#1	03/22/13	TJA	IDOT COMMENTS FROM JAN. 28, 2013

DRAWN: T.J.A.
 CHECKED: C.J.B.
 APPROVED: C.J.B.

WINNEBAGO COUNTY
VILLAGE OF CHERRY VALLEY
PERRYVILLE PATH SOUTHEAST CONNECTION



CROSS SECTION SHEET
 STA. 30+83.50 - STA. 33+00.00

SECTION	COUNTY	TOTAL SHEETS	SHEET NO.
01-00302-00-BT	WINNEBAGO	124	77

STA. 0+04.96 - STA. 170+75.02
 WHA #: 1139001 DATE: 03/01/2013