

DATE	
BY	
PROJECT NO.	
DATE PLOTTED	
DATE CHECKED	
DATE NOTED	
DATE STRUCTURE NOTATIONS DPOD	
NO.	

DATE	
BY	
PROJECT NO.	
DATE PLOTTED	
DATE CHECKED	
DATE NOTED	
DATE STRUCTURE NOTATIONS DPOD	
NO.	

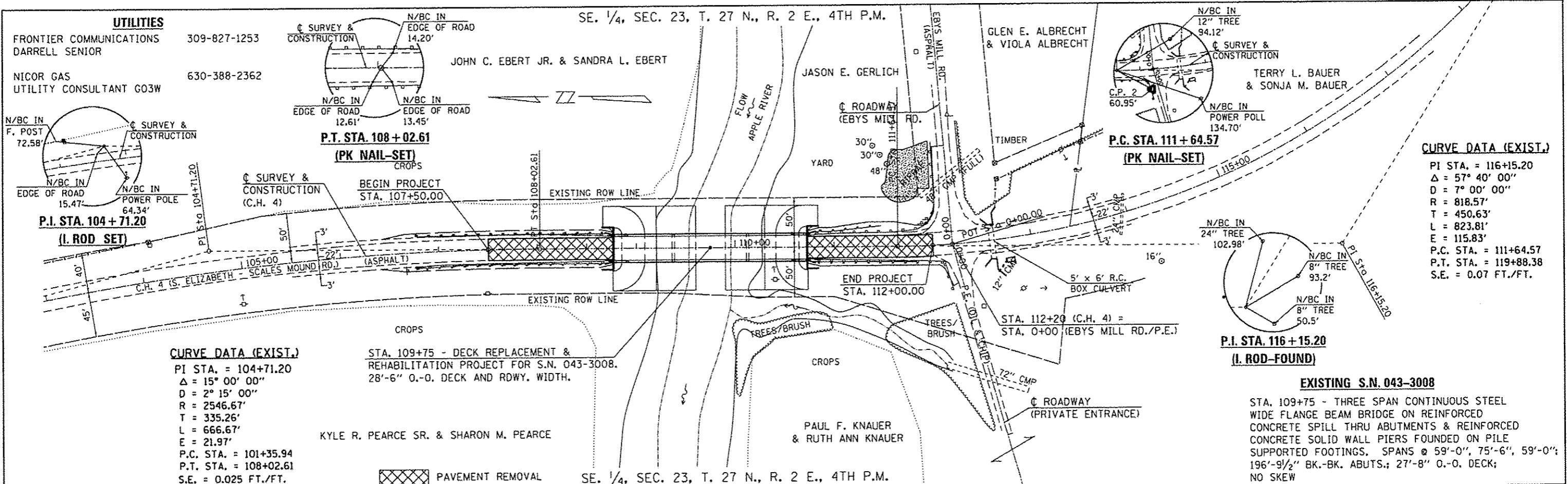

CURVE DATA (EXIST.)
 PI STA. = 104+71.20
 $\Delta = 15^\circ 00' 00''$
 $D = 2^\circ 15' 00''$
 $R = 2546.67'$
 $T = 335.26'$
 $L = 666.67'$
 $E = 21.97'$
 P.C. STA. = 101+35.94
 P.T. STA. = 108+02.61
 S.E. = 0.025 FT./FT.

STA. 109+75 - DECK REPLACEMENT & REHABILITATION PROJECT FOR S.N. 043-3008.
 28'-6" O.-O. DECK AND RDWY. WIDTH.
 KYLE R. PEARCE SR. & SHARON M. PEARCE

P.C. STA. 111+64.57
(PK NAIL-SET)

CURVE DATA (EXIST.)
 PI STA. = 116+15.20
 $\Delta = 57^\circ 40' 00''$
 $D = 7^\circ 00' 00''$
 $R = 818.57'$
 $T = 450.63'$
 $L = 823.81'$
 $E = 115.83'$
 P.C. STA. = 111+64.57
 P.T. STA. = 119+88.38
 S.E. = 0.07 FT./FT.

P.I. STA. 116+15.20
(I. ROD-FOUND)

EXISTING S.N. 043-3008
 STA. 109+75 - THREE SPAN CONTINUOUS STEEL WIDE FLANGE BEAM BRIDGE ON REINFORCED CONCRETE SPILL THRU ABUTMENTS & REINFORCED CONCRETE SOLID WALL PIERS FOUNDED ON PILE SUPPORTED FOOTINGS. SPANS @ 59'-0", 75'-6", 59'-0"; 196'-9 1/2" BK.-BK. ABUTS.; 27'-8" O.-O. DECK; NO SKEW

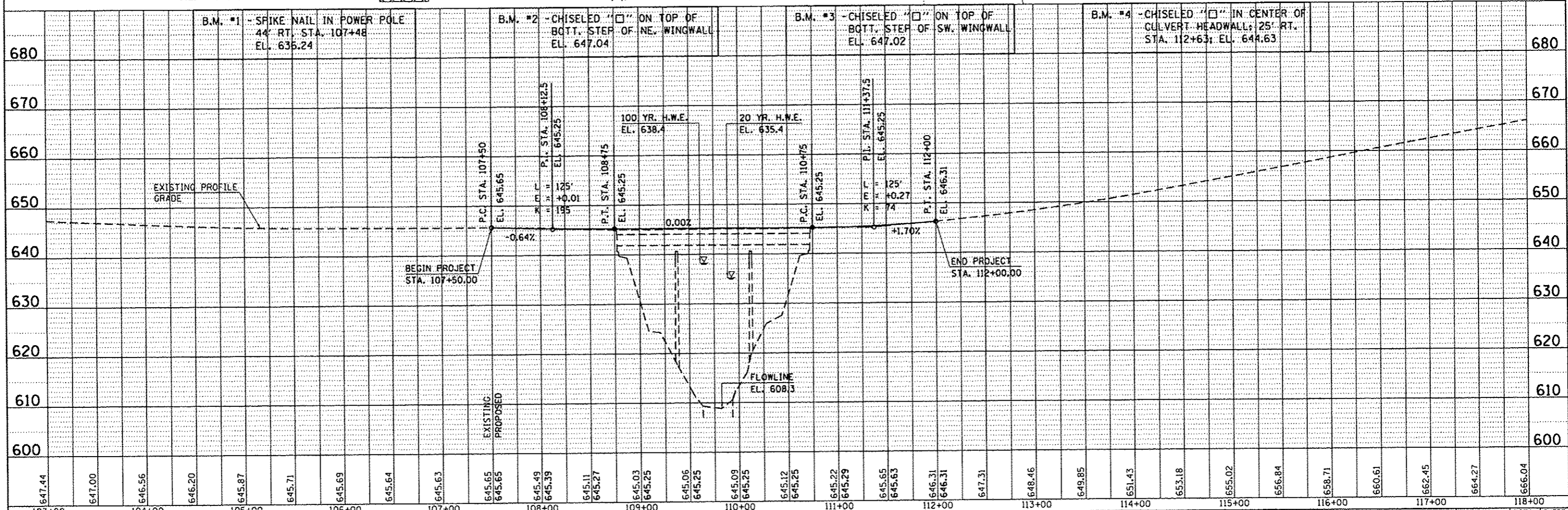

FILE NAME: 11-194.P&P.DGN	DESIGNED: G.J.C.	REVISED:	4440 ASH GROVE SPRINGFIELD, IL 62711 (217) 793-8600 www.fehr-graham.com	FREEPORT, IL ROCKFORD, IL ROCHELLE, IL SPRINGFIELD, IL	PLAN AND PROFILE - C.H. 4 OVER APPLE RIVER	C.H. 4	SECTION 11-00138-00-BR	COUNTY JO DAVIESS	TOTAL SHEETS 34	SHEET NO. 3
PLOTTED BY: S.A.P.	DRAWN: S.A.P.	REVISED:								
CHECKED BY: R.J.C.	CHECKED: R.D.F.	REVISED:								
PLOT DATE: 12/09/11	DATE: 12/09/11	REVISED:								