

FAS ROUTE NO.	SEC	COUNTY	TOTAL SHEETS	SHEET NO.
—	*	STEPHENSON	14	7

ILLINOIS PROJECT BROS-0177(045)

* 12-03120-00-BR
CONTRACT NO. 85587

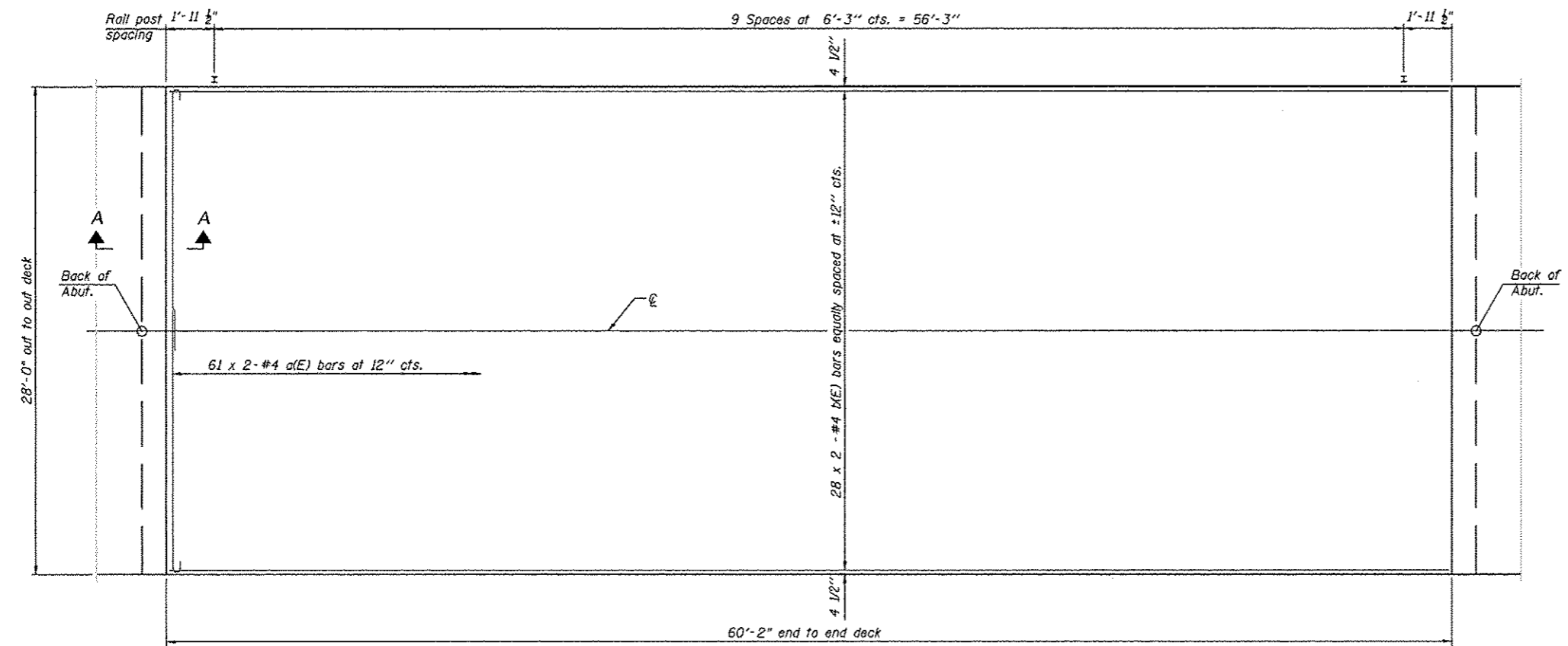
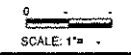

PLAN

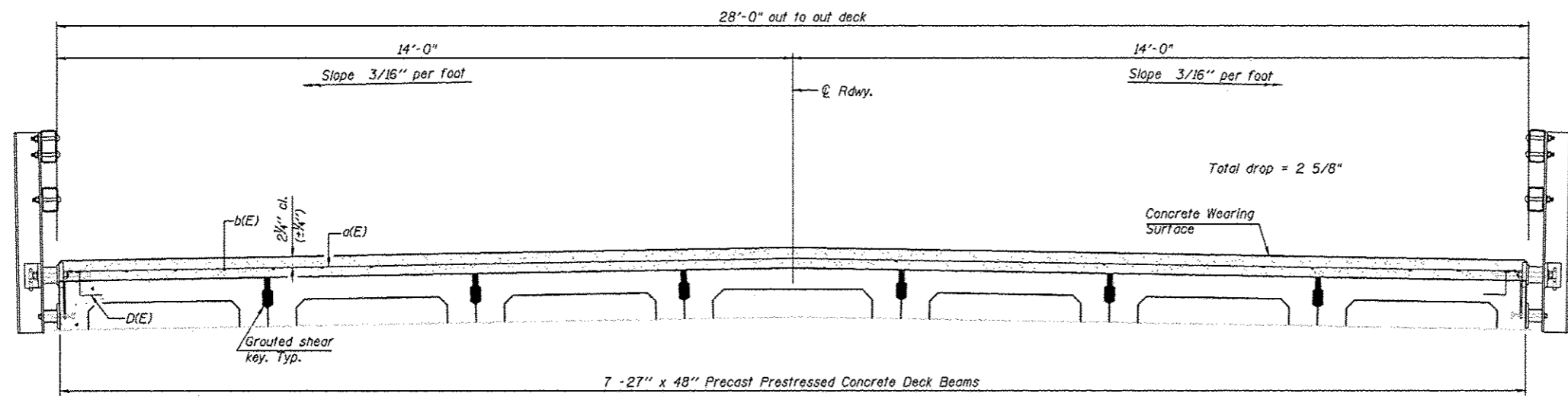

CROSS SECTION
(Looking NORTH)

SECTION A-A
Notes:
All concrete wearing surfaces shall be placed prior to casting a backwall and/or approach slab.

REVISIONS	DATE

DESIGNED BY:	DATE:
CHECKED BY:	
APPROVED BY:	

wendler
GROUNDWATER SOLUTIONS
engineers - surveyors - geologists
www.wendlergs.com P: 815.288.2261
Professional Design Firm No. 184-000648

SUPERSTRUCTURE DETAILS
OF
NORTH REES ROAD BRIDGE
FOR
STEPHENSON COUNTY

SHEET TITLE
DETAILS

JOB NUMBER
2120077
DATE
3/25/2013

SHEET NO.
7 of 14

PDS-S-R34-0 7-1-10

Notes:
See sheet 8 of 14 for Superstructure Details and Bill of Material.
Bars Indicated thus 20 x 2-#4 etc. Indicates 20 lines of bars with 2 lengths per line.

MINIMUM BAR LAP
#4 bar = 2'-0"

S.N. 089-3286
27" X 48" PPC DECK BEAMS
CONCRETE OVERLAY DETAILS
SECTION 12-03120-00-BR
STEPHENSON COUNTY