

PROP. CURVE
 PI STA. = 81+28.67
 $\Delta = 3^\circ 02' 09''$ (RT)
 $D = 12^\circ 27' 49''$
 $R = 459.70'$
 $T = 12.18'$
 $L = 24.36'$
 $E = 0.16'$
 $\phi =$ NORMAL CROWN
 P.C. STA. = 81+16.49
 P.T. STA. = 81+40.85

PROP. CURVE
 PI STA. = 80+71.44
 $\Delta = 65^\circ 36' 36''$ (LT)
 $D = 63^\circ 39' 43''$
 $R = 90.00'$
 $T = 58.01'$
 $L = 103.06'$
 $E = 17.08'$
 $\phi =$ NORMAL CROWN
 P.C. STA. = 80+13.43
 P.T. STA. = 81+16.49

PROP. CURVE
 PI STA. = 184+48.25
 $\Delta = 13^\circ 24' 30''$ (RT)
 $D = 4^\circ 46' 29''$
 $R = 1,200.00'$
 $T = 141.06'$
 $L = 280.82'$
 $E = 8.26'$
 $\phi =$ NORMAL CROWN
 P.C. STA. = 183+07.20
 P.T. STA. = 185+88.02

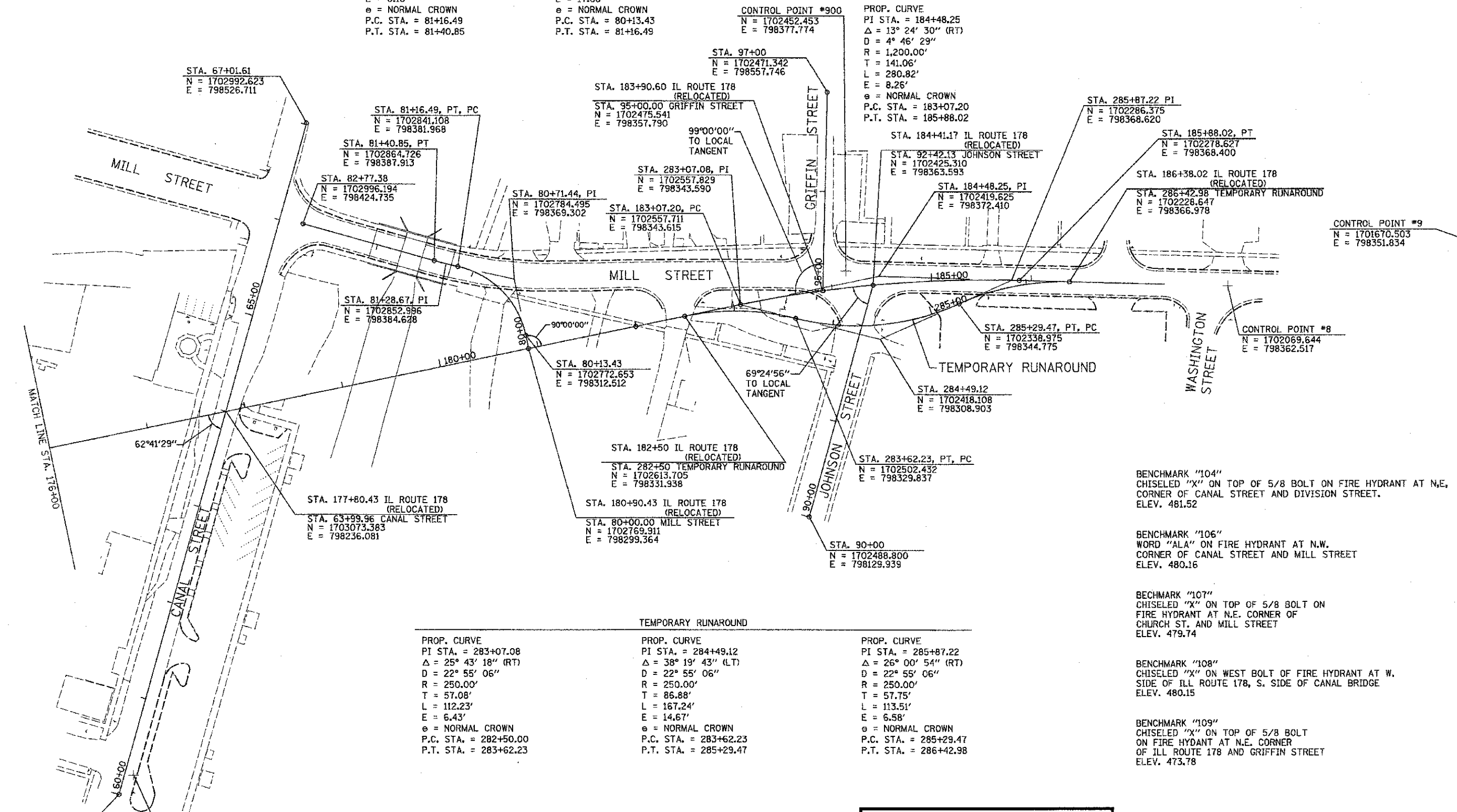

PROP. CURVE
 PI STA. = 283+07.08
 $\Delta = 25^\circ 43' 18''$ (RT)
 $D = 22^\circ 55' 06''$
 $R = 250.00'$
 $T = 57.08'$
 $L = 112.23'$
 $E = 6.43'$
 $\phi =$ NORMAL CROWN
 P.C. STA. = 282+50.00
 P.T. STA. = 283+62.23

PROP. CURVE
 PI STA. = 284+49.12
 $\Delta = 38^\circ 19' 43''$ (LT)
 $D = 22^\circ 55' 06''$
 $R = 250.00'$
 $T = 86.88'$
 $L = 167.24'$
 $E = 14.67'$
 $\phi =$ NORMAL CROWN
 P.C. STA. = 283+62.23
 P.T. STA. = 285+29.47

PROP. CURVE
 PI STA. = 285+87.22
 $\Delta = 26^\circ 00' 54''$ (RT)
 $D = 22^\circ 55' 06''$
 $R = 250.00'$
 $T = 57.75'$
 $L = 113.51'$
 $E = 6.58'$
 $\phi =$ NORMAL CROWN
 P.C. STA. = 285+29.47
 P.T. STA. = 286+42.98

- BENCHMARK "104"
 CHISELED "X" ON TOP OF 5/8 BOLT ON FIRE HYDRANT AT N.E. CORNER OF CANAL STREET AND DIVISION STREET.
 ELEV. 481.52
- BENCHMARK "106"
 WORD "ALA" ON FIRE HYDRANT AT N.W. CORNER OF CANAL STREET AND MILL STREET
 ELEV. 480.16
- BENCHMARK "107"
 CHISELED "X" ON TOP OF 5/8 BOLT ON FIRE HYDRANT AT N.E. CORNER OF CHURCH ST. AND MILL STREET
 ELEV. 479.74
- BENCHMARK "108"
 CHISELED "X" ON WEST BOLT OF FIRE HYDRANT AT W. SIDE OF ILL ROUTE 178, S. SIDE OF CANAL BRIDGE
 ELEV. 480.15
- BENCHMARK "109"
 CHISELED "X" ON TOP OF 5/8 BOLT ON FIRE HYDRANT AT N.E. CORNER OF ILL ROUTE 178 AND GRIFFIN STREET
 ELEV. 473.78

NOTE:
 INFORMATION ON THIS SHEET FROM CONTRACT 66547

SEE SHEET 9 FOR SWING TIES TO CONTROL POINTS.

FILE NAME = D36647-SHT-ATB.DGN	USER NAME = ---	DESIGNED - JKC	REVISED - ----	STATE OF ILLINOIS DEPARTMENT OF TRANSPORTATION	IL RTE 178 (RELOCATED) ALIGNMENT & TIES		F.A.S. RTE. 1279	SECTION 06-00017-01-LS	COUNTY LASALLE	TOTAL SHEETS 29	SHEET NO. 8	
PLOT SCALE = 1"=50'	CHECKED - JKC/LAG	DATE - 08/10	REVISED - ----		SCALE: 1"=50'	SHEET NO. ___ OF ___ SHEETS	STA. 176+00 TO STA. 186+38.02	CONTRACT NO. 87355				
PLOT DATE = 08/18	DATE - 08/10	REVISED - ----	REVISED - ----		FED. ROAD DIST. NO. [ILLINOIS] FED. AID PROJECT							