

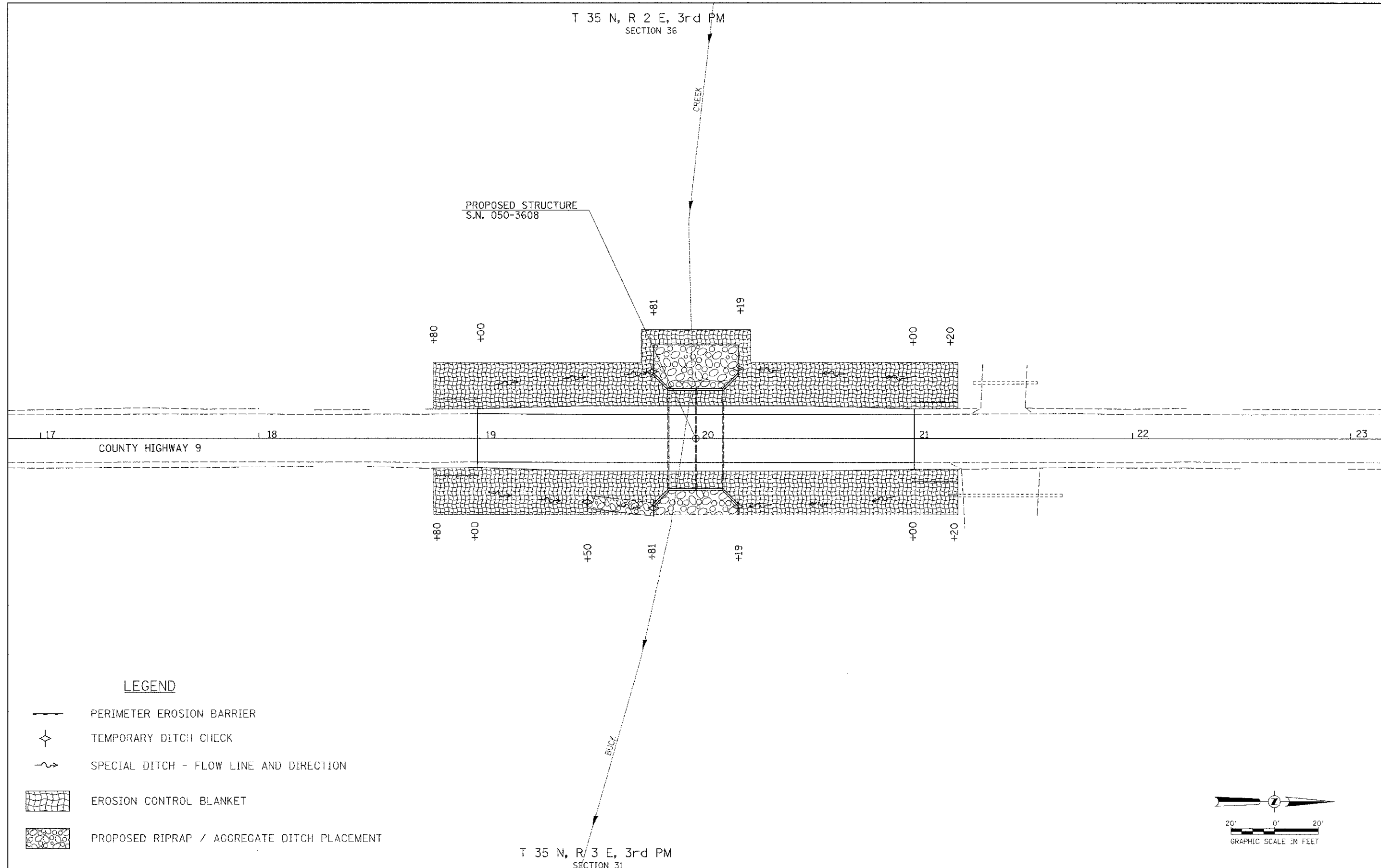



T 35 N, R 2 E, 3rd PM
SECTION 36

PROPOSED STRUCTURE
S.N. 050-3608

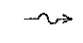

T 35 N, R 3 E, 3rd PM
SECTION 31

LEGEND

-  PERIMETER EROSION BARRIER
-  TEMPORARY DITCH CHECK
-  SPECIAL DITCH - FLOW LINE AND DIRECTION
-  EROSION CONTROL BLANKET
-  PROPOSED RIPRAP / AGGREGATE DITCH PLACEMENT

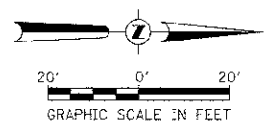

FILE NAME = V:\Bridge\3282-LoSalle\3282500.dgn	USER NAME = othomas	DESIGNED -	REVISED -	LASALLE COUNTY COUNTY HIGHWAY 9 OVER BUCK CREEK	EROSION CONTROL PLAN			F.A.S. RTE.	SECTION	COUNTY	TOTAL SHEETS	SHEET NO.
		DRAWN -	REVISED -		SCALE: 1"=20'	SHEET NO. 1 OF 1 SHEETS	STA. 18+80.00 TO STA. 21+20.00	174	13-00726-00-BR	LASALLE	16	5
		CHECKED -	REVISED -					CONTRACT NO. 87557				
		DATE -	REVISED -					FED. ROAD DIST. NO. 7 ILLINOIS FED. AID PROJECT BRS-0174019				