

F.A. RTE.	SECTION	COUNTY	TOTAL SHEETS	SHEET NO.
CH26	11-00143-00-BR	FULTON	23	1
ILLINOIS CONTRACT NO. 09597				

INDEX OF SHEETS

1. COVER
2. GENERAL NOTES AND LEGEND
3. SUMMARY AND SCHEDULE OF QUANTITIES
4. TYPICAL SECTIONS
5. ALIGNMENT, BENCHMARKS, AND TIES
6. DEMOLITION PLAN
7. PLAN AND PROFILE
8. EROSION CONTROL PLAN
9. GRADING PLAN
10. GENERAL PLAN AND ELEVATION
11. GENERAL NOTES AND RIPRAP DETAILS
12. PCC DECK BEAM SUPERSTRUCTURE
13. 27" X 48" PCC DECK BEAM
14. 27" X 48" PCC DECK BEAM DETAILS
15. STEEL RAILING, TYPE SM
16. ABUTMENTS
17. HP PILE DETAILS
18. BORING LOGS
19. ROADWAY - CROSS SECTIONS
20. ROADWAY - CROSS SECTIONS
21. ROADWAY - CROSS SECTIONS
22. CREEK - CROSS SECTIONS
23. CREEK - CROSS SECTIONS

STATE OF ILLINOIS
DEPARTMENT OF TRANSPORTATION
DIVISION OF HIGHWAYS
**PLANS FOR PROPOSED
BRIDGE REPLACEMENT**

COUNTY HIGHWAY 26
OVER UNNAMED TRIBUTARY OF THE SPOON RIVER
FULTON COUNTY
HIGHWAY BRIDGE PROGRAM
SECTION 11-00143-00-BR
PROJECT NO. BROS-0057 (033)
JOB NO. C-94-031-11

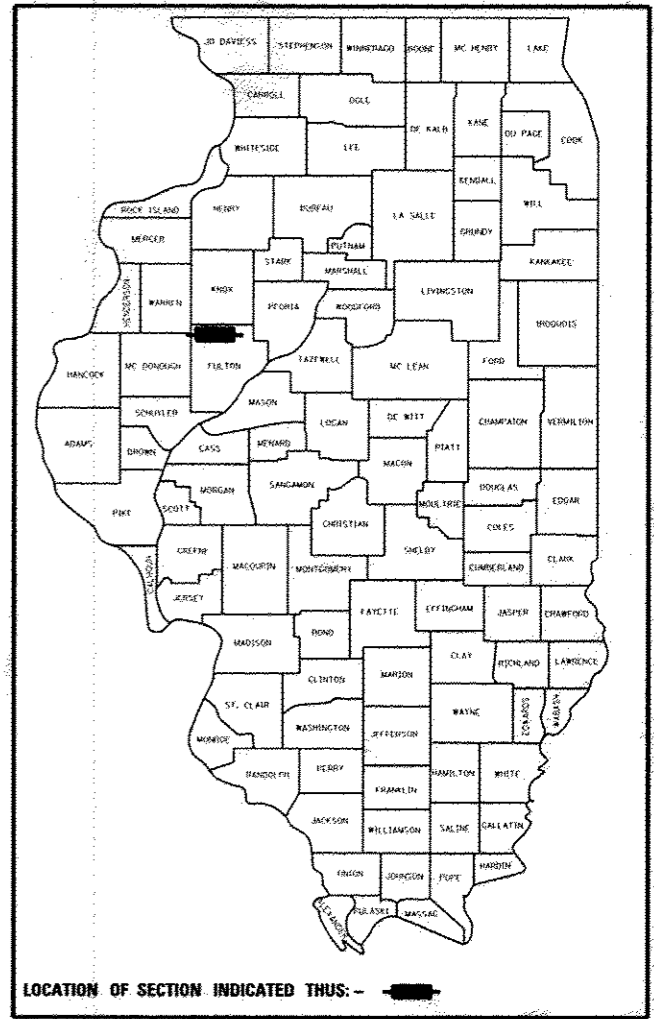

LIST OF STANDARDS

- | | |
|-------------|---|
| 000001-06 | STANDARD SYMBOLS, ABBREVIATIONS AND PATTERNS |
| 001001-02 | AREAS OF REINFORCEMENT BARS |
| 280001-07 | TEMPORARY EROSION CONTROL SYSTEMS |
| 515001-03 | NAME PLATES FOR BRIDGES |
| 635001-01 | DELINEATORS |
| 701006-04 | OFFROAD OPERATIONS, 2L, 2W, 15' TO 24" FROM PAVEMENT EDGE |
| 701901-02 | TRAFFIC CONTROL DEVICES |
| B.L.R. 21-9 | TYPICAL APPLICATION OF TRAFFIC CONTROL DEVICES FOR CONSTRUCTION ON RURAL LOCAL HIGHWAYS |
| B.L.R. 22-7 | TYPICAL APPLICATION OF TRAFFIC CONTROL DEVICES FOR CONSTRUCTION ON RURAL LOCAL HIGHWAYS |

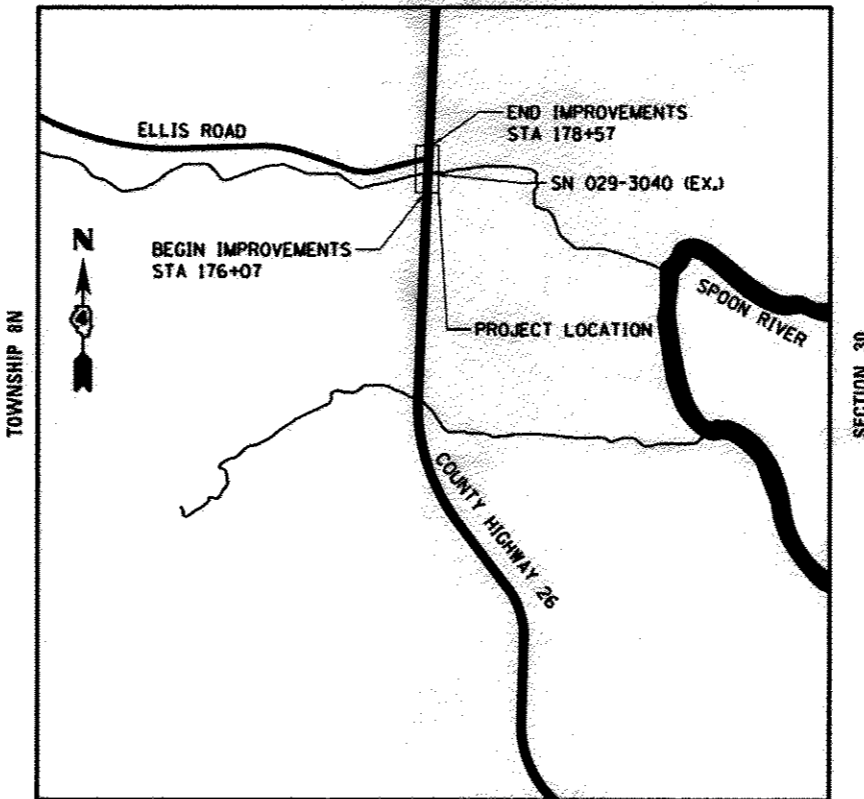

J.U.L.I.E.
JOINT UTILITY LOCATION INFORMATION FOR EXCAVATION
1-800-892-0123
OR 811

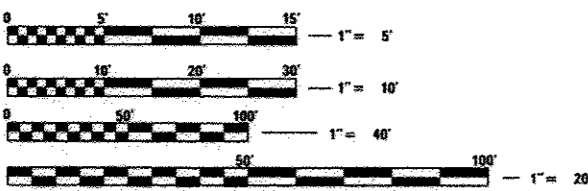

FULL SIZE PLANS HAVE BEEN PREPARED USING STANDARD ENGINEERING SCALES. REDUCED SIZED PLANS WILL NOT CONFORM TO STANDARD SCALES. IN MAKING MEASUREMENTS ON REDUCED PLANS, THE ABOVE SCALES MAY BE USED.

CAT* 033323-00

ADT (2010) = 50, SU/MU=0%
HIGHWAY CLASS: IV
FUNCTIONAL CLASSIFICATION: LOCAL ROAD
DESIGN SPEED: 30 MPH
DESIGN POLICY: BLR MANUAL

RANGE 2E
GROSS LENGTH = 250 FT. = 0.05 MILE
NET LENGTH = 250 FT. = 0.05 MILE

REGISTERED PROFESSIONAL ENGINEER
AURT
BRIAN LOBRESKI
A 062-058662
STATE OF ILLINOIS
DATE SIGNED: 3/27/2013
LIC. EXP. DATE: 11/30/2013
HANSON

**PRINTED BY THE AUTHORITY
OF THE STATE OF ILLINOIS**

APPROVED *March 19 2013*
William C. Kuhn
COUNTY ENGINEER

PASSED *03/27 2013*
[Signature]
DISTRICT ENGINEER OF LOCAL ROADS & STREETS

Releasing For Bid Based on Limited Review
March 28 2013
[Signature]
DEPUTY DIRECTOR OF HIGHWAYS,
REGION THREE ENGINEER
STATE OF ILLINOIS
DEPARTMENT OF TRANSPORTATION

DATE: 3/19/13
© Copyright Hanson Professional Services Inc. 2013
HANSON
Hanson Professional Services Inc.
7625 N. University St., Suite 200
Peoria, Illinois 61614
Offices Nationwide