

IMPROVEMENT BEGINS
STA. 3+03.44

PC Sta 3+12.53

MATCH LINE STA 7+00.00

- INTENDED SEQUENCE**
1. SETUP TRAFFIC CONTROL FOR THE RESPECTIVE STAGE.
 2. PLACEMENT OF PERIMETER EROSION BARRIER PRIOR TO THE COMMENCEMENT OF ANY WORK, SEE STD. 280001.
 3. INSTALL INLET AND PIPE PROTECTION AND OTHER EROSION CONTROL ITEMS AS STATED ON THE PLANS.
 4. REMOVE EXISTING PAVEMENT, CURB & GUTTER, SIDEWALK, PERFORM EARTHWORK AS SHOWN ON THE PLANS.
 5. CONSTRUCT NEW PAVEMENT, CURB & GUTTER, SIDEWALKS, STORM SEWERS, AND OTHER WORK AS SHOWN FOR THE RESPECTIVE STAGE.
 6. REVISE TRAFFIC CONTROL FOR THE NEXT STAGE AND REPEAT THE ABOVE SEQUENCE UNTIL COMPLETE.

PROP. CURVE LINDEN-1
 PI STA. = 5+16.53
 $\Delta = 18^{\circ} 32' 18''$ (RT)
 $D = 4^{\circ} 35' 01''$
 $R = 1,250.00'$
 $T = 204.00'$
 $L = 404.44'$
 $E = 16.54'$
 $\theta =$
 $T.R. =$
 $S.E. RUN =$
 $P.C. STA = 3+12.53$
 $P.T. STA = 7+16.97$

LEGEND

- INLET AND PIPE PROTECTION/ INLET FILTER
- PERIMETER EROSION BARRIER
- TEMPORARY DITCH CHECK

SCALE IN FEET

LEGEND

- INLET AND PIPE PROTECTION/ INLET FILTER
- PERIMETER EROSION BARRIER
- TEMPORARY DITCH CHECK

SCALE IN FEET

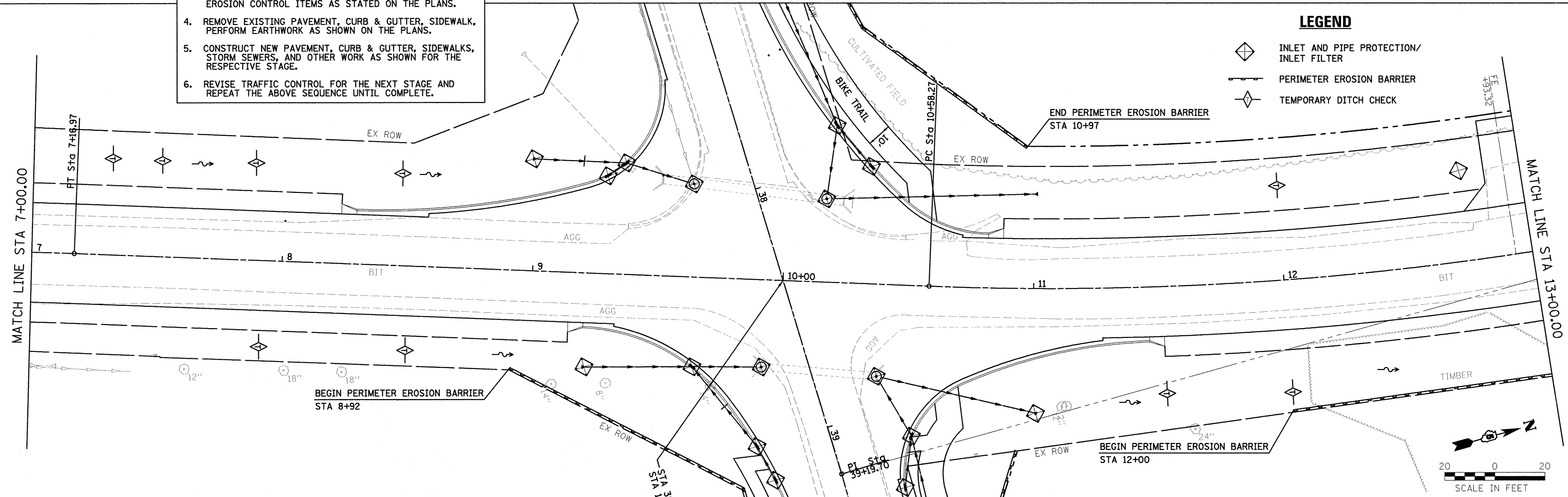

Farnsworth GROUP, INC.
 2709 McGraw Drive
 Bloomington, Illinois 61704
 309/663-8435, 309/663-1571 fax

DESIGNED - PJM
 DRAWN - JJO/LAT
 CHECKED - PJM
 DATE - 01/18/13

REVISED -
 REVISED -
 REVISED -
 REVISED -

REVISED -
 REVISED -
 REVISED -
 REVISED -

**TOWN OF NORMAL
 NORTHTOWN ROAD FROM
 1200' WEST OF LINDEN STREET TO TOWANDA AVENUE**

EROSION CONTROL PLAN

SCALE: SHEET OF SHEETS STA. TO STA.

F.A.U. RTE. 6375	SECTION 00-00206-00-RP	COUNTY MCLEAN	TOTAL SHEETS 129	SHEET NO. 57
CONTRACT NO. 91479				ILLINOIS FED. AID PROJECT