

PLAN	DESIGNED	BY	DATE
	PLOTTED		
	ALIGNED		
	CHECKED		
	NO.		
	FILE NAME		

PROFILE	DESIGNED	BY	DATE
	PLOTTED		
	GRADES		
	CHECKED		
	NO.		
	FILE NAME		

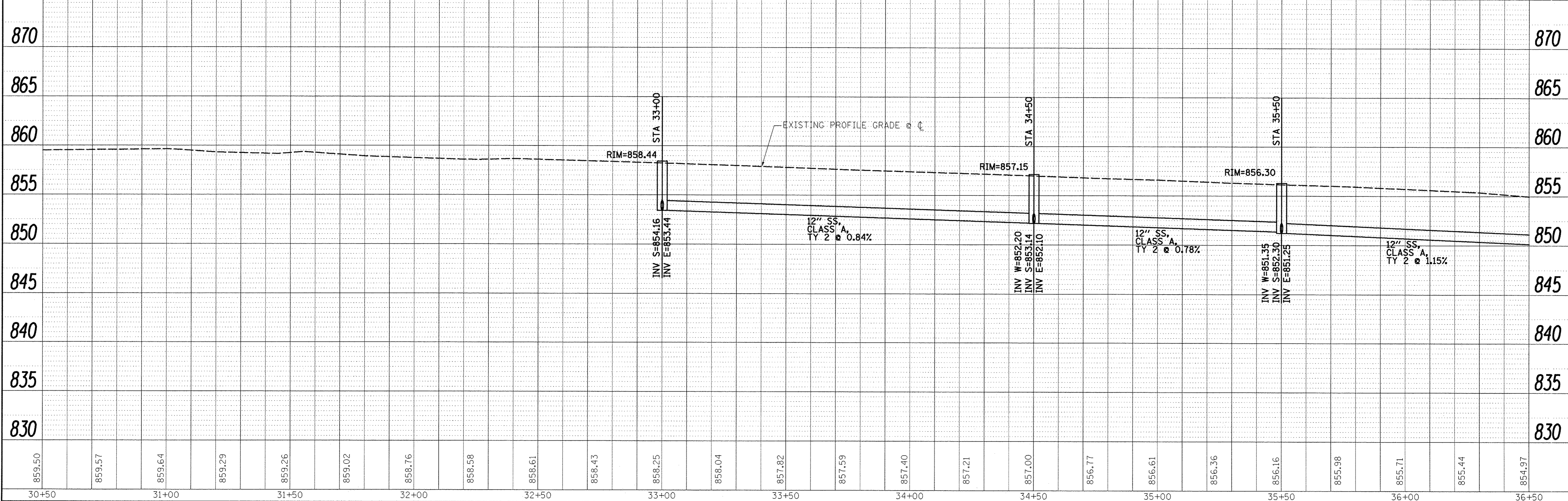
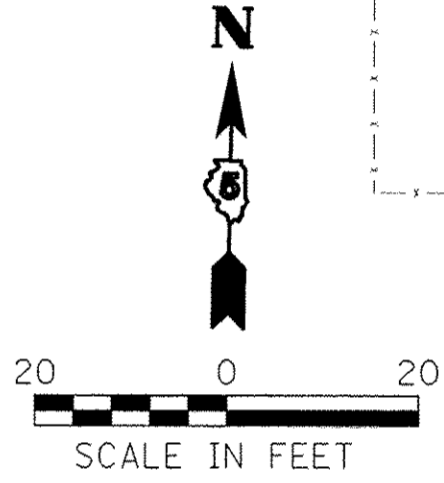
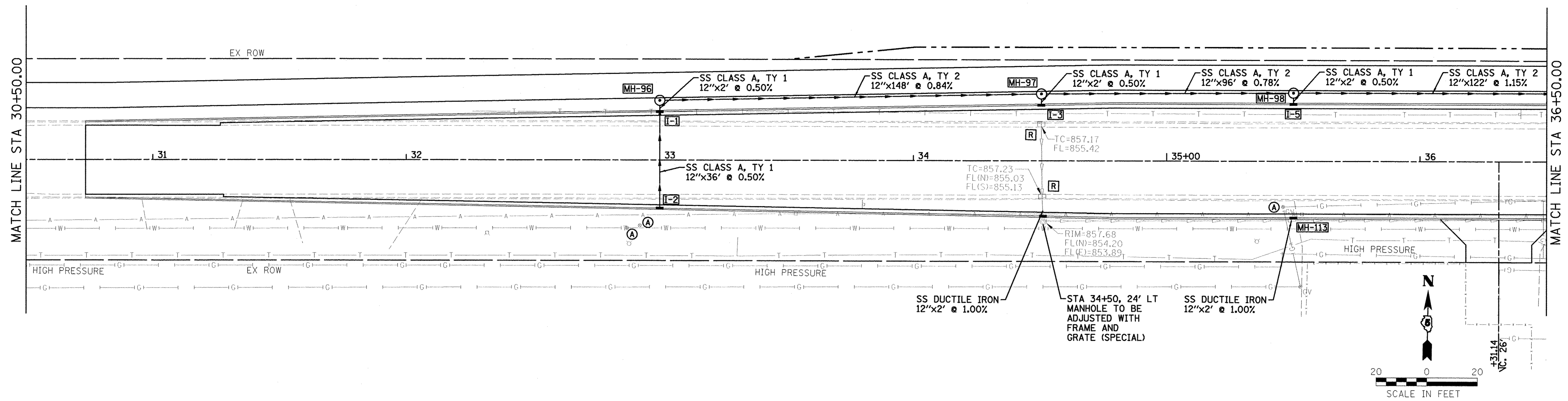

<b>Farnsworth GROUP, INC.</b> 2709 McGraw Drive Bloomington, Illinois 61704 309/663-8435, 309/663-1671 fax	DESIGNED - PJM	REVISED -	<b>TOWN OF NORMAL</b> <b>NORTHTOWN ROAD FROM</b> <b>1200' WEST OF LINDEN STREET TO TOWANDA AVENUE</b>	<b>DRAINAGE PLAN AND PROFILE</b> SCALE: SHEET OF SHEETS STA. 30+50.00 TO STA. 36+50.00	F.A.U. RTE. 6375	SECTION 00-00206-00-RP	COUNTY McLEAN	TOTAL SHEETS 129	SHEET NO. 61
	DRAWN - JJO/LAT	REVISED -			CONTRACT NO. 91479				
	CHECKED - PJM	REVISED -			ILLINOIS FED. AID PROJECT				
	DATE - 01/18/13	REVISED -			24-8801				