

FAU RTE 6405  
LINDEN ST

STA 3+03.44  
MATCH EXISTING  
PAVEMENT

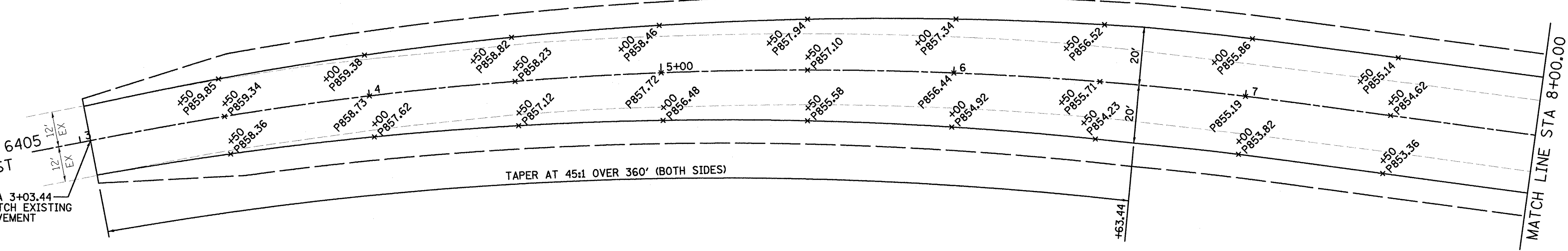

MATCH LINE STA 8+00.00

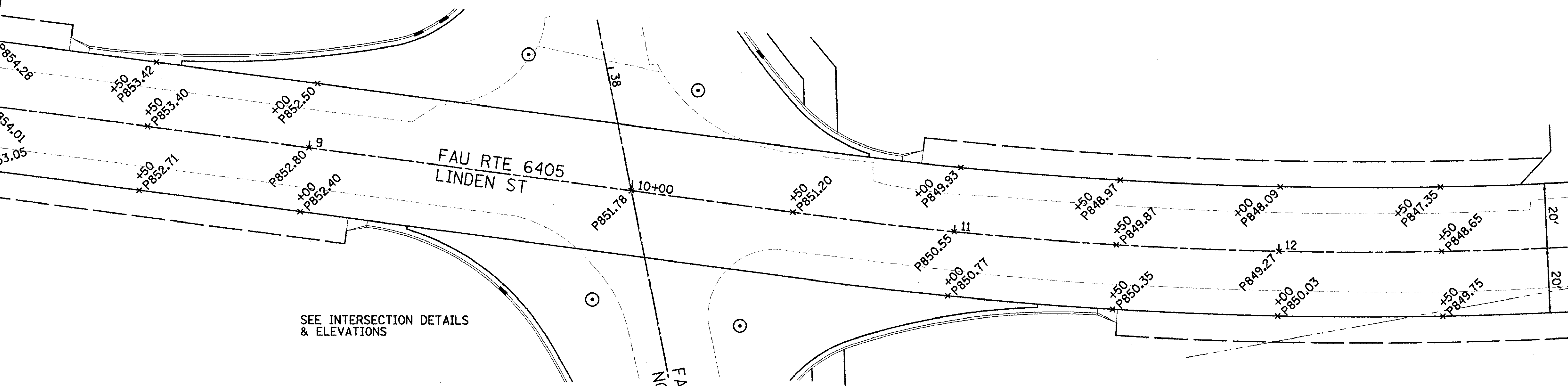

SEE INTERSECTION DETAILS  
& ELEVATIONS

FAU RTE 6375  
NORTHTOWN ROAD

MATCH LINE STA 13+00.00

**NOTE:**

CENTERLINE GRADES WERE SET TO MILL AND RESURFACE 2 1/4" OF HMA AT THE CENTERLINE EXCEPT FROM STA 9+00 TO STA 11+50 WHERE GRADES ARE WARPED FOR RIDE ABILITY. EDGE OF PAVEMENT GRADES WERE CALCULATED USING THE CENTERLINE GRADE AND THE EXISTING PAVEMENT CROSS SLOPE. THE CONTRACTOR SHALL CHECK THE EDGE OF PAVEMENT GRADES BY EXTENDING A STRAIGHT EDGE FROM THE CENTERLINE TO THE PROPOSED EDGE OF PAVEMENT AND REVISE THE GRADES AS NECESSARY TO MATCH EXISTING CROSS SLOPE IN THE FIELD.

FAU RTE 6405  
LINDEN ST

STA 17+27.39  
MATCH EXISTING  
PAVEMENT

MATCH LINE STA 13+00.00

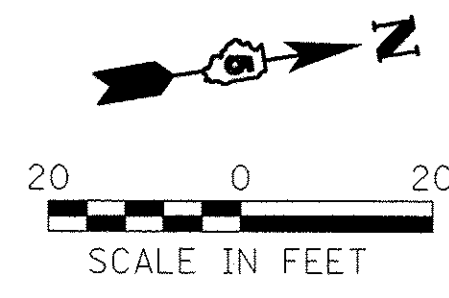
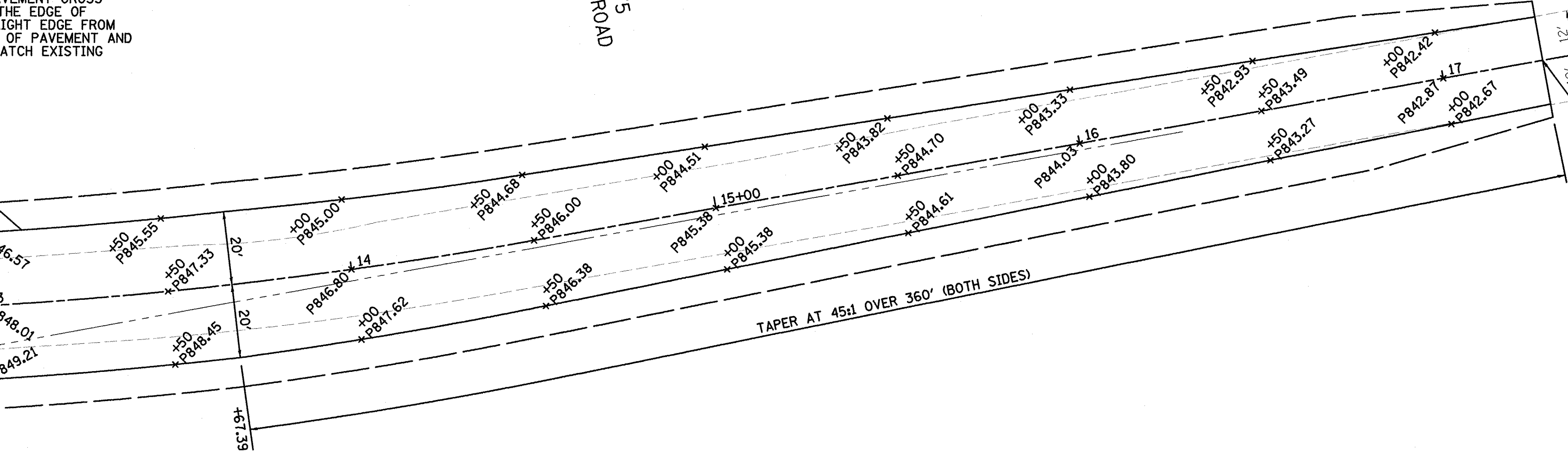

**Farnsworth**  
GROUP, INC.  
2709 McGraw Drive  
Bloomington, Illinois 61704  
309/663-8435, 309/663-1571 fax

DESIGNED - PJM  
DRAWN - JJO/LAT  
CHECKED - PJM  
DATE - 01/18/13

REVISED -  
REVISED -  
REVISED -  
REVISED -

**TOWN OF NORMAL  
NORTHTOWN ROAD FROM  
1200' WEST OF LINDEN STREET TO TOWANDA AVENUE**

**ELEVATION PLAN**

SCALE: SHEET OF SHEETS STA. TO STA.

F.A.U. RTE. 6375	SECTION 00-00206-00-RP	COUNTY MCLEAN	TOTAL SHEETS 129	SHEET NO. 77
CONTRACT NO. 91479				
ILLINOIS FED. AID PROJECT				