

FINAL SURVEY	DATE
FORWARDED	BY
PLOTTED	
NOTE BOOK	
AREAS CHECKED	
NO.	

ORIGINAL SURVEY	DATE
FORWARDED	BY
PLOTTED	
NOTE BOOK	
AREAS CHECKED	
NO.	

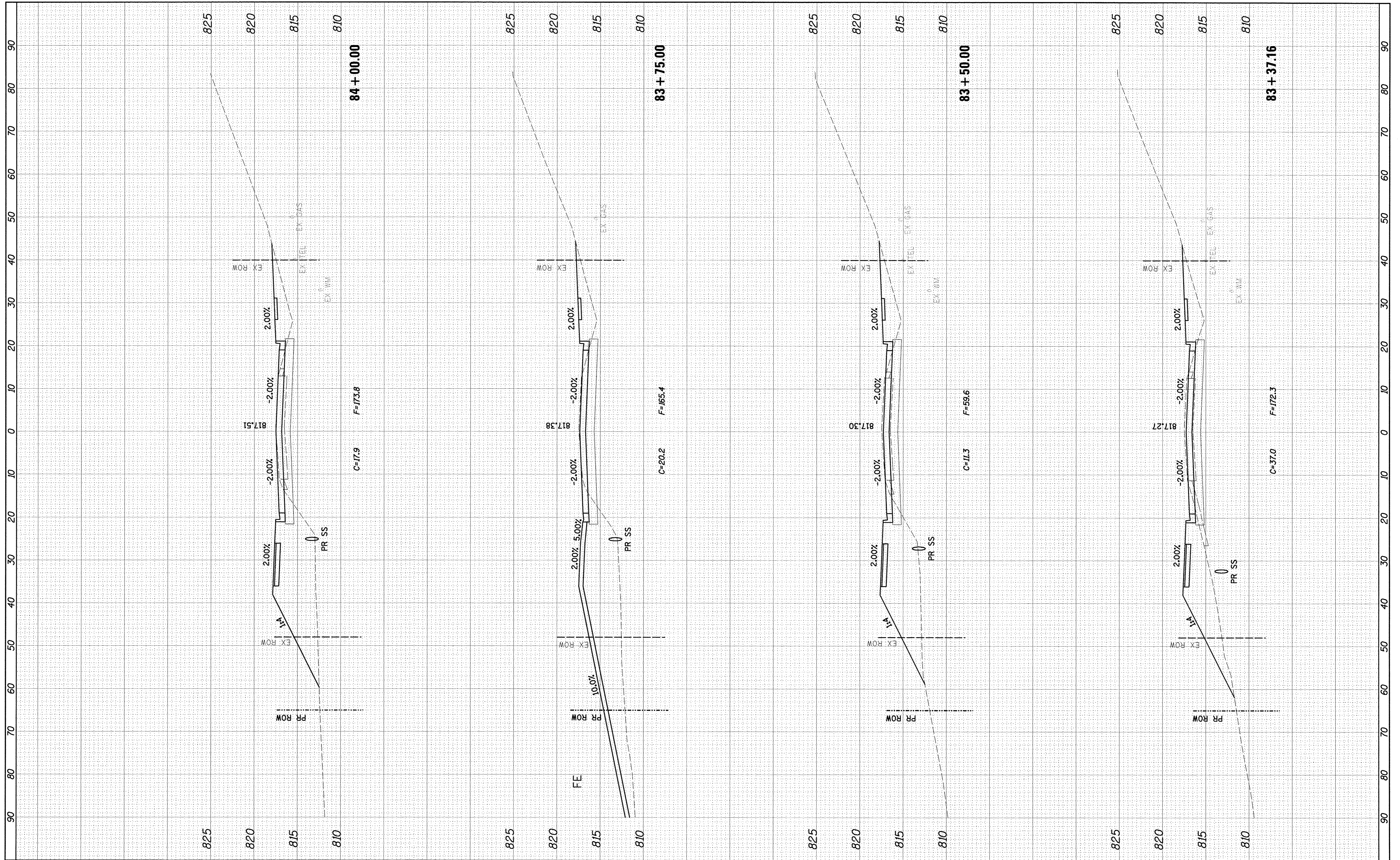

Farnsworth GROUP, INC.
 2709 McGraw Drive
 Bloomington, Illinois 61704
 309/663-8435, 309/663-1671 fax

DESIGNED - PJM
 DRAWN - JJO/LAT
 CHECKED - PJM
 DATE - 01/18/13

REVISED -
 REVISED -
 REVISED -
 REVISED -

**TOWN OF NORMAL
 NORTHTOWN ROAD FROM
 1200' WEST OF LINDEN STREET TO TOWANDA AVENUE**

**NORTHTOWN ROAD
 CROSS SECTIONS**

SCALE: SHEET OF SHEETS STA. 83+37.16 TO STA. 84+00.00

F.A.U. RTE.	SECTION	COUNTY	TOTAL SHEETS	SHEET NO.
6375	00-00206-00-RP	McLEAN	129	120
				CONTRACT NO. 91479
ILLINOIS FED. AID PROJECT				